

Fisher-Price®

M2055



www.fisher-price.com/uk



WARNING

To prevent serious injury or death:

- **Fall Hazard** - It is dangerous to use this reclined cradle on an elevated surface, since child's movement may cause product to slide or tip over. Use only on a floor.
- **Suffocation Hazard** - Never use on a soft surface (bed, sofa, cushion) since the product can tip over and cause suffocation in soft surfaces.
- Never use the toy bar as a handle.
- Always use the restraint system.
- Never leave child unattended.
- Never use as a car seat.
- Not recommended for children who can sit up by themselves (6 months approximately, until 9 kg/20 lbs).

IMPORTANT! Please keep these instructions for future reference, as they contain important information.

- Please read these instructions before use of this product.
- Adult assembly is required. Tool needed for assembly: Phillips Screwdriver (not included).
- Requires three "C" (LR14) **alkaline** batteries (not included) for operation.
- Product features and decoration may vary from photos.



CAUTION

This package contains small parts in its unassembled state. Adult assembly is required.

Parts

IMPORTANT! Please remove all parts from the package and identify them before assembly. Some parts may be packed inside the pad.

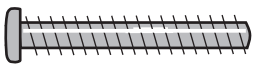
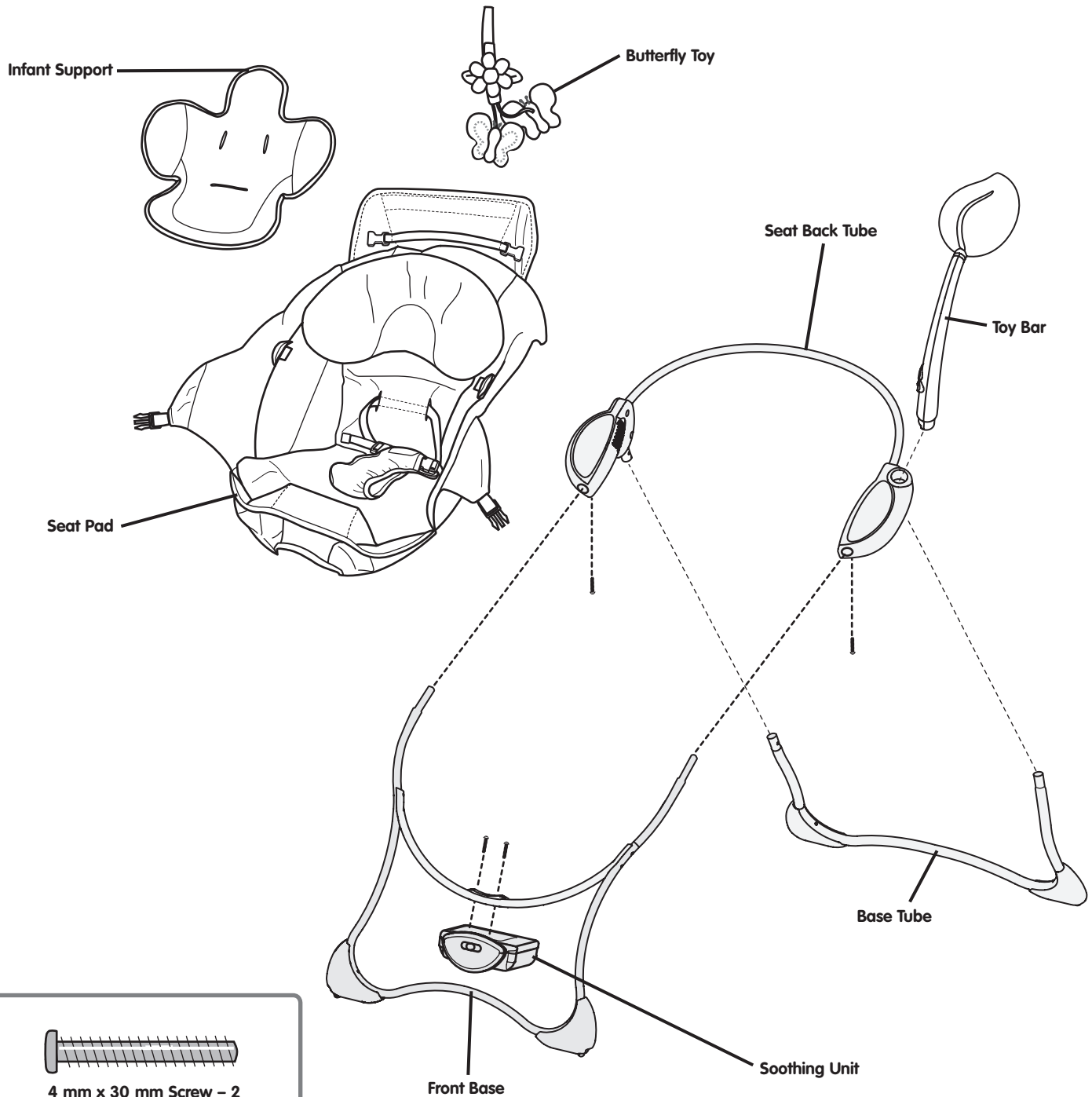

4 mm x 30 mm Screw - 2



4 mm x 20 mm Screw - 2

Shown Actual Size

Assembly

IMPORTANT! Before assembly, inspect this product for damaged hardware, loose joints, missing parts or sharp edges. DO NOT use if any parts are missing or broken. Contact Mattel for replacement parts and instructions if needed. Never substitute parts.

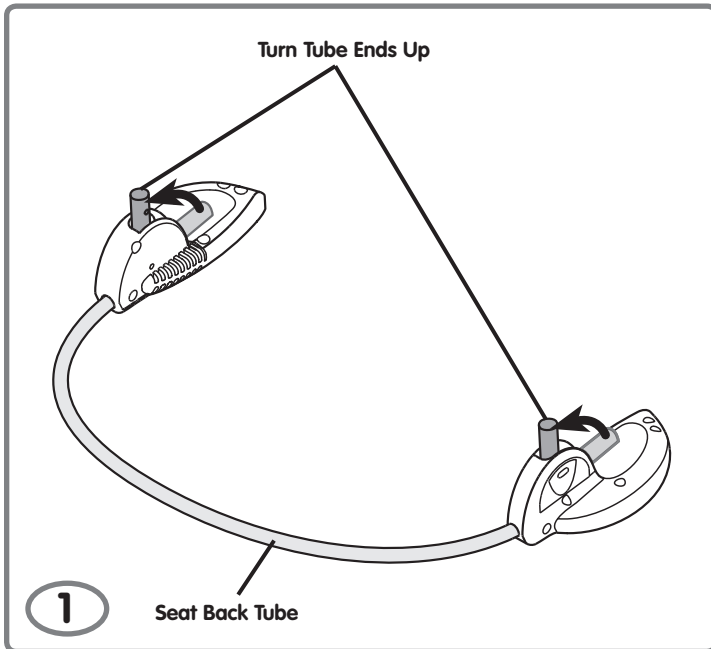

- Place the seat back tube face down, as shown.
- Turn the ends of the tube upright.

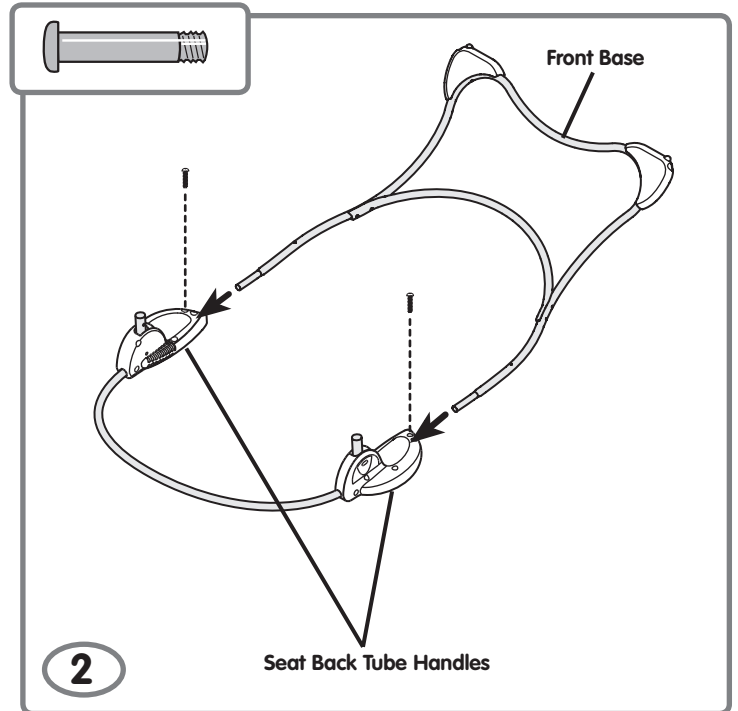

- Insert the ends of the front base into the holes in the handles.
Hint: If you cannot insert the front base into the handles, turn the seat back tube over and try again!
- Insert two 4 mm x 20 mm screws through the hole in the handles and the ends of the front base. Tighten the screws.
Hint: If the screw does not easily insert through the hole in the handle and front base, you may not have pushed the front base completely into the handle. Push the front base into the handle to align the holes and then insert the screw.

Assembly

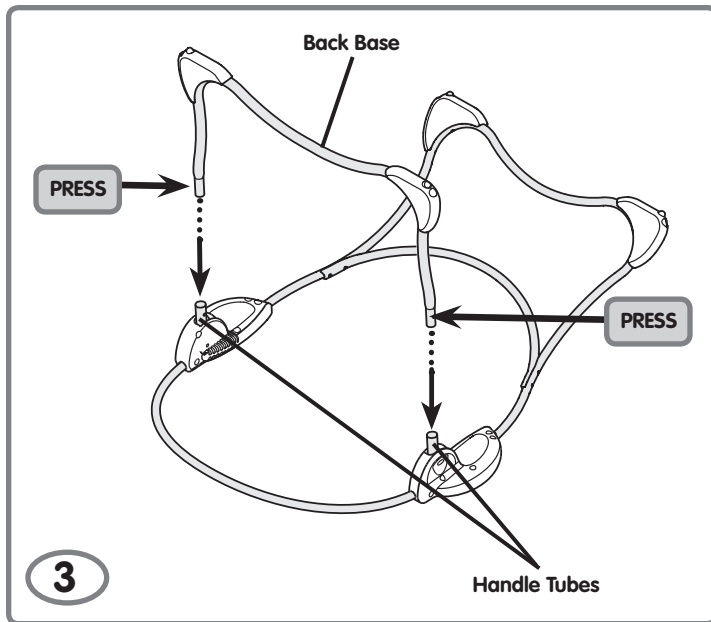

- While pressing the buttons on the ends of the back base, insert it into the tubes in the handle. **Make sure the back base “snaps” into place.**
- Pull the back base to be sure it is secure to the handle tubes.

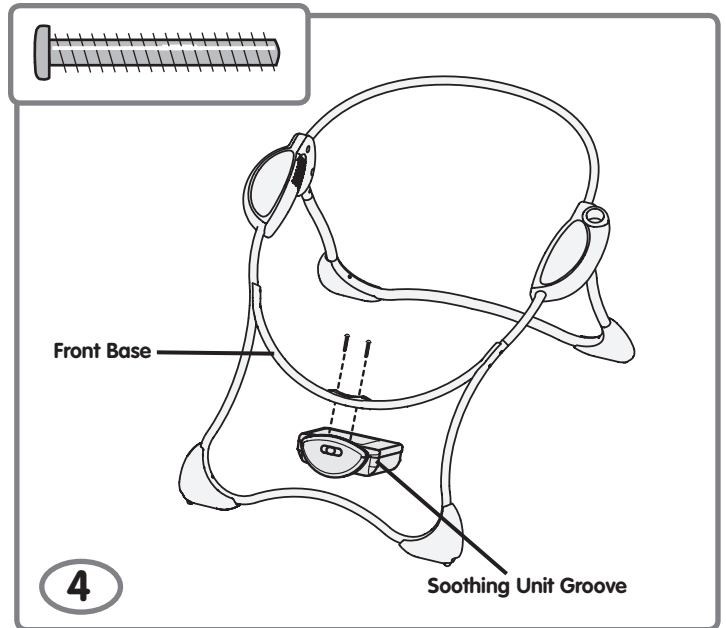

- Turn the assembly upright.
- Position the soothing unit upright and fit the groove to the front base, as shown.
- Insert two 4 mm x 30 mm screws through the front base and into the soothing unit. Tighten the screws.

Assembly

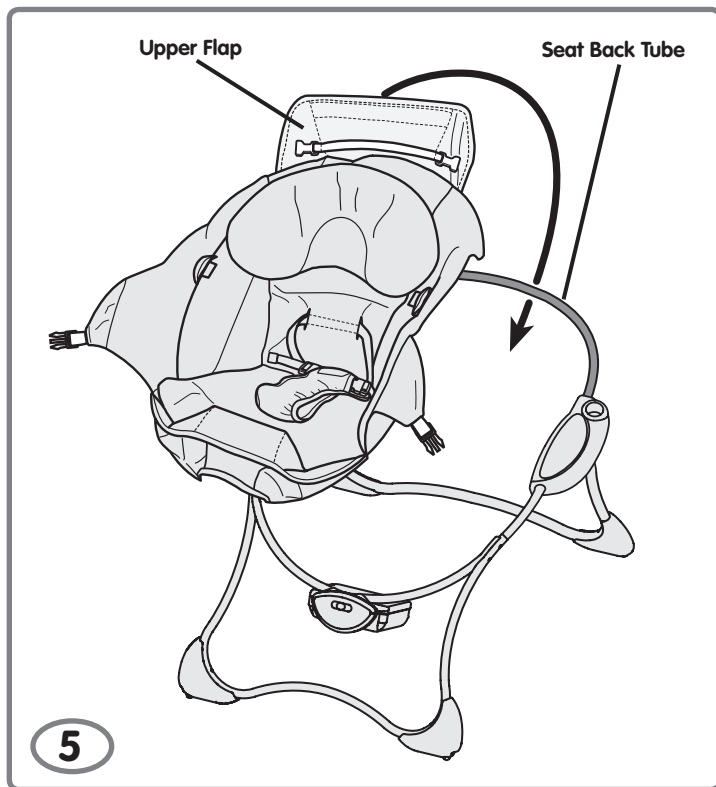

- Fit the upper flap on the pad around the seat back tube.

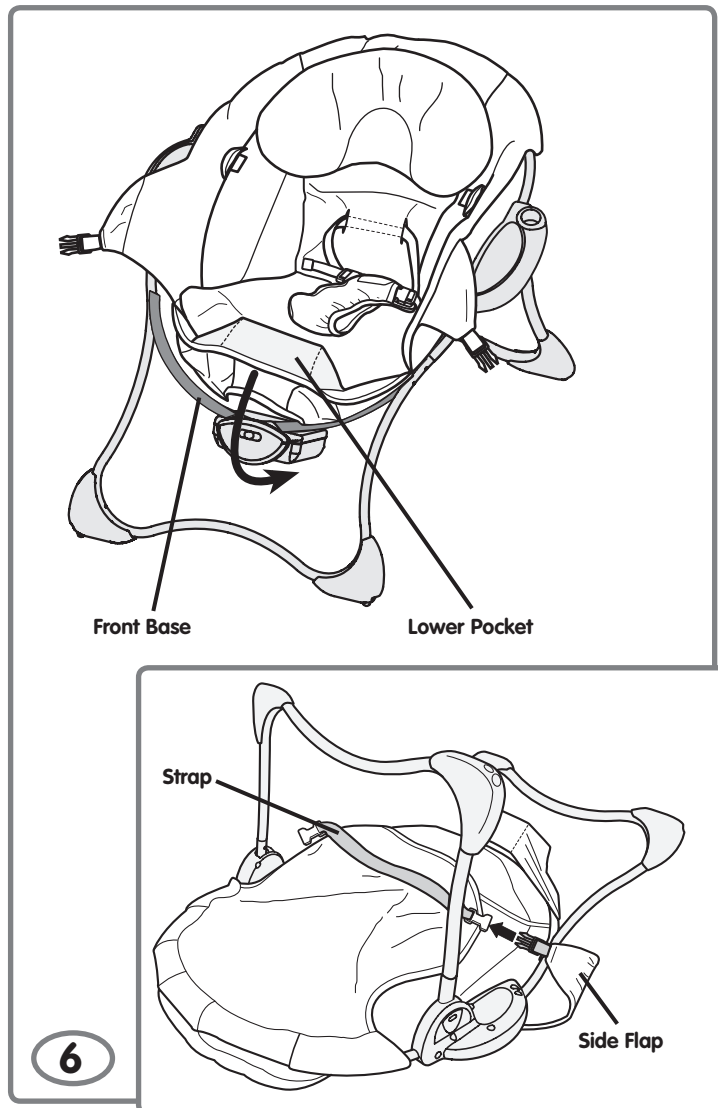

- Fit the pad lower pocket around the front base and soothing unit.
- Turn the assembly face down.
- Fasten both pad side flaps to the strap on the back of the pad. Make sure you hear a **“snap”** on both sides.

Assembly

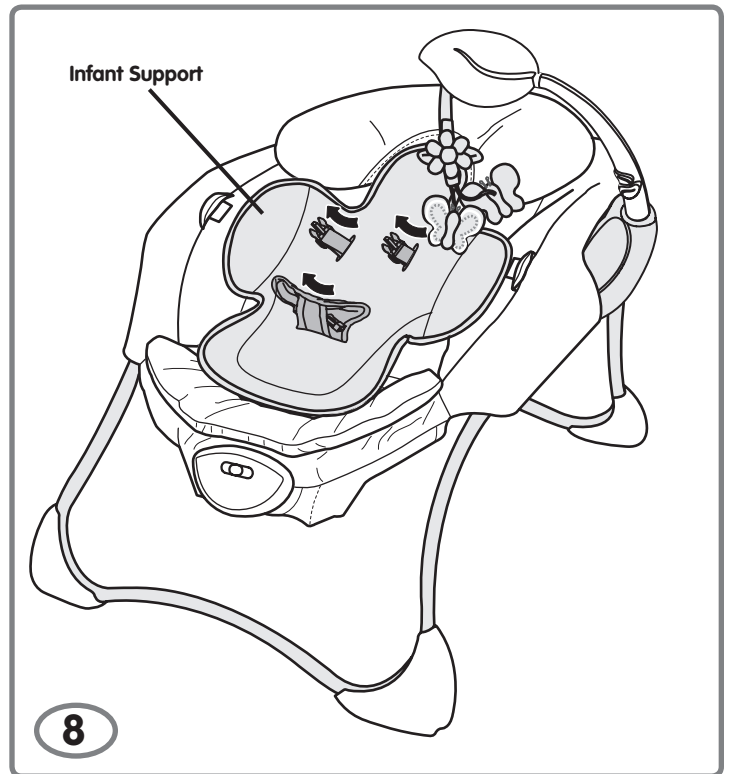
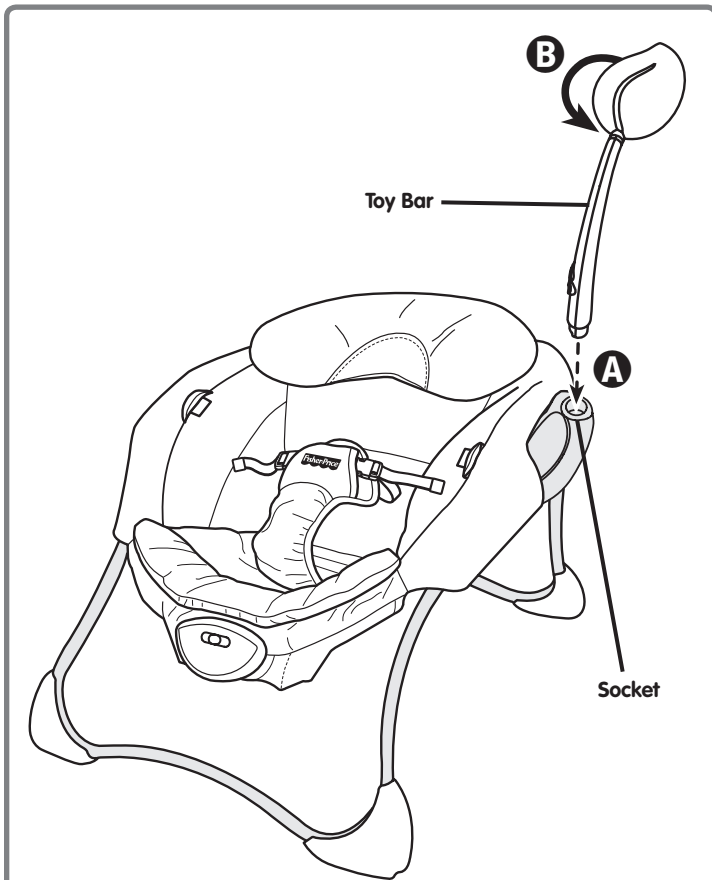

- Place the infant support on top of the pad.
- Insert the restraint pad through the slot in the infant support. Make sure the restraint pad is not twisted.
- Thread the restraint straps through the slots in the infant support.

Assembly is now complete.

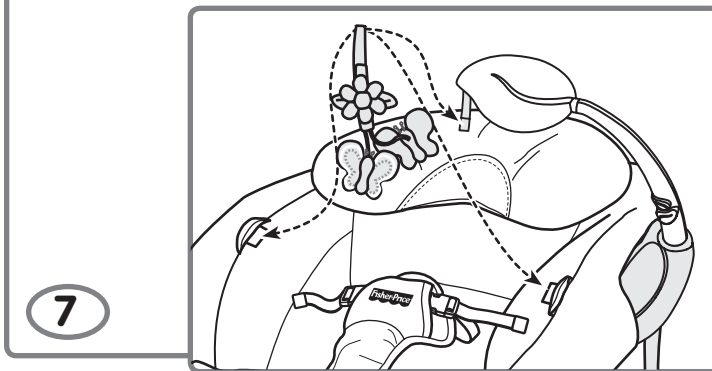

- Fit the toy bar into the socket in the handle **A**. Turn the toy bar to secure in place **B**.
- Attach the butterfly toy to any of the fastener tabs on the sides of the pad or toy bar, as shown.

Battery Installation



Hint: We recommend using an *alkaline* batteries for longer battery life.



- Protect the environment by not disposing of this product with household waste (2002/96/EC). Check your local authority for recycling advice and facilities (Europe only).

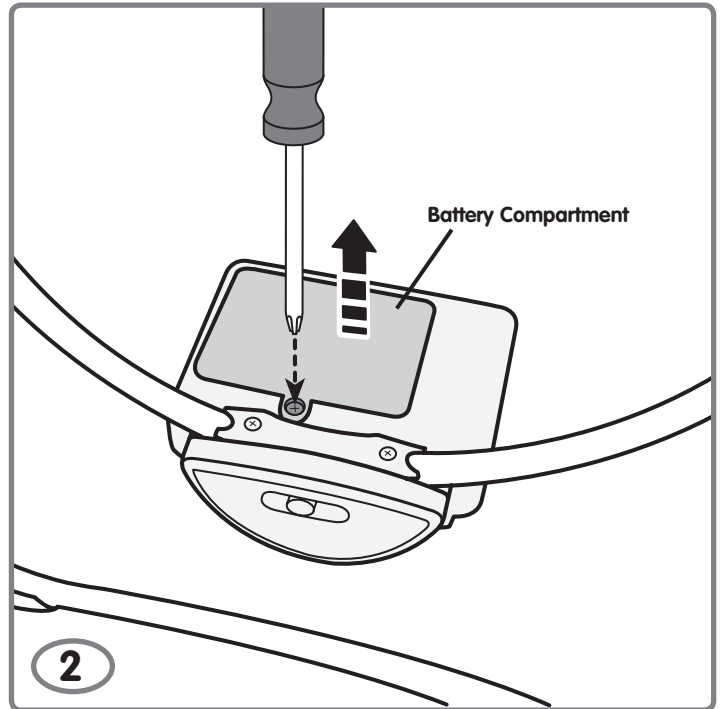

- Loosen the screw in the battery compartment door and remove the battery compartment door.
- Insert three "C" (LR14) *alkaline* batteries into the battery compartment.

Hint: We recommend using *alkaline* batteries for longer battery life.

- Replace the battery compartment door and tighten the screw.
- Fit the pad lower pocket around the front base and soothing unit.

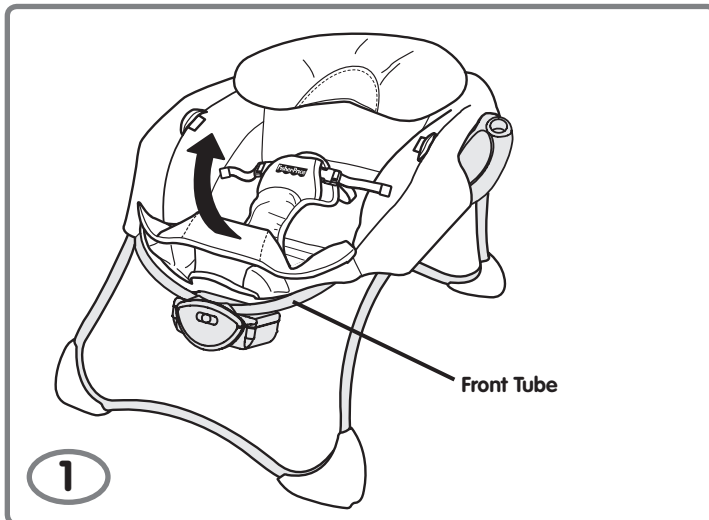

- Remove the pad lower pocket from the front tube.

Battery Safety Information

In exceptional circumstances, batteries may leak fluids that can cause a chemical burn injury or ruin your product. To avoid battery leakage:

- Do not mix old and new batteries or batteries of different types: alkaline, standard (carbon-zinc) or rechargeable (nickel-cadmium).
- Insert batteries as indicated inside the battery compartment.
- Remove batteries during long periods of non-use. Always remove exhausted batteries from the product. Dispose of batteries safely. Do not dispose of product in a fire. The batteries inside may explode or leak.
- Never short-circuit the battery terminals.
- Use only batteries of the same or equivalent type as recommended.
- Do not charge non-rechargeable batteries.
- Remove rechargeable batteries from the product before charging.
- If removeable, rechargeable batteries are used, they are only to be charged under adult supervision.

Setup and Use

WARNING

To prevent serious injury or death:

- **Fall Hazard** - It is dangerous to use this reclined cradle on an elevated surface, since child's movement may cause product to slide or tip over. Use only on a floor.
- **Suffocation Hazard** - Never use on a soft surface (bed, sofa, cushion) since the product can tip over and cause suffocation in soft surfaces.
- Never use the toy bar as a handle.
- Always use the restraint system.
- Never leave child unattended.
- Never use as a car seat.
- Not recommended for children who can sit up by themselves (6 months approximately, until 9 kg/20 lbs).

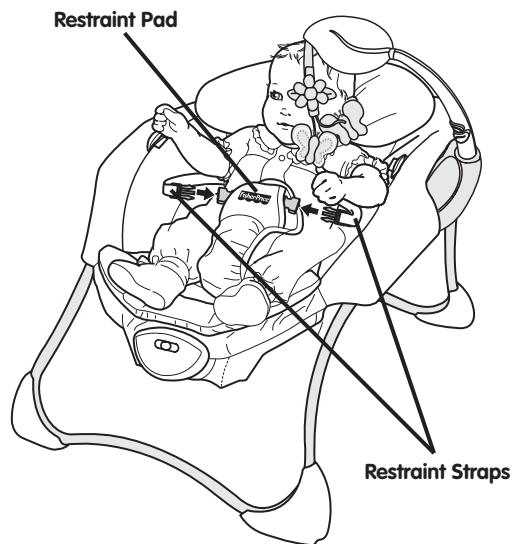

Securing your Infant

- Place your child in the seat. Position the restraint pad between your child's legs.
- Fasten the restraint straps to the restraint pad. **Make sure you hear a "click" on both sides.**
- Check to be sure the restraint system is securely attached by pulling it away from your child. The restraint system should remain attached.

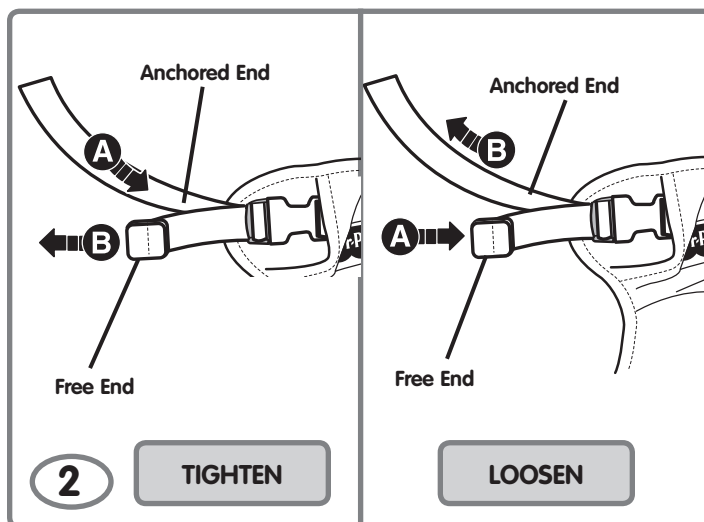

To tighten the restraint straps:

- Feed the anchored end of the restraint strap up through the buckle to form a loop **A**. Pull the free end of the restraint strap **B**.

To loosen the restraint straps:

- Feed the free end of the restraint strap up through the buckle to form a loop **A**. Enlarge the loop by pulling on the end of the loop toward the buckle. Pull the anchored end of the restraint strap to shorten the free end of the restraint strap **B**.

Soothing Unit



- Make sure your child is properly secured in the seat.
- Slide the power switch to 🎵 for music.
- Slide the power switch to ≈ for vibrations.
- Slide the power switch to 🎵 ≈ music and vibrations.
- Slide the power switch to ○ off to turn vibrations and music off.

Hint: Vibrations/Music turn off after approximately 15 minutes. To turn vibrations/music back on, slide the power switch off and then to the desired on mode.

IMPORTANT! Low battery power causes this product to operate erratically: no vibrations/music and the product may not turn off. Remove and discard all three batteries and replace with three, new “C” **alkaline** batteries.

Storage

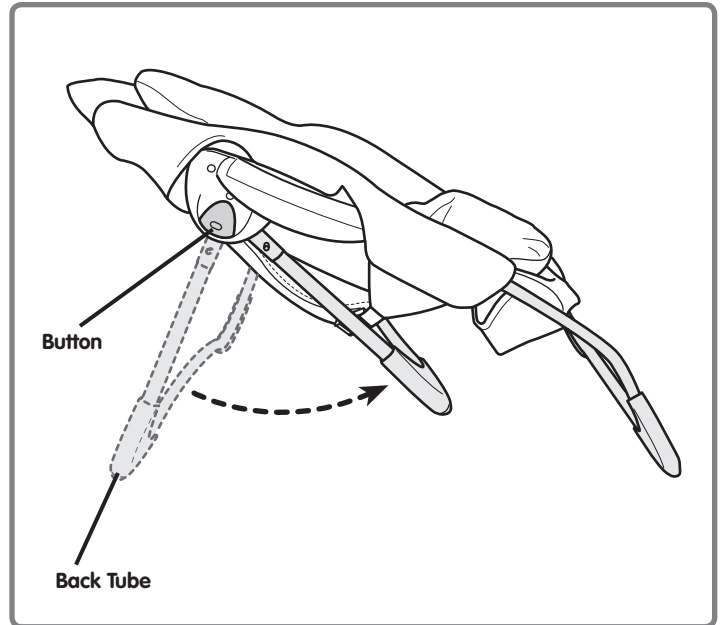

- While pressing the buttons on the handles, push the back tube towards the front tube.

Hint: To set-up this seat again, simply pull the back tube back until it “snaps” into place.

Care

- The pad, butterfly and infant support are machine washable. Wash them separately in cold water on the gentle cycle. Do not use bleach. Tumble dry separately on low heat and remove promptly.
- The frame and toy bar may be wiped clean using a mild cleaning solution and a damp cloth. Do not use bleach. Do not use harsh or abrasive cleaners. Rinse clean with water to remove residue.

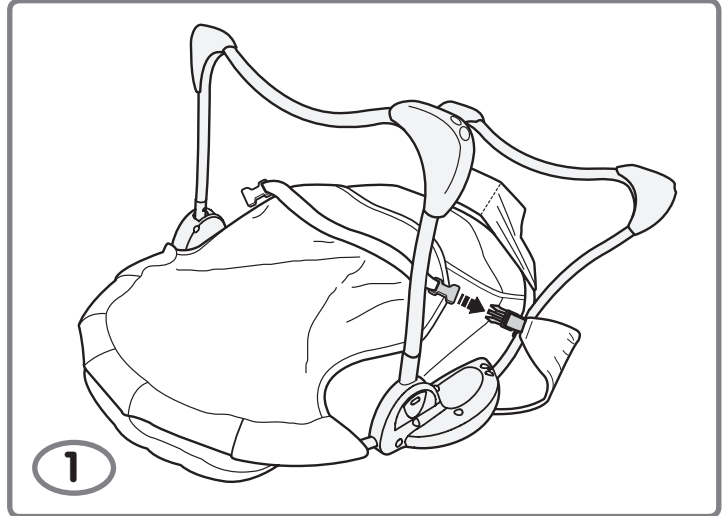

To remove the pad:

- Place the seat face down on a flat surface.
- Unfasten the side buckles.

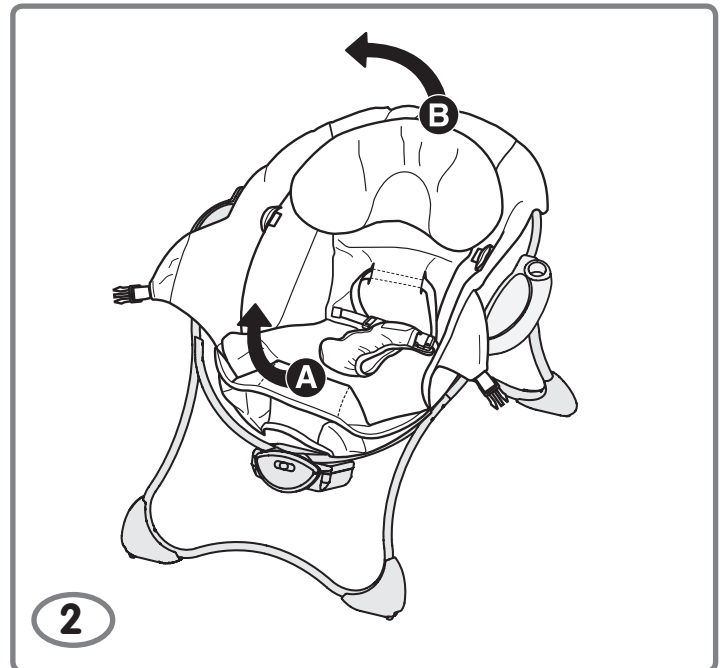

- Turn the seat upright.
- First remove the bottom pocket of the pad **A**. Then, remove the upper pad flap **B**.

To replace the pad, refer to Assembly steps 5 - 6.



www.service.fisher-price.com/uk

01628 500303

GREAT BRITAIN

Mattel UK Ltd, Vanwall Business Park, Maidenhead SL6 4UB. Helpline: 01628 500303; www.service.mattel.com/uk.

AUSTRALIA

Mattel Australia Pty. Ltd., 658 Church Street, Locked Bag #870, Richmond, Victoria 3121 Australia.
Consumer Advisory Service 1300 135 312.

NEW ZEALAND

16-18 William Pickering Drive, Albany 1331, Auckland.

ASIA

Mattel East Asia Ltd, Room 1106, South Tower, World Finance Centre, Harbour City, Tsimshatsui, HK, China.

MALAYSIA

Diimport & Diedarkan Oleh: Mattel SEA Ptd Ltd. (993532-P) Lot 13.5, 13th Floor, Menara Lien Hoe, Persiaran Tropicana Golf Country Resort, 47410 PJ. Tel: 03-78803817, Fax: 03-78803867.

©2007 Mattel, Inc. All Rights Reserved.
® and ™ designate U.S. trademarks of Mattel, Inc.
Fisher-Price, Inc., a subsidiary of Mattel, Inc., East Aurora, New York 14052, U.S.A.

Free Manuals Download Website

<http://myh66.com>

<http://usermanuals.us>

<http://www.somanuals.com>

<http://www.4manuals.cc>

<http://www.manual-lib.com>

<http://www.404manual.com>

<http://www.luxmanual.com>

<http://aubethermostatmanual.com>

Golf course search by state

<http://golfingnear.com>

Email search by domain

<http://emailbydomain.com>

Auto manuals search

<http://auto.somanuals.com>

TV manuals search

<http://tv.somanuals.com>