



V7536



Please keep this instruction sheet for future reference,
as it contains important information.

Lantern requires two "AA" batteries (included)
and one PR4 light bulb (included) for operation.

Adult assembly is required for battery and light bulb replacement.

Tool required for battery and light bulb replacement:
Phillips screwdriver (not included).

Before use, thoroughly wash all parts that may contact food.

www.fisher-price.com

Download from Www.Somanuals.com. All Manuals Search And Download.

Assembling the Lantern

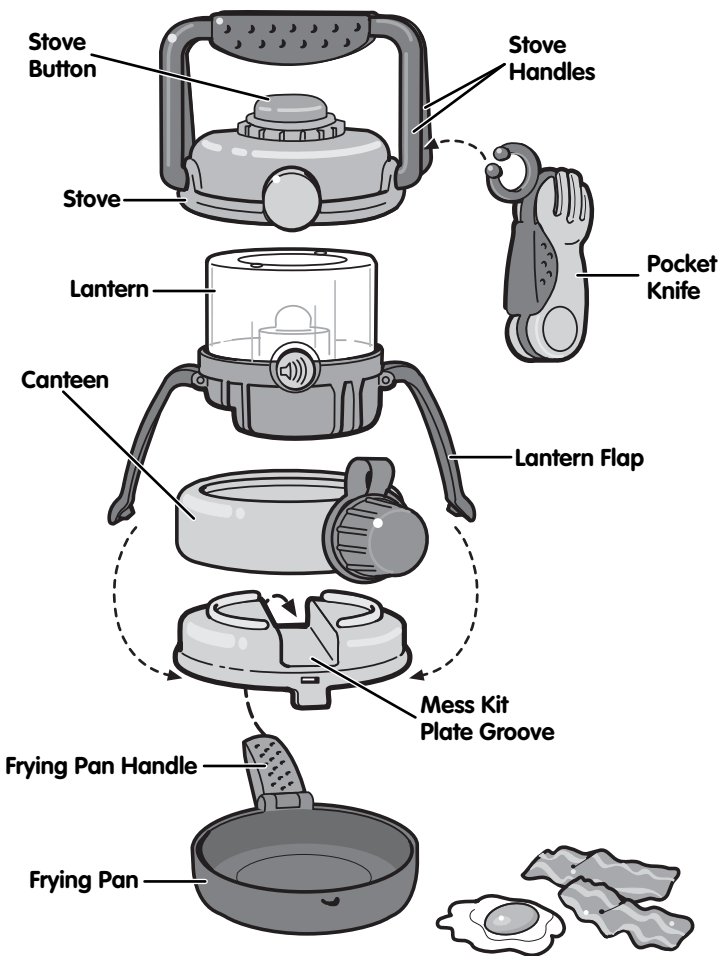

- **Use all of the equipment pieces!**
- Place the frying pan on a flat surface.
- Turn the mess kit plate upside down and fit it onto the frying pan.
- Rotate the frying pan handle up and over to insert it into the groove of the mess kit plate.
- Place the canteen on top of the mess kit plate.
- Unfold the lantern flaps and place the lantern on top of the canteen. Fold the lantern flaps down and **"snap"** each flap onto the edge of the mess kit plate.
- Turn the stove upside down and fit it on top of the lantern.

Hint: To remove the stove from the lantern assembly, press and hold the stove button. Lift to remove the stove from the lantern.

- **"Snap"** the pocket knife onto a stove handle.

Battery Replacement

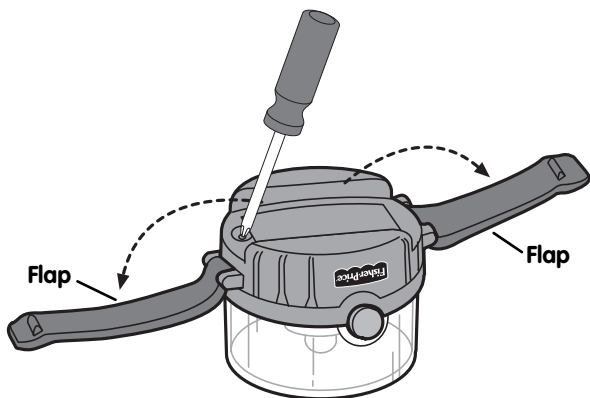

For best performance, we recommend replacing the batteries that came with this toy with two, new "AA" (LR6) alkaline batteries.

- Unfold the flaps on the bottom of the lantern to locate the battery compartment.
- Loosen the screw in the battery compartment door with a Phillips screwdriver and remove the battery compartment door.
- Remove the exhausted batteries and dispose of them properly.
- Insert two, new "AA" (LR6) **alkaline** batteries as indicated inside the battery compartment.

Hint: We recommend using **alkaline** batteries for longer battery life.

- Replace the battery compartment door and tighten the screw with a Phillips screwdriver. Do not over-tighten.
- Fold the flaps back over the bottom of the lantern.
- If this toy begins to operate erratically, you may need to reset the electronics. Remove the batteries and replace them.
- When sounds or lights become faint or stop, it's time for an adult to change the batteries.



- Protect the environment by not disposing of this product with household waste (2002/96/EC). Check your local authority for recycling advice and facilities (Europe only).

Battery Safety Information

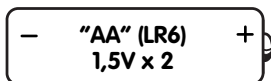

In exceptional circumstances, batteries may leak fluids that can cause a chemical burn injury or ruin your product. To avoid battery leakage:

- Do not mix old and new batteries or batteries of different types: alkaline, standard (carbon-zinc) or rechargeable (nickel-cadmium).
- Insert batteries as indicated inside the battery compartment.
- Remove batteries during long periods of non-use. Always remove exhausted batteries from the product. Dispose of batteries safely. Do not dispose of this product in a fire. The batteries inside may explode or leak.
- Never short-circuit the battery terminals.
- Use only batteries of the same or equivalent type, as recommended.
- Do not charge non-rechargeable batteries.
- Remove rechargeable batteries from the product before charging.
- If removable, rechargeable batteries are used, they are only to be charged under adult supervision.

Using the Lantern

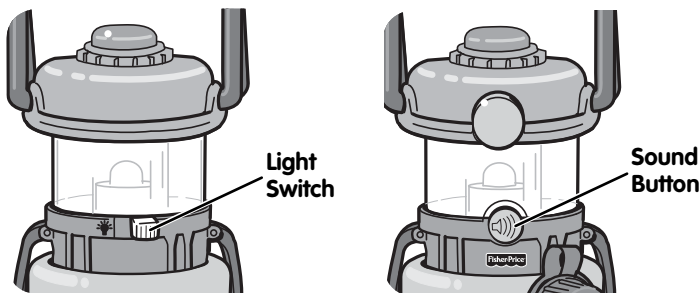

- To turn the lantern on, slide the light switch to the left.
 - To turn the lantern off, slide the light switch to the right.
- Hint:** Light will automatically turn off after approximately 15 minutes.
- Press the sound button to hear real nature sounds.

Let's Go Camping

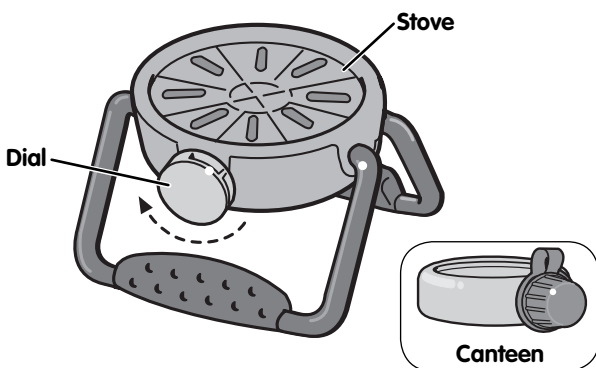

- Turn the stove dial to see the stove “heat up”!
- “Cook” the bacon and eggs over the stove in the frying pan.
- Fill the canteen with water.

Note: Do not use on surfaces that can be damaged by water. Water toys sometimes get messy. Protect play surfaces before use.

Care

- Hand-wash the canteen, pocket knife and mess kit with hot, soapy water before using.
- Drain/rinse/wash and dry the canteen, pocket knife and mess kit thoroughly before storing.
- Wipe the lantern and stove with a clean cloth dampened with a mild soap and water solution.
- Do not immerse the lantern or the stove in water. If moisture does get inside the lantern or the stove, remove the batteries. Allow the lantern or stove to dry several hours before using again.
- This toy has no consumer serviceable parts. Please do not take this toy apart.

Light Bulb (Glass Bulb) Replacement

IMPORTANT! Should the light bulb become non-functional, you are advised to remove it or replace it. This should be carried out away from the child's play area.

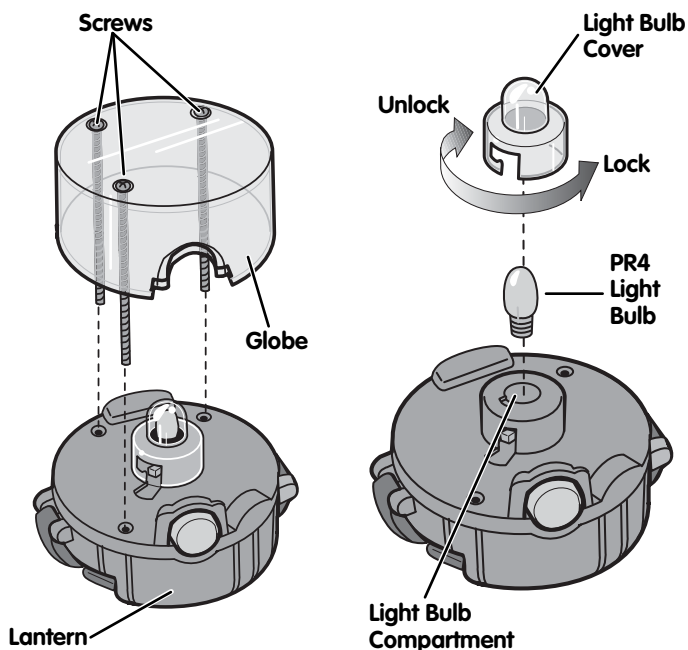

- Loosen the screws in the lantern globe with a Phillips screwdriver.
- Lift to remove the globe from the lantern. The screws will remain in the globe.
- Press down and turn the light bulb cover clockwise to "unlock" the light bulb cover.
- Lift to remove the light bulb cover from the light bulb compartment.
- Pull to remove the light bulb.
- Discard the old light bulb properly. Beware of cracked or broken glass.
- Insert a new PR4 light bulb (or equivalent) into the light bulb compartment.
- Replace the light bulb cover.
- Press down and turn the light bulb cover counter-clockwise to "lock" the light bulb cover.
- Replace the globe onto the lantern and tighten the screws with a Phillips screwdriver. Do not over-tighten.



CONSUMER ASSISTANCE

1-800-432-5437 (US & Canada)
1300 135 312 (Australia)

 service.fisher-price.com

Fisher-Price, Inc., 636 Girard Avenue, East Aurora, NY 14052.
Hearing-impaired consumers: 1-800-382-7470.

Outside the United States:

Canada: Mattel Canada Inc., 6155 Freemont Blvd.,
Mississauga, Ontario L5R 3W2; www.service.mattel.com.

Great Britain: Mattel UK Ltd, Vanwall Business Park,
Maidenhead SL6 4UB. Helpline: 01628 500303.
www.service.mattel.com/uk

Mattel Europa, B.V., Gondel 1, 1186 MJ Amstelveen, Nederland.

Australia: Mattel Australia Pty. Ltd., 658 Church Street,
Locked Bag #870, Richmond, Victoria 3121 Australia.

New Zealand: 16-18 William Pickering Drive,
Albany 1331, Auckland.

FCC Statement (United States only)

This equipment has been tested and found to comply with the limits for a Class B digital device, pursuant to Part 15 of the FCC Rules. These limits are designed to provide reasonable protection against harmful interference in a residential installation. This equipment generates, uses and can radiate radio frequency energy and, if not installed and used in accordance with the instructions, may cause harmful interference to radio communications. However, there is no guarantee that interference will not occur in a particular installation. If this equipment does cause harmful interference to radio or television reception, which can be determined by turning the equipment off and on, the user is encouraged to try to correct the interference by one or more of the following measures:

- Reorient or relocate the receiving antenna.
- Increase the separation between the equipment and receiver.
- Consult the dealer or an experienced radio/TV technician for help.

Note: Changes or modifications not expressly approved by the manufacturer responsible for compliance could void the user's authority to operate the equipment.

This device complies with Part 15 of the FCC Rules. Operation is subject to the following two conditions: (1) this device may not cause harmful interference and (2) this device must accept any interference received, including interference that may cause undesired operation.

ICES-003

This Class B digital apparatus complies with Canadian ICES-003. Operation is subject to the following two conditions: (1) this device may not cause harmful interference and (2) this device must accept any interference received, including interference that may cause undesired operation.

NMB-003

Cet appareil numérique de la classe B est conforme à la norme NMB-003 du Canada. L'utilisation de ce dispositif est autorisée seulement aux conditions suivantes : (1) il ne doit pas produire de brouillage et (2) l'utilisateur du dispositif doit être prêt à accepter tout brouillage radioélectrique reçu, même si ce brouillage est susceptible de compromettre le fonctionnement du dispositif.

Free Manuals Download Website

<http://myh66.com>

<http://usermanuals.us>

<http://www.somanuals.com>

<http://www.4manuals.cc>

<http://www.manual-lib.com>

<http://www.404manual.com>

<http://www.luxmanual.com>

<http://aubethermostatmanual.com>

Golf course search by state

<http://golfingnear.com>

Email search by domain

<http://emailbydomain.com>

Auto manuals search

<http://auto.somanuals.com>

TV manuals search

<http://tv.somanuals.com>