

 **FISHER**

*Studio - Standard*

## 3 - CD AUDIO SYSTEM

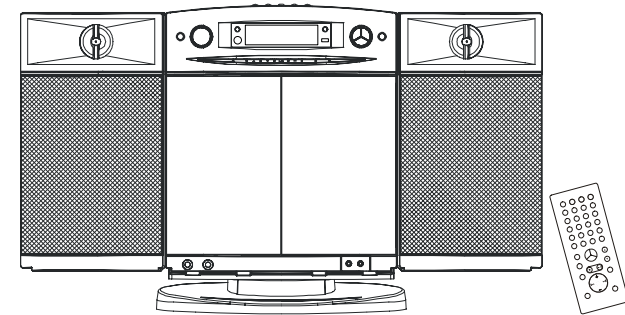

## **INSTRUCTION MANUAL** **SLIM3010**

Thank-you for choosing Fisher. This executive audio system includes a built-in CD player, AM/FM stereo tuner, alarm clock, timer, motorized CD door, removable speakers and remote control. The unit can be wall mounted in order to save desk or counter space.

## SAFETY INFORMATION

|   |  |  |  |  |
|---|--|--|--|--|
|   | <p><b>CAUTION</b><br/>RISK OF ELECTRIC SHOCK<br/>DO NOT OPEN</p> |  |  | <p>This symbol indicates that dangerous voltage constituting a risk of electric shock is present within this unit.</p>                 |
| <p>CAUTION: TO REDUCE THE RISK OF ELECTRIC SHOCK, DO NOT REMOVE COVER. NO USER-SERVICEABLE PARTS INSIDE. REFER SERVICING TO QUALIFIED SERVICE PERSONNEL</p> |  |  |  | <p>This symbol indicates that there are important operating and maintenance instructions in the literature accompanying this unit.</p> |

WARNING: TO AVOID THE HAZARDS OF FIRE OR ELECTRICAL SHOCK, DO NOT EXPOSE THIS APPLIANCE TO RAIN OR OTHER MOISTURE.

CAUTION: TO PREVENT ELECTRICAL SHOCK, MATCH WIDE BLADE OF PLUG TO WIDE SLOT, FULLY INSERT.

## SAFETY CERTIFICATION

This unit is made and tested to meet exacting safety standards. It meets CSA and FCC requirements and complies with safety performance standards of the U.S. Department of Health and Human Services.

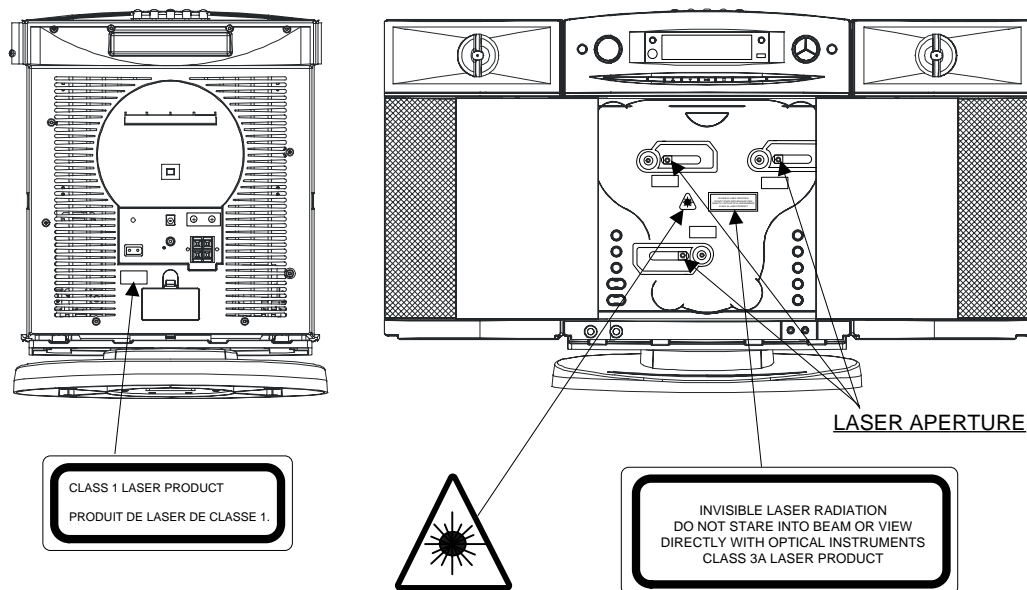

CAUTION - USE OF CONTROLS OR ADJUSTMENTS OR PERFORMANCE OF PROCEDURES OTHER THAN THOSE SPECIFIED HEREIN MAY RESULT IN HAZARDOUS RADIATION EXPOSURE.

## FCC information

**For CD player section:** This device complies with Part 15 of the FCC Rules. Operation is subject to the following two conditions: (1) This device may not cause harmful interference, and (2) this device must accept any interference received, including interference that may cause undesired operation.

## NOTE:

This equipment has been tested and found to comply with the limits for a Class B digital device, pursuant to Part 15 of the FCC Rules. These limits are designed to provide reasonable protection against harmful interference in a residential installation. This equipment generates, uses and can radiate radio frequency energy and, if not installed and used in accordance with the instructions, may cause harmful interference to radio communications. However, there is no guarantee that interference will not occur in a particular installation. If this equipment does cause harmful interference to radio or television reception, which can be determined by turning the equipment off and on, the user is encouraged to try to correct the interference by one or more of the following measures:

- Reorient or relocate the receiving antenna.
- Increase the distance between equipment and receiver.
- Connect the equipment to an outlet on a different circuit from that to which the receiver is connected.
- Consult the dealer or an experienced radio/TV tech.

## FOR SAFE AND EFFICIENT OPERATION

- Do not damage the power cord.
- When not in use, disconnect the power cord from the outlet. Grasp the plug, not the cord, when disconnecting the unit.
- If water should enter the unit, electrical shock or malfunction may result. Use in an area where there is low humidity and little dust.
- Do not disassemble or alter the unit in any way.
- Do not use the unit in areas where extremes in temperature occur (below 40°F or exceeding 95°F), or where it may be exposed to direct sunlight.
- Because of the CD player's extremely low noise and wide dynamic range, there is a tendency to turn the volume on the amplifier higher than necessary. Doing so may produce an excessively high output from the amplifier, which can cause damage to your speakers. Please be careful in this regard.
- Sudden changes in the surrounding temperature can cause dew to form on the optical pickup lens inside unit. Under this condition, the unit may be unable to operate properly. If this should occur, remove the disc and allow the player to adjust to the surrounding temperature.

**WARNING:** Handling the cord on this product or cords associated with accessories sold with this product will expose you to lead, a chemical known to the State or California to cause cancer, and birth defects or other reproductive harm.

**Wash hands after handling.**

# IMPORTANT SAFETY INSTRUCTIONS

1. **Read Instructions** - All the safety and operating instructions should be read before the product is operated.
2. **Retain Instructions** - The safety and operating instructions should be retained for future reference.
3. **Heed Warnings** - All warnings on the product and in the operating instructions should be adhered to.
4. **Follow Instructions** - All operating and use instructions should be followed.
5. **Cleaning** - Unplug this product from the wall outlet before cleaning. Do not use liquid cleaners or aerosol cleaners. Use a damp cloth for cleaning.
6. **Attachments** - Do not use attachments not recommended by the product manufacturer as they may cause hazards.
7. **Water and Moisture** - Do not use this product near water - for example, near a bath tub, wash bowl, kitchen sink, or laundry tub; in a wet basement, or near swimming pool, and the like.
8. **Accessories** - Do not place this product on an unstable cart, stand tripod, bracket, or table. The product may fall, causing serious injury to a child or adult, and serious damage to the product. Use only with a cart, stand, tripod, bracket, or table recommended by the manufacturer, or sold with the product. Any mounting of the product should follow the manufacturer's instructions and should use a mounting accessory recommended by the manufacturer.
9. A product and cart combination should be moved with care. Quick stops, excessive force, and uneven surfaces may cause the product and cart combination to overturn.



PORTABLE CART WARNING  
(symbol provided by RETAC)

10. **Ventilation** - Slots and openings in the cabinet are provided for ventilation and to ensure reliable operation of the product and to protect it from overheating, and these openings must not be blocked or covered. The openings should never be blocked by placing the product on a bed, sofa, rug, or other similar surface. This product should not be placed in a built-in installation such as a bookcase or rack unless proper ventilation is provided according to manufacturer's instructions.
11. **Power Sources** - This product should be operated only from the type of power source indicated on the marking label. If you are not sure of the type of power supply to your home, consult your product dealer or local power company. For products intended to operate from battery power, or other sources, refer to the operating instructions.

# IMPORTANT SAFETY INSTRUCTIONS

12. **Grounding or Polarization** - This product may be equipped with a polarized alternating current line plug (a plug having one blade wider than the other). This plug will fit into the power outlet only one way. This is a safety feature. If you are unable to insert the plug fully into the outlet, try reversing the plug. If the plug should still fail to fit, contact your electrician to replace your obsolete outlet. Do not defeat the safety purpose of the polarized plug.
13. **Power-Cord Protection** - Power supply cords should be routed so that they are not likely to be walked on or pinched by items placed on or against them, paying particular attention to cords at plugs, convenience receptacles, and the point where they exit from the product.
14. **Lightning** - For added protection for this product during a lightning storm, or when it is left unattended and unused for long periods of time, unplug it from the wall outlet. This will prevent damage to the product due to lightning and power-line surges.
15. **Overloading** - Do not overload wall outlet, extension cords, or integral convenience receptacles as this can result in a risk of fire or electric shock.
16. **Object and Liquid Entry** - Never push objects of any kind into this product through openings as they may touch dangerous voltage points or short-out parts that could result in a fire or electric shock. Never spill liquid of any kind on the product.
17. **Servicing** - Do not attempt to service this product yourself as opening or removing covers may expose you to dangerous voltage or other hazards. Refer all servicing to qualified service personnel.
18. **Damage requiring Service** - Unplug this product from the wall outlet and refer servicing to qualified service personnel under the following conditions:
  - a) When the power-supply cord or plug is damaged,
  - b) If liquid has been spilled, or objects have fallen into the product,
  - c) If the product has been exposed to rain or water,
  - d) If the product does not operate normally by following the operating instructions, adjust only those controls that are covered by the operating instructions as an adjustment of other controls may result in damage and will often require extensive work by a qualified technician to restore the product to its normal operation.
  - e) If the product has been dropped or damaged in any way, and
  - f) When the product exhibits a distinct change in performance.

# IMPORTANT SAFETY INSTRUCTIONS

- 19. Replacement Parts** - When replacement parts are required, be sure the service technician uses replacement parts that have been specified by the manufacturer or that have the same characteristics as the original part. Unauthorized substitutions may result in fire, electric shock, or other hazards.
- 20. Safety Check** - Upon completion of any service or repairs to this product, ask the service technician to perform safety checks to determine that the product is in proper operating condition.
- 21. Wall or Ceiling Mounting** - The product should be mounted to a wall or ceiling only as recommended by the manufacturer.
- 22. Heat** - The product should be situated away from heat sources such as radiators, heat registers, stoves, or other products (including amplifiers) that produce heat.
- 23. Nonuse Periods** - Unplug the product's power cord when you will not use it for an extended period.

## CONNECTIONS

### LINE (AUX) IN/OUT CONNECTIONS

Press the LINE (AUX) button (34) to select IN or OUT mode.

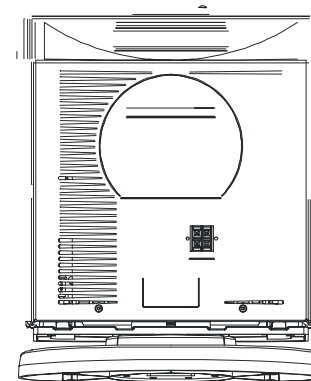
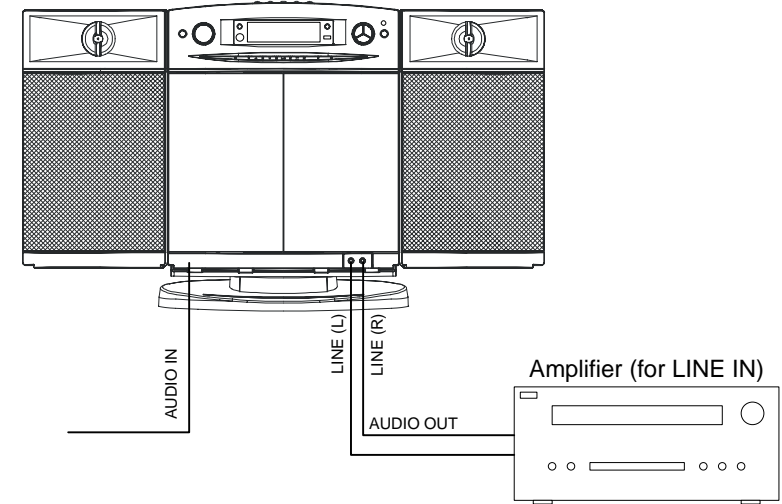

# LOCATION OF CONTROLS - UNIT

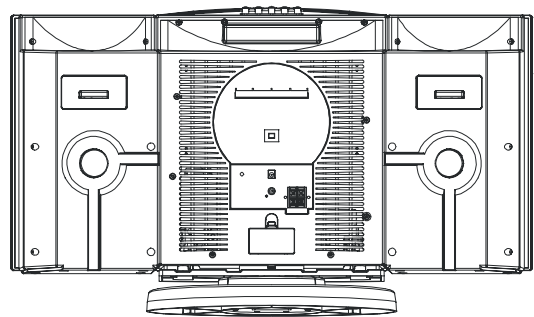
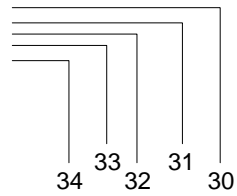
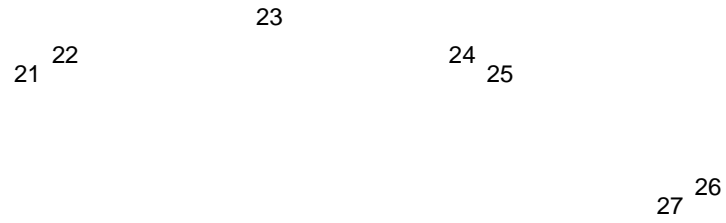
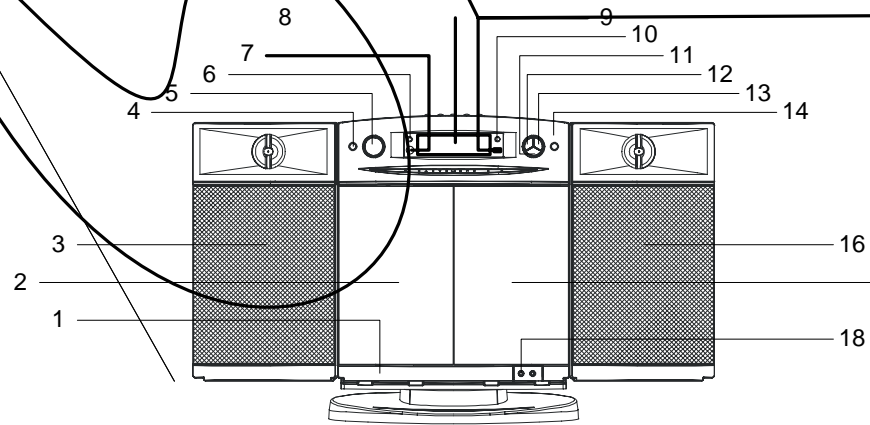

- 35. SURROUND Button**  
Press to turn the surround sound ON or OFF. The indicator lights while surround is ON.
- 36. DYNAMICBASS Button**  
Press for a rich bass sound.
- 37. EQ Button**  
Selects FLAT, POP, ROCK, JAZZ and DISCO sound effects
- 38. STEREO Button**  
Stereo / mono switching for FM stations
- 39. PRESET/REPEAT Button**  
-Retrieve preset radio stations (Forward)  
-Repeats track / 1 disc / all discs for CD mode
- 40. 3 CD Changer Compartment**
- 41. CD-TUNER-SKIP ►► Button**  
-Manual tuning, station search (Forward)  
-CD forward title selection, forward search operation
- 42. CD-TUNER-SKIP ◄◄ Button**  
-Manual tuning, station search (Backward)  
-CD reverse title selection, reverse search operation
- 43. MP3 MODE Button**  
Selects MP3 TITLE & ARTIST or ALBUM
- 44. AC Socket**  
Main power connection

- 45. Subwoofer Jack**  
To connect powered subwoofer (not supplied)
- 46. DC 14V Jack**  
Connects to CAR/BOAT adapter
- 47. AM Antenna**  
AM antenna connection socket (connect frame antenna included in this package)
- 48. Wall Mounting Holder - Center unit**  
Used to mount the center unit on a wall
- 49. Wall mounting Holder - R-Speaker**  
Used to mount the R-speaker on a wall
- 50. Wall mounting Holder - L-Speaker**  
Used to mount the L-speaker on a wall
- 51. Reset Switch**  
If the system does not display information, or the data appearing is wrong, press the "RESET" switch with a sharp object, e.g. needle or ballpoint pen. The data must then be re-entered.
- 52. FM Antenna**  
Note - Do not connect to external antenna
- 53. Speaker Terminal**
- 54. Battery Compartment**  
Batteries (3 x 1.5V "AA" size) for power back-up of time and programmed radio stations.

**NOTE:**  
If the system is connected to the power voltage, part of the machine is in operation due to the stand-by function. In order to switch off the system completely, pull out the power plug from the power socket.

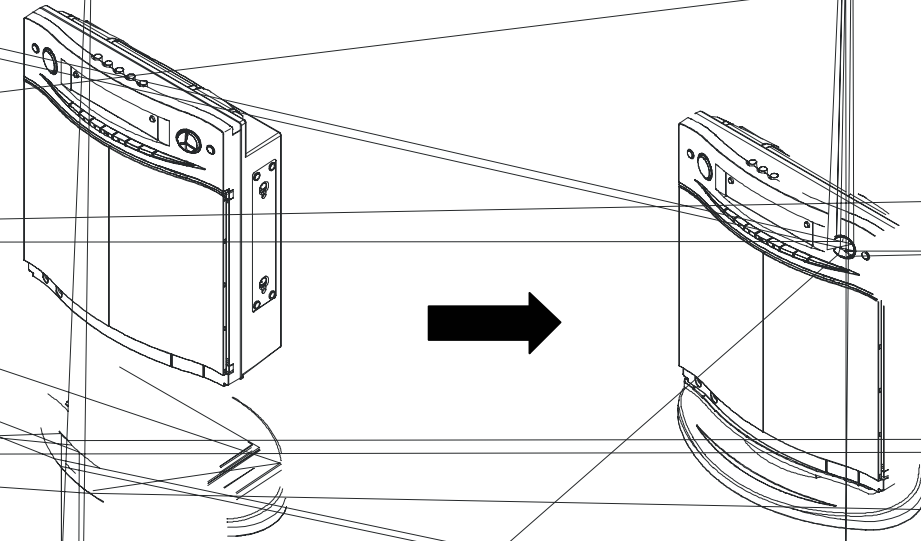

**DISASSEMBLE PEDESTAL**

1. Press down both side of safety lock ribs (3) then push forward slightly (4) at the same time.
2. Hold onto the unit (5) then push forward (6) again carefully to release the unit from the pedestal.

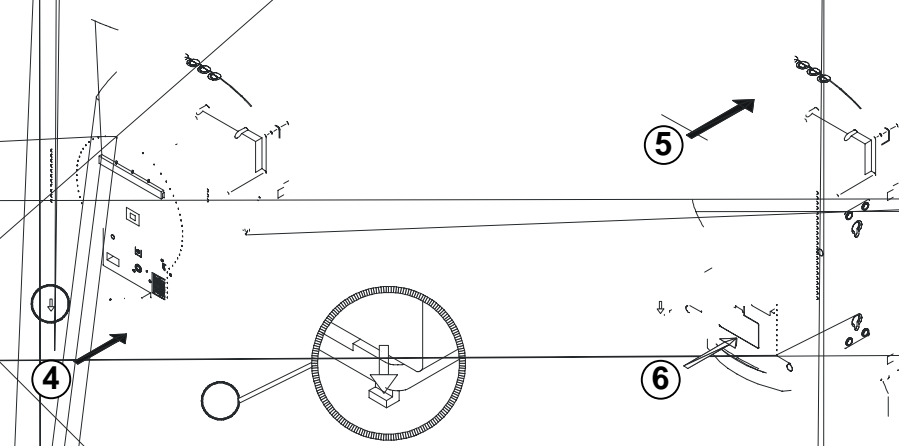

# INSTALLATION (Speakers)

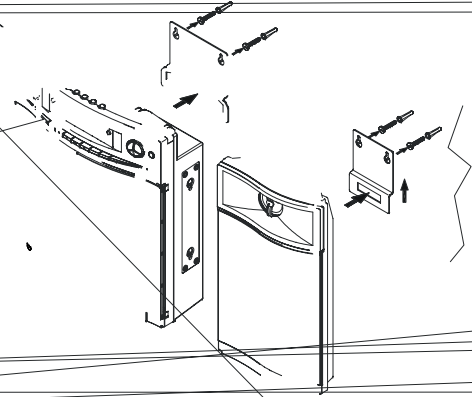
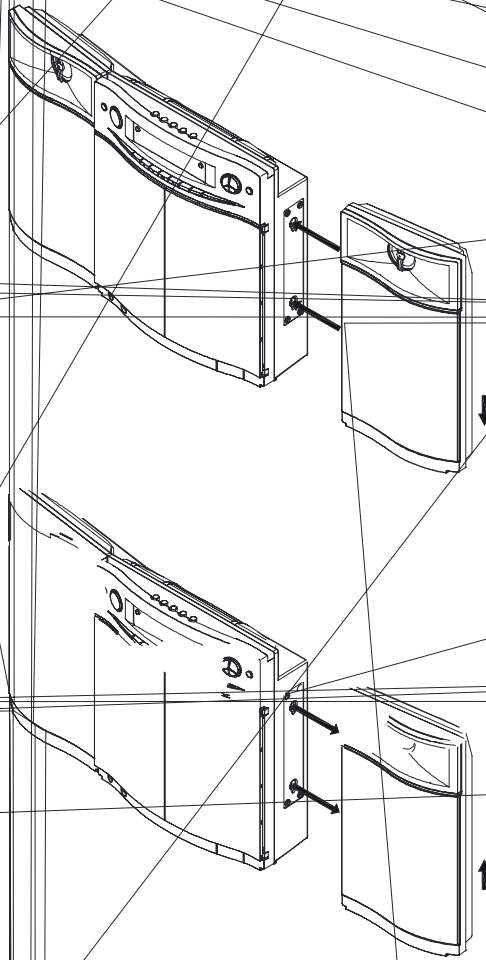

## REMOTE CONTROL (Battery Installation)

1. Remove battery tray by pressing point (1a) inside then sliding point (1b) area at the same time.
2. Pull out the battery tray.
3. Install or replace the button type battery "CR2032".
4. Close the battery tray.

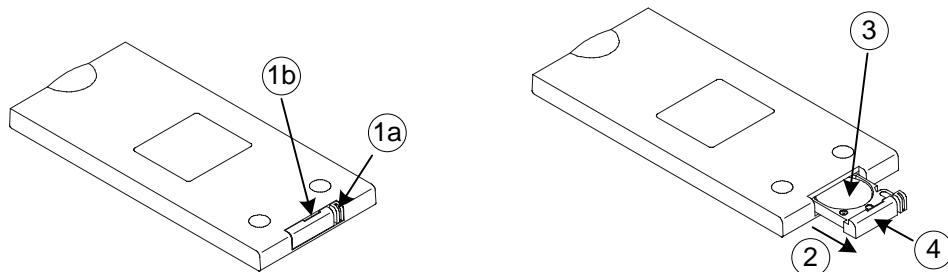
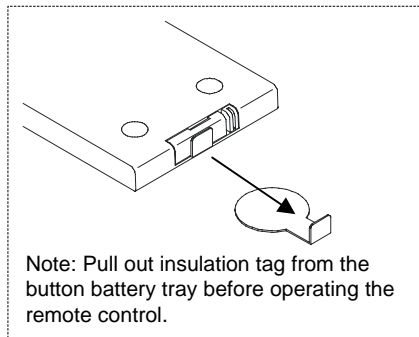

## LOCATION OF CONTROLS - REMOTE CONTROL

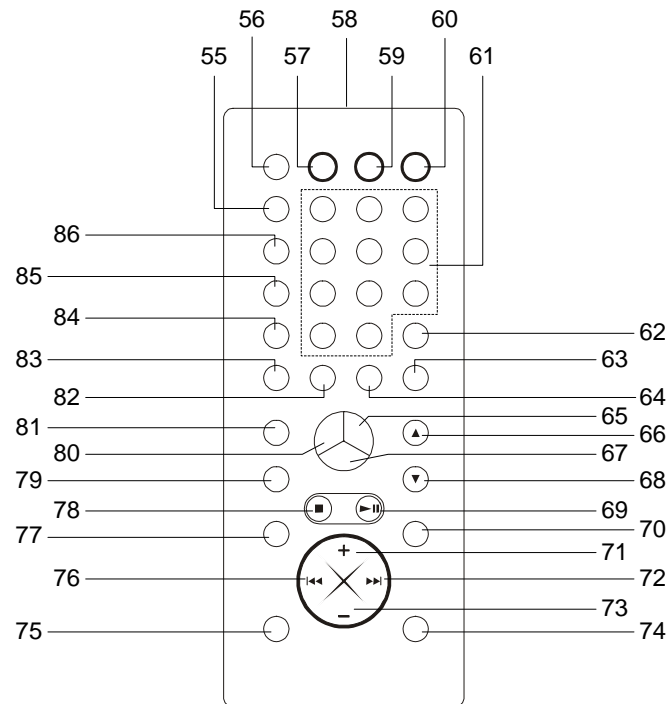

13

## LOCATION OF CONTROLS - REMOTE CONTROL (Cont.)

55. **TIMER Button**  
Activates/deactivates the timer
56. **CD Door OPEN/CLOSE Button**  
Opens the door while the unit is on. Other operating elements now become accessible, and you can insert or remove CDs.
57. **MOOD LIGHT Button**  
Press to turn on soft lighting from the CD door.
58. **Remote Control Transmitter**
59. **EQ Button**  
Selects FLAT, POP, ROCK, JAZZ and DISCO sound effects
60. **POWER ON/STANDBY Button**  
Switches the system on or off
61. **1 - 9, 0/+10 NUMERIC Buttons**  
Recalls TUNER preset stations / recalls CD tracks
62. **MEM/PGM Button**  
For tuner memory / CD program
63. **MP3 MODE Button**  
Selects title & artist or album in MP3 mode
64. **REPEAT Button**  
Repeats 1 track / 1 disc / all discs in CD mode
65. **DISC-2 Button**  
Press to play CD tray-2
66. **ST/MO / FOLDER ▲ Button**  
-Stereo/Mono switching for FM stations  
-Selects MP3 album (Forward)
67. **DISC-3 Button**  
Press to play CD tray-3
68. **FOLDER ▼ Button**  
Selects MP3 album (reverse)
69. **▶▶ PLAY/PAUSE Button**  
To play CD, start CD playback / short interruption of CD playback
70. **MUTE Button**  
Mutes the sound
71. **VOLUME (+) Button**  
Increases volume
72. **CD / TUNER SKIP ▶▶▶ Button**  
-Manual tuning up to stations, station search operation (Forward)  
-CD forward title selection, forward search operation
73. **VOLUME (-) Button**  
Reduces volume
74. **DYNAMICBASS Button**  
Press for a rich bass sound
75. **SURROUND Button**  
Press to turn the surround sound ON or OFF. The indicator lights while surround is ON.
76. **CD / TUNER SKIP ◀◀◀ Button**  
-Manual tuning down to stations, station search operation (Backward)  
-CD backward title selection, backward search operation
77. **TUNER / BAND Button**  
Activates TUNER mode and selects the reception band
78. **■ STOP Button**  
Interrupting the CD playback / clearing the CD programme

14



## LOCATION OF CONTROLS - REMOTE CONTROL (Cont.)

### 79. SLEEP Button

Press for sleep to music

### 80. CD selection - Disc 1 Button

Press to access disc 1

### 81. SNOOZE Button

Switches off the unit for 9 minutes while timer is on. The unit will then start again.

### 82. MODE Button

Toggles the display contents

### 83. INTRO Button

Plays 10 seconds of each CD track

### 84. RANDOM Button

CD play in random sequence

### 85. PRESET Button

Press to retrieve preset radio stations (Forward)

### 86. LINE Button

Activates operating mode LINE

## POWER SUPPLY

Take the cord out and connect it.

### NOTE:

This unit is equipped with a polarized plug. If you have difficulty inserting the plug, turn it over and reinsert it.

### CAUTION:

TO PREVENT ELECTRICAL SHOCK, MATCH WIDE BLADE OF PLUG TO WIDE SLOT, FULLY INSERT.

AC power operation

## BATTERY SUPPLY (For Tuner/Clock Memory Back-up)

Install batteries (not supplied).  
Observe + and - signs.

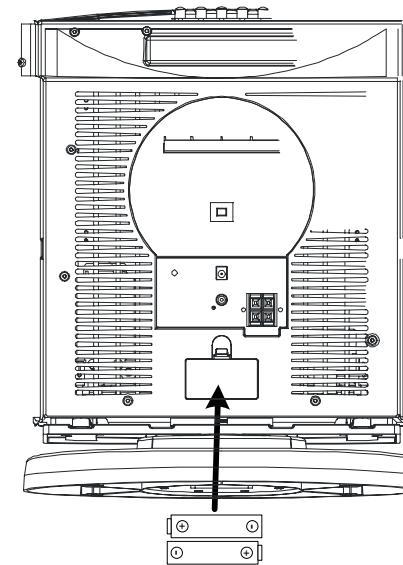

Remember to replace the battery compartment lid  
3 "AA" size batteries

### IMPORTANT NOTE:

**SPENT OR DISCHARGED BATTERIES MUST BE RECYCLED OR DISPOSED OF PROPERLY IN COMPLIANCE WITH ALL APPLICABLE LAWS. FOR DETAILED INFORMATION, CONTACT YOUR LOCAL COUNTRY SOLID WASTE AUTHORITY.**

### CAUTION:

WHEN INSTALLING BATTERIES

To prevent leakage from the batteries, (leakage is corrosive and can cause personal injury and damage to the unit) observe the following precautions:

1. The batteries must be installed correctly. Match the polarities (+ and - signs) on the batteries, to the polarities shown on the battery compartment of the unit (see above).
2. Do not mix new batteries with old or used batteries.
3. Only use batteries of the same type and brand.
4. If the unit will not be used for an extended period of time, remove the batteries and store them in a cool place.
5. Carefully follow the battery manufacturer's instructions for proper use and disposal.
6. **DO NOT ALLOW YOUNG CHILDREN TO HANDLE BATTERIES.**

# OPERATING INSTRUCTIONS

## POWER ON/OFF

When the AC power is connected, the clock shows on the LCD display.

1. Press the POWER button to turn the unit 'ON'.

Note: The LCD display lights up.

2. You can now select your desired music source by pressing one of the function buttons: TUNER/BAND or CD PLAY/PAUSE or AUX.

Example : FM mode



3. To switch to POWER OFF, press the POWER button.

The LCD display backlit goes off.

NOTE: Please turn off the unit to standby mode before disconnecting main power supply from the unit.

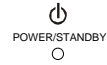

## SETTING THE TIME

When the unit is first connected to AC power, the display shows "AM 12:00". To set the clock to the current time proceed as follows:

1. With unit at off mode, press the MEM/PROG button once, the hour digits begin to flash.

MEMORY



2. Press the SKIP Forward or Backward buttons to adjust the hour. Be sure to set the hour correctly for AM or PM.

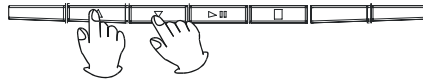

3. Press the MEM/PROG button again, the minute digits begin to flash.

MEMORY



4. Press the SKIP Forward or Backward buttons to adjust the minute.

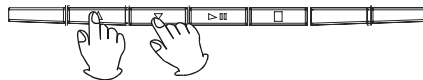

5. Press the MEM/PROG button once more, the display stops flashing and the clock begins to run.

MEMORY



## TIMER ON/OFF SETTING

NOTE: The clock should be set before the Timer On/Off setting.

1. With unit at off mode, press the TIMER button once, the TIMER ON indicator begins to flash.
2. Press the MEMORY/PROGRAM button once, the hour digits begin to flash.
3. Press the SKIP forward or backward buttons to adjust the hour. Be sure to set the hour correctly for AM or PM.
4. Press the MEMORY/PROGRAM button again, the minute digits begin to flash.
5. Press the SKIP forward or backward buttons to adjust the minute.
6. Press the MEMORY button once more, the timer on setting is finished.

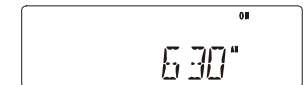
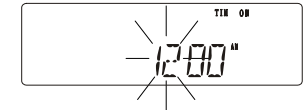
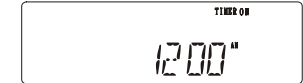

10. Press the MEMORY button again, the minute digits begin to flash.

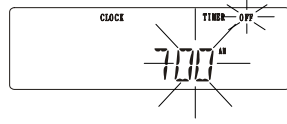

11. Press the SKIP forward or backward buttons to adjust the minute.

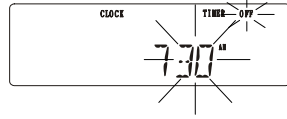

12. Press the MEMORY button once more, the timer off setting is finished.

Note: Timer "OFF" indicator will stop flashing after about 3 seconds and then goes off.

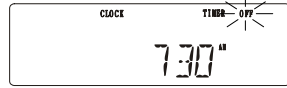

13. To cancel the timer on setting, press the TIMER button until "TIMER" display goes off.

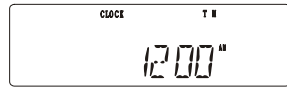

### SLEEP SETTING

Pressing the SLEEP button permits settings from 00 minutes to 120 minutes. When the desired time appears, releasing your finger will set the time. (Pressing "SLEEP" after the 120-minute position will cancel the sleep timer)

### Change of SLEEP

## LISTENING TO THE RADIO

1. Press the POWER button to turn the system 'ON'.
2. Press the TUNER/BAND button to select the radio function.



Example : FM mode



4. Press the SKIP forward or backward buttons to tune to the desired station.



Manual Tuning - Press and hold the SKIP forward/backward buttons until the display approaches your desired station. Then tap the buttons repeatedly until the display shows the exact frequency.

Auto tuning - Press the TUNING forward or backward buttons momentarily and release. The tuner will move up or down to the next available station.

3. Press the TUNER/BAND button repeatedly to select AM or FM band.

5. When finished listening, press the POWER/STANDBY button to shut the system OFF.

## STORING PRESET STATIONS

1. Tune to the station you wish to store.



The unit enables you to randomly preset 16 stations for FM and 16 stations for AM band.

2. Press the MEMORY button once.

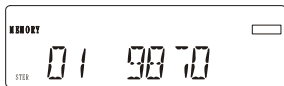

4. Press the MEMORY button again. The station is stored in channel 2.

3. Press the PRESET/REPEAT button repeatedly to set the desired preset station number.

5. To store other stations, repeat above steps.

### RECALLING PRESET STATION

Press the PRESET/REPEAT button repeatedly to select the desired station.

PRESET/  
REPEAT



## STEREO / MONO Function

Repeatedly pressing the button "ST / MO" switches between stereo and mono reception. The stereo reception of a station in the FM band is indicated on the display.

In the case of stereo stations with a bad reception (noise infested reception) we recommend switching the tuner to mono reception. Press the "ST / MO" button. In the display, the STEREO indicator disappears in mono mode.

## To repeat a track or disc

Press REPEAT button on remote control:

*Press once for one track repeat*



*Press twice to repeat all tracks in playing disc*



*Press three times to repeat tracks in all discs*



---

## Random play function

Press RANDOM button on remote control in stop condition to start random play. Press once again to cancel the function.

*Random playing start*

## Intro play function

In stop condition, press the INTRO button on remote control. After that the first 10 seconds of each song will be played. If the INTRO button is pressed again, the CD will change to normal playing mode.

*Intro playing*

Note: Random play can not operate while playing programmed tracks.

---

## PROGRAMMED PLAYBACK

The CD player enables you to program up to 40 tracks in a sequence of your choice. First select CD stop mode.

1. Press the MEMORY button on remote control one time.  
*Program input mode*
2. Press the SKIP forward or backward buttons to select the desired track to be programmed.
3. Press the MEMORY button again, then track 4 is stored.
4. Continue to program, repeat steps 2 and 3.
5. Press PLAY/PAUSE button to play the program tracks.

Note: If the program function has stopped with MEMORY indicator displayed, press the PLAY/PAUSE button, the program play will start.

## Clear the program

In stop mode, press the STOP button once, the MEMORY indicator will go off and the preset programs will be cancelled.

## PROGRAMMED PLAYBACK

The MP3 player enables you to program up to 40 tracks in a sequence of your choice. First select CD stop mode.

1. Press the MEMORY button on remote control once.

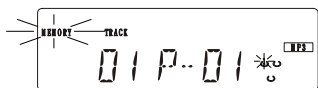

2. Press the SKIP ◀◀ or ▶▶ buttons or Numeric buttons on remote control to select your desired track.

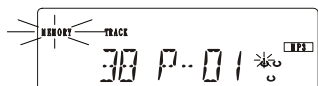

3. Press the MEMORY button again to store the selected track. (for example, track 38 shown below)



4. Continue to program, repeating steps 1 to 3.
5. Press PLAY/PAUSE to play the programmed tracks.



Note: If the program function has stopped with MEMORY indicator displayed, press the PLAY/PAUSE button, the program play will start.

### Clear the program

In the stop mode, press the STOP button once, the MEMORY indicator will go off and the preset programs will be cancelled.

## CARE AND MAINTENANCE

### COMPACT DISC CARE

- Treat the disc carefully. Handle the disc only by its edges. Never allow your fingers to come in contact with the shiny, unprinted side of the disc.
- Do not attach adhesive tape, stickers etc., to the disc label.
- Clean the disc periodically with soft, lint-free, dry cloth. Never use detergents or adhesive cleaners to clean the disc. If necessary, use a CD cleaning kit.
- If disc skips or gets stuck on a section of the disc, it is probably dirty or damaged (scratched).
- When cleaning the disc, wipe in straight lines from the centre of the disc to the edge of the disc. Never wipe in a circular motion.
- To remove a disc from its storage case, press down on the centre of the case and lift the disc out, holding it carefully by the edges.
- Fingerprints and dust should be carefully wiped off the disc's recorded surface with a soft cloth. Unlike conventional records, compact discs have no grooves to collect dust and microscopic debris, so gently wiping with a soft cloth should remove most particles.



### CLEANING THE UNIT

- To prevent fire or shock hazard, disconnect your unit from the AC power source when cleaning.
- The finish on the unit may be cleaned with a dust cloth and cared for as other furniture. Use caution when cleaning and wiping the plastic parts.
- If the cabinets become dusty, wipe them with a soft dry dust cloth. Do not use any wax or polish sprays on the cabinets.
- If the front panel becomes dirty or smudged with fingerprints it may be cleaned with a soft cloth slightly dampened with a mild soap and water solution. Never use abrasive cloths or polishes as these will mar the finish of your unit.

Caution: never allow any water or other liquids to get inside the unit while cleaning.

# TROUBLESHOOTING GUIDE

Should this unit exhibit a problem, check the following before seeking service.

| Symptom  | Possible cause                          | Solution                                      |
|--|---|---|
| <b>Radio</b><br>Noise or sound distorted on AM or FM broadcasts. | Station not tuned properly for AM or FM | Retune the AM or FM broadcast station.        |
|  | FM: Line antenna is not extended.       | Extend FM line antenna.                       |
|  | AM: Unit is not positioned correctly.   | Rotate unit until best reception is obtained. |
| FM STEREO indicator does not light                               | FM MODE button is set to MONO position. | Set FM MODE to FM STEREO position.            |
| AM or FM, no sound.  | TUNER Function button is not pressed.   | Press TUNER function button.                  |
|  | Volume at minimum                       | Increase Volume.                              |

### Compact Disc Player

|   |   |   |
|---|---|---|
| CD Player will not play.  | CD Function button is not pressed.            | Press the CD Function button.             |
|   | CD is not installed or installed incorrectly. | Insert CD with label side out.            |
| CD skips while playing.   | Disc is dirty or scratched.                   | Wipe disc with cloth or use another disc. |
| Disc is inserted but CD player skips over spot and will not play, | Disc inserted upside down.                    | Insert disc properly.                     |
|   | Disc is dirty.                                | Clean disc.                               |
|   | Disc is non-standard.                         | Use correct disc.                         |

## SPECIFICATIONS

|                               |  |                |  |
|-------------------------------|--|----------------|--|
| AC Power                      | AC 120V, 60Hz  | CD Section     | Vertical Front Loading CD                            |
| Power Output                  | 10 W CH 10% THD  | Speaker System | Woofer: 5 1/4", 4 ohms<br>Tweeter: 2", 4 ohms        |
| Dimension of:<br>Main Section | 723(W) x 428(D) x<br>213(H)mm (Approx.)  | Remote Control | 41 Keys, Battery size "CR2032"<br>(Battery included) |
| Radio section                 | Tuning : PLL with 32 Random<br>Preset Memory<br><br>Freq. Range : AM 530-1710KHz<br>FM : 87.5-108MHz |                |  |

## FISHER STUDIO STANDARD MODEL SLIM-3010 LIMITED WARRANTY

### OBLIGATIONS

In order to obtain factory warranty service, call the toll-free number below. The unit must be packed in the original carton or a well padded sturdy carton in order to avoid shipping damage.

**Note:** Do not return this unit to the retail store for service.

To obtain factory warranty service product operation or for problem resolution, call

**Customer Information 1-800-421-6382**

**Weekdays 8:00 AM -5:00 PM Pacific Time**

**THIS WARRANTY IS VALID ONLY ON FISHER PRODUCTS PURCHASED AND USED IN THE UNITED STATES OF AMERICA.**

THIS WARRANTY APPLIES ONLY TO THE ORIGINAL RETAIL USER, AND DOES NOT APPLY TO PRODUCTS USED FOR ANY INDUSTRIAL, PROFESSIONAL OR COMMERCIAL PURPOSE. THE ORIGINAL DATED BILL OF SALE OR SALES SLIP MUST BE SUBMITTED AT THE TIME WARRANTY SERVICE IS REQUESTED.

Subject to the OBLIGATIONS above and EXCLUSIONS below, SANYO FISHER COMPANY (SFC) warrants this FISHER product against defects in materials and workmanship for the periods of LABOR and PARTS specified below. SFC will repair or replace (at its option) the product and any of its parts which fail to conform to this warranty with new or reconditioned products or parts.

This warranty period commences on the date the product was first purchased at retail.

|                |                |
|----------------|----------------|
| <b>LABOR</b>   | <b>PARTS</b>   |
| <b>90 DAYS</b> | <b>90 DAYS</b> |

### EXCLUSIONS

This warranty does not cover (A) the adjustment of customer-operated controls as explained in the appropriate model's instruction manual, or (B) the repair of any product whose serial number has been altered, defaced or removed.

This warranty shall not apply to the cabinet or cosmetic parts, antenna, knobs, batteries or routine maintenance.

This warranty does not apply to uncrating, setup, installation, removal of the product for repair or reinstallation of the product after repair.

This warranty does not apply to repairs or replacements necessitated by any cause beyond the control of SFC including, but not limited to, any malfunction, defect or failure caused by or resulting from unauthorized service or parts, improper maintenance, operation contrary to furnished instructions, shipping or transit accidents, modification or repair by the user, abuse, misuse, neglect, accident, incorrect power line voltage, fire, flood or other Acts of God, or normal wear and tear.

The foregoing is in lieu of all other expressed warranties and SFC does not assume or authorize any party to assume for it any other obligation or liability.

THE DURATION OF ANY WARRANTIES WHICH MAY BE IMPLIED BY LAW (INCLUDING THE WARRANTIES OF MERCHANTABILITY AND FITNESS) IS LIMITED TO THE TERM OF THIS WARRANTY. IN NO EVENT SHALL SFC BE LIABLE FOR SPECIAL, INCIDENTAL OR CONSEQUENTIAL DAMAGES ARISING FROM OWNERSHIP OR USE OF THIS PRODUCT, OR FOR ANY DELAY IN THE PERFORMANCE OF ITS OBLIGATIONS UNDER THIS WARRANTY DUE TO CAUSES BEYOND ITS CONTROL.

SOME STATES DO NOT ALLOW LIMITATIONS ON HOW LONG AN IMPLIED WARRANTY LASTS AND/OR DO NOT ALLOW THE EXCLUSION OR LIMITATION OF CONSEQUENTIAL DAMAGES, SO THE ABOVE LIMITATIONS AND EXCLUSIONS MAY NOT APPLY TO YOU. THIS WARRANTY GIVES YOU SPECIFIC LEGAL RIGHTS. YOU MAY HAVE OTHER RIGHTS, WHICH VARY FROM STATE TO STATE.

For your protection in the event of theft or loss of this product, please fill in the information below for your own personal records.

Model No. \_\_\_\_\_ Serial No. \_\_\_\_\_  
(Located on back or bottom side of unit)  
 Date of Purchase \_\_\_\_\_ Purchase Price \_\_\_\_\_  
 Where Purchased \_\_\_\_\_

## Free Manuals Download Website

<http://myh66.com>

<http://usermanuals.us>

<http://www.somanuals.com>

<http://www.4manuals.cc>

<http://www.manual-lib.com>

<http://www.404manual.com>

<http://www.luxmanual.com>

<http://aubethermostatmanual.com>

Golf course search by state

<http://golfingnear.com>

Email search by domain

<http://emailbydomain.com>

Auto manuals search

<http://auto.somanuals.com>

TV manuals search

<http://tv.somanuals.com>