

HD Vari-Focal (2.8 - 12mm)

YV4.3x2.8SA-2

4.3x Applicable camera (model) 1 2/3 1/2 1/3 1/4 For Security

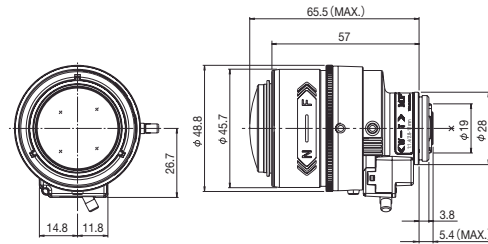

Unit : mm

YV4.3x2.8SA-2

Focal Length (mm)		2.8 - 12 (4.3x)	
Iris Range		F1.4 - Close	
Operation	Zoom	Manual	
	Focus	Manual	
	Iris	Manual	
Angle Of View (HxV)	1/3"	WIDE	100°02' × 74°03'
		TELE	23°26' × 17°36'
	1/4"	WIDE	74°03' × 55°06'
		TELE	17°36' × 13°13'
Angle Of View (HxV)	1/3"	WIDE	109°33' × 60°80'
		TELE	25°31' × 14°23'
Aspect Ratio 16 : 9	1/4"	WIDE	80°56' × 44°51'
		TELE	19°10' × 10°48'
Focusing Range (From Front Of The Lens) (m)		∞ - 0.3	
Object Dimensions at M.O.D. (HxV) (mm)	1/3"	WIDE	753 × 476
		TELE	131 × 98
	1/4"	WIDE	476 × 329
		TELE	98 × 73
Object Dimensions at M.O.D. (HxV) (mm)	1/3"	WIDE	895 × 365
		TELE	143 × 80
	1/4"	WIDE	538 × 260
		TELE	106 × 60
Back Focal Distance (in air) (mm)		7.83	
Exit Pupil Position (From Image Plane) (mm)		455	
Filter Thread (mm)		-	
Mount		CS	
Mass (g)		80	
Remarks		•With Metal Mount	

[Lens Image]

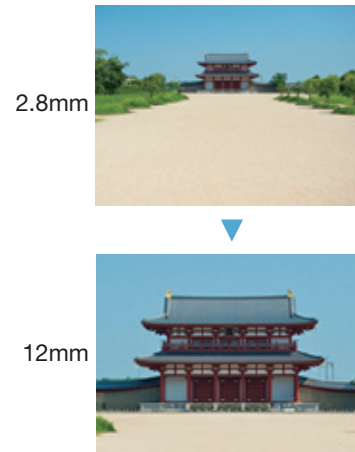

Free Manuals Download Website

<http://myh66.com>

<http://usermanuals.us>

<http://www.somanuals.com>

<http://www.4manuals.cc>

<http://www.manual-lib.com>

<http://www.404manual.com>

<http://www.luxmanual.com>

<http://aubethermostatmanual.com>

Golf course search by state

<http://golfingnear.com>

Email search by domain

<http://emailbydomain.com>

Auto manuals search

<http://auto.somanuals.com>

TV manuals search

<http://tv.somanuals.com>