

nüvi™ 610/660

personal travel assistant



quick reference guide

This guide provides short instructions for various nüvi operations. Fold and keep this guide in the pocket of your nüvi carrying case.

WARNING: See the *Important Safety and Product Information* guide in the product box for product warnings and other important information.

Turning the nüvi On or Off

Press and hold the **Power** button on the top of the nüvi.

Charging the nüvi

To charge the nüvi, use one of the following methods:

- Connect the nüvi to the suction mount and the 12/24-Volt vehicle adapter.
- Connect the USB cable to the nüvi and your computer.
- Connect the AC adapter to the nüvi and a wall outlet (included with the nüvi 660).

Acquiring Satellites

Before the nüvi can find your current location and navigate a route, you must do the following:

1. Go outdoors to an open area, away from tall buildings and trees.
2. Flip up the GPS antenna on the back of the nüvi, so that it is parallel to the ground.
3. Turn on the nüvi. Acquiring satellite signals can take a few minutes.



GPS Antenna Up (Parallel to the Ground)

The bars indicate satellite strength. When the bars are green, the nüvi has acquired satellite signals; now you can select a destination and navigate to it.

Mounting on the Windshield

Check your state and local traffic laws before mounting. Currently, state laws in California and Minnesota prohibit drivers from using suction mounts on their windshields while operating motor vehicles. Other Garmin dashboard or friction mounting options should be used. See the *Important Safety and Product Information* guide for more details.

1. Plug the power cable into the bottom of the mount. Plug the other end into a 12/24-Volt receptacle in your vehicle.
2. Clean and dry your windshield and the suction cup with a lint-free cloth. Place the suction cup on the windshield.
3. Flip the lever back, toward the windshield.
4. Flip up the GPS antenna. Fit the bottom of your nüvi into the cradle.
5. Tilt the nüvi back until it snaps into place.
6. If you are using a traffic receiver in Europe, secure the traffic antenna and suction cups to the windshield.

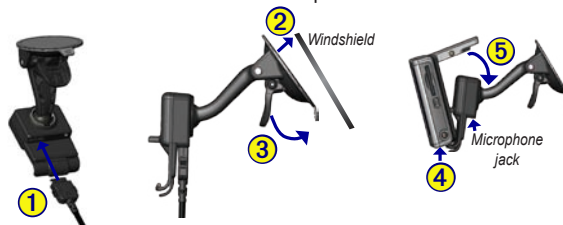

To remove the nüvi from the cradle, press the small tab on the bottom of the cradle up, and tilt the top of the nüvi forward.

Do not leave your GPS unit exposed in an unattended vehicle on a hot day. To prevent damage, remove it from the vehicle; or store it out of direct sunlight, such as in the glove box. See the specifications in the owner's manual.

Download from www.somanuals.com. All Manuals Search And Download.

Finding Your Destination

1. On the Menu page, touch **Where to?**
2. Search for your destination. Touch the arrows for more.
3. When you select your destination, touch **Go**.

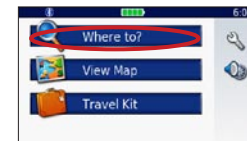

Following Your Route

Follow the route to your destination using the Map page.

- The vehicle icon shows your location.
- Your route is marked with a purple line.
- Follow the arrows as you take turns.
- A checkered flag marks your destination.

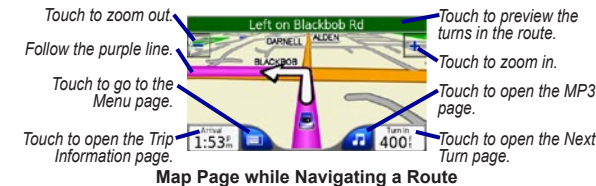

On the Menu page, you can touch **View Map** to open the Map page. Touch and drag the map to view different areas.

Saving Your Current Location

1. On the Map page, touch the vehicle icon.
2. Touch **Save**. The place is saved in **Favorites**.

Saving Places That You Search For

1. After you search for a place you want to save, touch **Save**.
2. Touch **OK**. The place is saved in **Favorites**.

Finding Saved Places

1. On the Menu page, touch **Where to?** > **Favorites**.
2. Select a place.
3. Touch **Go**.

Adding a Stop to Your Route

1. When navigating a route, touch **Where to?** on the Menu page.
2. Search for a location at which you want to stop before your final destination.
3. Touch **Go**.

Taking a Detour

1. When navigating a route, touch **Detour** on the Map page.
2. Touch **Detour**.

Stopping the Route

1. When navigating a route, touch **Stop** on the Map page.
2. Touch **Stop**.

Tips and Shortcuts

- To quickly return to the Menu page, touch and hold **Back**.
- Touch and to see more choices. Touch and hold an arrow to scroll faster.
- To extend the battery life, close the GPS antenna when you do not need GPS signals. You can also decrease the brightness.
- To adjust the audio or brightness, quickly press and release the **Power** button. You can also touch on the Menu page.
 - To adjust the volume or brightness, touch or .
 - To prevent accidental screen taps, touch **Lock**. To unlock the screen, press the **Power** button.
- To switch the audio output between the nüvi and an FM stereo (where available), quickly press the **Power** button twice.
- To learn more about the nüvi Bluetooth® technology or Travel Kit features, touch **Help** on the appropriate screen.

Locking Your nüvi

To help prevent theft of the nüvi, apply the Garmin Lock™ sticker to the inside of a vehicle window, and do the following:

- Flip up the GPS antenna.
- On the Menu page, touch **Settings > System**.
- Touch the button next to **Garmin Lock**. Touch **OK**.
- Enter a four-digit PIN. Touch **Yes** to accept the PIN.
- Touch **OK**. Drive to a security location, and touch **Set**.
- Each time you turn on the nüvi, enter the four-digit PIN or drive to the security location (with the antenna up).

NOTE: If you forget your PIN and your security location, you must send your nüvi to Garmin to get it unlocked.

Using Hands-Free Features

Hands-free phone features on the nüvi are available only if your phone supports that feature using Bluetooth technology (for example, phone book, voice dial, and call waiting). To use the hands-free features, you must pair your phone and the nüvi.

Pairing Your Phone Using the nüvi Settings

- Confirm that your phone is supported by the nüvi. (See www.garmin.com/bluetooth.)
- On the Menu page, touch **Settings > Bluetooth**.
- Ensure that the Bluetooth button is set to **Enabled**.
- Touch **Add** (or **Change**, if you already added).
- If adding, set your phone to **Find Me/Discoverable** mode, and touch **OK** on the nüvi. Select your phone on the list. Enter passkey **1234** on your phone, when prompted.

OR

If changing, select your phone and touch **OK**, or touch **Add Device** and **OK**.

- If the pairing is successful, the Phone icon appears on the nüvi Menu page.

Calling a Number

- Ensure that your phone is paired with the nüvi.
- On the Menu page, touch **Phone > Dial**.
- Enter the number, and touch **Dial**.
- To end the call, touch , and then touch **End Call**.

If you are calling a number that requires that you enter information using a keypad during the call (for example, entering a password for your voicemail), do the following:

- During the call, touch **> Call Options > Touch Tones**.
- Enter the information. Touch **Back** twice, when finished.
- To end the call, touch **End Call**.

Calling a Place

- Ensure that your phone is paired with the nüvi.
- On the Menu page, touch **Phone > Food, Hotels**.
- Search for the place that you want to call.
- Touch **Dial**.
- To end the call, touch , and then touch **End Call**.

Receiving a Call

- Ensure that your phone is paired with the nüvi.
- When you receive a call, a message appears on the nüvi. Touch **Answer**.
- To end the call, touch , and then touch **End Call**.

Using Call Waiting

If you get a call waiting call, the nüvi displays a message. Touch **Answer**. The first call is put on hold.

To switch between calls:

- During the call, touch **> Switch To**.
- Touch **End Call** to hang up; this does not disconnect the call on hold.

Using the Travel Kit

The Travel Kit includes several functions that are helpful when you are traveling (for example, MP3 Player, Audible Book Player, and Currency Converter). On the Menu page, touch **Travel Kit**. Touch the arrows to view more items. Touch **Help** to learn more about each feature.

Using Traffic Features

If you are using a traffic receiver, and you are receiving traffic data, on the Menu page, touch to display a list of traffic incidents.

The Map page displays or in the lower-right corner when there is a traffic incident on your current route or road. Touch or , select an item to view details, and then touch **Avoid**.

Using the FM Transmitter

If an FM transmitter is available on your nüvi 660, you can listen to your nüvi audio on an FM stereo.

Listening to the nüvi on an FM Stereo

- On the Menu page, touch **> Audio Output > FM Transmitter > OK**.
- If you are using a traffic receiver, touch **Auto Tune**. Then tune your stereo to the selected channel.

OR

If you are not using a traffic receiver, select an FM channel that has a lot of static. Then select the same channel on the nüvi.

Switching between the nüvi and an FM Stereo

- On the Menu page, touch **> Audio Output**.
- Touch an output mode, and touch **OK**.

Resetting the nüvi

If the nüvi screen stops functioning, turn the nüvi off and on again.

If this does not help, do the following:

- Disconnect the nüvi from external power.
- Flip up the GPS antenna.
- Press the **Reset** button.
- Connect the nüvi to a power source. The nüvi should automatically turn back on and operate normally.

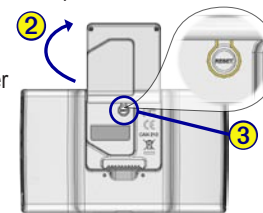

More Information

For more information about the nüvi, refer to the *nüvi 610/660 Owner's Manual* in one of the following locations:

- Included in the box on CD-ROM.
- Go to www.garmin.com/products/nuvi610 or www.garmin.com/products/nuvi660; click **Manuals**, and then select **Download**. You must have Adobe Reader installed on your computer to view this manual.

For information about accessories, go to www.garmin.com/products/nuvi610 or www.garmin.com/products/nuvi660. You can also contact your Garmin dealer to purchase nüvi accessories.

Garmin® is a registered trademark, and nüvi™ is a trademark of Garmin Ltd. or its subsidiaries and may not be used without the express permission of Garmin. The Bluetooth® word mark and logos are owned by the Bluetooth SIG, Inc., and any use of such name by Garmin is under license.

Free Manuals Download Website

<http://myh66.com>

<http://usermanuals.us>

<http://www.somanuals.com>

<http://www.4manuals.cc>

<http://www.manual-lib.com>

<http://www.404manual.com>

<http://www.luxmanual.com>

<http://aubethermostatmanual.com>

Golf course search by state

<http://golfingnear.com>

Email search by domain

<http://emailbydomain.com>

Auto manuals search

<http://auto.somanuals.com>

TV manuals search

<http://tv.somanuals.com>