

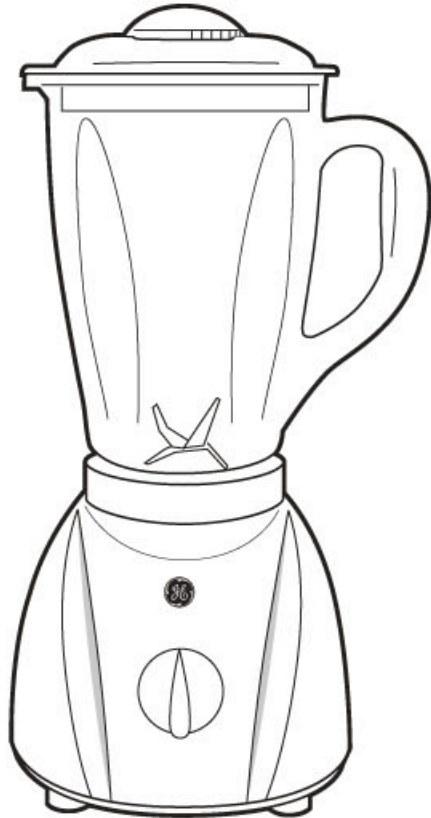

# Blender



**Item Stock Number**  
**GE168942**  
*UPC:*  
*681131689427*

<b>Blender Safety .....</b>	<b>2</b>	<b>How to Clean.....</b>	<b>7</b>
<b>Know Your Blender .....</b>	<b>5</b>	<b>Recipes.....</b>	<b>8</b>
<b>How to Assemble and Use.....</b>	<b>6</b>		

[www.gehousewares.com](http://www.gehousewares.com)

**For Customer Assistance Please Call: 1-877-207-0923**

840079000

# *Blender Safety*

## **IMPORTANT SAFEGUARDS**

When using electrical appliances basic safety precautions should always be followed including the following:

1. Read all instructions.
2. To protect against risk of electric shock, do not put cord, plug, or blender base in water or other liquid.
3. Close supervision is necessary when any appliance is used by or near children.
4. Unplug from outlet when the appliance is not in use, before putting on or taking off parts, and before cleaning.
5. Avoid contacting moving parts.
6. Do not operate any appliance with a damaged cord or plug or after the appliance malfunctions, or is dropped or damaged in any manner. Return appliance to the nearest authorized service facility for examination, repair or electrical or mechanical adjustment.
7. The use of attachments, including canning jars, not recommended by the manufacturer may cause a risk of injury to persons.
8. Do not use outdoors.
9. Do not let cord hang over edge of table or counter or touch hot surfaces.
10. Keep hands and utensils out of container while blending to reduce the risk of severe injury to persons or damage to the blender. A scraper may be used but must be used only when the blender is not running.
11. Blades are sharp. Handle carefully.
12. To reduce the risk of injury, never place cutter-assembly blades on base without jar properly attached.
13. Always operate blender with cover in place.
14. When blending hot liquids, remove fill cap from lid.
15. Do not place on or near a hot gas or electric burner or in a heated oven.

16. To disconnect, turn the control to “OFF”, then remove plug from wall outlet.
17. Do not use appliance for other than intended use.

## **SAVE THESE INSTRUCTIONS**

### **THIS BLENDER IS FOR HOUSEHOLD USE ONLY**

**Note:** A short power supply cord is provided to reduce the risk of personal injury resulting from becoming entangled in or tripping over a longer cord. Grounding-type 3-wire longer extension cords are available and may be used if care is exercised. If a grounding-type 3-wire extension cord is used, the marked electrical rating of the extension cord shall be at least as great as the electrical rating of the appliance. Do not let the cord hang over the edge of the counter or table where it can be pulled by children or accidentally tripped over.

## GROUNDING INSTRUCTIONS

As a safeguard against electrical shock this appliance must be grounded while in use. The appliance is equipped with a 3-conductor cord and a 3-prong grounding-type plug to fit the proper grounding-type receptacle. The appliance has a plug that looks like sketch A. An adaptor, sketch B, should be used for connecting sketch-A plugs to two prong receptacles. The grounding tab which extends from the adaptor must be connected to a permanent ground such as a properly grounded outlet box as shown in sketch C using a metal screw.

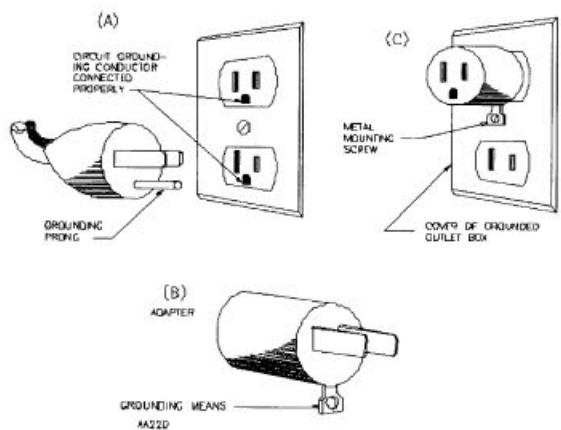

## Know Your Blender Parts and Features

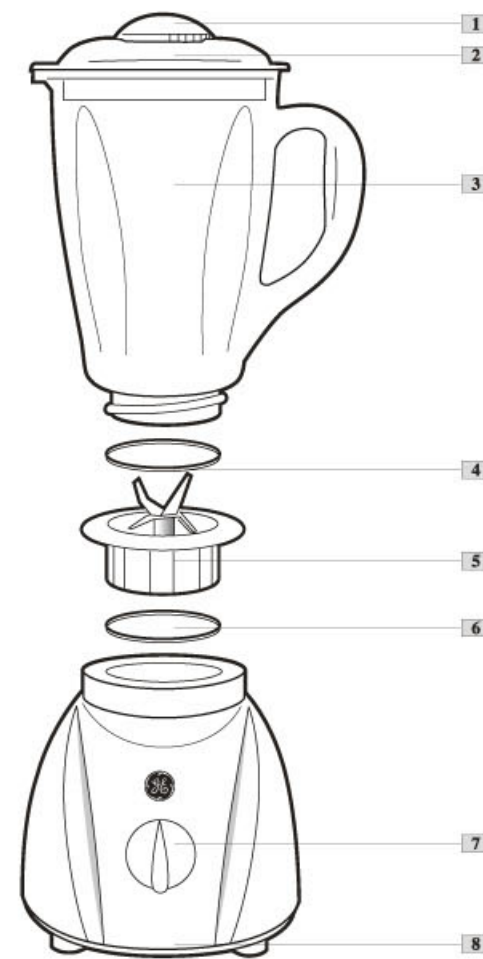

- |                          |                                 |
|--------------------------|---------------------------------|
| 1 Filler Cap             | 2 Lid                           |
| 3 Glass jar              | 4 Jar Gasket                    |
| 5 Cutting Blade Assembly | 6 Cutter Blades Assembly Gasket |
| 7 Power Switch           | 8 Base                          |

**Before First Use:** After unpacking the blender, wash everything except the blender base in hot, soapy water. Dry thoroughly. Wipe the blender base with a damp cloth or sponge. **DO NOT IMMERSE THE BASE IN WATER.** Care should be taken when handling the cutting blades as they are very sharp.

## *How to Assemble and Use*

### **Operating Instructions**

- Before starting, make sure that the blender cord is unplugged and that the power switch, located on the middle of the blender base, is in the OFF position.
- Check the jar to be certain that the cutting blade assembly, jar gasket, and cutting blade assembly gasket are in the proper positions.
  - (1) Cutting blade assembly must be securely tightened to the jar before placing food or liquid in the jar.
  - (2) Tighten the cutting blade assembly by holding the jar upside down and rotating the cutting blade assembly clockwise.
- Place the jar assembly on the blender base so that it is firmly seated and not tilted to one side. Never place the blade assembly on the blender base without the jar being completely assembled and securely tightened.
- Add ingredients to be processed, and place lid on the jar. Be sure lid is fully seated.
- Be sure the power switch is still in the OFF position, and plug the blender into the wall outlet.
- Turn the Speed Control Knob to your desired setting. The speed can be changed at any time during the blending process. For ingredients that require short bursts of power, use PULSE setting.
- Always be sure to switch the power switch to the OFF position when you are not blending.

## *How to Clean*

### **Cleaning**

- Before cleaning, be sure that the unit is off and cord is unplugged from outlet.
- Whenever possible, rinse filler cap and lid immediately after processing to make cleanup easier. Do not immerse the motor base in liquid.
- If washing the jar by hand, wash in hot, soapy water, rinse, and dry thoroughly. If necessary, use a nylon bristle brush to thoroughly clean the jar.
- Do not use rough scouring pads or cleansers on any plastic or metal parts.
- Do not fill the jar with boiling water. Do not place any of the parts in boiling water.
- Do not allow the blade assembly in the jar to soak in water for long periods of time.

**CAUTION – DO NOT IMMERSE THE BASE IN ANY LIQUID**



# Recipes

---

## Ice Crushing

1 cup ice cubes (9 large ice maker cubes)

1. Add ice to blender jar.
  2. Actuate momentary pulse button (2 sec on, 2 sec off)
- 

## Margarita

4-1/2 oz. alcohol  
4 cup ice

15 oz. of margarita mix

1. Add all ingredients to blender jar.
  2. Blend at high speed for 40 seconds.
- 

## Milk Shake

2 cup ice cream  
1/2 tsp vanilla

1/2 cup milk

1. Add all ingredients to blender jar.
  2. Blend at high speed 45 seconds.
- 

## Coffee Grinding

1 cup coffee beans (60g)

1. Measure one cup of coffee beans.
  2. Grind coffee beans for 20 sec at high speed.
- 

## Berry Blast

1 1.5-ounce can berry juice concentrate  
(found in juice aisle)

1 cup frozen strawberries

1 cup ice cubes

1. Place all ingredients to blender jar.
  2. Pulse 45 seconds or until desired consistency. Makes 30 ounces.
- 

## Strawberry Smoothie

2 cups ice cubes  
3 cups fresh strawberries

3 tablespoons sugar  
1/4 cup cranberry juice

1. Place all ingredients in blender jar.
  2. Blend on pulse for 1 minute or until desired consistency.  
Makes 32 ounces.
- 

## Adult Kahlua Shakes

1 cup coffee-flavored liqueur,  
like Kahlua

1 cup milk  
4 scoops chocolate ice cream

1. Place all ingredients in blender jar.
  2. Blend at low speed for 30 seconds or until desired consistency.  
Makes 32 ounces.
- 

## Tropical Icee

1 1.5-ounce can tropical fruit juice  
concentrate

2 bananas, broken into pieces  
2 1/2 cups ice cubes

1. Place all ingredients in blender jar.
  2. Blend on pulse for 1 minute or until desired consistency.  
Makes 48 ounces.
- 

## Salsa

1/2 cucumber, cut into 8 pieces  
1/2 small onion, cut into 4 pieces  
3 spoons of Vinegar  
1 spoon of Lea & Perrings

12 oz. tomatoes (4 pieces each)  
1 clove garlic,  
1/2 green pepper  
few drops of Tabasco

1. Add all ingredients to blender jar.
  2. Run at high speed for 45 seconds.
-

# Customer Assistance

If you have a claim under this warranty, please call our Customer Assistance Number. For faster service please have model, series, and type numbers ready for operator to assist you. These numbers can be found on the bottom of your blender.

**MODEL:** \_\_\_\_\_ **TYPE:** \_\_\_\_\_ **SERIES:** \_\_\_\_\_

**Customer Assistance Number 1-877-207-0923**

**Keep this number for future reference!**

---

## Two-Year Limited Warranty

### What does your warranty cover?

- Any defect in material or workmanship.

### For how long after the original purchase?

- Two years.

### What will we do?

- Provide you with a new unit.
- The exchange unit is warranted for the remainder of your product's original two-year warranty period.

### How do you make a warranty claim?

- Properly pack your unit. We recommend using the original carton and packing materials.
- Include in the package a copy of the sales receipt or other evidence of date of original purchase. If the unit was a gift, provide a statement specifying the date received. Also print your name and address and a description of the defect.
- Return the product to your nearest WAL\*MART store or call Customer Assistance at 1-877-207-0923.

### What does your warranty not cover?

- Glass parts, glass containers, cutter/strainer, blades and/or agitators.
- Commercial use or any other use not found in printed directions.
- Damage from misuse, abuse, or neglect.
- Products purchased or serviced outside the USA.

### How does state law relate to this warranty?

- This warranty gives you specific legal rights, and you may also have other rights which vary from state to state.
- WAL\*MART expressly disclaims all responsibility for consequential damages or incidental losses caused by use of this appliance. Some states do not allow this exclusion or limitation of incidental or consequential losses so the foregoing disclaimer may not apply to you.

### What if you purchased your product in the U.S., Canada or Mexico and encounter a problem while using it outside the country of purchase?

- The warranty is valid only in the country of purchase and if you follow the warranty claim procedure as noted.



is a trademark of  
General Electric Company  
and is used under license by  
WAL\*MART Stores, Inc.  
Bentonville, AR 72716

WAL\*MART Stores, Inc.  
Bentonville, AR 72716

840079000

11/00

## Free Manuals Download Website

<http://myh66.com>

<http://usermanuals.us>

<http://www.somanuals.com>

<http://www.4manuals.cc>

<http://www.manual-lib.com>

<http://www.404manual.com>

<http://www.luxmanual.com>

<http://aubethermostatmanual.com>

Golf course search by state

<http://golfingnear.com>

Email search by domain

<http://emailbydomain.com>

Auto manuals search

<http://auto.somanuals.com>

TV manuals search

<http://tv.somanuals.com>