

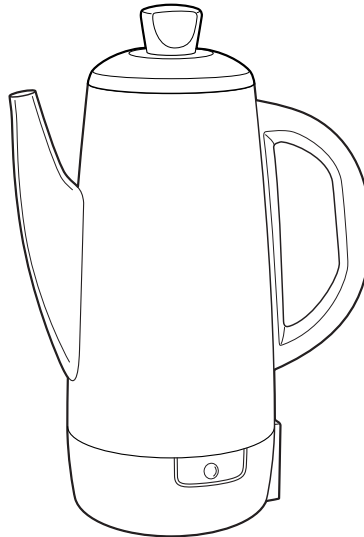

# Percolator Percolateur Percolador



**READ BEFORE USE  
LIRE AVANT L'UTILISATION  
LEA ANTES DE USAR**

840146400

106856R

**For Customer Assistance, call Customer Service at  
1-877-207-0923 (US) or 1-877-556-0973 (Canada)**

**Pour l'assistance à la clientèle au Canada : 1-877-556-0973**

**Para comunicarse con Asistencia al Cliente en México: 01-800-343-7378  
Le invitamos a leer cuidadosamente este instructivo antes de usar su aparato.**

## WARNING

### Shock Hazard

- Do not immerse this appliance in water or other liquid.
- If the plug on this appliance does not fit in your outlet:
  - Do not modify the plug.
  - Do not use an adaptor.
  - Have an electrician replace the obsolete outlet.

## IMPORTANT SAFEGUARDS

When using electric appliances, basic safety precautions should always be followed, including the following:

1. Read all instructions.
2. Do not touch hot surfaces. Use handles or knobs. Care must be taken, as burns can occur from touching hot parts or from spilled, hot liquid.
3. To protect against fire, electric shock, and injury to persons do not immerse cord, plug or any part of the percolator in water or other liquid.
4. Close supervision is necessary when any appliance is used by or near children.
5. Unplug from outlet when the percolator is not in use and before cleaning. Allow to cool before putting on or taking off parts and before cleaning the appliance.
6. Percolator must be operated on a flat surface away from the edge of counter to prevent accidental tipping.
7. Do not operate any appliance with a damaged cord or plug, or after the appliance malfunctions or is dropped or damaged in any manner. Call our toll-free customer assistance number for information on examination, repair, or adjustment.
8. The use of accessory attachments not recommended by the appliance manufacturer may result in fire, electrical shock or injury to persons.
9. Do not use outdoors.
10. Do not let cord hang over edge of table or counter or touch hot surfaces, including the stove.
11. Twist-off lid must be securely in place during the perk cycle and when serving coffee. See instructions on page 5 for more information.
12. Scalding may occur if the lid is removed during the brew cycle.
13. Do not place percolator on or near a hot gas or electric burner or in a heated oven.
14. Always attach plug to appliance first, then plug cord into wall outlet. To disconnect percolator, remove plug from wall outlet, then unplug from percolator.
15. Warning: To reduce the risk of fire or electric shock, do not remove the bottom cover. No user serviceable parts are inside. Repair should be done by authorized service personnel only.
16. Do not use appliance for other than intended use.

## SAVE THESE INSTRUCTIONS!

### Other Consumer Safety Information

**This appliance is intended for household use only.**

The length of the cord used on this appliance was selected to reduce the hazards of becoming tangled in, or tripping over a longer cord. If a longer cord is necessary an approved extension cord may be used. The electrical rating of the extension cord must be equal to or greater than the rating of the percolator. Care must be taken to arrange the extension cord so that it will not drape over the countertop or tabletop where it can be pulled on by children or accidentally tripped over.

To avoid an electrical circuit overload, do not use another high wattage appliance on the same circuit with your percolator.

**To reduce risk of electrical shock, do not immerse the percolator in water.**



2

## PARTS AND FEATURES

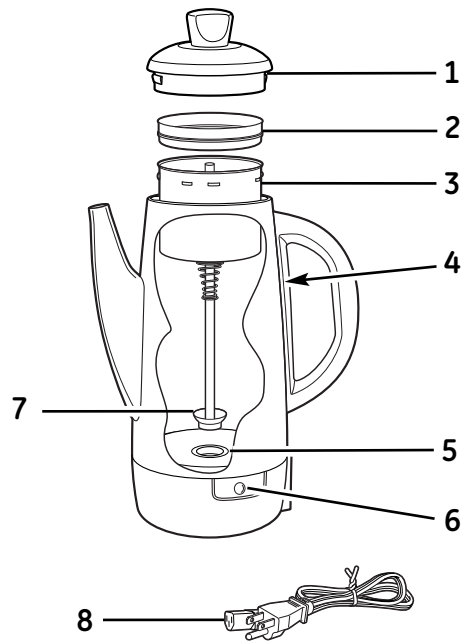
1. Twist-Off Lid
2. Spreader
3. Basket
4. Water Window
5. Heating Well
6. Ready Light
7. Stem
8. Detachable Cord

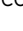

## TWIST OFF LID

- **To remove lid:** Twist lid until unlocked icon  aligns with the black dot above the handle of the percolator. Then gently pull up on lid.
- **To replace lid:** Align unlocked icon  on lid with black dot and gently push lid onto percolator body. Then twist until locked icon  aligns with black dot.

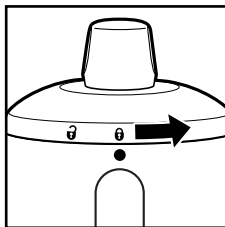

## TO MAKE COFFEE

**Before First Use:** Clean the percolator by following the steps in “How To Clean.”

1. To make coffee, twist lid to unlocked position to remove, then remove the spreader, basket, and stem. Fill with cold water to desired level as indicated by numbered servings on inside of percolator or water window.
2. Wet basket interior to keep small coffee grounds from sifting through basket. Place basket on stem. Hold top of stem and place stem and basket into heating unit well.  
**IF THE STEM IS NOT SEATED PROPERLY IN THE HEATING WELL, THE PERCOLATOR WILL NOT PERK.**
3. Measure percolator-type ground coffee into basket. Avoid getting coffee grounds in the stem. Refer to the Coffee Making Chart that follows. Spread coffee evenly in basket. Place spreader on basket.
4. Place lid onto percolator and twist to the locked position.
5. Plug cord into the percolator then plug the cord into electrical outlet. The unit automatically turns on.
6. The percolator will stop automatically when the coffee has finished brewing, and the Ready light will glow. Allow about one minute per cup for brewing time.
7. The percolator will remain at serving temperature until it is unplugged.
8. When finished serving coffee, unplug the percolator from the electrical outlet. Then remove cord from the percolator.

### WARNING

#### Burn Hazard

- Do not remove Twist-Off Lid until brew cycle is completed and the Ready Light glows.  
Failure to follow this instruction may result in scalding steam escaping and serious personal injury.

## COFFEE MAKING CHART

Water Level	Amount of Ground Coffee
12 cups (3 L)	8 to 12 tablespoons (120-180 ml)
10 cups (2.5 L)	8 to 10 tablespoons (120-150 ml)
8 cups (2 L)	6 to 8 tablespoons (90-120 ml)
6 cups (1.5 L)	5 to 6 tablespoons (75-90 ml)
4 cups (1 L)	4 to 5 tablespoons (60-75 ml)
2 cups (500 ml)	3 tablespoons (45 ml)

**NOTE:** We recommend using coffee that has been ground specifically for use in a **percolator-type** coffee maker, although, coffee marked “For All Coffee Makers” is acceptable. If using a coffee grinder and whole beans, percolator coffee should be a coarse grind. A finely ground coffee may cause the coffee basket to overflow.

## TO HEAT WATER

Use heated water to make instant coffee, hot cocoa, or tea.

1. To heat water, twist lid to unlocked position to remove, then remove the basket and stem. Fill percolator with cold water to desired level as indicated by numbered servings on inside of percolator or water window.
2. Place basket on stem. Hold top of stem and place stem and basket into heating unit well. (Using the stem and basket will speed heating time.) Place spreader on basket.
3. Place lid onto percolator and twist to the locked position. Plug in percolator and let go through complete perk cycle. Water is hot when Ready light glows.

## CLEANING YOUR PERCOLATOR

1. After each use, unplug cord from outlet then remove cord from the percolator. Let cool before cleaning.
2. Twist lid to unlocked position to remove, then remove the basket, spreader, and stem. Wash these in hot, soapy water. (These parts can also be placed in dishwasher.) Do not put percolator in dishwasher.
3. Rinse all parts thoroughly and dry. Store with cover off.

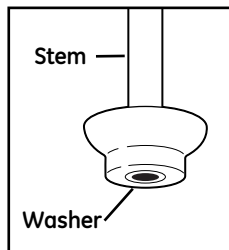

**NOTE:** Make sure the washer at bottom of stem remains loose. If coffee grounds lodge in this area, remove them under running water or with a wooden pick then rinse and dry.

4. Fill the percolator half-full with hot water. Add a drop of liquid dishwashing detergent and wash the inside of the percolator. Use a sponge and clean the inside of the heating unit well. This part must be properly cleaned to maintain the proper operation of the percolator. Do not immerse percolator in water.
5. Drain the soapy water then fill the percolator with hot water to rinse. Pour soapy water through spout to clean the spout. Repeat with another hot water rinse. Dry.
6. Clean outside of percolator with a damp cloth. Do not use abrasive scouring pads or cleansers.

## TO REMOVE MINERAL DEPOSITS AND BUILDUPS

If the percolator is used daily follow these instructions every other week. Fill the percolator with 6 cups (1.5 L) cold water and 6 cups (1.5 L) white vinegar. Assemble with stem, basket, spreader, and lid.

Plug in and let go through the perk cycle. When perking has stopped let sit another 15 minutes. Unplug and drain the percolator. Let cool then clean according to "How To Clean."

## CUSTOMER SERVICE

If you have a claim under this warranty, please call our Customer Assistance Number. For faster service please have model, series, and type numbers ready for operator to assist you. These numbers can be found on the bottom of your appliance.

**MODEL:** \_\_\_\_\_ **TYPE:** \_\_\_\_\_ **SERIES:** \_\_\_\_\_

**Customer Assistance Number 1-877-207-0923 (US) or 1-877-556-0973 (Canada)**

**Keep these numbers for future reference!**

**For more information, please visit us at [www.walmart.com](http://www.walmart.com)**

### Two-Year Limited Warranty

#### What does your warranty cover?

- Any defect in material or workmanship.

#### For how long after the original purchase?

- Two years.

#### What will we do?

- Provide you with a new one.
- For those items still under warranty but no longer available, WAL-MART reserves the right to replace with a similar GE branded product of equal or greater value.

#### How do you make a warranty claim?

- Save your receipt.
- Properly pack your unit. We recommend using the original carton and packing materials.
- Return the product to your nearest WAL-MART store or call Customer Assistance at 1-877-207-0923 (US) or 1-877-556-0973 (Canada)

#### What does your warranty not cover?

- Parts subject to wear, including, without limitation, glass parts, glass containers, cutter/strainer, blades, seals, gaskets, clutches, motor brushes, and/or agitators, etc.
- Commercial use or any other use not found in printed directions.
- Damage from misuse, abuse, or neglect, including failure to clean product regularly in accordance with manufacturer's instructions.

#### How does state law relate to this warranty?

- This warranty gives you specific legal rights, and you may also have other rights which vary from state to state or province to province.
- THIS WARRANTY IS IN LIEU OF ANY OTHER WARRANTY OR CONDITION, WHETHER EXPRESS OR IMPLIED, WRITTEN OR ORAL, INCLUDING, WITHOUT LIMITATION, ANY STATUTORY WARRANTY OR CONDITION OF MERCHANTABILITY OR FITNESS FOR A PARTICULAR PURPOSE.
- WAL-MART, GE, AND THE PRODUCT MANUFACTURER EXPRESSLY DISCLAIM ALL RESPONSIBILITY FOR SPECIAL, INCIDENTAL, AND CONSEQUENTIAL DAMAGES OR LOSSES CAUSED BY USE OF THIS APPLIANCE. ANY LIABILITY IS EXPRESSLY LIMITED TO AN AMOUNT EQUAL TO THE PURCHASE PRICE PAID WHETHER A CLAIM, HOWEVER INSTITUTED, IS BASED ON CONTRACT, INDEMNITY, WARRANTY, TORT (INCLUDING NEGLIGENCE), STRICT LIABILITY, OR OTHERWISE. SOME STATES OR PROVINCES DO NOT ALLOW THIS EXCLUSION OR LIMITATION OF INCIDENTAL OR CONSEQUENTIAL LOSSES SO THE FOREGOING DISCLAIMER MAY NOT APPLY TO YOU.

#### What if you encounter a problem with this product while using it outside the country of purchase?

- The warranty is valid only in the country of purchase and you follow the warranty claim procedure as noted.

## Free Manuals Download Website

<http://myh66.com>

<http://usermanuals.us>

<http://www.somanuals.com>

<http://www.4manuals.cc>

<http://www.manual-lib.com>

<http://www.404manual.com>

<http://www.luxmanual.com>

<http://aubethermostatmanual.com>

Golf course search by state

<http://golfingnear.com>

Email search by domain

<http://emailbydomain.com>

Auto manuals search

<http://auto.somanuals.com>

TV manuals search

<http://tv.somanuals.com>