

4 CUP COFFEE MAKER



Model Number:
169184
UPC: 681131691840

Customer Assistance
1 877 207 0923 (US)
1 877 556 0973 (Canada)



Thank you for purchasing this GE appliance.

In keeping with the GE ecomagination initiative, please consider the option to recycle the packaging material and donate any appliance you are no longer using.

To read more about GE's ecomagination commitment, visit:
ge.ecomagination.com

IMPORTANT SAFEGUARDS

When using electrical appliances, basic safety precautions should always be followed to prevent the risk of fire, electric shock, burns, or other injuries or damages.

- **Read all instructions before use.**
- Do not touch hot surfaces. Use handles or knobs.
- To protect against fire, electrical shock and injury to persons do not immerse cord, plugs, or the appliance in water or other liquids.
- Close supervision is necessary when any appliance is used by or near children.
- Unplug from outlet when not in use and before cleaning. Allow it to cool before putting on or taking off parts and before cleaning the appliance.
- Do not operate appliance with a damaged cord or plug, or after the appliance malfunctions or has been dropped or damaged in any manner. Call our toll-free customer assistance number for information on examination, repair, or adjustment.
- The use of accessory attachments not recommended by the appliance manufacturer may result in fire, electric shock or injuries to persons.
- Do not use outdoors or in a damp area.
- Do not let cord hang over edge of table or counter, or touch hot surfaces.
- Do not place on or near a hot gas or electric burner, or in a heated oven.
- To disconnect the appliance, turn control to "off", then remove plug from wall outlet.
- Do not use this appliance for anything other than its intended use.
- Do not touch the warming plate (8) when the coffee maker is on.
- Scalding may occur if the lid (2) is removed during the brewing cycles.
- Never leave the empty carafe (10) on the warming plate (8) when the coffee maker is on. Otherwise the carafe (10) is liable to crack.
- Do not set a hot container on a cold surface.
- Do not use a cracked container or a container having a loose or weakened handle.
- Do not clean container with cleansers, steel wool pads, or other abrasive material.
- To reduce the risk of fire or electric shock, do not remove the bottom cover on the appliance. No user serviceable parts inside. Call our toll-free customer assistance number for repair.
- The container is designed for use with this appliance. It must never be used on a range top.

SAVE THESE INSTRUCTIONS!

IMPORTANT SAFEGUARDS

- WARNING: Hot Steam.
- CAUTION: To reduce the risk of scalding, do not open lid when coffee is brewing.
- WARNING: To Reduce the Risk of Fire or Electric Shock, Do Not Remove This Cover. No User Serviceable Parts Inside. Call our toll – free customer service number for repair.
- CAUTION: Risk of injury – Replace the carafe within 30 seconds while brewing.

SAVE THESE INSTRUCTIONS!

ADDITIONAL SAFEGUARDS

This appliance is for **HOUSEHOLD USE ONLY**.
DO NOT OPERATE APPLIANCE IF THE LINE CORD SHOWS ANY DAMAGE OR IF APPLIANCE WORKS INTERMITTENTLY OR STOPS WORKING ENTIRELY.

EXTENSION CORDS

A short power-supply cord is to be provided to reduce the risk resulting from becoming entangled in or tripping over a longer cord. Longer detachable power-supply cords or extension cords are available and may be used if care is exercised in their use. If a longer detachable power-supply cord or extension cord is used,

- 1) The marked electrical rating of the cord set or extension cord should be at least as great as the electrical rating of the appliance, and
- 2) The longer cord should be arranged so that it will not drape over the countertop or tabletop where it can be tripped over, snagged, or pulled on unintentionally (especially by children).

POLARIZED PLUG

This appliance has a polarized plug (one blade is wider than the other). To reduce the risk of electric shock, this plug is intended to fit into a polarized outlet only one way. If plug does not fit fully into the outlet, reverse the plug. If it still does not fit, contact a qualified electrician. Do not attempt to modify the plug in any way.

SP
HP
done:
check:

PARTS

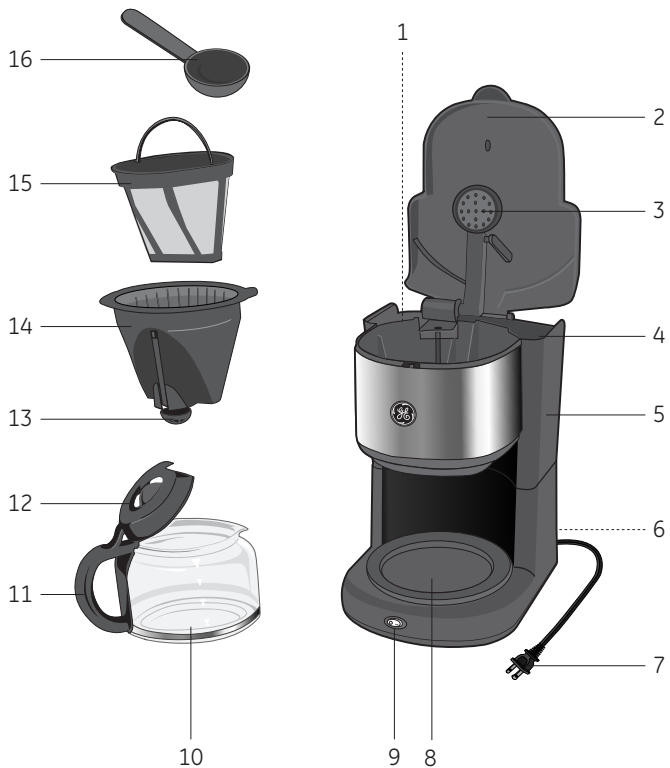

- | | |
|--------------------------|-----------------------------|
| 1. Water-level indicator | 9. On/off switch 0/I |
| 2. Lid | 10. Carafe |
| 3. Drip head | 11. Grip handle |
| 4. Water tank | 12. Carafe lid |
| 5. Housing | 13. Drip stop valve |
| 6. Cord storage | 14. Filter basket |
| 7. Power cord with plug | 15. Permanent filter |
| 8. Warming plate | 16. Measuring spoon |

SP
HP
done:
check:

ILLUSTRATIONS

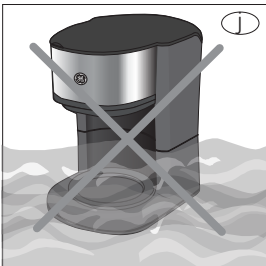
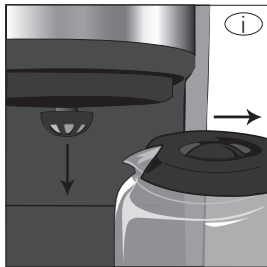
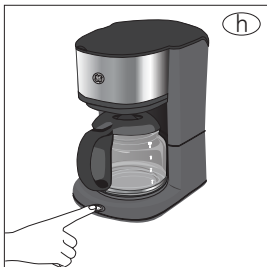
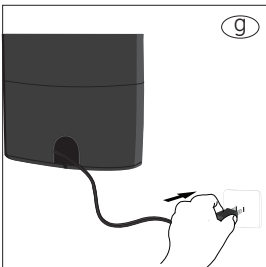
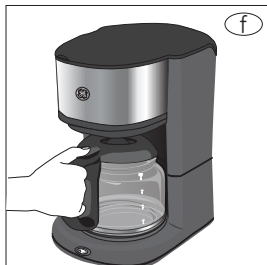
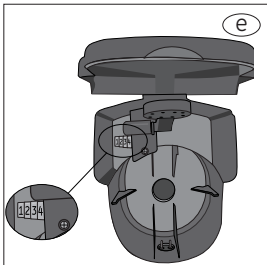
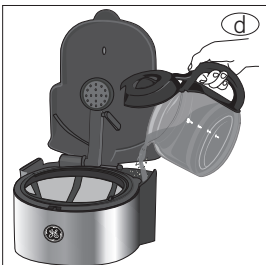
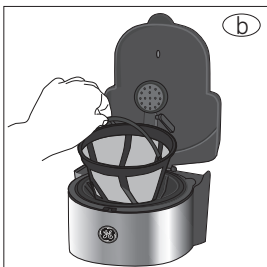
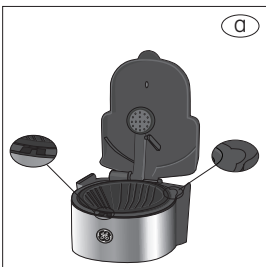

SP
HP
done:
check:

OPERATION

Before first use

- Remove all packaging materials, labels and stickers from the coffee maker.
- Clean the coffee maker thoroughly before using for the first time (*Cleaning*).

NOTE: To remove any residues from the coffee maker fill in fresh water (to the maximum level) and run at least 2 brewing cycles.

Using the coffee maker

Use this coffee maker to brew coffee only.

- Open the lid **(2)** and place the filter basket **(14)** in the coffee maker. Make sure the tab of the filter basket **(14)** fits in the opening of the coffee maker (*ill. (a)*).
- Insert the permanent filter **(15)** or a number 2 cone filter into the filter basket **(14)** (*ill. (b)*). Do not use the permanent filter with a paper filter as water will not flow through the filter basket correctly.
- Add the desired amount of ground coffee into the filter **(15)** (*ill. (c)*). For 4 cups of coffee add 3 to 4 measuring spoons **(16)** of coffee into the filter **(15)**, according to your taste.
- Fill the carafe **(10)** with the desired amount of water.
- Pour the water from the carafe **(10)** into the water tank **(4)** (*ill. (d)*). Check the water level indicator **(1)** inside the water tank **(4)** (*ill. (e)*). Do not overfill the coffee maker.
- Close the lid **(2)** and place the carafe **(10)** on the warming plate **(8)** (*ill. (f)*).
- Remove the power cord from the cord storage **(6)** and insert the power plug **(7)** into a standard 120V AC wall outlet (*ill. (g)*). Press the on/off switch **0/I (9)** to turn the coffee maker on (*ill. (h)*). The on/off switch **0/I (9)** lights blue.
- This coffee maker has a pause and pour function. When removing the carafe **(10)** the drip stop valve will prevent coffee from leaking onto the warming plate **(8)** (*ill. (i)*).
- Hot water continues to flow into the filter basket **(14)** and may overflow if the carafe **(10)** is not returned to the warming plate **(8)** within 30 seconds. Make sure the carafe **(10)** is fully seated on the warming plate **(8)** or returned to the warming plate **(8)** within 30 seconds when using the pause and pour function.
- Brewing process starts automatically. After brewing is finished, the warming plate **(8)** will keep the coffee heated.
- Press the on/off switch **0/I (9)** to turn the coffee maker off. Unplug the coffee maker from the wall outlet when not in use.
- After usage store the cord in the cord storage **(6)**.

WARNING: The coffee maker is hot during operation. Handle hot coffee carefully.

WARNING: ALWAYS TURN COFFEE MAKER OFF WHEN NOT IN USE.

CLEANING

Proper maintenance will ensure years of service from your appliance. Clean the appliance after every use. This appliance contains no user serviceable parts and requires little maintenance. Leave servicing or repairs to qualified personnel.

WARNING: Unplug the appliance and let it cool down completely before cleaning.

CAUTION: Do not immerse the coffee maker, or the power cord with plug (7) into water or any liquids (ill. ①). Do not use abrasive pads or alcohol.

- Remove the carafe (10), the permanent filter (15) and the filter basket (14) from the coffee maker.
- Clean the housing (5) and warming plate (8) with a clean, damp cloth.
- Use baking soda or a mild cleaning agent to remove stains on the carafe (10). If stains are hard to remove, fill the carafe (10) with hot water and add 2 tablespoons of dishwasher detergent. Leave the carafe (10) with the water/detergent mixture overnight and clean afterwards.
- Make sure all parts are completely dry after washing and before use.
- After cleaning, reassemble the coffee maker.

CAUTION: The carafe (10) is dishwasher-safe. Wash carafe (10), carafe lid (12), filter basket (14) and permanent filter (15) in hot, soapy water. Rinse and dry.

NOTE: Do not dry the inside of the water tank (4) with a cloth, as lint may remain.

TROUBLESHOOTING

PROBLEM	CAUSE	SOLUTION
Coffee leaks around filter basket (14) / drip stop valve (13) overflows	Filter basket (14) is not seated correctly or not tightened sufficiently	Insert filter basket (14) correctly
	There are coffee grounds on the edge of filter	Clean around the filter
	Coffee is ground too finely. This will clog the filter	Clean the filter. Use another type of coffee
Coffee maker does not brew or heat	Power cord (7) is not firmly plugged into a power outlet	Insert power plug (7) into a power outlet
Water does not run through	No water in the water tank (4) The filter is blocked or coffee grounds are too fine or tamped down too hard	Fill the water tank (4) Clean the filter and try coarser coffee
Water runs through too quickly	Coffee grounds too coarse	Try finer coffee
Water not absorbed by coffee grounds	Insufficient quantity of ground coffee	Increase quantity of ground

If additional assistance is needed, please contact our Customer Assistance at 1.877.207.0923 (U.S.) or 1.877.556.0973 (Canada).

TECHNICAL DATA

Rated voltage: 120V ~60Hz
 Rated current: 4.75A
 Rated power input: 550W

CUSTOMER ASSISTANCE

If you have a claim under this warranty, please call our Customer Assistance Number. For faster service, please have the model number and product name ready for the operator to assist you. This number can be found on the bottom of your appliance and on the front page of this manual.

Model Number: _____ **Product Name:** _____

Customer Assistance Number 1.877.207.0923 (U.S.) or 1.877.556.0973 (Canada).

Keep these numbers for future reference!

For more information, please visit us at WWW.GEHOUSEWARES.COM

Two-year limited warranty

What does your warranty cover?

- Any defect in material or workmanship.

For how long after the original purchase?

- Two years.

What will we do?

- Provide you with a new one.
- For those items still under warranty but no longer available, WAL-MART reserves the right to replace with a similar GE branded product of equal or greater value.

How do you make a warranty claim?

- Save your receipt.
- Properly pack your unit. We recommend using the original carton and packing materials.
- Return the product to your nearest WAL-MART store or call Customer Assistance at 1-877-207-0923 (U.S.) or 1-877-556-0973 (Canada).

What does your warranty not cover?

- Parts subject to wear, including, without limitation, glass parts, glass containers, cutter/strainer, blades, seals, gaskets, clutches, motor brushes, and/or agitators, etc.
- Commercial use or any other use not found in printed directions.
- Damage from misuse, abuse, or neglect, including failure to clean product regularly in accordance with manufacturer's instructions.

How does state law relate to this warranty?

- This warranty gives you specific legal rights, and you may also have other rights which vary from state to state or province to province.
- This warranty is in lieu of any other warranty or condition, whether express or implied, written or oral, including, without limitation, any statutory warranty or condition of merchantability or fitness for a particular purpose.
- WAL-MART, GE and the product manufacturer expressly disclaim all responsibility for special, incidental, and consequential damages or losses caused by use of this appliance. Any liability is expressly limited to an amount equal to the purchase price paid whether a claim, however instituted, is based on contract, indemnity, warranty, tort (including negligence), strict liability, or otherwise. Some states or provinces do not allow this exclusion or limitation of incidental or consequential losses, so the foregoing disclaimer may not apply to you.

What if you encounter a problem with this product while using it outside the country of purchase?

- The warranty is valid only in the country of purchase and if you follow the warranty claim procedure as noted.



is a trademark of General Electric Company and is used under the license by Wal-Mart Stores Inc., Bentonville, AR 72716

Marketed in Canada by:

Wal-Mart Canada Corp.
1940 Argentia Road, Mississauga,
Ontario L5N1P9

SP
HP
done:
check:

Free Manuals Download Website

<http://myh66.com>

<http://usermanuals.us>

<http://www.somanuals.com>

<http://www.4manuals.cc>

<http://www.manual-lib.com>

<http://www.404manual.com>

<http://www.luxmanual.com>

<http://aubethermostatmanual.com>

Golf course search by state

<http://golfingnear.com>

Email search by domain

<http://emailbydomain.com>

Auto manuals search

<http://auto.somanuals.com>

TV manuals search

<http://tv.somanuals.com>