



PERCOLATOR

PERCOLATEUR / PERCOLADOR

Model Number / Numéro de modèle / Número de Modelo: 169185
UPC: 681131691857

Customer Assistance / Service à la clientèle / Asistencia al Cliente

1 877 207 0923 (US)

1 877 556 0973 (Canada)



Thank you for purchasing a GE small appliance.

In keeping with the GE ecomagination initiative, please consider the option to recycle the packaging material and donate the properly functioning appliance and corresponding Use & Care Guide you are no longer using.

To read more about GE's ecomagination commitment visit:

ge.ecomagination.com

Merci d'avoir acheté ce petit appareil GE.

Afin de poursuivre l'initiative écomagination de GE, veuillez recycler les matériaux d'emballage et faire don d'un appareil fonctionnant adéquatement que vous n'utilisez plus ainsi que le guide d'utilisation et d'entretien.

Pour en savoir plus à propos de l'engagement écomagination de GE, visitez le site :

ge.ecomagination.com

Gracias por comprar un pequeño electrodoméstico de GE.

Siguiendo la iniciativa ecoimaginación de GE, por favor considere la opción de reciclar el material de empaçado y donar el aparato funcionando adecuadamente y la Guía de Cuidado y Uso correspondiente que ya no use.

Para leer más sobre el compromiso de ecoimaginación de GE visite:

ge.ecomagination.com

IMPORTANT SAFEGUARDS

When using electrical appliances, basic safety precautions should always be followed including the following:

- Read all instructions.
- Do not touch hot surfaces. Use handles or knobs. Care must be taken, as burns can occur from touching hot parts or from spilled, hot liquid.
- To protect against fire, electric shock, and injury to persons do not immerse cord, plug or any part of the percolator in water or other liquid.
- Close supervision is necessary when any appliance is used by or near children.
- Unplug from outlet when the percolator is not in use and before cleaning. Allow to cool before putting on or taking off parts and before cleaning the appliance.
- Percolator must be operated on a flat surface away from the edge of counter to prevent accidental tipping.
- Do not operate any appliance with a damaged cord or plug, or after the appliance malfunctions or is dropped or damaged in any manner. Call our toll-free customer assistance number for information on examination, repair, or adjustment.
- The use of accessory attachments not recommended by the appliance manufacturer may result in fire, electrical shock or injury to persons.
- Do not use outdoors.
- Do not let cord hang over edge of table or counter or touch hot surfaces, including the stove.
- Twist-off lid must be securely in place during perk cycle and when serving coffee. See Operation instructions for more information.
- Scalding may occur if the lid is removed during the brew cycle.
- Do not place percolator on or near a hot gas or electric burner or in a heated oven.
- Always attach plug to appliance first, then plug cord into wall outlet. To disconnect percolator, remove plug from wall outlet, then unplug from percolator.
- **WARNING!** To reduce the risk of fire or electric shock, do not remove the bottom cover. No user serviceable parts are inside. Repair should be done by authorized service personnel only.
- Do not use appliance for other than intended use.

SAVE THESE INSTRUCTIONS!

ADDITIONAL SAFEGUARDS

This appliance is for **HOUSEHOLD USE ONLY**. It may be plugged into an AC electrical outlet (ordinary household current).

A short power-supply cord is provided to reduce the risk resulting from becoming entangled in or tripping over a longer cord. Longer detachable power-supply cords or extension cords are available and may be used if care is exercised in their use. If a longer detachable power-supply cord or extension cord is used;

- 1) The marked electrical rating of the cord set or extension cord should be at least as great as the electrical rating of the appliance, and
- 2) The cord should be arranged so that it will not drape over the countertop or tabletop where it can be pulled on by children or tripped over unintentionally.

If the power-supply cord is a grounding-type-3-wire cord with a grounding prong on the plug, the extension cord should also be a grounding-type-3-wire cord.

GROUNDING INSTRUCTIONS

This appliance must be grounded while in use to protect the operator from electrical shock. The appliance is equipped with a 3-conductor cord and a 3-prong grounding-type plug to fit the proper grounding-type receptacle. **WARNING!** Shock Hazard: If the plug on this appliance does not fit in your outlet, do not modify the plug, and do not use an adaptor. Have an electrician replace the obsolete outlet.

ADDITIONAL SAFEGUARDS (CONT.)

CORD SAFETY TIPS

1. Never pull or yank on cord or the appliance.
2. To insert plug, grasp it firmly and guide it into outlet.
3. To disconnect appliance, grasp plug and remove it from outlet.
4. Before each use, inspect the cord for cuts and/or abrasion marks. If any are found, this indicates that the appliance should be serviced and the cord replaced.
5. Never wrap the cord tightly around the appliance, as this could place undue stress on the cord where it enters the appliance and cause it to fray and break.

PARTS

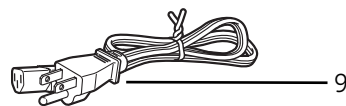
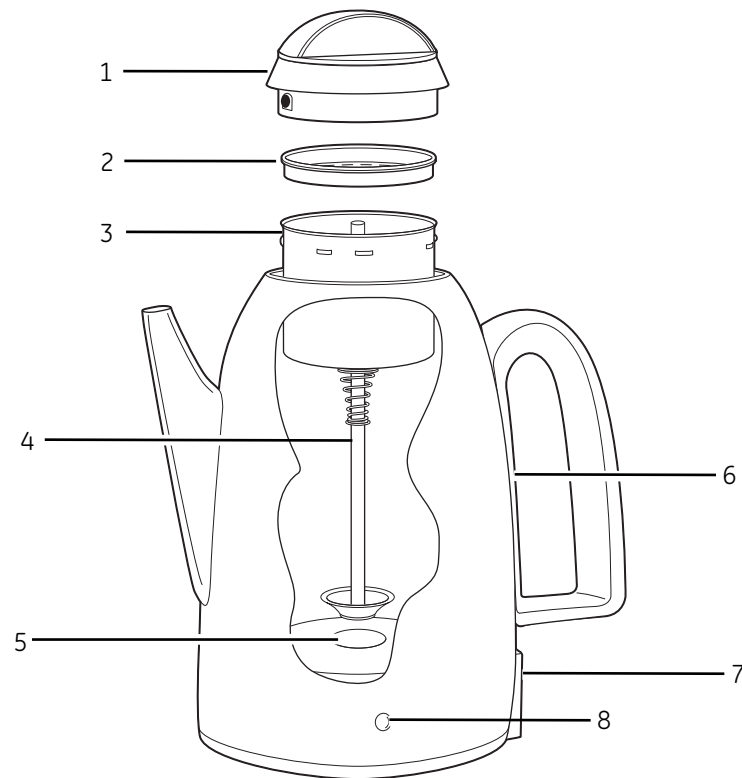

1. Twist-Off Lid
2. Spreader
3. Basket
4. Stem
5. Heating Well
6. Water Window
7. Cord Receptacle
8. Ready Light
9. Detachable Cord

OPERATION

Before first use

- Clean the percolator by following the steps in "How To Clean."

Using the percolator

- To make coffee, remove lid, spreader, basket, and stem. Fill with cold water to desired level as indicated by numbered servings on inside of percolator. Do not fill beyond MAX or grounds can overflow into coffee.
- Wet basket interior to keep small coffee grounds from sifting through basket. Place basket on stem. Hold top of stem and place stem and basket into heating unit well. **IF THE STEM IS NOT SEATED PROPERLY IN THE HEATING WELL, THE PERCOLATOR WILL NOT PERCOLATE.**
- Measure percolator-type ground coffee into basket. Avoid getting coffee grounds in the stem. Refer to the Coffee Making Chart that follows. Spread coffee evenly in basket. Place spreader on basket.
- Push lid down, then turn to lock. The glass portion of the lid will not be hot during operation. **WARNING! Burn Hazard. Scalding may occur if the lid is removed during the brewing cycle.**
- Plug cord into the percolator then plug the cord into electrical outlet. The unit automatically turns on.
- The Ready Light will glow when coffee is ready and percolator will automatically go into a keep warm mode. Allow about 1 minute per cup for brewing time.
- The percolator will remain at serving temperature until it is unplugged.
- When finished serving coffee, unplug the percolator from the electrical outlet. Allow to cool. Then remove cord from the percolator.

Coffee making chart

Water Level	Amount of Ground Coffee
12 cups	8 to 12 tablespoons
10 cups	8 to 10 tablespoons
8 cups	6 to 8 tablespoons
6 cups	5 to 6 tablespoons
4 cups	4 to 5 tablespoons
2 cups	3 tablespoons

NOTE: We recommend using coffee that has been ground specifically for use in a **percolator-type** coffee maker. Although, coffee marked "For All Coffee Makers" is acceptable. If using a coffee grinder and whole beans, percolator coffee should be a coarse grind. A finely ground coffee may cause the coffee basket to overflow.

OPERATION (CONT.)

To heat water

Use heated water to make instant coffee, hot cocoa, or tea.

- Remove cover, basket and stem. Fill percolator with cold water to desired level as indicated by numbered servings on inside of percolator or water window. Do not fill beyond MAX.
- Place basket on stem. Hold top of stem and place stem and basket into heating unit well. (Using the stem and basket will speed heating time.) Place spreader on basket.
- Push lid down, then turn to lock. The glass portion of the lid will not be hot during operation. **WARNING! Burn Hazard. Scalding may occur if the lid is removed during the brewing cycle.** Plug cord into the percolator then plug the cord into electrical outlet. The unit automatically turns on.
- The Ready Light will glow when water is ready, and percolator will automatically go into a keep warm mode.

CARE AND CLEANING

⚠ WARNING Electrical Shock Hazard.

Disconnect power before cleaning.

To reduce the risk of electrical shock, do not immerse the cord, plug or percolator in water or any other liquid.

How to clean

- After each use, unplug cord from outlet then remove cord from the percolator. Let cool before cleaning.
- Remove lid, basket, spreader, and stem. Wash these in hot, soapy water. (These parts can also be placed in dishwasher.) Do not put percolator in dishwasher.
- Rinse all parts thoroughly and dry. Store with cover off. **NOTE:** Make sure the washer at bottom of stem remains loose. If coffee grounds lodge in this area, remove them under running water or with a wooden pick, then rinse and dry.

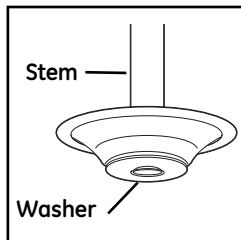

- Fill the percolator half-full with hot water. Add a drop of liquid dishwashing detergent and wash the inside of the percolator. Use a sponge and clean the inside of the heating unit well. This part must be properly cleaned to maintain the proper operation of the percolator. Do not immerse percolator in water.
- Drain the soapy water then fill the percolator with hot water to rinse. Pour soapy water through spout to clean the spout. Repeat with another hot water rinse. Dry.
- Clean outside of percolator with a damp cloth. Do not use abrasive scouring pads or cleansers.

To remove mineral deposits and build-up

If the percolator is used daily, follow these instructions every other week.

- Fill the percolator with 6 cups cold water and 6 cups white vinegar. Assemble with stem, basket, spreader, and lid.
- Plug in and complete one perk cycle. When perking has stopped, let sit another 15 minutes. Unplug and drain percolator. Let cool, then clean according to "How to clean."

CUSTOMER ASSISTANCE

If you have a claim under this warranty, please call our Customer Assistance Number. For faster service, please have the model number and product name ready for the operator to assist you. This number can be found on the bottom of your appliance and on the front page of this manual.

Model Number: _____ **Product Name:** _____

Customer Assistance Number 1.877.207.0923 (US) or 1.877.556.0973 (Canada)

Keep these numbers for future reference!

For more information, please visit us at www.gehousewares.com

Two-Year Limited Warranty

What does your warranty cover?

- Any defect in material or workmanship.

For how long after the original purchase?

- Two years.

What will we do?

- Provide you with a new one.
- For those items still under warranty but no longer available, WAL-MART reserves the right to replace with a similar GE branded product of equal or greater value.

How do you make a warranty claim?

- Save your receipt.
- Properly pack your unit. We recommend using the original carton and packing materials.
- Return the product to your nearest WAL-MART store or call Customer Assistance at 1-877-207-0923 (U.S.) or 1-877-556-0973 (Canada).

What does your warranty not cover?

- Parts subject to wear, including, without limitation, glass parts, glass containers, cutter/strainer, blades, seals, gaskets, clutches, motor brushes, and/or agitators.
- Commercial use or any other use not found in printed directions.
- Damage from misuse, abuse, or neglect, including failure to clean product regularly in accordance with manufacturer's instructions.

How does state law relate to this warranty?

- This warranty gives you specific legal rights, and you may also have other rights which vary from state to state or province to province.
- THIS WARRANTY IS IN LIEU OF ANY OTHER WARRANTY OR CONDITION, WHETHER EXPRESS OR IMPLIED, WRITTEN OR ORAL, INCLUDING, WITHOUT LIMITATION, ANY STATUTORY WARRANTY OR CONDITION OF MERCHANTABILITY OR FITNESS FOR A PARTICULAR PURPOSE, EXCEPT TO THE EXTENT PROHIBITED BY LAW.
- WAL-MART, GE, AND THE PRODUCT MANUFACTURER EXPRESSLY DISCLAIM ALL RESPONSIBILITY FOR SPECIAL, INCIDENTAL, AND CONSEQUENTIAL DAMAGES OR LOSSES CAUSED BY USE OF THIS APPLIANCE. ANY LIABILITY IS EXPRESSLY LIMITED TO AN AMOUNT EQUAL TO THE PURCHASE PRICE PAID WHETHER A CLAIM, HOWEVER INSTITUTED, IS BASED ON CONTRACT, INDEMNITY, WARRANTY, TORT (INCLUDING NEGLIGENCE), STRICT LIABILITY, OR OTHERWISE. SOME STATES OR PROVINCES DO NOT ALLOW THIS EXCLUSION OR LIMITATION OF INCIDENTAL OR CONSEQUENTIAL LOSSES SO THE FOREGOING DISCLAIMER MAY NOT APPLY TO YOU.

What if you encounter a problem with this product while using it outside the country of purchase?

- The warranty is valid only in the country of purchase and you follow the warranty claim procedure as noted.



is a trademark of General Electric Company and is used under the license by WAL-MART Stores, Inc., Bentonville, AR 72716

Marketed in Canada by:

Wal-Mart Canada Corp.
1940 Argentia Road, Mississauga,
Ontario L5N1P9

Free Manuals Download Website

<http://myh66.com>

<http://usermanuals.us>

<http://www.somanuals.com>

<http://www.4manuals.cc>

<http://www.manual-lib.com>

<http://www.404manual.com>

<http://www.luxmanual.com>

<http://aubethermostatmanual.com>

Golf course search by state

<http://golfingnear.com>

Email search by domain

<http://emailbydomain.com>

Auto manuals search

<http://auto.somanuals.com>

TV manuals search

<http://tv.somanuals.com>