

KETTLE



Model Number:
169205
UPC: 681131692052

Customer Assistance

1 877 207 0923 (US)
1 877 556 0973 (Canada)



Thank you for purchasing this GE appliance.

In keeping with the GE ecomagination initiative, please consider the option to recycle the packaging material and donate any appliance you are no longer using.

To read more about GE's ecomagination commitment, visit:
ge.ecomagination.com

IMPORTANT SAFEGUARDS

When using electrical appliances, basic safety precautions should always be followed, including the following:

- **Read all instructions.**
- Do not touch hot surfaces. Use handles or knobs.
- To protect against fire, electric shock and injury to persons, do not immerse cord, plugs, base or kettle in water or other liquid.
- Never leave the appliance unattended when in use. Close supervision is necessary when any appliance is used by or near children.
- Unplug from outlet when not in use, no water in kettle, filling water, moving kettle and before cleaning. Allow to cool before putting on or taking off parts, and before cleaning the appliance.
- Do not operate any appliance with a damaged cord or plug or after the appliance malfunctions, or has been damaged in any manner. Call our toll-free Customer Assistance Number for examination, repair or adjustment.
- Do not use a base unit other than the one supplied. The use of accessory attachments not recommended by the appliance manufacturer may result in fire, electric shock or injury to persons.
- Do not use outdoors.
- Do not let cord hang over edge of table or counter, or touch hot surfaces. Always store excess portion of the power cord in the compartment of the base unit.
- Electric kettle must be operated on a flat surface. Do not place on or near a hot gas or electric burner, or in a heated oven, or on the top of other electric appliances.
- Always attach plug to appliance first, then plug cord into the wall outlet. To disconnect, turn control to off, then remove plug from wall outlet.
- Do not use appliance for other than intended use.
- To avoid circuit overload, do not operate another high wattage appliance on the same circuit.
- Do not fill kettle when positioned on base. Dry the water on the bottom of the body before place it onto the power base.
- Be aware of steam being emitted from spout or lid especially during refilling. Do not remove lid during boiling cycle.
- Do not use the kettle to heat anything other than water. Do not fill above the "max" indication. Do not operate kettle if water is below minimum marking. If the kettle is overfilled, boiling water may be ejected. The kettle is only to be used with the base unit provided.
- Do not insert any object into slots or holes of the kettle.
- Open the lid with the release button only. Push lid down to lock in place.
- Scalding may occur if the lid is removed during the brewing cycles.
- This appliance is for **HOUSEHOLD USE ONLY**.

SAVE THESE INSTRUCTIONS!

ADDITIONAL SAFEGUARDS

DO NOT OPERATE APPLIANCE IF THE LINE CORD SHOWS ANY DAMAGE OR IF APPLIANCE WORKS INTERMITTENTLY OR STOPS WORKING ENTIRELY.

EXTENSION CORDS

A short power-supply cord is to be provided to reduce the risk resulting from becoming entangled in or tripping over a longer cord. Longer detachable power-supply cords or extension cords are available and may be used if care is exercised in their use. If a longer detachable power-supply cord or extension cord is used,

- 1) The marked electrical rating of the cord set or extension cord should be at least as great as the electrical rating of the appliance, and
- 2) The extension cord should be a grounding-type 3-wire cord, and
- 3) The longer cord should be arranged so that it will not drape over the countertop or tabletop where it can be tripped over, snagged, or pulled on unintentionally (especially by children).

GROUNDING INSTRUCTIONS

This appliance must be grounded while in use.

CAUTION: To ensure continued protection against risk of electric shock, connect to properly ground outlets only.

GROUNDING INSTRUCTIONS – US ONLY

The appliance has a plug that looks like Figure A. An adaptor, as shown in Figure B, should be used for connecting a 3-prong grounding plug to a 2-wire receptacle. The grounding tab, which extends from the adaptor, must be connected to a permanent ground such as a properly grounded receptacle as shown in Figure C, using a metal screw.

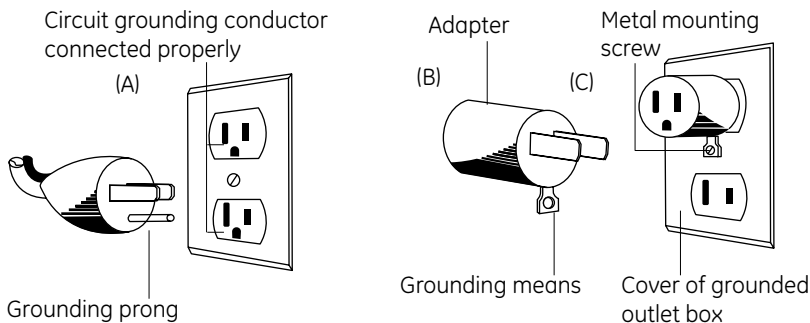

PARTS

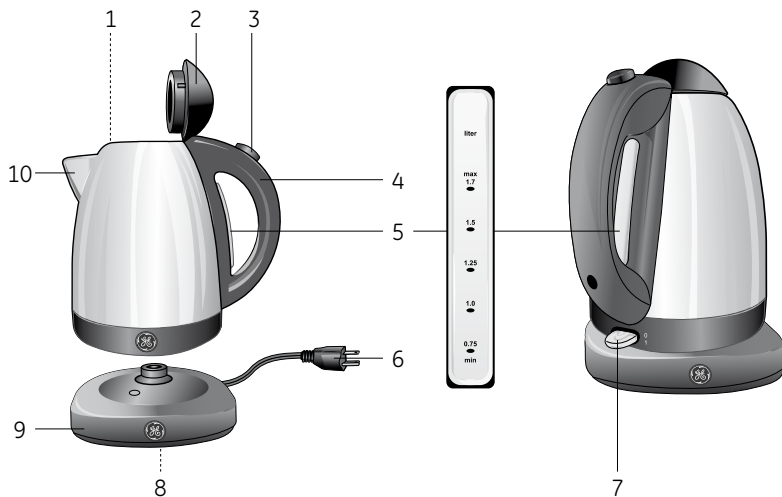

- 1 Filter
- 2 Lid
- 3 Lid release button
- 4 Handle
- 5 Water gauge
- 6 Power plug with power cord
- 7 I/O switch I=on, O=off
- 8 Cord storage
- 9 Base
- 10 Spout

ILLUSTRATIONS

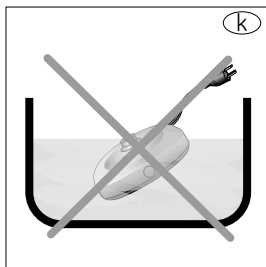
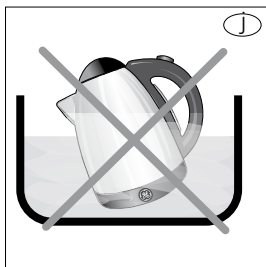
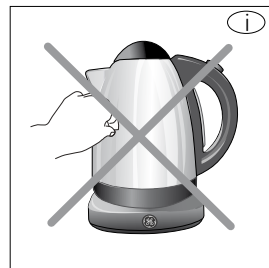
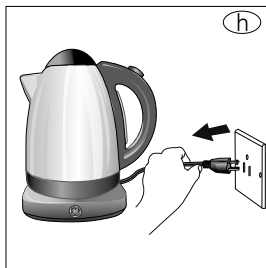
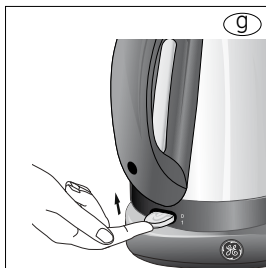
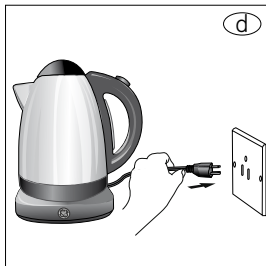
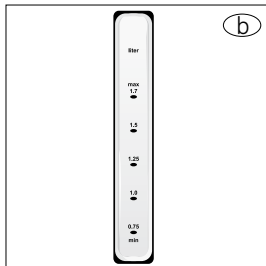

OPERATION

Before first use

- Remove all packaging materials, labels and/or stickers from your kettle.
- Clean your kettle thoroughly before using for the first time (↳ *Cleaning*).
- Boil water at least 2 times and dispose, before boiling water for consumption.
- Remove the kettle from the base **(9)**. Push the lid release button **(3)** to open the lid **(2)**.
- Fill the kettle with water (*ill.* **(a)**) up to the **max 1.7** marking (*ill.* **(b)**). Close the lid **(2)** (*ill.* **(c)**).
- Connect the power plug **(6)** to a wall outlet (*ill.* **(d)**). Press down the **I/O** switch **(7)** to on position to start boiling the water (*ill.* **(e)**).
- The **I/O** switch **(7)** lights up. After boiling is finished, the kettle turns off automatically. Dispose of the hot water in the sink.

WARNING: Be careful when handling hot water. Danger of scalding!

- Let the appliance cool down 1 minute before boiling water again. Repeat this process at least 2 times before using water for consumption.

WARNING: Do not immerse the base **(9)** or the kettle in water or any liquids. This may cause electric shock or damage the appliance.

Operating instructions

Before plugging the kettle into the wall outlet, check that the electrical circuit is not overloaded with other appliances.

- Set the base **(9)** on a flat, even and steady surface.
- Remove the kettle from the base **(9)**. Push the lid release button **(3)** to open the lid **(2)**.
- Fill the kettle with water (*ill.* **(a)**) between the **min 0.75** and the **max 1.7** marking (*ill.* **(b)**). Do not fill under the **min** or over the **max** marking. See the water gauge **(5)** for adding the desired amount of water. Close the lid **(2)** (*ill.* **(c)**).
- Connect the power plug **(6)** to a wall outlet (*ill.* **(d)**).
- Press down the **I/O** switch **(7)** to on position to start boiling the water (*ill.* **(e)**). The **I/O** switch **(7)** lights up.
- After boiling is finished, the kettle turns off automatically.
- Let the appliance cool down 1 minute before boiling water again.
- Pour the hot water into a heat resistant container (*ill.* **(f)**).

OPERATION

- Manually interrupt the boiling process by lifting up the I/O switch (7) to off position (ill. 9).
- After each use remove the power plug (6) from the wall outlet (ill. h).

WARNING: The appliance is very hot during use. Do not touch (ill. i). Danger of burns!

WARNING: Never leave the kettle unattended while boiling water. Especially when there are children nearby.

CLEANING

Clean the kettle regularly. This appliance contains no user serviceable parts and requires little maintenance. Leave any servicing or repairs to qualified personnel.

- Clean the outside of the base (9) and the kettle with a damp soft cloth.
- Clean the inside of the kettle with dishwasher detergent and rinse thoroughly with water.
- Do not use abrasive cleansers.
- After cleaning dry the kettle and the base (9) thoroughly.

WARNING: Never immerse the kettle (ill. j) or the base (9) (ill. k) in water or other liquids.

DECALCIFYING

- Remove the filter (1).
- Fill the kettle with a vinegar and water mixture (½ vinegar and ½ water) up to the **max 1.7** mark.
- Open lid (2) and pour water into the kettle (ill. a).
- Close the lid (2) and place the kettle on the base (9).
- Insert power plug (6) into a standard 120 V AC wall outlet (ill. d). Press down the I/O switch on/off (7) to start boiling the water (ill. e).
- Run through the complete brewing cycle with the decalcifying solution and repeat 3 times.
- After decalcifying, run through 2 complete boiling cycles with clear water.
- Clean the kettle afterwards (↳ Cleaning).

STORAGE

Clean and dry all parts before storing. Store the kettle in its box or in a clean, dry place. Never wrap the power cord **(6)** around the kettle. Always use the cord storage on the bottom of the base **(9)** (ill. ).

TECHNICAL DATA

Rated voltage:	120V ~60Hz
Rated current:	12.5A
Rated power input:	1500W
Capacity:	min. 25oz (0.75L), max. 57oz (1.7L)

CUSTOMER ASSISTANCE

If you have a claim under this warranty, please call our Customer Assistance Number. For faster service, please have the model number and product name ready for the operator to assist you. This number can be found on the bottom of your appliance and on the front page of this manual.

Model Number: _____ **Product Name:** _____

Customer Assistance Number 1.877.207.0923 (U.S.) or 1.877.556.0973 (Canada).

Keep these numbers for future reference!

For more information, please visit us at WWW.GEHOUSEWARES.COM

Two-year limited warranty

What does your warranty cover?

- Any defect in material or workmanship.

For how long after the original purchase?

- Two years.

What will we do?

- Provide you with a new one.
- For those items still under warranty but no longer available, WAL-MART reserves the right to replace with a similar GE branded product of equal or greater value.

How do you make a warranty claim?

- Save your receipt.
- Properly pack your unit. We recommend using the original carton and packing materials.
- Return the product to your nearest WAL-MART store or call Customer Assistance at 1-877-207-0923 (U.S.) or 1-877-556-0973 (Canada).

What does your warranty not cover?

- Parts subject to wear, including, without limitation, glass parts, glass containers, cutter/strainer, blades, seals, gaskets, clutches, motor brushes, and/or agitators, etc.
- Commercial use or any other use not found in printed directions.
- Damage from misuse, abuse, or neglect, including failure to clean product regularly in accordance with manufacturer's instructions.

How does state law relate to this warranty?

- This warranty gives you specific legal rights, and you may also have other rights which vary from state to state or province to province.
- This warranty is in lieu of any other warranty or condition, whether express or implied, written or oral, including, without limitation, any statutory warranty or condition of merchantability or fitness for a particular purpose.
- WAL-MART, GE and the product manufacturer expressly disclaim all responsibility for special, incidental, and consequential damages or losses caused by use of this appliance. Any liability is expressly limited to an amount equal to the purchase price paid whether a claim, however instituted, is based on contract, indemnity, warranty, tort (including negligence), strict liability, or otherwise. Some states or provinces do not allow this exclusion or limitation of incidental or consequential losses, so the foregoing disclaimer may not apply to you.

What if you encounter a problem with this product while using it outside the country of purchase?

- The warranty is valid only in the country of purchase and if you follow the warranty claim procedure as noted.



is a trademark of General Electric Company and is used under the license by Wal-Mart Stores Inc., Bentonville, AR 72716. **Marketed in Canada by:** Wal-Mart Canada Corp. 1940 Argentia Road, Mississauga, Ontario L5N 1P9. **Download from www.800manuals.com. All Manuals Search And Download.**

Free Manuals Download Website

<http://myh66.com>

<http://usermanuals.us>

<http://www.somanuals.com>

<http://www.4manuals.cc>

<http://www.manual-lib.com>

<http://www.404manual.com>

<http://www.luxmanual.com>

<http://aubethermostatmanual.com>

Golf course search by state

<http://golfingnear.com>

Email search by domain

<http://emailbydomain.com>

Auto manuals search

<http://auto.somanuals.com>

TV manuals search

<http://tv.somanuals.com>