

JUICE EXTRACTOR



Model Number:
169201
UPC: 681131692014

Customer Assistance

1 877 207 0923 (US)
1 877 556 0973 (Canada)



Thank you for purchasing this GE appliance.

In keeping with the GE ecomagination initiative, please consider the option to recycle the packaging material and donate any appliance you are no longer using.

To read more about GE's ecomagination commitment, visit:
ge.ecomagination.com

IMPORTANT SAFEGUARDS

When using electrical appliances, basic safety precautions should always be followed, including the following:

- **Read all instructions.**
- To protect against risk of electrical shock, do not immerse the cord or the juice extractor's base in water or other liquid. If base or cord falls into liquid, unplug the cord from outlet immediately. Do not reach into the liquid.
- Close supervision is necessary when the juice extractor is used near children. Never allow a child to use this product.
- Unplug from outlet when not in use, before putting on or taking off parts, and before cleaning.
- Avoid contacting moving parts. Keep hands, hair, clothing as well as spatulas and other utensils away from juice extractor during operation, to prevent personal injury and/or damage to the appliance. A scraper may be used but must be used only when the juice extractor is not running.
- Caution: Sharp blade. Never put your fingers into the feeding chute or tube. Always use food pusher. Unplug before cleaning and before assembling or removing parts.
- Do not operate appliance with a damaged cord or plug, or after the appliance malfunctions or is dropped or damaged in any manner. Call our toll-free customer assistance number for information on examination, repair, or adjustment.
- The use of attachments, not recommended by the manufacturer may cause injury to persons.
- Do not use outdoors or in a damp area.
- Do not let cord hang over edge of table or counter.
- Always operate juice extractor with lid locked in place by the latches.
- When using juice extractor do not remove lid until the blade has stopped rotating.
- Do not process for longer than the time periods recommended.
- Do not overfill the sieve. Add food in small quantities.
- Do not use the sieve if is damaged or deformed. Have it replaced with a new one.
- Do not process hot foodstuffs.
- Regularly empty the pulp container.
- All parts must be properly in place before operating the appliance.
- Do not place juice extractor on or near a hot burner (gas or electric).
- Do not use appliance for other than intended use.

SAVE THESE INSTRUCTIONS!

ADDITIONAL SAFEGUARDS

This appliance is for **HOUSEHOLD USE ONLY**.

DO NOT OPERATE APPLIANCE IF THE LINE CORD SHOWS ANY DAMAGE OR IF APPLIANCE WORKS INTERMITTENTLY OR STOPS WORKING ENTIRELY.

EXTENSION CORDS

A short power-supply cord is to be provided to reduce the risk resulting from becoming entangled in or tripping over a longer cord. Longer detachable power-supply cords or extension cords are available and may be used if care is exercised in their use. If a longer detachable power-supply cord or extension cord is used,

- 1) The marked electrical rating of the cord set or extension cord should be at least as great as the electrical rating of the appliance, and
- 2) The longer cord should be arranged so that it will not drape over the countertop or tabletop where it can be tripped over, snagged, or pulled on unintentionally (especially by children).

POLARIZED PLUG

This appliance has a polarized plug (one blade is wider than the other). To reduce the risk of electric shock, this plug is intended to fit into a polarized outlet only one way. If the plug does not fit fully into the outlet, reverse the plug. If it still does not fit, contact a qualified electrician. Do not attempt to modify the plug in any way.

PARTS

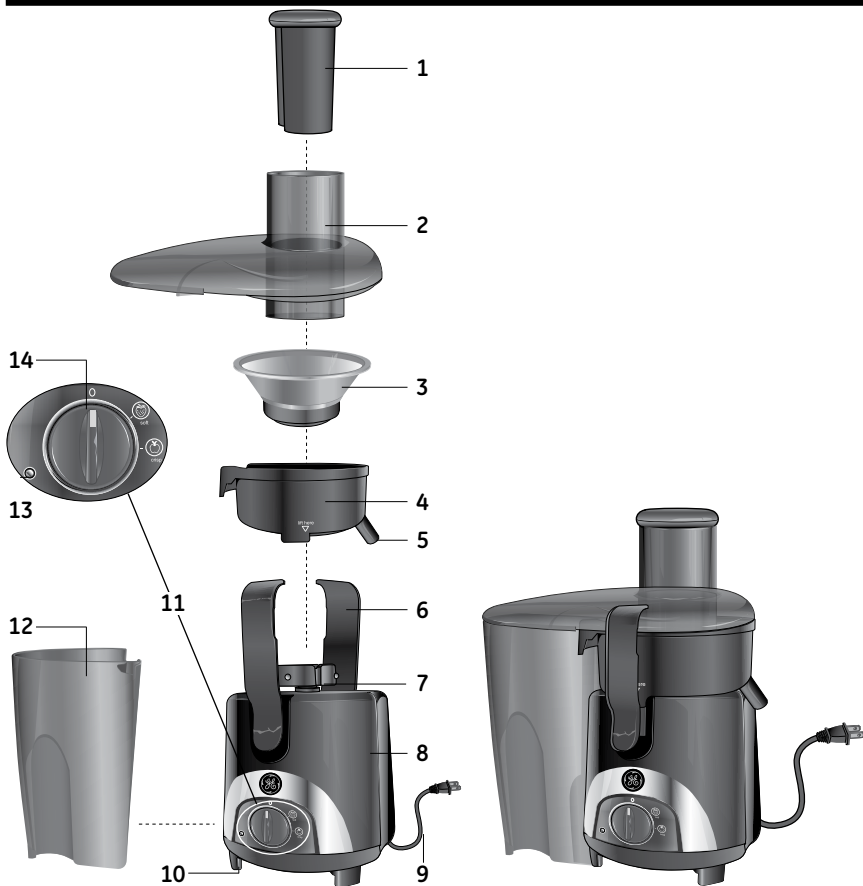

- | | |
|---------------------------|------------------------|
| 1. Food pusher | 8. Base |
| 2. Lid with feeding chute | 9. Power cord and plug |
| 3. Stainless steel filter | 10. Rubber feet |
| 4. Filter holder | 11. Control panel |
| 5. Spout | 12. Pulp container |
| 6. Locking latches | 13. Indicator light |
| 7. Stem | 14. Speed control |

ILLUSTRATIONS

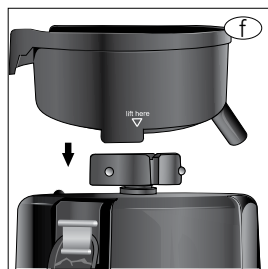
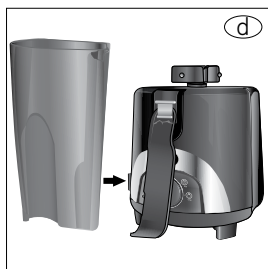
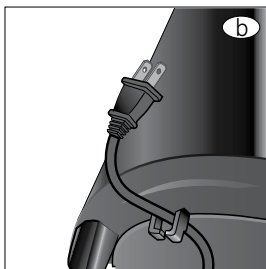
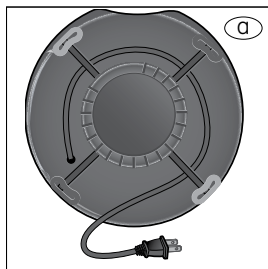

ILLUSTRATIONS

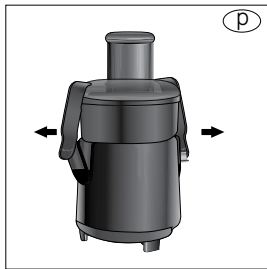
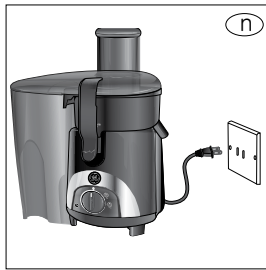
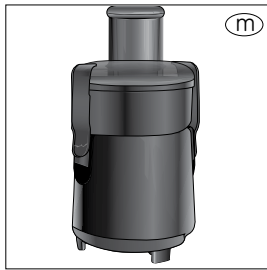
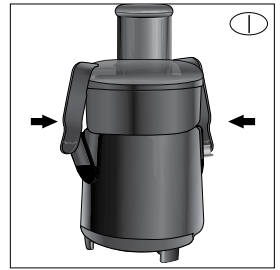
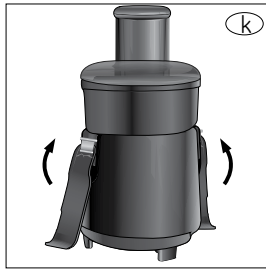
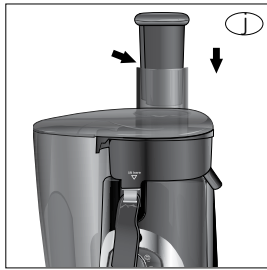

OPERATION

Before first use

- Remove all packaging materials, labels and/or stickers from your juice extractor.
- Clean your juice extractor thoroughly before using for the first time (↳ *Cleaning*). The juice extractor must not be connected to power during cleaning.

Warning: Do not immerse the juice extractor in water or any liquids. This may cause electric shock or damage the appliance.

Before operation

- Unwind the power cord **(9)** from the base **(8)** of juice extractor (*ill.* **(a)**).
- Lead the power cord **(9)** through the guide on the bottom of base **(8)** (*ill.* **(b)**).
- Place the rubber feet **(10)** on the bottom of base **(8)** on a flat, even and steady surface (*ill.* **(c)**).

Operating instructions

Always disconnect the power plug **(9)** from the outlet when putting on or taking off parts.

Before plugging in the juice extractor check that the electrical circuit is not overloaded with other appliances.

Assembly	<ul style="list-style-type: none">• Place the pulp container (12) next to the base (8). Make sure the guide rail of the base is inserted into the pulp container's groove (<i>ill.</i> (d)/(e)).• Place the filter holder (4) on the base (8) (<i>ill.</i> (f)/(g)).• Insert the stainless steel filter (3) and turn until it locks into place (<i>ill.</i> (h)). <p>Warning: Danger of laceration. The center of the stainless steel filter (3) contains small blades to process fruits and vegetables. Do not touch the blades when handling the stainless steel filter (3).</p> <ul style="list-style-type: none">• Place lid (2) on the appliance (<i>ill.</i> (i)).• Insert the food pusher (1) in the feeding chute (2). Make sure the ridge of the feeding chute (2) fits into the notch on the food pusher (1) (<i>ill.</i> (j)).• Close locking latches (6): Lift up the two latches (<i>ill.</i> (k)) until they lock into place (<i>ill.</i> (l)/(m)).• Connect the power plug (9) with a wall outlet (<i>ill.</i> (n)).• Place a glass or mug underneath the spout (5) (<i>ill.</i> (o)).
-----------------	---



OPERATION

Preparing fruits/vegetables

- This juice extractor can be used to make juices from many different fruits and vegetables, but some preparations are needed to create flavorful and tasty juices.
 - Rinse and dry fruits under running fresh water.
 - Cut large fruits into pieces that fit into the feeding chute **(2)**.
 - Remove large seeds, stones, and pits from cherries, peaches, etc.
 - Peel thick-skinned fruits (pineapples, melons, etc).

Extracting juice

- Assemble the juice extractor as described above. Connect the juice extractor with a suitable outlet, and place a container underneath the spout **(5)**.
- Remove food pusher **(1)** from the feeding chute **(2)**.
- Set the speed control (14) to the desired setting:

Setting	Suitable for
	Strawberries, watermelon, pears, apricots, blueberries, grapes, kiwi, mangoes, melons, nectarines, peaches, plums, raspberries, tomatoes, broccoli, cabbage, cauliflower, cucumber,
	Apples, carrots, beetroot, brussels sprouts, celery, fennel, oranges, pineapple

- Fill the prepared ingredients into feeding chute **(2)**. Do not overload the feeding chute. Add small pieces at a time. Fruit pulp is ejected into the pulp container **(12)** while the extracted juice will be flowing through the spout **(5)** into the prepared container.



Warning: Do not put your hand or fingers into the feeding chute **(2)** to push food or clear the feeding chute **(2)** from food. Use the food pusher **(1)**. Danger of serious injury through the rotating blades.

- Insert the food pusher **(1)** into the feeding chute **(2)**. Make sure the ridge of the feeding chute **(2)** fits into the notch on the food pusher **(1)** (ill. ).
- Set speed control **(14)** to **0** when all of the food has been processed.
- Wait until stainless steel filter **(3)** has stopped rotating before removing lid **(2)**.

See the table on page **9** for recommended amounts and processing times.

OPERATION

Recommended amounts and processing times

Types of food	Max vol.	Speed	Time
Strawberries, blueberries, raspberries	70oz/2000g	soft 	90-120 sec
Pears, peaches, apricots, nectarines	70oz/2000g		130-150 sec
Spinach, cauliflower, broccoli, cabbage, cucumber	70oz/2000g		180-210 sec
Watermelon, melons, grapes, kiwi, mangoes, melons, plums	70oz/2000g		60-90 sec
Tomato	70oz/2000g		60-90 sec
Apples	70oz/2000g		crisp 
Carrots	70oz/2000g	60-90 sec	
Beetroot, brussels sprouts, celery, fennel, oranges, pineapple	70oz/2000g	120-150 sec	
Potatoes	Do not process with this appliance		
Bananas			
Avocados			

Caution: Do not process for longer than recommended time.
Do not exceed recommended maximum volumes.

Warning: Always turn the juice extractor off and unplug when not in use, otherwise the motor would continue to rotate when a button is pressed.

OPERATION

Information on fruits and vegetables

Fruits / vegetables	Nutrition facts	Energy in kj/kcal per 3.5oz/100g
Apples	Rich in protein, fibers, vitamin C	218kj/52kcal
Oranges	Rich in vitamin C, folates, vitamin A	207kj/49kcal
Strawberries	Rich in vitamin C, folates, lutein	136kj/32kcal
Pears	Rich in fibers, carotene, vitamin A	242kj/58kcal
Watermelon	Rich in carotene, vitamin A, lycopene	127kj/30kcal
Grapes (seedless)	Rich in calcium, vitamin C, vitamin A	288kj/69kcal
Peaches	Rich in vitamin A, vitamin C, folate	165kj/39kcal
Nectarines	Rich in vitamin A, vitamin C, carotene	185kj/44kcal
Tomatoes	Rich in calcium, vitamin C, folates	75kj/18kcal
Fennel	Rich in calcium, vitamin C, vitamin A	130kj/31kcal
Celery	Rich in calcium, folates, carotene	67kj/16kcal
Cucumber	Rich in carotene, vitamin A, lutein	65kj/15kcal
Carrots	Rich in fibers, calcium, vitamin A	173kj/41kcal

CLEANING

Always unplug the power plug **(9)** from wall outlet before cleaning.

Clean the juice extractor after every use. This appliance contains no user serviceable parts and requires little maintenance. Leave any servicing or repairs to qualified personnel.

Disassembly

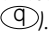
- Disconnect the power plug **(9)** from the wall outlet.
- Remove the glass or mug from underneath the spout **(5)**.
- Remove the pulp container **(12)** from the base **(8)**.
- Remove the food pusher **(1)** from the feeding chute **(2)**.
- Remove the lid **(2)** from the appliance.
- Open the locking latches **(6)** (ill. .
- Lift the filter holder **(4)** together with the stainless steel filter **(3)** from the base **(8)** (ill. .
- Remove the stainless steel filter **(3)** from the filter holder **(4)**.

Warning: Danger of laceration. The center of the stainless steel filter **(3)** contains small blades to process fruits and vegetables. Do not touch the blades when handling the stainless steel filter **(3)**.

- Disconnect the power plug **(9)** from the wall outlet.
- Do not immerse the appliance in water (ill. .
- Clean base **(8)** and control panel **(11)** with a damp soft cloth.
- Filter holder **(4)**, stainless steel filter **(3)**, and pulp container **(12)** may be washed by hand in hot soapy water. Do not place in the dishwasher. Do not use abrasives.
- Clean the stainless steel filter **(3)** carefully, it is very sharp.
- Always clean the parts that have come into contact with food in hot, soapy water immediately after use.

Storage

- Clean and dry all parts before storing.
- Assemble the juice extractor (→ *Assembly*).
- Never wrap power cord **(9)** tightly around the appliance; use the cord storage on the bottom of the base **(8)** (ill. .
- Store the juice extractor in its box or in a clean, dry place.

TROUBLESHOOTING

Problem	Possible Cause	Solution
The motor works very slowly.	✦ Too many ingredients in the sieve.	✦ Unplug. Remove some food and restart.
The motor does not work.	✦ Too many foods in the container. ✦ The motor is damaged.	✦ Unplug. Remove some food and restart.

If additional assistance is needed, please contact our Customer Assistance at 1.877.207.0923 (U.S.) or 1.877.556.0973 (Canada).

TECHNICAL DATA

Rated voltage:	120V ~60Hz
Rated current:	6.7A
Rated power input:	800W
Filling capacity:	70oz (2000g)
Dimensions:	313mm (L) x 200mm (W) x 387mm (H)
Weight (without package):	3.18kg

CUSTOMER ASSISTANCE

If you have a claim under this warranty, please call our Customer Assistance Number. For faster service, please have the model number and product name ready for the operator to assist you. This number can be found on the bottom of your appliance and on the front page of this manual.

Model Number: _____ **Product Name:** _____

Customer Assistance Number 1.877.207.0923 (U.S.) or 1.877.556.0973 (Canada).

Keep these numbers for future reference!

For more information, please visit us at WWW.GEHOUSEWARES.COM

Two-year limited warranty

What does your warranty cover?

- Any defect in material or workmanship.

For how long after the original purchase?

- Two years.

What will we do?

- Provide you with a new one.
- For those items still under warranty but no longer available, WAL-MART reserves the right to replace with a similar GE branded product of equal or greater value.

How do you make a warranty claim?

- Save your receipt.
- Properly pack your unit. We recommend using the original carton and packing materials.
- Return the product to your nearest WAL-MART store or call Customer Assistance at 1-877-207-0923 (U.S.) or 1-877-556-0973 (Canada).

What does your warranty not cover?

- Parts subject to wear, including, without limitation, glass parts, glass containers, cutter/strainer, blades, seals, gaskets, clutches, motor brushes, and/or agitators, etc.
- Commercial use or any other use not found in printed directions.
- Damage from misuse, abuse, or neglect, including failure to clean product regularly in accordance with manufacturer's instructions.

How does state law relate to this warranty?

- This warranty gives you specific legal rights, and you may also have other rights which vary from state to state or province to province.
- This warranty is in lieu of any other warranty or condition, whether express or implied, written or oral, including, without limitation, any statutory warranty or condition of merchantability or fitness for a particular purpose.
- WAL-MART, GE and the product manufacturer expressly disclaim all responsibility for special, incidental, and consequential damages or losses caused by use of this appliance. Any liability is expressly limited to an amount equal to the purchase price paid whether a claim, however instituted, is based on contract, indemnity, warranty, tort (including negligence), strict liability, or otherwise. Some states or provinces do not allow this exclusion or limitation of incidental or consequential losses, so the foregoing disclaimer may not apply to you.

What if you encounter a problem with this product while using it outside the country of purchase?

- The warranty is valid only in the country of purchase and if you follow the warranty claim procedure as noted.



is a trademark of General Electric Company and is used under the license by Wal-Mart Stores Inc.,

Centerville, AR 72116

Marketed in Canada by:

Wal-Mart Canada Corp.
1940 Argenta Road, Mississauga,

Ontario L5V 1P9

Download from www.Somanuals.com

on www.ManualsSearch.com

and www.Download.com

Free Manuals Download Website

<http://myh66.com>

<http://usermanuals.us>

<http://www.somanuals.com>

<http://www.4manuals.cc>

<http://www.manual-lib.com>

<http://www.404manual.com>

<http://www.luxmanual.com>

<http://aubethermostatmanual.com>

Golf course search by state

<http://golfingnear.com>

Email search by domain

<http://emailbydomain.com>

Auto manuals search

<http://auto.somanuals.com>

TV manuals search

<http://tv.somanuals.com>