



Wireless Rechargeable Optical Mini Mouse

Instruction Manual



H097663

For technical support, contact Jasco Products
1-800-654-8483
www.jascoproducts.com

Revision 3



TABLE OF CONTENTS

Special Mouse Functions	3
Battery Installation	4
Linking Your Mouse & Receiver.....	5
Software Installation	6
Troubleshooting.....	6
Five Year Limited Warranty	7
FCC Statement	8



Package Contents

- Wireless Rechargeable Optical Mini Mouse
- Mini USB Receiver
- Instruction Manual
- USB Recharging Cable
- 2 Rechargeable AAA Batteries
- Travel Bag

System Requirements

- Windows® 98 SE or higher
- Available USB Port



Special Mouse Functions

To turn your mouse off while traveling, press and hold the scroll wheel button. While pressing the scroll wheel button, press the link button on the bottom of the mouse. To turn the mouse on, repeat this process.

The mouse will go to sleep when idle for a long period of time to save batteries. To wake the mouse, press any mouse button.

When the batteries are low, the scroll wheel will become illuminated. It is time to charge/change the batteries. (See page 4.) Afterwards, you will need to re-link your mouse. (See page 5.)

Scroll wheel
illuminates when
batteries are low



USB Recharging Cable

Your Wireless Rechargeable Optical Mini Mouse comes with a USB recharging cable. This allows you use your mouse while it is being recharged, instead of having to wait hours for a recharging cradle.

Simply plug the USB recharging cable into the mouse as shown in the picture, and insert the USB end of the cable into an available USB port on your computer or USB hub.

USB
charging
cable



Battery Installation

1. Place the mouse in the palm of your left hand, with the scroll wheel at the bottom and the GE logo at the top.
2. While holding the mouse in your left hand, locate the battery compartment release and with your right hand press and hold the battery compartment release using a pointed object. (Refer to picture for steps 2 and 3)
3. Begin to grip the mouse firmly in your left hand. Refer to the picture and place the thumb of your left hand where indicated. Then push your thumb away from your body to release the battery cover.
4. Set the battery compartment cover aside. Insert 2 AAA batteries, being sure to match the polarity of the batteries with the polarity markings inside the battery compartment.
5. Replace the battery compartment cover.
6. Re-link your mouse. (See pg 5.)

Place thumb here, push down and away



Battery compartment release



Linking Your Mouse & Receiver

Please keep these directions in a safe place. Each time you replace the batteries you will need to re-link your mouse.

1. Insert the enclosed batteries into the battery compartment of your mouse following the directions on page 4.
2. Plug the mini USB receiver into an available USB port on your computer or USB hub. It is not necessary to reboot your computer.
3. If prompted, insert your Windows disk and follow the on screen instructions. (This step is not necessary for all operating systems. Your system will prompt you if it is necessary.)
4. Press the link button on your receiver.
5. Press the link button on the bottom of your mouse.

Your mouse should now function normally. Move your mouse to test functionality.

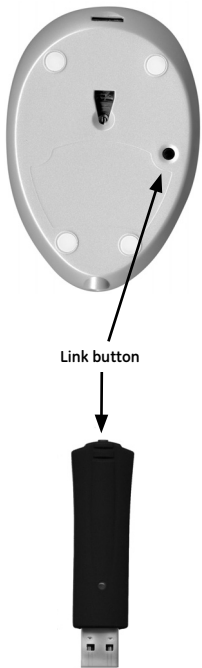

Software Installation

Your GE mouse comes with Office Selector Software. To install, simply insert the CD that came with your purchase, and follow the on screen instructions.

Using the Office® Selector Software

By pressing the button on top of the mouse, you have access to Microsoft Office® functions at your fingertips. Press the Office® Selector button to navigate into Microsoft Word®, Excel® or any of the other Microsoft programs listed below. Once you are in a program like Microsoft Word®, press the Office® Selector button again, and you will be able to choose from another set of shortcuts like Print, Open, or Save.

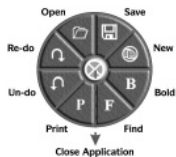

Troubleshooting

The Mini Optical Mouse does not work properly.



- Optical mice do not work well on glass or highly reflective surfaces. Try using your mouse on a different surface.
- If your mouse has been idle for a period of time it may be asleep to conserve battery power. Press the left mouse button to wake it.

- 
- Re-link your mouse. Press the link button on the receiver. Press the link button on the bottom of your mouse.

Scrolling left & right does not work smoothly.

- Your operating system may not support this function.

Mouse will not move.

- Press your left mouse button to wake your mouse.
 - Re-link your mouse. See section 5.
 - Sometimes screen savers interfere with the wake feature. Turn off your screen saver. If the mouse works, try using a different screen saver.
 - Change the batteries on your mouse. See section 4.
 - Not all laptops support USB mice. Test the mouse on a desktop computer. If this works, contact your laptop dealer.
- 
- 

Five Year Limited Warranty

Jasco Products Company warrants this product to be free from manufacturing defects for a period of five years from the original date of consumer purchase. This warranty is limited to the repair or replacement of this product only and does not extend to consequential or incidental damage to other products that may be used with this unit. This warranty is in lieu of all other warranties express or implied. Some states do not allow limitations on how long an implied warranty lasts or permit the exclusion or limitation of incidental or consequential damages, so the above limitations may not apply to you. This warranty gives you specific rights, and you may also have other rights which vary from state to state. If unit should prove defective within the warranty period, return prepaid with dated proof of purchase to: Jasco Products Company, 10 East Memorial Dr Oklahoma City, OK 73114.



FCC Statement

Notice: Federal Communications Commission (FCC) requirements, Part 15

This equipment has been tested and found to comply with the limits for a class B digital device, pursuant to part 15 of the FCC Rules. These limits are designed to provide reasonable protection against harmful interference in a residential installation. This equipment generates, uses and can radiate radio frequency energy and, if not installed and used in accordance with the instructions, may cause harmful interference to radio communications. However, there is no guarantee that interference will not occur in a particular installation. If this equipment does cause harmful interference to radio or television reception, which can be determined by turning the equipment off and on, the user is encouraged to try to correct the interference by one or more of the following measures:

- Reorient or relocate the receiving antenna.
- Increase the separation between the equipment and receiver.
- Connect the equipment into an outlet on a circuit different from that to which the receiver is connected.
- Consult the dealer or an experienced radio/TV technician for help.



CAUTION: Any changes of modifications not expressly approved by the grantee of this device could void the users authority to operate the equipment. This device complies with Part 15 of the FCC Rules. Operation is subject to the following two conditions: (1) this device may not cause harmful interference, and (2) this device must accept any interference received, including interference that may cause undesired operation.



Distributed for THOMSON INC
by Jasco Products Company
311 N.W. 122nd Street, Oklahoma City, OK 73114
www.jascoproducts.com

Free Manuals Download Website

<http://myh66.com>

<http://usermanuals.us>

<http://www.somanuals.com>

<http://www.4manuals.cc>

<http://www.manual-lib.com>

<http://www.404manual.com>

<http://www.luxmanual.com>

<http://aubethermostatmanual.com>

Golf course search by state

<http://golfingnear.com>

Email search by domain

<http://emailbydomain.com>

Auto manuals search

<http://auto.somanuals.com>

TV manuals search

<http://tv.somanuals.com>