

**GRACE**  
DIGITAL AUDIO

## **Floating Wireless Speaker System**

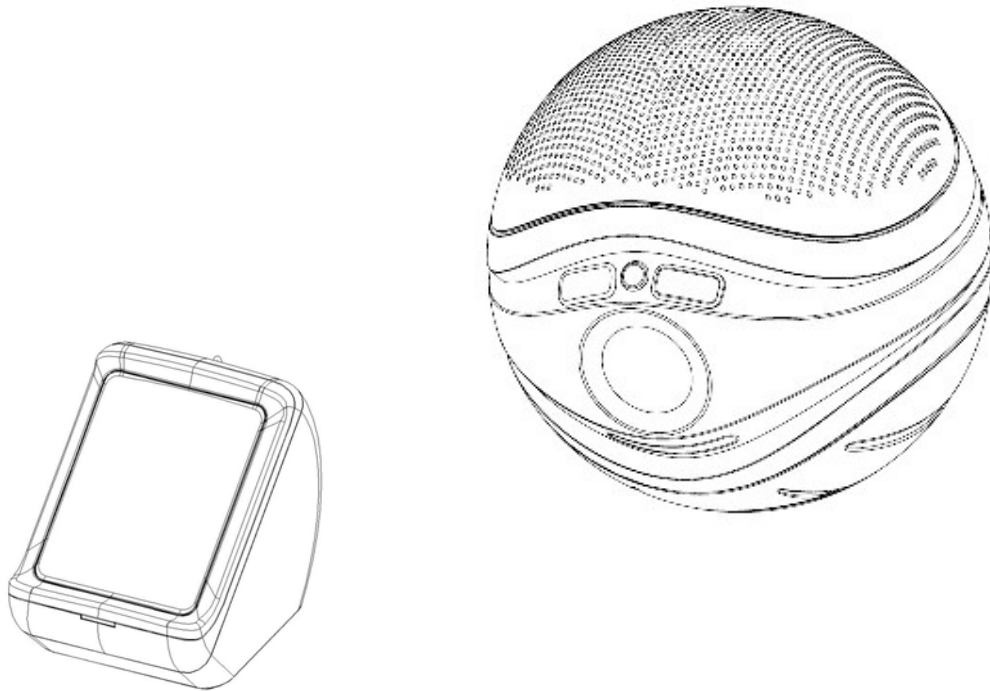

**Instructions Manual**

## **INTRODUCTION**

This Floating Wireless Speaker System uses the latest 900Mhz wireless technology to enable you to enjoy music outdoors in your swimming pool. It is simple to connect the portable transmitter to typical audio sources such as an i-Pod, Hi-Fi, CD/MP3 player or other audio source.

### **A. INSIDE THE PACKAGE**

1. Transmitter base
2. Floating speaker
3. AC adapter for transmitter
4. Input adapter (3.5mm audio plug to RCA type audio cable)
5. User Manual

### **B. FEATURES**

1. 900 MHz wireless technology
2. Auto Scan System to lock speakers onto strongest signal
3. Phase Lock Loop (PLL) transmitter
4. Water-resistant Speaker
5. Open air operating distance of up to 150 feet.
6. ON/OFF control on Transmitter
7. Auto Shut-Off on Speaker
8. Switchable mood light directed downward into the water
9. Battery operation for complete portability of transmitter and speaker

## C. COMPONENTS IDENTIFICATION

### 1. TRANSMITTER

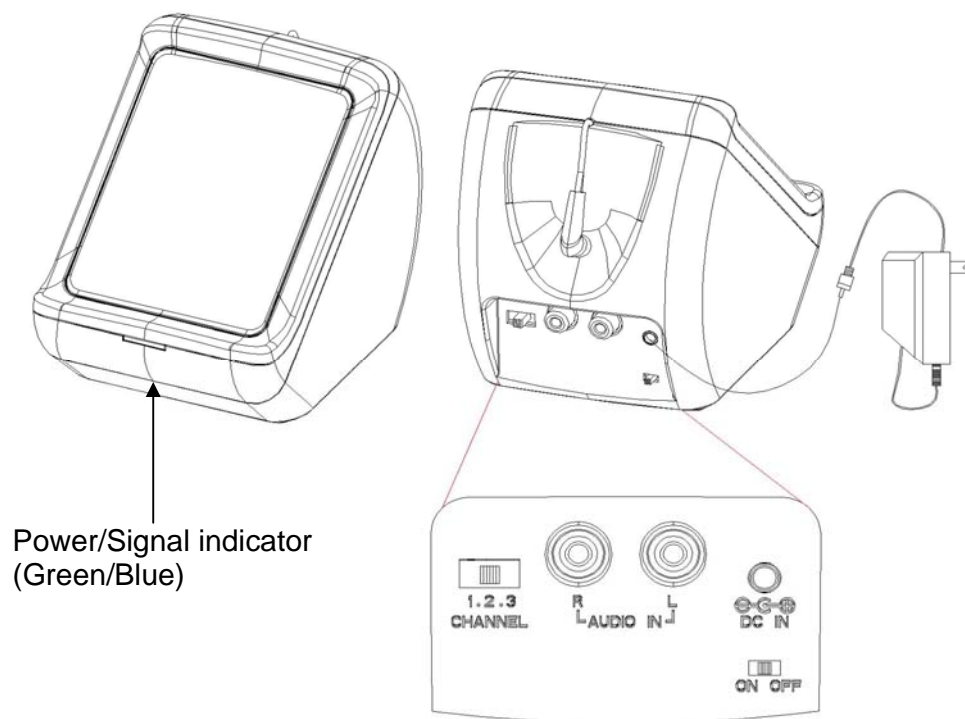

### 2. SPEAKER

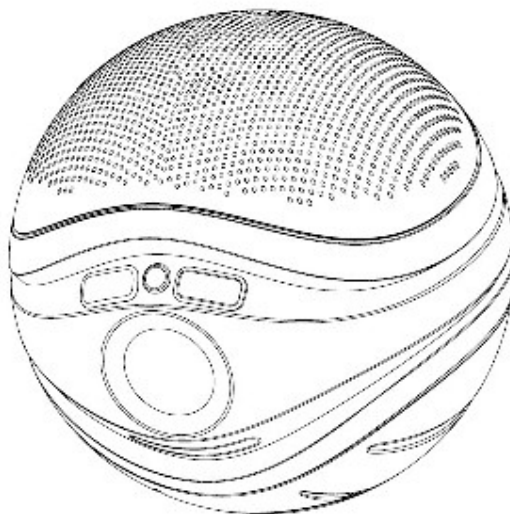

## D. INSTALLATION

### 1. TRANSMITTER

- A. Connect the supplied AC power adapter to an electrical wall outlet.
- B. Plug the AC power adapter in the DC jack located on the rear of the transmitter.
- C. Or you can insert 4 X "AA" size ALKALINE batteries into the battery compartment at the bottom of the transmitter with correct polarity.
- D. The rear of the transmitter has one audio cord that can be connected to audio output jack of TV, i-pod, DVD, and CD/MP3 players or to headphone/earphone jack with the connector provided.

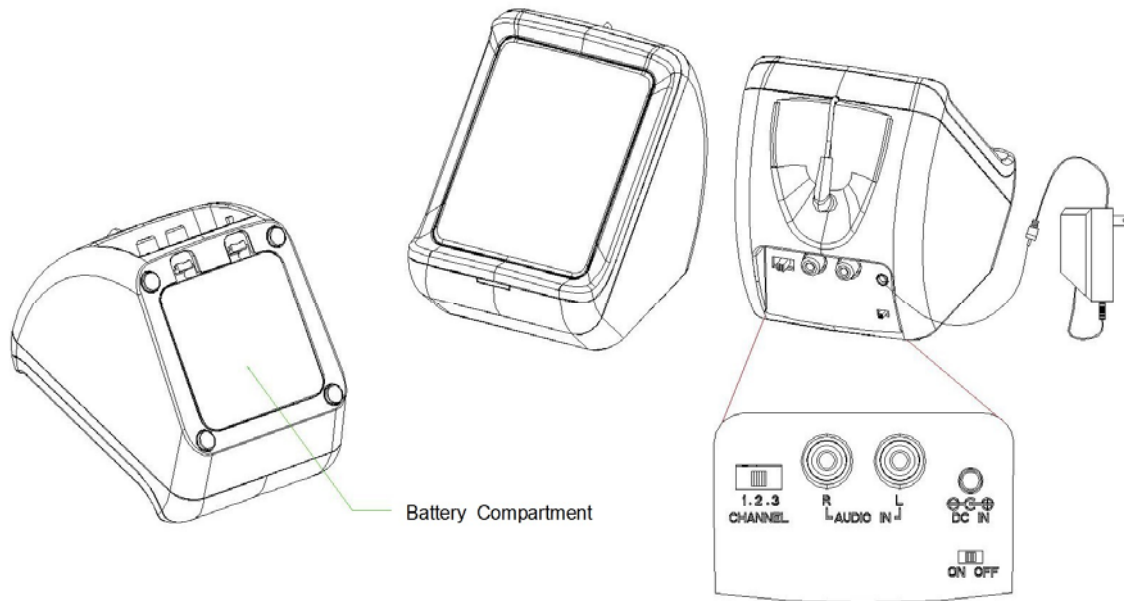

Turn the switch to On and the LED of transmitter will light up in Green. When the audio cable has been connected turn on the audio source to at least the mid range level and play the music. The LED will turn from Green to Blue (note: if the audio source is not in the play mode the LED will not turn from green to blue). If a speaker is not turned on within 4 minutes the transmitter light will turn from Blue back to green to save power.

### 2. SPEAKER

- A. Insert 6 x AA size ALKALINE batteries into the battery compartment with correct polarity at the bottom of the speaker.
- B. Tighten the battery door clockwise and make sure it is closed firmly without any gap.
- C. Press the Power button to turn the speaker ON. The Power LED will light up in Green. When the signal link is established between the transmitter and speaker, the LED on the speaker will change to Blue.

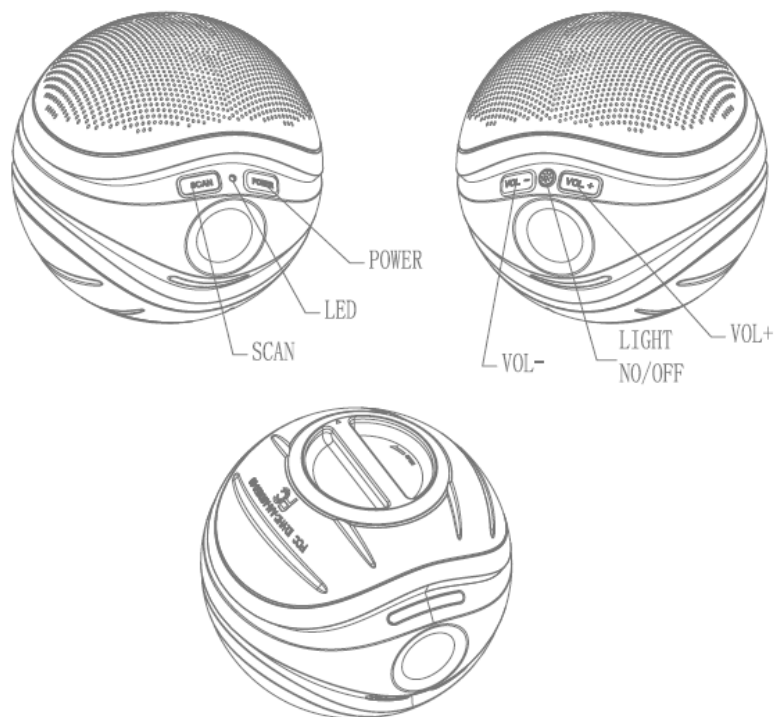

## E. OPERATION

1. Turn on the transmitter. The LED will light up in Green.
2. Turn on the audio source (TV or audio component like an iPod) to which the transmitter is connected. The LED will change from Green to Blue.
3. Select channel 1, 2 or 3 of the transmitter for best performance in your location.
4. Turn on the Power button on the speaker. Press the Autoscanner button. Adjust the volume by pressing "+" and "-" for desired listening level.

Caution: Screw the battery door clockwise to tightly close it and to make sure there is no gap before placing the speaker into the water.



5. You can now place the floating speaker in the pool, bathtub, hot tub etc.

CAUTION: Your speaker will operate best and loudest with no water resting on top of the speaker. Periodically draining the speaker by inverting it will ensure that not too much water remains standing on top of the speaker driver. Turn the speaker over and lightly shake it to let the water drain out quickly for best audio performance and when storing the speaker between uses.

When there has water inside the speaker, simply open the speaker cover to release water out. Just use your finger tab to press the edge of speaker cover (as figure) and open the cover. After that, close the speaker cover with correct position.

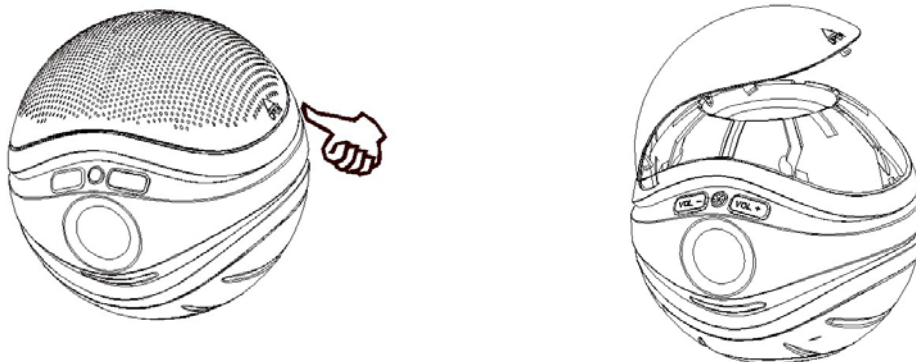

### SWITCHING OFF

1. If there is no audio input signal to the transmitter for a 4 minute period, the transmitter will go into standby mode and the LED will change from Blue to Green.
2. If the audio source is off, the LED on the transmitter will change to Green.
3. The Speaker will turn to standby mode if there is no input signal to transmitter and the LED becomes Green. The Speaker will automatically shut off when standby mode continues for 5 minutes.
4. While in standby mode, the speaker will turn to On automatically after getting a signal from transmitter.

### OTHER CONTROL

1. Select volume up and down on Speaker.
2. Select Light button to turn on the mood light effect in the water. This feature works only when the Speaker is turned on.
3. If you hear interference that may be coming from other devices, you can adjust the tuning control by moving the channel knob to 1, 2 or 3 on the transmitter. Then press the "Scan" button on the speaker for best reception.

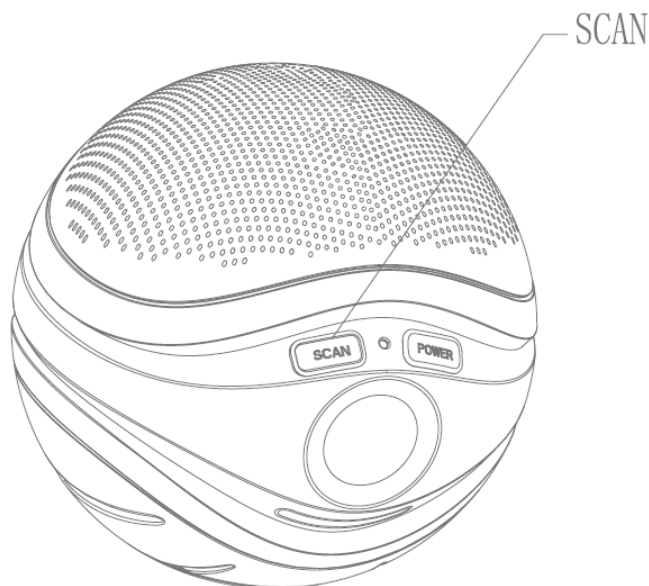

## **F. TROUBLE SHOOTING**

### **NO SOUND**

- Too much water retention inside the speaker grill. Turn the speaker over and gently shake it to let the water drain out.
- Ensure you have fresh alkaline batteries for both transmitter and receiver if the speaker's and/or transmitter's battery charge is too low, sound distortion will be heard. Replace with new batteries.
- Ensure the audio component is ON and its volume is set to at least 50%.
- The connected audio equipment is not playing. Start playing the equipment.
- The volume of speaker is too low, adjust the volume to an appropriate level. Adjust your audio source component volume to maximum.

### **DISTORTED**

- Too much water retention inside the speaker grill. Turn the speaker over and gently shake it to let the water drain out.
- Press the "Scan" button on the speaker to best match the frequency of the transmitter.
- Change the position of the channel selector on the transmitter. You must then press the "Scan" button on the speakers.
- Battery capacity is too low. Replace with the new batteries.
- Ensure the volume level of speakers is adjusted properly.
- The speaker is too far from transmitter, move closer.
- The input level of the audio signal is too low. Turn up the volume of the audio source equipment.

## G. TECHNICAL SPECIFICATIONS

Transmission Mode	:	UHF stereo
Carrier Frequency	:	900 MHz
Operation Voltage	:	Transmitter, 4 X "AA" size Alkaline batteries (not included) or DC 6V 300mA adaptor (included) Speaker, 6 X "AA" size Alkaline batteries (not included)
Frequency Response	:	40Hz – 12KHz
Distortion	:	1.5%
S/N Ratio	:	65dB (typical)
Channel Separation	:	35dB (Typical)
Operation Distance	:	Up to 150feet
Output Power	:	3W (Max)

WARNING : Changes or modifications to this unit not expressly approved by the party responsible for compliance could void the user's authority to operate the equipment. Operation is subject to the following two conditions: (1) this device may not cause interference, and (2) this device must accept any interference, including interference that may cause undesired operation of the device.

This device complies with RSS-210 of Industry and Science Canada. Operation is subject to the following two conditions: (1) this device may not cause interference, and (2) this device must accept any interference that may cause undesired operation of the device.

This product may contain chemicals listed in Proposition 65

([http://www.oehha.ca.gov/prop65/prop65\\_list/Newlist.html](http://www.oehha.ca.gov/prop65/prop65_list/Newlist.html)) that may be known to cause cancer, birth defects or other reproductive harm.



Thank you for your purchase with Grace Digital Audio. All Grace products purchased in the United States of America are supported by a conditional warranty.

## WARRANTY

Grace Digital Inc. guarantees this item for a period of 1 year from the original date of purchase. This guarantee covers the replacement of equipment that proves to be faulty as a result of manufacturing faults only. No liability can be accepted for faults arising from accident or misuse.

In the event your equipment requires warranty attention and/or service, please contact Grace Digital Inc., at [www.gracedigitalaudio.com](http://www.gracedigitalaudio.com).

In the event a replacement is required and there is a shortage of stock, Grace Digital Inc. reserves the right to replace faulty items with similar equipment of equivalent value.

This warranty is applicable in the United States only and does not in any way limit the customer's legal rights. Claims and enquiries under the warranty for Grace products purchased outside the USA should be addressed to the local importers or distributors. If you have reason to claim under the warranty please contact your dealer in the first instance. Please retain all original packaging materials for possible future use. We suggest that you complete details of purchase now and keep this information in a safe place for future reference.

## CONDITIONS

1. This Warranty will be granted when the original invoice or sales receipt (with proof of date of purchase, product type and dealer's name) is presented together with the defective product.
2. This guarantee will not reimburse nor cover the damage resulting from adaptations or adjustments which may be made to the product.
3. This guarantee will not include any or some of the following:
  - i. Maintenance and/or repair of parts due to normal wear and tear.
  - ii. Changes to the product from its normal purpose as described in the instruction manual.
  - iii. Transportation costs, home service costs and all related risks and costs of transport.
4. Damage resulting from any of the following:
  - i. Misuse including using for a purpose other than intended, installation or use of the product in a manner inconsistent with the technical or safety standards, improper or incorrect installation.
  - ii. Repair done by non-authorized establishment or individual.
  - iii. Accidents including lightning, water, fire, improper ventilation or any cause beyond the control of Grace Digital Inc.

## Free Manuals Download Website

<http://myh66.com>

<http://usermanuals.us>

<http://www.somanuals.com>

<http://www.4manuals.cc>

<http://www.manual-lib.com>

<http://www.404manual.com>

<http://www.luxmanual.com>

<http://aubethermostatmanual.com>

Golf course search by state

<http://golfingnear.com>

Email search by domain

<http://emailbydomain.com>

Auto manuals search

<http://auto.somanuals.com>

TV manuals search

<http://tv.somanuals.com>