

ALSO FROM IFB

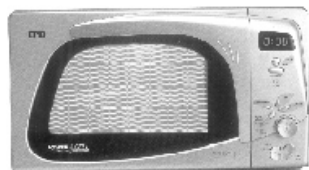

MICROWAVE OVEN
CAPACITY - 17 to 30 LITERS



CLOTHES DRYER
CAPACITY - 5.5KG



DISHWASHER
CAPACITY - 12 PLACE SETTING

IFB

Customer Care

Dial

1860 425 5678 - BSNL & MTNL Callers

3900 4321 - Other Callers

IFB

Fully Automatic Washing Machine Operation Manual

MODEL: AW60-806

IFB Industries Limited, Plot No. IND - 5, Sector - 1, East Calcutta Township, Calcutta - 700 078
Visit us at www.ifbappliances.com

Thank you for selecting this fully automatic washing machine
Before operating this unit, please read this operation manual thoroughly



INDEX

Features and accessories	2
Names of respective parts and simple installation	3
Simple installation	3
Installation of the water inlet hose	4
Installation of the drain hose	5
Power source and grounding	6
Installation of the base cover	6
Simple operation	6
Control panel design	7
Way of use	9
Operation method	11
Button operation steps	11
EF programe	11
Preset programe	11
Confirmation of the preset and inspection	11
Cancel the preset,alternate preset time	12
Child-lock function	12
Soak wash	12
Wash of blanket	13
Use the cleaning solution for twice	13
Load size and detergent	14
Weight standard of clothes	14
Washing tips	14
Method of maintenance	15
Trouble shooting	16
Other functions	17
Precautions	18
Specifications	Back cover

FEATURES AND ACCESSORIES

FEATURES

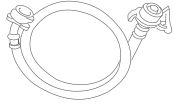
- Transparent window, unique outlook design: Adopting the vogue transparent cover, let's be clear at a glance in the course of washing.
- Spraying water flow, washing more drastically: Adopting unique pulsator can produce spraying water flow from the bottom, to break up the wrapped clothing, so that the clothing can be washed more sufficiently and uniformly.
- Dynamic soak, powerful washing: Adopting the model of dynamic soak, the detergent will better be dissolved by water and fully infiltrated into the clothes, especially wash the stubborn dirt off the clothes.
- Complete function, easy and simple using: The fully automatic program, delay washing, soak functions and fuzzy washing etc, ever and again satisfy your family's needs of washing clothes.
- Slight vibration, low noise: The sun-and-planet gear technology is applied to the mechanical transmission devices, reducing the mechanical noise.
- Compact structure, pleasing appearance and durable: The mezzo-capacity, the cabinet sprayed with plastic powder and the base made of engineering plastic, it is resistible to corrosion and durable.
- Memory back-up function: The washing machine has an in-built memory function, thus ensuring that it will start from the same point from where it has stopped, on resumption of power supply. This prevents you from harassment of the power cut which provide your family with a comfortable washing environment.
- Suggestion: If the voltage range exceed $230V \pm 15\%$, we suggest add a manostat to the washing machine.

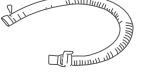
Accessories (Part of standard machine)			
			Fixing ring(1) is used for the fixation in time of the installation of the drain hose 
Universal connector(1)	Water inlet hose assembly(1)	Base cover (1) Self-tapping screw (1)	

NAMES OF RESPECTIVE PARTS AND SIMPLE INSTALLATION

Names of respective parts

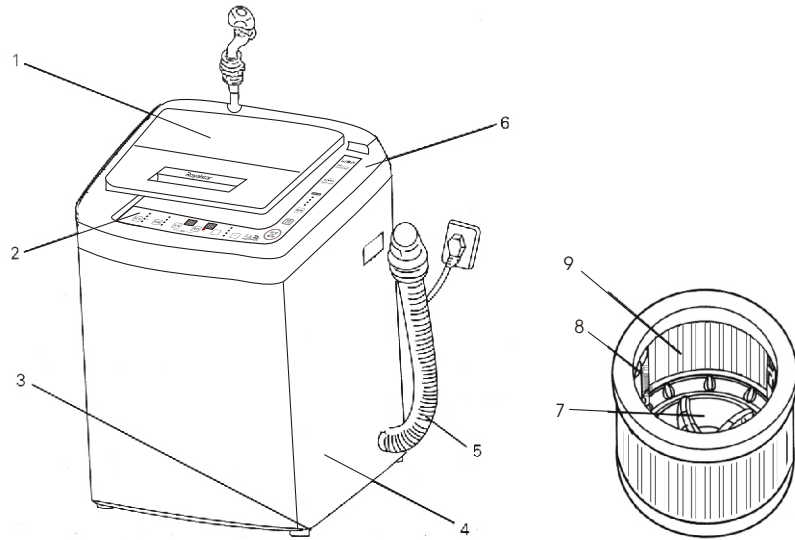

1. Top lid 2. Operation panel 3. Adjustable leg 4. Cabinet
5. Drain hose 6. Top frame 7. Pulsator 8. Lint filter 9. Inner tub

Simple installation

- Step 1:** The washing machine should be placed inside the room with a flat floor, which is convenient for water supply and drain, has low moisture and no direct sunshine, and does not freeze in winter.
- Step 2:** All foam packing (including the fixing frame on the base foam) should be taken off, otherwise the washing machine will not work.
- Step 3:** Please adjust the washing machine even according to the instructions below to make the washing machine run steadily in low noise.
1. Loosen the fixing pole on the adjusting foot, screw in or screw out the adjusting foot to make the four feet placed even on the floor.
 2. When the floor is slanting or uneven, it is not easy to make even only by the adjusting foot. Then the rubber band can be added to the un-flat place.

3

SIMPLE INSTALLATION

3. Use a spirit level to check whether the washing machine is placed flat.
4. After the adjustment, the fixing pole should be screwed back and tight.

Notices:

☞ If the washing machine is not placed flat (the inclination angle is over 2°), it may cause great vibration or automatic check and rectification or other abnormal circumstances will often take place in the course of spinning.

All foam packing including the fixing frame on the base foam in step 2.

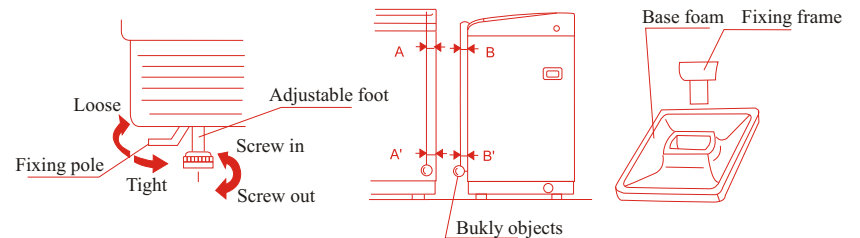

Step 4: Installation of the water inlet hose

1. Check the tap mouth. If it is not even, it can be filed even.
2. Loosen the locking ring slightly, screw the four screws into the universal connector at the same distance.
3. Put the tap deeply into the universal connector, then screw in the screws.
4. Screw tight the locking ring clockwise to the most.
5. Pull the skirt of one end of the water inlet hose downwards, and then plug in the universal connector. A sound of "KA-TA" means proper connection.

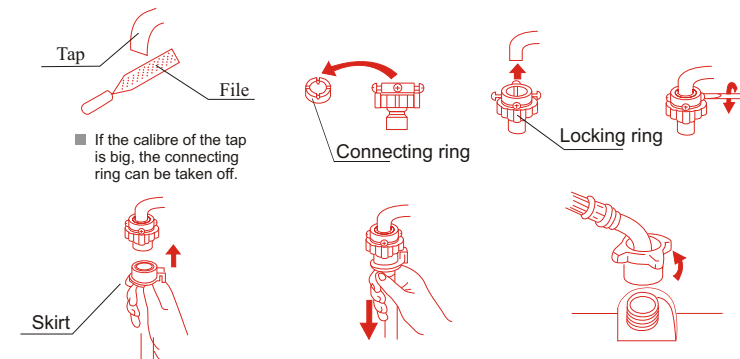

4

SIMPLE INSTALLATION

Notices:

- After installation, do not start the washing machine in haste. First open the tap to let the water press into the water inlet hose to check whether there is any leakage in the connectors on the both ends. When the pressure is too high, please shut the tap a little to avoid water leakage.
- The method of installation for the double water inlet hose is same.

Step 5 Installation of the drain hose

1. Nip the fixing ring with hand to make it loose and engaged on the drain hose and put the drain hose into the leading skirt of drain hose in the bottom of the washing machine to the end at the most (soak the head of the drain hose in warm water, it will make the engagement easy), and loose the fixing ring to let it clasp the drain hose.

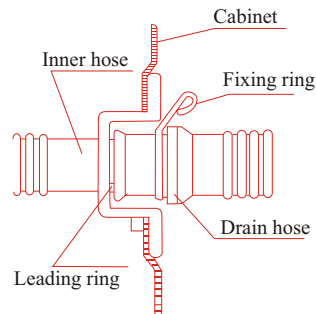

2. It had better put the outlet of the drain hose into the nearby drainage permanently, which can save the trouble that the drain hose has to be connected each time before use. If the drainage is far from the washing machine, it can be solved by connection of the drain hoses head with end to extend.

SIMPLE INSTALLATION AND SIMPLE OPERATION

Step 6: Power source and grounding

The washing machine employs alternative current with the rated voltage and frequency. When the voltage fluctuates between 10% of rated voltage, the washing machine can work normally. A special power socket for the washing machine had better be set beside the washing machine for convenience and safety. The method of connection of the socket is as the figure below:

Notices:

- The socket and the grounding wire must be installed by an electrician to prevent incorrect installation or use of the socket, and to guarantee the safety of use of electricity.
- The power wire of the washing machine employs Y connection and the replacement of the power wire should be carried out by professionals.
- No connection of the grounding wire with the neutral wire, otherwise the cabinet will be charged, which is likely to cause the danger of electric shock.

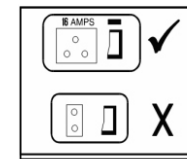
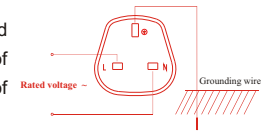

Step 7 Installation of the base cover

- Slant the washing machine with angle of 45° in the direction of the arrows showed in the figure, put the side with the clasper to the washing machine and the other side to the ground, insert base cover along the direction of the upper slot of the base from the back side of the washing machine.
- Put the base cover straight to the point and then press the base cover upward till there is a sound of "Gaba" and then screw in a self-tapping screw (without the self-tapping screw for plastic cabinet).

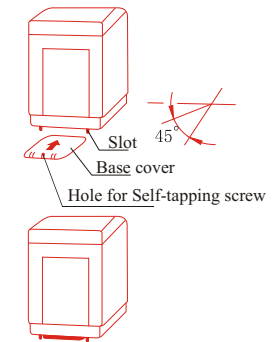

Simple operation

Preparations before using:

- Hang the drain hose up, the high is about 1 m.
- Connect the water inlet hose and open the tap.
- Put the power plug into the socket.
- Take out the coins and other sundries and shake off the mud and sand on the clothes.
- Determine water level. Press "Water level" button to select the water level.
- Press "Power" switch button.
- Press "Start/Pause" button. The washing machine will go into operation by the automatic program of standard.

Notices:

If you want to set other programs, please see and read "Full automatic program" and "Self-program". According to your needs, select corresponding programs for your service.

CONTROL PANEL DESIGN

CONTROL PANEL DESIGN

AIR-DRY

- Press the button, you can choose air-dry time freely.
- You also can select tub-clean.

EF

- Press the button, you can select single EF programme or combine EF programme.

Water level

- Press water level button, the user can set water level freely.
- Wool programme can select 10-16 level.
- Rapid programme can select 1-10 level. Others can select 1-16 level freely.

Preset

- Press the button to preset delay time. Less than 24 hours, each press of the button, the delay time is added by an hour. For more than 24 hours, each press of the button, the delay time is added by 6 hours. After 48 hours, the preset indicator comes back to original status. If the button is kept pressed, the delay time will automatically change.

Child Lock

- Please read "Additional explanation".

FULLY AUTOMATIC PROGRAM

IFB

AW60-806

Fully Automatic Washer

6.0kg

Light/Flash

Normal ● Fuzzy
Rapid ● Last time
Delicate ● Child
Bulky ● Wool

Power

- On & off power
- Automatic power off

Start/Pause

- After program selection, press the button to start.
- Press the button to pause in the course of operation, press the button again the program continues till the program is finished.

Selection of function

- Press the button to select "WASH"+"RINSE"+"SPIN", "SOAK"+"WASH"+"RINSE"+"SPIN", "WASH", "WASH"+"RINSE", "RINSE"+"SPIN", "SPIN".

Program

- By washing requirement you may optional select the programs of "NORMAL(light)"/"FUZZY"(flash), "RAPID(light)"/"LAST TIME"(flash) "DELICATE"(light)"/"CHILD"(flash) "BULKY"(light)"/"WOOL"(flash)

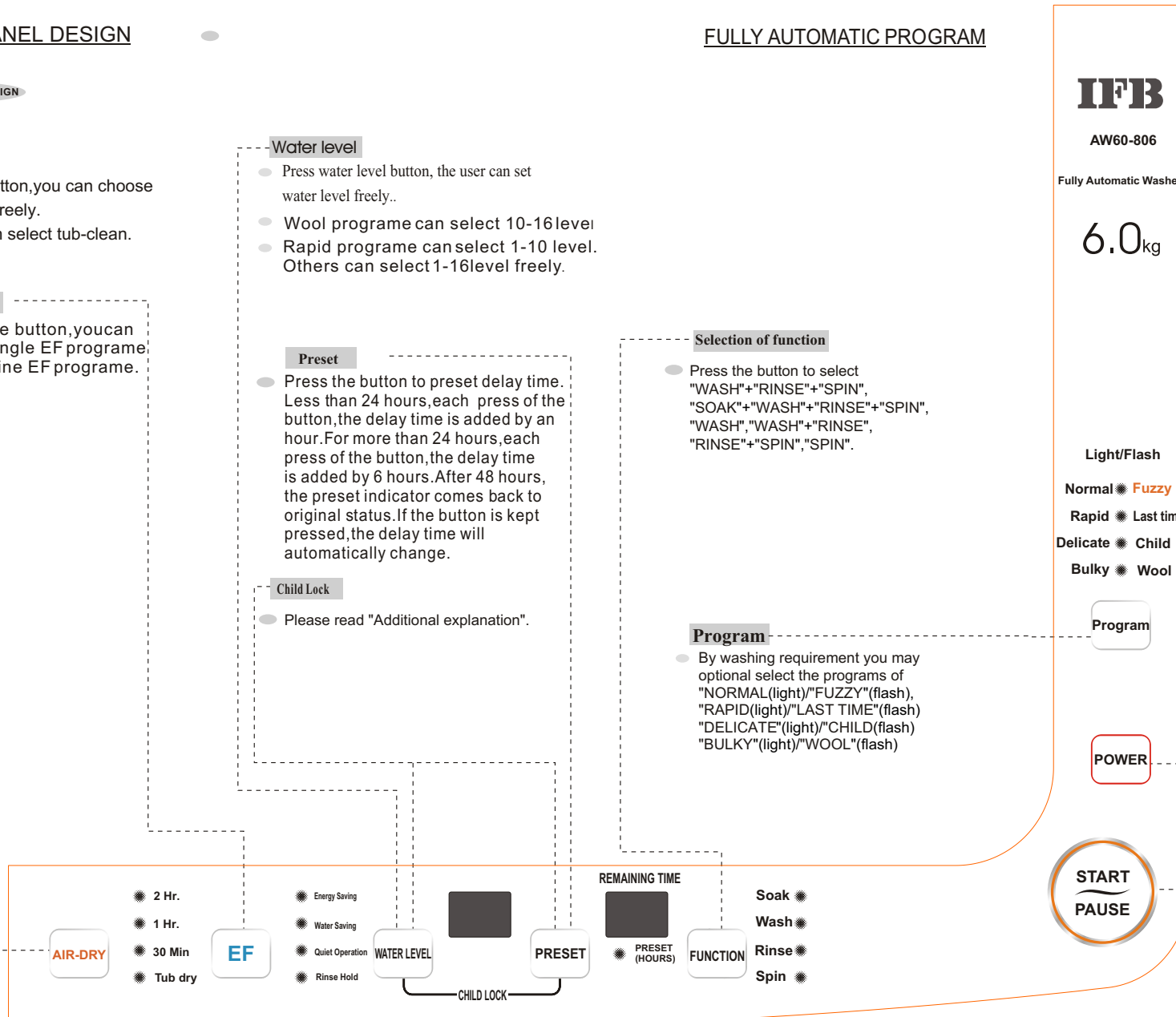

! In order to protect controller, the interval of switching on and off power should be more than 30 seconds.

If drawing is changed, no inform any more.

WAY OF USE

Preparations before using

1. Hang the drain hose.
2. Connect the water inlet hose. The loading and unloading method of the water inlet hose can be seen in page 3-4.
3. Connect the power..
4. Take out the coins and other sundries and shake off the mud and sand on the clothes.

Program	Feature and usage	Way of use	Washing		
			Wash	light flashes	
Normal program	Powerful in washing and widely applicable, especially in spring, autumn and winter.	Step1-step4 is same with usual program.	Water injection	Washing for 12 minutes	
Rapid program	Washing time is short and applicable for small volume, not more than 3.5Kg, and the degree of stain of the clothes is light.	Step5: Press button "Power", switch on, all lights flash three times.		Washing for 3 minutes	
Bulky program	Washing intensity is high and spinning time is long, water level is high.	Step6: Press any button of "Normal", "Delicate", "Rapid", "Soak", "Child's clothes", "Heavy wash", "Bulky", "Anti-crease" to select the program you want and the corresponding light is on.		Soaking for 20 minutes Washing for 15 minutes	
Child's clothes program	The times for rinse is much, and the water level is high, so it can rinse the clothes clearly, avoiding the remaining detergent in the clothes which hurts the skin of children.	Step7: Press button "Start/Pause", the washing machine will be started. Press again during the process of running the washer will be paused.		Soaking for 20 minutes Washing for 15 minutes	
Fuzzy program	Auto select washing intensity.			Washing for 12 minutes	
Delicate program	Water flow is soft, applicable for delicate clothes such as silk clothes.			Washing for 12 minutes	
Wool program	Be fit for washing wool			Soaking for 20 minutes Washing for 15 minutes	
Last time program	Start at last time programe you choose.				

*

WAY OF USE

Fully automatic program

There are eight fully automatic programs that can automatically complete the whole courses of "Wash", "Rinse", "Spin", and features and usage of each process and the method of use are as below: (preparations before use are the same as the above-mentioned preparations).

Rinse / Rinse light flashes										Spinning/Spinning light flashes	Total time		
Rinse for the first time			Rinse for the second time			Rinse for the third time							
Drain	Water injection	Spinning for 3 minutes	Washing for 3 minutes	Spinning for 3 minutes	Water injection	Washing for 4 minutes				Spinning for 6 minutes	About 41 minutes		
		Spinning for 1 minutes and soak 30 seconds with spraying	Washing for 2 minutes									Spinning for 2 minutes	About 10 minutes
		Spinning for 3 minutes	Washing for 3 minutes	Spinning for 4 minutes	Washing for 3 minutes	Spinning for 3 minutes	Washing for 4 minutes						
		Spinning for 3 minutes	Washing for 4 minutes	Spinning for 3 minutes	Washing for 4 minutes	Spinning for 3 minutes	Water injection	Washing for 4 minutes					
		Spinning for 3 minutes	Washing for 4 minutes	Spinning for 3 minutes	Water injection	Washing for 4 minutes							
		Spinning for 2 minutes	Washing for 4 minutes	Spinning for 2 minutes	Water injection	Washing for 4 minutes							
		Spinning for 3 minutes	Washing for 4 minutes	Spinning for 3 minutes	Washing for 4 minutes								

OPERATION METHOD

Button operation steps

1. This washing machine has many extended functions, please operate it as per the below steps. Some of the functions of this washing machine if you don't want to operate, you only need to do is to skip it.
1. Operate the above mentioned steps range from "1" to "5".
2. Pressing program button to select the relevant programs that you choose to operate.
3. When choose delicate, fuzzy, last time, wool, the other functions can not be altered.
4. Pressing EF button to select the EF function. (Details of this function please refers to the EF operation steps).
5. Pressing water level button to select the appropriate water levels.
6. Pressing delay button to set the delay time. (Details of this function please refers to the delay operation steps).
7. Pressing "START/PAUSE" button to start the machine with the provision that the power is on, then close the top cover of the machine itself.

EF PROGRAME

1. When "normal" program is selected, then "rinse" or "washing" are chosen at the same time, it is better to choose "energy saving" function.
2. "Water saving" can be used to reduce rinse times when there is more than one time of rinse, rinse times would be reduced by one time, at the same time, one time of spray is added.
3. "Rinse hold" function is recommended to be chosen together with "spin". The washers buzzing sound. Will remind you of recycling water at the last time of spin.
4. "Water saving" and "rinse hold" are not achievable at the same time.

Preset program

Preset time means the beginning time of washing.

1. Switch on "Power" button.
2. Open the tap and lay down the drain hose.
3. Load laundry and put detergent.
4. Select the proper water level according to the quantity of clothes.
5. Select the functions and programs.
6. Press "Preset" button to select the beginning time of washing.
7. Press "Start/Pause" button and close the lid.

Confirmation of the preset and inspection

After the preset is started, the corresponding light will be turned on, and other lights are turned off.

After the preset is started, press "Preset" button continuously, you may see the selected programs and the rest of the preset time. Loosen the button, the program will automatically come back to preset status.

OPERATION METHOD

Cancel the preset, or alter the preset time

Before the program is started, the preset indicator lights, the preset time is selected from 1 to 48 hours, after the preset time is set over 48 hours, the preset indicator is turned off, the function will be cancelled.

Press power switch to end program, and to cancel preset function at the same time.

To change the preset time, please press "Power", and then press "Preset" button to re-preset.

Child-lock function

Child-lock function: after power-on of the machine, press of both "water level" and "preset" buttons means start of "child-lock" function. Then all functions are not accessible. Digital display shows "CL" every five seconds. Press again, both "Water level" and "Preset" to disable "Child-lock" function

Soak wash

1. Switch on the power, open the tap and lay down the drain hose.
2. Put in the washing and detergent, close the lid.
3. Select proper water level and programs according to the weight of clothes and the clothes's varieties.
4. Press the "FUNCTION" button, select "SOAK", the lights of "SOAK" "WASH" "RINSE" "SPIN" will get turned on.
5. Press "START/PAUSE" button.

AIR DRY

The function is to dry clothes by air. The efficiency of air dry is about 60%, and suggest 50% load in the tub for drying.

OPERATION METHOD

Wash of blanket

The weight of blanket should be less than 4kg, and please select the “bulky ” program for washing.

Steps:

1. Dissolve the detergent with proper amount of warm water (below 50?), then pour it into the washing machine.
2. Fold up the blanket as the method showed in the figures below and put it into the washing tub.
3. Switch on the power and press the "Program" button to select the "Bulky" program and "High" or "Medium" water level.
4. Press the "Start/Pause" button, and close the lid.
5. After the end of washing, put it to clothes line for sunshine. Make sure that the blanket is flat and free of wrinkle.

Notices:

Only the blanket with marks "Hand wash" is washable.

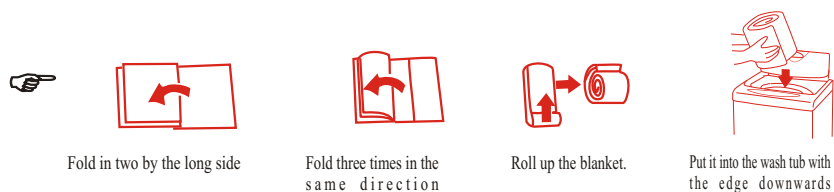

● Use the cleaning solution for twice

1. Put in the washing in the first batch and detergent and press "Wash" or "Function" button to set the Single "wash" to run.
2. Take out the washing in the first batch after hearing the buzzing sound.
3. Put in the washing in the second batch, and run "Wash", "Rinse", "Spin".
4. Take out the washing in the second batch after hearing the buzzing sound.
5. Put in the washing in the first batch and press "Function" button to run "Rinse" and "Spin".

● Pre-wash of dirty clothes

One of the "Rinse/Spin" program can be selected to perform pre-wash as for clothes seriously stained with mud, and then add washing powder and select the full program to wash.

Notices:

Please use the water that temperature is below 50°C.

If the water level is less than the set "Water level", the machine will add water automatically.

OPERATION METHOD

● Load size and the detergent

Water level	Water volume	Weight of washing	Washing powder
15-16	About 48L-50L	<5.5kg	About 53g
13-14	About 46L-48L	<4.8kg	About 48g
11-12	About 44L-46L	<4.2kg	About 43g
9-10	About 42L-44L	<3.6kg	About 37g
7-8	About 39L-42L	<3.0kg	About 32g
5-6	About 36L-39L	<2.4kg	About 27g
3-4	About 33L-36L	<1.8kg	About 21g
1-2	About 30L-33L	<1.2kg	About 16g

Notices:

- The highest priority of using the detergent is low and mid foam detergent.
- The volume of detergent is changed with different type. You need read its user manual
- Water volume is different because of clothes variety. When the washing machine runs not well, please adjust clothes volume and water level.
- The water volume above listed is based on normal clothes volume.

● Weight standard of the clothes

Union suit including coat and trousers (blended) about 800g	Pyjamas including coat and trousers (cotton) about 500g	Long sleeves shirt (blended) about 200g	Short sleeves shirt (cotton) about 130g
Bedsheet (cotton) about 500g	Bath towel (cotton) about 300g	Trunks (cotton) about 50g	Socks (blended) about 50g

● Washing tips



- * put the easily damaged and loose clothes into mesh before washing.
- * put bulk clothes and easily suspended clothes at the bottom of tub.
- * Turn the easily damaged face of clothes inside before washing.
- * If the clothes hold webbing and zipper you need to tie and zipper that before washing.
- * Get rid of mud on clothes before washing.
- * you can add some washing powder on the specially dirty place before washing.

METHOD OF MAINTENANCE

The following cases are not faults

1. There is water injection in time of washing or rinse, which is due to that the washer senses the inadequacy of water and exchanges water level automatically.
2. There is the phenomenon of intermittent spinning in the beginning of spinning, which is performed to achieve better spinning effects.
3. In the course of spin, the program return to the wash program. Because that is designed to rectify the unbalanced distribution of load in the spin tub.

Method Of Maintenance

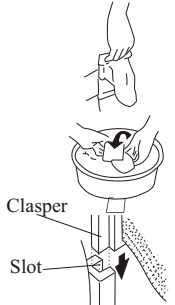
After the whole washing program	Maintenance of shell
<ul style="list-style-type: none"> ■ The washing machine will send off the "DOU-DOU" sound after any program operation to remind you of taking out the load or going on with other operations. ■ After finishing washing, please shut off the tap, pull out the plug in case of water leakage or fire 	<ul style="list-style-type: none"> ■ Use soft cloth to wipe off the water and dirt on the surface each time after use of the washing machine. Detergent, propellant and other chemicals are not allowed to use, for they can cause damage to the surface. 
Cleaning the water inlet	Cleaning of the lint filter
<p>After long time use, the water inlet mesh bag may be blocked with smudginess, and should be cleaned according to the following steps:</p> <ol style="list-style-type: none"> 1. Switch on the power, followed by shutting off the tap . 2. Let the washer works for 5 seconds so that water flows into the tub through the water inlet hose. then turn off the power. 3. Unload the water inlet hose and clean the mesh bag, then restore the water inlet assembly. 	<p>After using the washing machine for a period, please clean according the following steps:</p> <ol style="list-style-type: none"> 1. Take out the lint filter. 2. Turn the mesh bag outside and wash it clean in the water. 3. Restore it and refix it. 

TROUBLE SHOOTING

Exceptional phenomenon	Cause	Solution
No indication in controller	The power plug is not plugged tight. The power switch is not switched on. Not press "START/PAUSE" button. Power cut.	Re-plug the power plug. Check the power socket, or change other socket. Press "START/PAUSE" button. Wait for switching on electricity.
The inlet hose leakage	Do not rightly connect the tap with the universal connector. Do not screw tight the nut of the water inlet hose.	Re-install rightly the universal connector. Screw tight the nut.
Does not drain	The drain hose is wrung or jammed.	Loosen the drain hose for smooth flow of water
Dose not inject water	Stop water. Do not open the tap. Whether the wire netting in the water inlet was stopped up by the sundries.	Wait for coming water. Open the tap. Clean the netting according to the method of "Cleaning of the water inlet".
Spinning stops and water injecting begins in the course of spin	Cause by that the washing	This is automatic rectification for spinning in the washing program. That the washing are too much or too little, or that the washing machine is not placed plane will cause the unbalance in time of spinning. If there is still abnormal circumstances after checking the above-mentioned points, please pull out the power plug and contact with local service as soon as possible.
Does not spin	After end to drain, do not close the lid. Open the lid in course of spinning.	Close the upper lid.
Intermittent spinning	In order to attain the better spinning effect.	Belong to the normal phenomenon generally.
Before using the machine water exists in the drain hose.	Remainning water due to testing or experiment in the factory.	Belong to the normal phenomenon generally.

👉 Notices:

- The washing machine does not work normally because the voltage is low or too high. Please pull out the plug and wait till the voltage becomes normal.
- If there is still abnormal circumstances after checking the above-mentioned points, please pull out the plug. Do not repair it by yourself at home, which is very dangerous.

OTHER FUNCTIONS

● Function of fault alarm

Indication of fault	Cause of fault	Phenomenon of fault	Alarm of the buzzing sound	Solution of alarm
Alarm for water injection	Entering water less than 16 minutes, reset water	E1	The buzzer goes on buzzing sound for 10 seconds. If the alarm does not be solved, every 16 minutes re-buzzs for 10 seconds.	Open the lid to deal with faults, then close the lid to solve the alarm.
Alarm for opening lid	Open the lid after start the delay time. Open the lid when the washer is	E2		
Imbalance alarm	Be examined imbalance for the third time.	E3		
Drain alarm	After draining for 4 minutes, does not	E4		

● Function of automatic power-off

1. Start 10 minutes later to not work, automatically shut off the power.
2. After end to wash and the buzzer sounds 6 times, automatically shut off the power at once.

● Function of adjusting for unbalance

1. If the clothes are placed uneven before spinning, easy to result in bigger vibrancy of spinning. The washing machine has a function of adjusting unbalance. When working, the system of the washing machine always inspects running state. If finding a phenomenon that the spinning vibrancy is too big, the washing machine automatically start the adjusting program To adjust the clothes's state.
2. The washing machine can adjust unbalance twice, if no effect, it will alarm.

PRECAUTIONS

Safe use of power

Please plug the power cord into the special voltage. The plug-in and plug-out of the wire should go on with the plug held with hand.

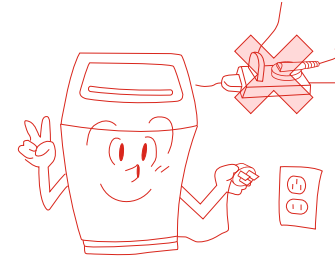

Keep away from dampness

Don't place the washing machine in extreme damp surroundings, for dampness may weaken the insulation of the machine, which may cause electric shock or faults.



Don't use hot water

Don't use hot water over 50°C to avoid deformation of the plastics.

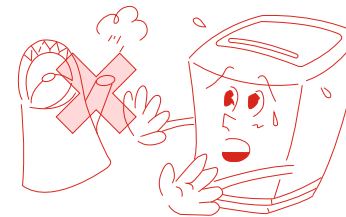

Don't open the lid in time of spinning

If the lid is opened in time of spinning, the washing machine will arrest at once, which will shorten the service life. Please avoid opening the lid in the course of operation as possible and furthermore, don't put hands into the tub, for it is very dangerous that the clothes wind the hand despite of low speed of rotation.



Avoid spray of water

Don't let water spray onto the switch or the control panel in case of electric shock and



Keep away from smoke and fire

Don't place lighted candles, cigarettes and thermos nearby to avoid fire accidents or deformation of the plastics.



WARRANTY

IFB Industries Ltd. ("The Company") warrants to the original domestic purchaser of this washing machine ("Appliance") that it is free from defects in workmanship and materials. During 24 months from the date of purchase of the new washing machine all the parts of the washing machine which prove to be defective in workmanship and/or materials shall be replaced or repaired free of charge on intimation to the company/ company's authorized service centre nearest to the place where the appliance is installed. This warranty is subject to limitations of warranty.



LIMITATIONS OF WARRANTY

1. This warranty is not valid in case of the following events:
 - a) If the warranty card is not fully and properly filled in and signed at the time of purchase/ installation by the company's authorized dealer / service engineer.
 - b) If the completed warranty card is not presented to the authorized personnel at the time of service / repair.
 - c) If the appliance is not used in accordance with manufacturer's instructions given in the **"Operating Manual"**.
 - d) If the washing machine has been installed, serviced, repaired, opened or tampered by any unauthorized personnel.
 - e) If defects arise/caused by accidents, alteration, misuse, neglect, abuse, substitution of original components with spurious/non genuine components, attacked by household pest /rodents, fire, flood, earthquake, lightning and/or any other acts of God/natural, calamities.
 - f) If defects arising with optional accessories like trolleys, rat mesh, machine cover, on-line filter, inlet/exhaust extension hoses, tap adapter, extended power supply cable, adjustment feet cover, etc. thereof.
 - g) If damages occur by improper electrical circuits outside the washing machine or by any electrical supply thereof.
 - h) If the machine serial number on the appliance is defaced, missing or altered.
 - i) If sea water or any substandard detergent has been used in the appliance.
 - j) If the appliance is taken out of India.
2. This warranty does not cover any type of painting, plating including rusting etc., or defects thereof.
3. The company is not liable for any incidental or consequential damages.
4. Parts replaced or repaired under this warranty are warranted throughout the remaining of the original warranty period.
5. The company is not liable for any delay in servicing due to reasons beyond the control of the company or any of its authorized service centre.
6. This warranty is not applicable, if the washing machine is used for commercial purpose or at places like institutions, hostels, hospitals, community halls and other similar applications.
7. For any service under this warranty beyond city/town/municipal limits from the company /authorized service centre, a fixed charge of Rs. 250/- will be collected from the customers in addition to the actual to and fro charges by the shortest route. Alternatively, the customer can bring the appliance to the nearest service centre for carrying out the necessary repairs, at customer's own cost.
8. During the warranty period, whenever the appliance is shifted from the original city of purchase to another city / town where service is provided by the company's authorized service agent, a warranty transfer charge of Rs. 300/- will be collected from the customer by the company's authorized service agent. The above charges also include the reinstallation charges of the appliance. However, in case of transfer to a city where the company provides direct service, a nominal charge of Rs. 250/- only will be collected from the customer towards reinstallation. The Company, however, shall not undertake the responsibility of shifting / transferring the appliance from the location where the appliance is originally installed.
9. This warranty is issued subject to the jurisdiction of Calcutta courts. and /or other judicial / quasi judicial forums having jurisdiction over the registered office of the company.
10. This is the **ONLY WARRANTY** covering the appliance given by the company.

CUSTOMER COPY

MODEL: AW60-806, S.R.NO: _____

DEALER'S NAME : _____

CUSTOMER'S NAME : _____

ADDRESS : _____

PIN CODE : _____

TEL. NO. (Resi.) _____ (Off.) _____

E-MAIL: _____

DATE OF PURCHASE : _____

SERVICE STATION COPY

MODEL: AW 60-806, S.R.NO: _____

DEALER'S NAME : _____

CUSTOMER'S NAME : _____

ADDRESS : _____

PIN CODE : _____

TEL. NO. (Resi.) _____ (Off.) _____

E-MAIL: _____

DATE OF PURCHASE : _____

SPECIFICATIONS

Size	526X536X885 m	Weight of the product	30kg
Rated input power	340W	Rated capacity of wash and spinning	6.0kg(dry clothes)
Rated voltage	230V~	Maximum water pressure permitted in the water inlet	0.6Mpa
Rated frequency	50Hz	Minimum water pressure permitted in the water inlet	0.1Mpa

I OWN THE FOLLOWING PRODUCTS: (Please tick in the box)

COLOUR TV REFRIGERATOR AIR CONDITIONER

DISH WASHER MICROWAVE OVEN CLOTHES DRYER

FRANCHISEE ATTACHED: _____

Free Manuals Download Website

<http://myh66.com>

<http://usermanuals.us>

<http://www.somanuals.com>

<http://www.4manuals.cc>

<http://www.manual-lib.com>

<http://www.404manual.com>

<http://www.luxmanual.com>

<http://aubethermostatmanual.com>

Golf course search by state

<http://golfingnear.com>

Email search by domain

<http://emailbydomain.com>

Auto manuals search

<http://auto.somanuals.com>

TV manuals search

<http://tv.somanuals.com>