



# Adjustable Drill Press Support MODEL H6238

## Introduction

The Model H6238 Adjustable Drill Press Support (**Figure 1**) provides stability and control for drilling long workpieces.

The Model H6238 was carefully packed when it left our warehouse. If you discover this unit is damaged after you have signed for delivery, *please immediately call Customer Service at (570) 546-9663 for advice.*

Save the containers and all packing materials for possible inspection by the carrier or its agent. *Otherwise, filing a freight claim can be difficult.*

When you are completely satisfied with the condition of your shipment, you should inventory the contents.

## Inventory (**Figure 2**)

|           |                                |   |
|-----------|--------------------------------|---|
| <b>A.</b> | Column Clamp.....              | 1 |
| <b>B.</b> | Clamp Plate.....               | 1 |
| <b>C.</b> | Center Support.....            | 1 |
| <b>D.</b> | Extension Arms .....           | 2 |
| <b>E.</b> | Roller Supports.....           | 2 |
| <b>F.</b> | Lock Knob M10-1.5 .....        | 5 |
|           | Clamp Hardware .....           |   |
|           | —Hex Bolts M8-1.25 x 100 ..... | 2 |
|           | —Lock Nut M8-1.25 .....        | 1 |
|           | —Wing Nut M8-1.25.....         | 1 |



**Figure 1.** Adjustable Drill Press Support.

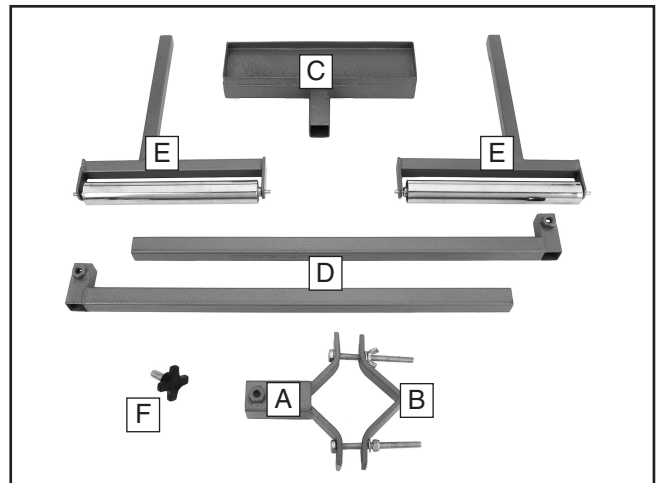
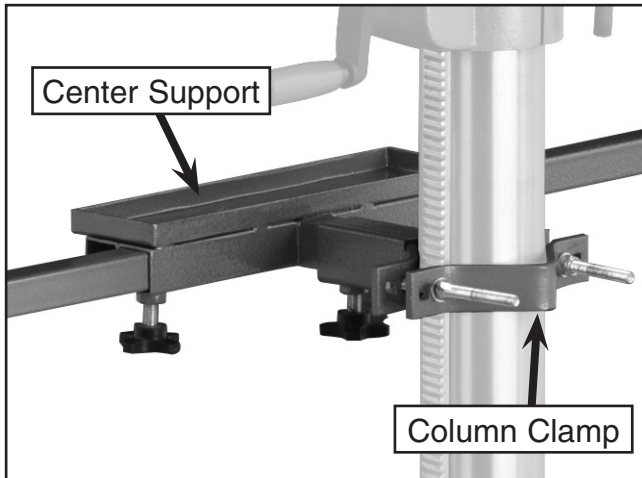

**Figure 2.** Inventory.



# ASSEMBLY

1. Use the hex bolts with a lock nut on one side of the column clamp and a wing nut on the other side to clamp the drill column as shown in **Figure 3**.



**Figure 3.** Column clamp.

2. Slide the center support into the column clamp and secure with a lock knob as shown in **Figure 3**.
3. Insert the extensions into the central support and secure with lock knobs (**Figure 4**).

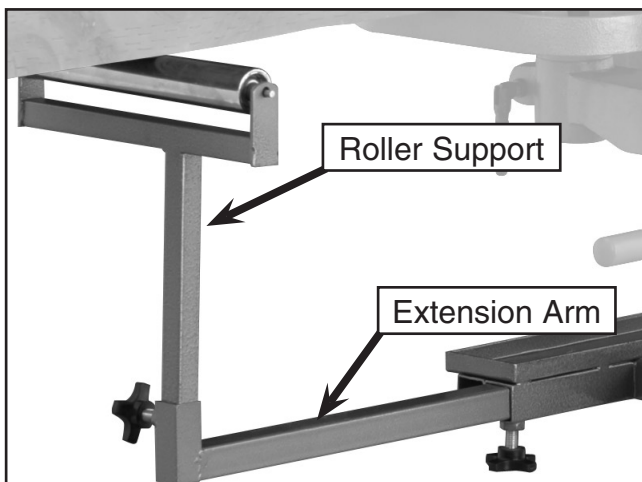

**Figure 4.** Support assembly.

4. Slide the roller supports into the extensions and secure with lock knobs (**Figure 4**).

# ADJUSTMENTS

1. Loosen the wing nut on the column clamp and rotate the drill press support perpendicular to the drill head. Tighten the wing nut.
2. Place a straightedge on the drill press table and adjust the roller supports until they are the same height as the drill press table.
3. Move the extensions in or out as necessary to accommodate the length of the workpiece.

*If you need additional help with these procedures, call our service department at: (570) 546-9663.*



## **!WARNING**

**Failure to follow these instructions will result in serious personal injury:**

1. The addition of the Drill Press Support increases the tipping hazard. Bolt the drill press to a solid surface to prevent tipping.
2. Make sure the extension arms are inserted at least 2" into the center support.
3. Use additional supports for extra long or unusually heavy workpieces.
4. Push extension arms in when not in use to reduce obstructions in your shop.
5. Center the workpiece to prevent tipping.
6. **DO NOT** exceed the weight capacity of the drill press table.



# PARTS BREAKDOWN

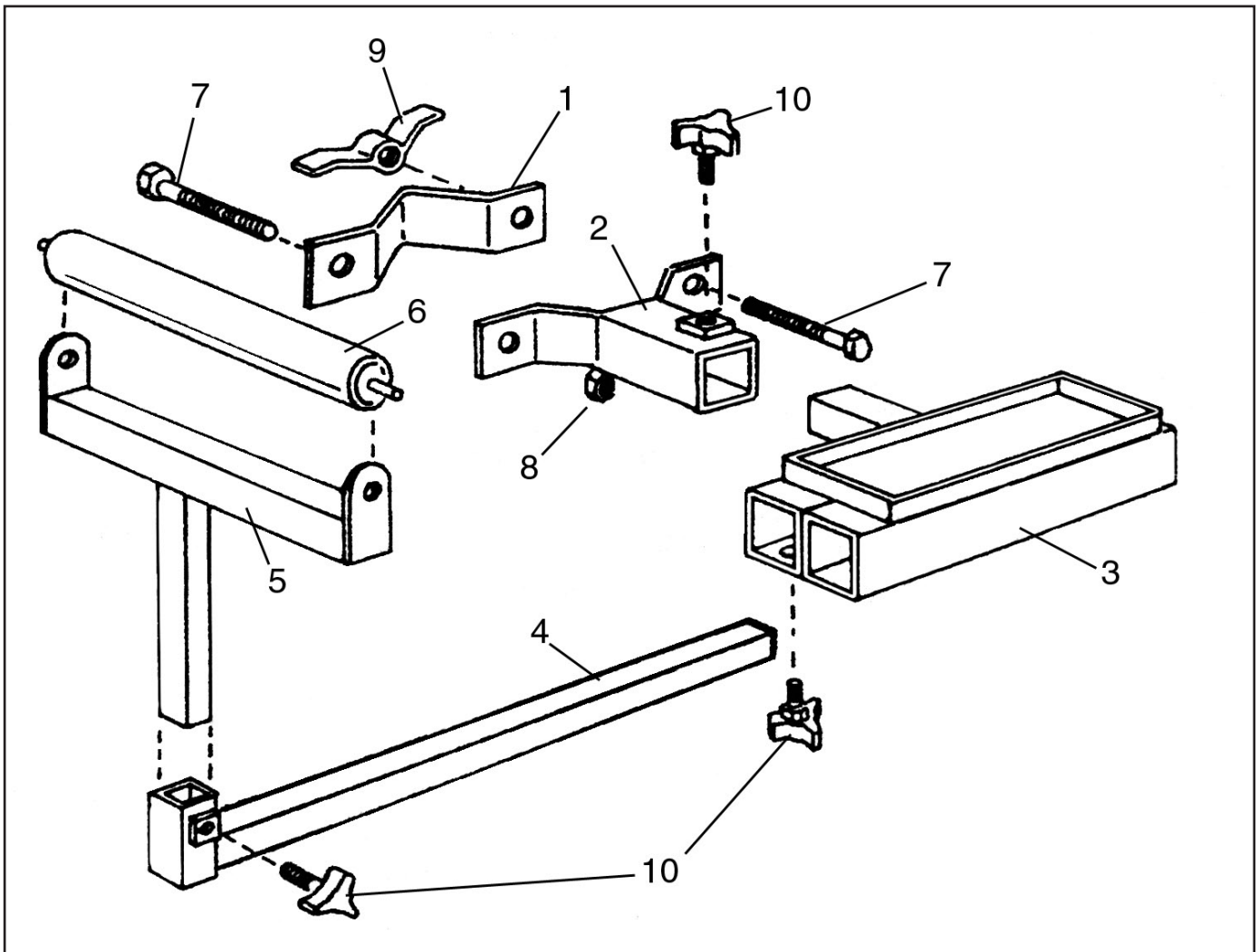

| REF | PART #    | DESCRIPTION            |
|-----|-----------|------------------------|
| 1   | PH6238001 | CLAMP PLATE            |
| 2   | PH6238002 | COLUMN CLAMP           |
| 3   | PH6238003 | CENTER SUPPORT         |
| 4   | PH6238004 | EXTENSION ARM          |
| 5   | PH6238005 | ROLLER SUPPORT BRACKET |

| REF | PART #    | DESCRIPTION            |
|-----|-----------|------------------------|
| 6   | PH6238006 | 10" ROLLER             |
| 7   | PB45M     | HEX BOLT M8-1.25 X 100 |
| 8   | PLN04M    | LOCK NUT M8-1.25       |
| 9   | PWN02M    | WING NUT M8-1.25       |
| 10  | PH6238010 | LOCK KNOB M10-1.5      |

COPYRIGHT © AUGUST, 2004 BY GRIZZLY INDUSTRIAL, INC.  
**WARNING: NO PORTION OF THIS MANUAL MAY BE REPRODUCED IN ANY SHAPE OR FORM WITHOUT THE WRITTEN APPROVAL OF GRIZZLY INDUSTRIAL, INC.**  
 #EW6462 PRINTED IN CHINA

## Free Manuals Download Website

<http://myh66.com>

<http://usermanuals.us>

<http://www.somanuals.com>

<http://www.4manuals.cc>

<http://www.manual-lib.com>

<http://www.404manual.com>

<http://www.luxmanual.com>

<http://aubethermostatmanual.com>

Golf course search by state

<http://golfingnear.com>

Email search by domain

<http://emailbydomain.com>

Auto manuals search

<http://auto.somanuals.com>

TV manuals search

<http://tv.somanuals.com>