

Grizzly **Industrial, Inc.**®

MODEL H7790/H7791 Laminate Trim Router OWNER'S MANUAL



COPYRIGHT © NOVEMBER, 2005 BY GRIZZLY INDUSTRIAL, INC.
**WARNING: NO PORTION OF THIS MANUAL MAY BE REPRODUCED IN ANY SHAPE
OR FORM WITHOUT THE WRITTEN APPROVAL OF GRIZZLY INDUSTRIAL, INC.**
#EW7626 PRINTED IN CHINA



WARNING!

Some dust created by power sanding, sawing, grinding, drilling, and other construction activities contains chemicals known to the State of California to cause cancer, birth defects or other reproductive harm. Some examples of these chemical are:

- **Lead from lead-based paints.**
- **Crystalline silica from bricks, cement and other masonry products.**
- **Arsenic and chromium from chemically-treated lumber.**

Your risk from these exposures varies, depending on how often you do this type of work. To reduce your exposure to these chemicals: Work in a well ventilated area, and work with approved safety equipment, such as those dust masks that are specially designed to filter out microscopic particles.

Table of Contents

INTRODUCTION.....	2
Foreword.....	2
Contact Information	2
Machine Data Sheet.....	3
Identification.....	4
SECTION 1: SAFETY.....	5
Safety Instructions for Machinery	5
Additional Safety Instructions for Laminate Trim Routers	7
Electrical Safety	8
SECTION 2: OPERATIONS	9
Unpacking/Inventory	9
Removing/Installing Router Bit	9
Adjusting Bit Depth	10
Feed Direction	10
Routing Operations.....	11
Routing Tips	11
Curved Trim Guide	12
Straight Guide.....	12
Template Guide	14
SECTION 3: ACCESSORIES.....	15
SECTION 4: MAINTENANCE	17
Router Maintenance	17
Replacing Brushes.....	17
H7790 Parts.....	18
H7791 Parts.....	19
WARRANTY AND RETURNS	20

INTRODUCTION

Foreword

We are proud to offer the Grizzly Model H7790/H7791 Laminate Trim Router. These models are part of a growing Grizzly family of fine power tools. When used according to the guidelines set forth in this manual, you can expect years of trouble-free, enjoyable operation and proof of Grizzly's commitment to customer satisfaction.

It is our pleasure to provide this manual with the Model H7790/H7791 Laminate Trim Router. It was written to encourage safety considerations and guide you through general operating procedures and maintenance.

The specifications, details, and photographs in this manual represent the Model H7790/H7791 as supplied when the manual was prepared. However, owing to Grizzly's policy of continuous improvement, changes may be made at any time with no obligation on the part of Grizzly.

Contact Information

If you have any comments regarding this manual, please write to us at the following address:

Grizzly Industrial, Inc.
C/O Technical Documentation
P.O. Box 2069
Bellingham, WA 98227-2069

Most importantly, we stand behind our tools. If you have any service questions or parts requests, please call or write us at the location listed below.

Grizzly Industrial, Inc.
1203 Lycorning Mall Circle
Muncy, PA 17756
Phone: (570) 546-9663
Fax: (800) 438-5901
E-Mail: techsupport@grizzly.com
Web Site: <http://www.grizzly.com>

WARNING

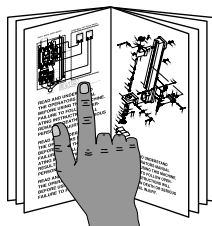

Read the manual before operation. Become familiar with this tool, its safety instructions, and its operation before beginning any work. Serious personal injury may result if safety or operational information is not understood or followed.



MACHINE DATA SHEET

Customer Service #: (570) 546-9663 • To Order Call: (800) 523-4777 • Fax #: (800) 438-5901

Laminate Trim Router Models H7790 and H7791

MODEL	H7790	H7791
HP	5/8	1/2
NO LOAD SPEED	30,000 RPM	30,000 RPM
COLLET SIZE	1/4"	1/4"
MAX. BIT DIAMETER	1 1/8"	1 1/8"
WEIGHT	4 lbs.	4 lbs.

Identification

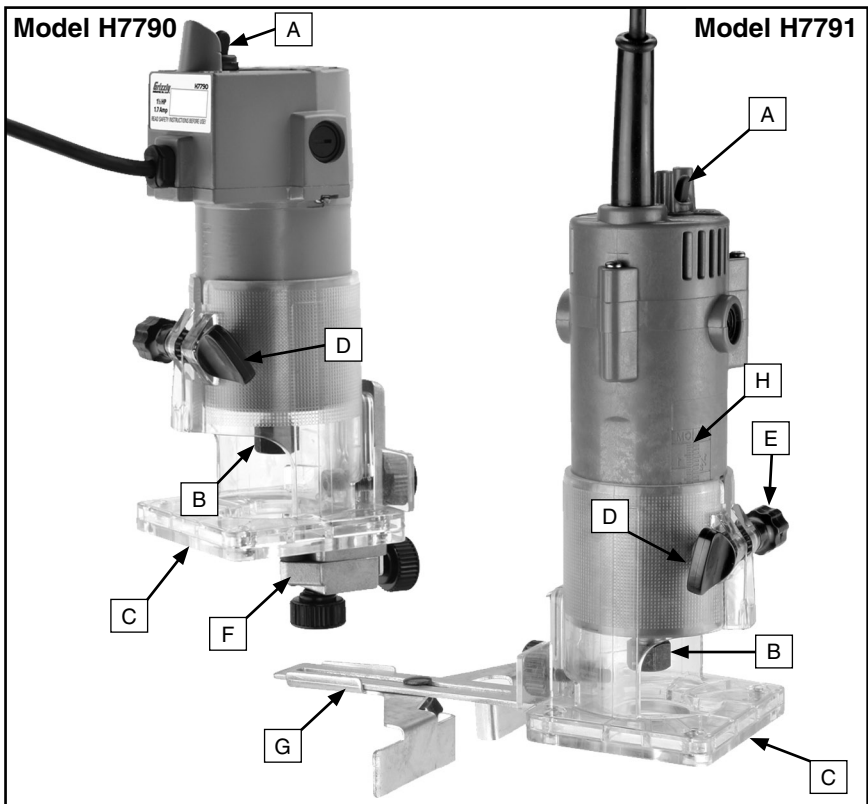

Figure 1. Router component identification.

- A.** ON/OFF Switch
- B.** Collet
- C.** Base Plate
- D.** Height Adjustment Lock Knob
- E.** Height Adjustment Knob
- F.** Curved Trim Guide
- G.** Straight Trim Guide
- H.** Depth Scale

SECTION 1: SAFETY

WARNING

For Your Own Safety Read Instruction Manual Before Operating This Equipment

The purpose of safety symbols is to attract your attention to possible hazardous conditions. This manual uses a series of symbols and signal words which are intended to convey the level of importance of the safety messages. The progression of symbols is described below. Remember that safety messages by themselves do not eliminate danger and are not a substitute for proper accident prevention measures.



Indicates an imminently hazardous situation which, if not avoided, **WILL** result in death or serious injury.



Indicates a potentially hazardous situation which, if not avoided, **COULD** result in death or serious injury.



Indicates a potentially hazardous situation which, if not avoided, **MAY** result in minor or moderate injury. It may also be used to alert against unsafe practices.

NOTICE

This symbol is used to alert the user to useful information about proper operation of the equipment.

WARNING

Safety Instructions for Machinery

- 1. READ THROUGH THE ENTIRE MANUAL BEFORE STARTING MACHINERY.** Machinery presents serious injury hazards to untrained users.
- 2. ALWAYS USE ANSI APPROVED SAFETY GLASSES WHEN OPERATING MACHINERY.** Everyday eyeglasses only have impact resistant lenses, they are NOT safety glasses.
- 3. ALWAYS WEAR AN ANSI APPROVED RESPIRATOR WHEN OPERATING MACHINERY THAT PRODUCES DUST.** Wood dust is a carcinogen and can cause cancer and severe respiratory illnesses.
- 4. ALWAYS USE HEARING PROTECTION WHEN OPERATING MACHINERY.** Machinery noise can cause permanent hearing damage.
- 5. WEAR PROPER APPAREL.** DO NOT wear loose clothing, gloves, neckties, rings, or jewelry which may get caught in moving parts. Wear protective hair covering to contain long hair and wear non-slip footwear.
- 6. NEVER OPERATE MACHINERY WHEN TIRED, OR UNDER THE INFLUENCE OF DRUGS OR ALCOHOL.** Be mentally alert at all times when running machinery.

7. **ONLY ALLOW TRAINED AND PROPERLY SUPERVISED PERSONNEL TO OPERATE MACHINERY.** Make sure operation instructions are safe and clearly understood.
8. **KEEP CHILDREN AND VISITORS AWAY.** Keep all children and visitors a safe distance from the work area.
9. **MAKE WORKSHOP CHILD PROOF.** Use padlocks, master switches, and remove switch keys.
10. **NEVER LEAVE WHEN MACHINE IS RUNNING.** Turn power **OFF** and allow all moving parts to come to a complete stop before leaving machine unattended.
11. **DO NOT USE IN DANGEROUS ENVIRONMENTS.** DO NOT use machinery in damp, wet locations, or where any flammable or noxious fumes may exist.
12. **KEEP WORK AREA CLEAN AND WELL LIT.** Clutter and dark shadows may cause accidents.
13. **USE A GROUNDED EXTENSION CORD RATED FOR THE MACHINE AMPERAGE.** Undersized cords overheat and lose power. Replace extension cords if they become damaged. DO NOT use extension cords for 220V machinery.
14. **ALWAYS DISCONNECT FROM POWER SOURCE BEFORE SERVICING MACHINERY.** Make sure switch is in **OFF** position before reconnecting.
15. **MAINTAIN MACHINERY WITH CARE.** Keep blades sharp and clean for best and safest performance. Follow instructions for lubricating and changing accessories.
16. **MAKE SURE GUARDS ARE IN PLACE AND WORK CORRECTLY BEFORE USING MACHINERY.**
17. **REMOVE ADJUSTING KEYS AND WRENCHES.** Make a habit of checking for keys and adjusting wrenches before turning machinery **ON**.
18. **CHECK FOR DAMAGED PARTS BEFORE USING MACHINERY.** Check for binding and alignment of parts, broken parts, part mounting, loose bolts, and any other conditions that may affect machine operation. Repair or replace damaged parts.
19. **USE RECOMMENDED ACCESSORIES.** Refer to the instruction manual for recommended accessories. The use of improper accessories may cause risk of injury.
20. **DO NOT FORCE MACHINERY.** Work at the speed for which the machine or accessory was designed.
21. **SECURE WORKPIECE.** Use clamps or a vise to hold the workpiece when practical. A secured workpiece protects your hands and frees both hands to operate the machine.
22. **DO NOT OVERREACH.** Keep proper footing and balance at all times.
23. **MANY MACHINES WILL EJECT THE WORKPIECE TOWARD THE OPERATOR.** Know and avoid conditions that cause the workpiece to "kickback."
24. **ALWAYS LOCK MOBILE BASES (IF USED) BEFORE OPERATING MACHINERY.**
25. **BE AWARE THAT CERTAIN WOODS MAY CAUSE AN ALLERGIC REACTION** in people and animals, especially when exposed to fine dust. Make sure you know what type of wood dust you will be exposed to and always wear an approved respirator.

WARNING

Additional Safety Instructions for Laminate Trim Routers

- 1. READ THE ENTIRE MANUAL:** This manual contains proper operating instructions for this router.
- 2. SAFETY EQUIPMENT:** Wear safety glasses, respirator, and hearing protection when operating a router.
- 3. POWER SOURCE:** Unplug the router and make sure the switch is **OFF** before inserting or removing bit, making adjustments, or performing maintenance or service. **DO NOT** make adjustments while the router is running.
- 4. ROUTER BITS:** Inspect router bits before use. **DO NOT** use router bits that have been dropped, cracked, or damaged. The router bit may shatter, causing serious injury.
- 5. INSTALLING BIT:** Insert the bit all the way into the collet and tighten firmly. If the bit is not inserted far enough, the bit may slip or come out, causing injury. **DO NOT** use bits with a diameter larger than 1/8".
- 6. COLLET WRENCHES:** Make sure the collet wrenches are removed from the router before turning it **ON**.
- 7. WORKPIECE:** Check the workpiece for nails or other foreign objects which may cause the router to kickback or damage the bit, possibly causing injury to the operator.
- 8. HOLDING THE WORKPIECE:** Secure the workpiece with clamps or attach it to an immovable object. **DO NOT** hold the workpiece in your hand or across your legs.
- 9. HOLDING THE ROUTER:** Hold the router with both hands to control torque twist and kickback. Keep hands away from the spinning bit. Make sure the bit has come to a complete stop before setting the router down.
- 10. ROUTING:** Always route with the base flat upon the workpiece. **DO NOT** start the router with the bit in contact with the workpiece.
- 11. FEED DIRECTION:** Always feed the router against the cutter rotation. **DO NOT** start routing at a corner. Starting at a corner may cause the router to grab, damaging the workpiece, and possibly causing personal injury.
- 12. REMOVING THE BIT:** The bit is sharp and will be hot after use. Use gloves when removing.
- 13. WORK AREA:** **DO NOT** use the router in an area that may contain hidden live wires. Disconnect all power leading to the work area.
- 14. TOOL SERVICE:** If the router is damaged, or not working correctly, repair it before use.

CAUTION

No list of safety guidelines can be complete. Every shop environment is different. Always consider safety first, as it applies to your individual working conditions. Use this and other machinery with caution and respect. Failure to do so could result in serious personal injury, damage to equipment or poor work results.

Electrical Safety

Extension Cords

We do not recommend the use of extension cords, if you find it absolutely necessary:

- Use at least a 16 gauge cord that does not exceed 100 feet in length!
- The extension cord must also contain a ground wire and plug pin.
- DO NOT use an extension cord that has cuts, exposed wires, bent/missing prongs, or other damage.
- A qualified electrician MUST size cords over 100 feet long to prevent motor damage.

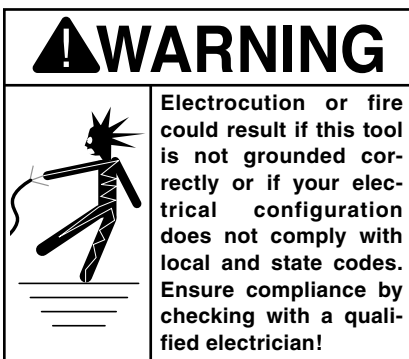
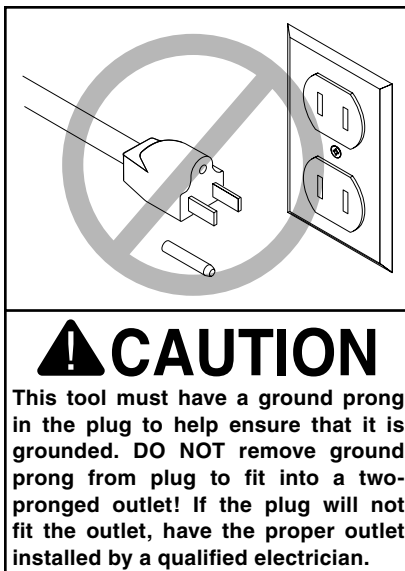

SECTION 2: OPERATIONS

Unpacking/Inventory

The Model H7790/H7791 was carefully packed when it left our warehouse. If you discover the tool is damaged after you have signed for delivery, *please immediately call Customer Service at (570) 546-9663 for advice.*

Save the box and all packing materials for possible inspection by the carrier or its agent. *Otherwise, filing a freight claim can be difficult.*

When you are completely satisfied with the condition of your shipment, you should inventory the contents.

Model H7790/H7791 Inventory (Figure 2)

- A. Router with Base Plate (Not Shown) . 1
- B. Collet Wrenches..... 1
- C. Template Guide 1
- D. Straight Trim Guide..... 1
- E. Curved Trim Guide 1

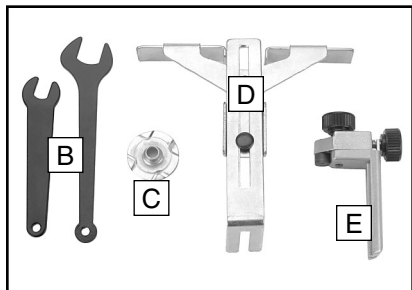

Figure 2. Model H7790/H7791 inventory.

In the event that any nonproprietary parts are missing (e.g. a nut or a washer), we would be glad to replace them, or for the sake of expediency, replacements can be obtained at your local hardware store.

Removing/Installing Router Bit

This router is supplied with a ¼" collet for use with ¼" shank router bits. It will accept router bits up to a 1⅝" diameter. Carefully inspect router bits for cracks, chips, or other damage before installing. DO NOT use router bits that have been dropped, cracked, or damaged. The router bit may shatter causing serious injury.

To remove or install a router bit:

1. UNPLUG THE ROUTER AND MAKE SURE THE SWITCH IS **OFF!**
2. Loosen the lock knob and adjust the base for access to the collet.
3. Place the collet wrenches as shown in **Figure 3**, loosen the collet, and remove the router bit.

⚠ CAUTION: The router bit is sharp and will be hot after use. Wear gloves to prevent injury when removing bit.

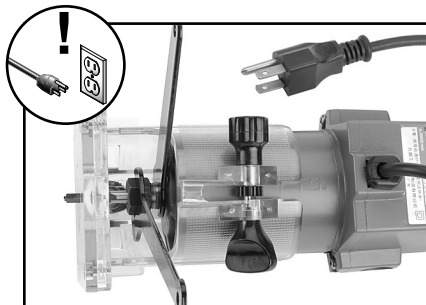

Figure 3. Loosening the collet.

4. Slide the router bit to within ⅛" of the bottom of the collet and securely tighten the collet with the wrenches.

Note: The collet can be damaged if it is tightened without a bit.

Adjusting Bit Depth

⚠ WARNING

Unplug the router and make sure the switch is **OFF** before inserting or removing bit, making adjustments, or performing maintenance or service. **DO NOT** make adjustments while the router is running.

To adjust the bit depth:

1. UNPLUG THE ROUTER AND MAKE SURE THE SWITCH IS **OFF**
2. Loosen the lock knob shown in **Figure 4** and adjust the base to approximately the desired height.

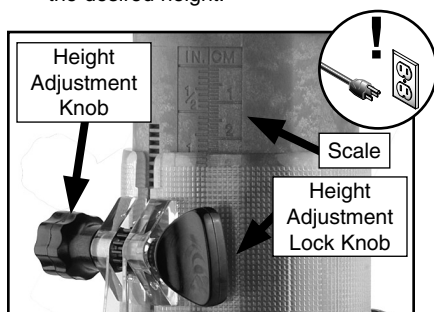

Figure 4. Height adjustment knobs.

3. Fine tune the depth of the router bit by using a measuring device, or place the router on the workpiece and eyeball the depth for an approximate measurement.

Note: *The scale on the Model H7791 is not calibrated to any specific point. Only use it for reference when making incremental changes.*

4. Tighten the lock knob to secure the base plate.
5. Plug in the router and make a test run in a scrap piece of wood to make sure the depth is correct.

Feed Direction

Once the bit has been selected and installed properly, and the depth has been set, you need to determine the proper feed direction of the router across the workpiece:

To determine the feed direction:

1. Examine the top face of the workpiece and determine the direction of the grain. Feed the router so the bit is cutting with the grain (cutting along the growth rings as shown in **Figure 5**). Cutting against the grain chips the wood rather than cutting it, making a rougher surface with more “chip out.”

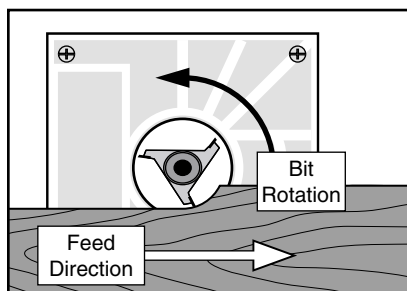

Figure 5. Correct feed direction and grain orientation (bottom view).

2. Always pass the router across the workpiece so the bit is rotating opposite the feed direction as shown in **Figure 5**. If the cutters are moving in the same direction you are feeding the router, you are performing a “climb cut.” This is a very dangerous operation because the router could lunge forward out of your hands, causing serious personal injury.

Routing Operations

Once the router bit is installed, the depth is set, and the feed direction is determined, it is time to start routing.

To perform routing operations:

1. Secure the workpiece to a stable surface.
2. Place the router flat on the surface of the workpiece, making sure that the bit is not touching the workpiece.
3. Firmly grasp the router and turn the switch **ON**.

⚠ CAUTION: The router will "kick" when started. If it comes into contact with the workpiece it could jump out of your hands and cause injury.

4. Smoothly move the router in the correct feed direction into the workpiece.

⚠ CAUTION: DO NOT start routing at a corner. Starting at a corner may cause the router to grab, damaging the workpiece corner, and possibly causing personal injury.

5. Feed the router along the workpiece at a consistent rate of speed. Be aware of the sound of the router motor and the sound of the bit cutting. If the motor begins to bog down, or the sound pitch of the router bit lowers, reduce the feed rate.
6. When finished routing, turn the router **OFF**, and allow it to come to a complete stop before setting it down.

Routing Tips

- Performing routing operations in multiple passes produces smoother results with less chance of "chip out" and burning of the workpiece. It also reduces the possibility of the router jerking out of your hands from trying to remove too much material in one pass.
- Cutting end grain with the router will cause tearout. Cutting the end grain first allows the tearout to be trimmed off by the side cuts.
- Feed the router in a counterclockwise direction when routing the outside edges of a workpiece. Feed the router clockwise when routing interior holes.
- The correct feed speed depends on the speed of the router, bit size, shape, and sharpness, and the characteristics of the workpiece. Feeding the router too fast will cause chatter marks, chip out, and possibly damage the bit and motor. Feeding the router too slow will cause burn marks and extra build-up on the router bit. Make a test cut on a sample scrap of the workpiece to determine the correct feed speed. A router fed at the correct speed should make large, thin shavings.

Curved Trim Guide

The curved trim guide is used for trimming curved surfaces, such as adding a decorative edge to a round table or trimming curved corners on a laminate countertop.

This guide is only necessary with router bits that do not have a guide bearing. The bushing in the curved trim guide rides along the edge of the workpiece guiding the router bit.

To use the curved trim guide:

1. Slide the trim guide onto the base plate as shown in **Figure 6**, set the guide height, and tighten the height adjustment lock knob.

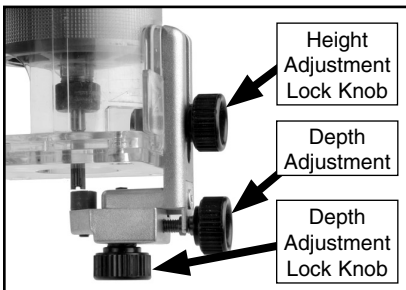

Figure 6. Curved trim guide adjustments.

2. Loosen the depth adjustment lock knob and turn the depth adjustment to adjust the depth of cut.
3. Follow the instructions in **Routing Operations** on **Page 11** and make a test cut by sliding the guide bushing along the edge of a scrap piece of wood.
4. TURN **OFF** AND UNPLUG THE ROUTER, then make the necessary adjustments to the height and depth of the curved trim guide.
5. Repeat **Steps 1–4** until the cut is the correct height and depth.

Straight Guide

The straight guide can be used for trimming, cutting dadoes, straight dovetails, and for cutting circles.

Only use router bits with no guide bearing when using the straight guide.

To use the straight guide for trimming:

1. Slide the straight guide onto the base plate as shown in **Figure 7**, then set the guide height and tighten the lock knob.

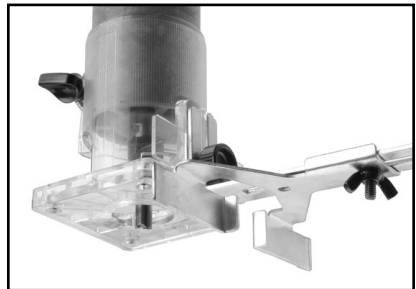

Figure 7. Straight guide installation.

2. Loosen the wing nut and slide the straight guide to approximately the desired depth.
3. Follow the instructions in **Routing Operations** on **Page 11** and make a test cut by sliding the straight guide along the edge of a scrap piece of wood.
4. TURN **OFF** AND UNPLUG THE ROUTER, then make the necessary adjustments to the straight guide.
5. Repeat **Steps 2–4** until the cut is correct.

To use the straight guide for interior cuts.

1. Set up the straight guide as explained for trimming, but adjust the guide to allow the router bit to follow an interior slot.

Note: *When cutting interior slots, the router will tend to wander toward the guide. Keep a constant pressure towards the workpiece, and pull the router towards you, instead of pushing the router.*

2. Make sure there is enough excess material at the end of the cut to support the straight guide. If the guide slips off of the end of the workpiece, it will wander off of the desired line. You may wish to add a longer piece of wood to the workpiece for the straight guide to follow.
3. Follow the instructions in **Routing Operations** on **Page 11** to make the desired cut as shown in **Figure 8**.

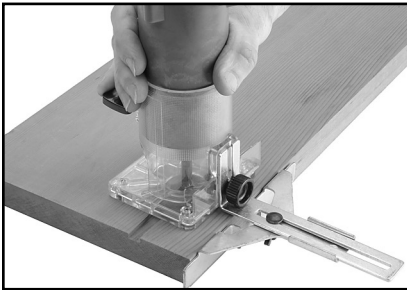

Figure 8. Routing a slot.

To use the straight guide for cutting circles.

1. Set up the straight guide as shown in **Figure 9** with the guide plate facing up.

Note: *The router will cut circles from 2³/₄"–4³/₄" when the lock bolt is placed in the hole closest to the router and it can cut circles from 4³/₄"–8⁵/₈" when the lock bolt is placed in the hole farthest from the router.*

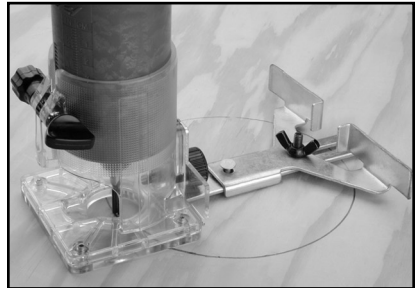

Figure 9. Guide setup for cutting circles.

2. Use a compass to mark the desired circle on the workpiece, then drive a small nail into the workpiece at the center of the circle.
3. Place the hole in the straight guide over the nail, then loosen the lock bolt and adjust the guide until the router bit aligns with the marked circle.
4. Adjust the router to the desired depth.
5. Lift the router above the surface, turn it **ON**, and then carefully lower it into the workpiece.
6. Rotate the router in a clockwise direction, using the nail as the pivot point.

Template Guide

The template guide allows the router to follow a template or pattern. This setup is necessary when routing interior slots where a bit with a guide bearing will not fit.

To install the template guide:

1. Remove the screws securing the bottom of the router base as shown in **Figure 10**.

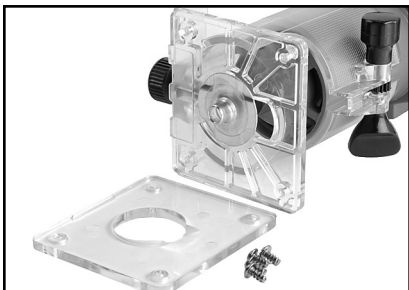

Figure 10. Installing the template guide.

2. Set the template guide into the groove in the upper portion of the router base and re-install the bottom portion of the router base.
3. Install a router bit that has a diameter of $\frac{1}{4}$ " or less (see **Figure 11**).



Figure 11. Router bit installed through the template guide.

Guidelines for building the template:

1. MDF is the most common template material, but the template can be made out of any material that is flat on the top and bottom, and is at least $\frac{3}{16}$ " thick.
2. Take into account the diameter of the template guide when calculating the size of the template. The diameter of the bushing (X in **Figure 12**), minus the diameter of the router bit (R), divided by 2, gives you the template offset as shown in **Figure 13**.

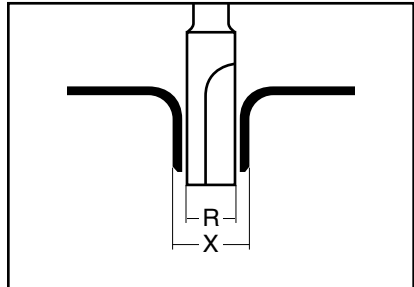

Figure 12. Calculating template offset.

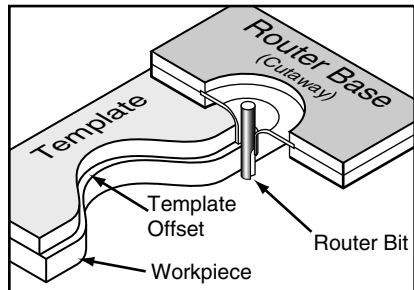

Figure 13. Using the template guide.

3. Attach the template to the workpiece with screws or other removable fasteners. Make sure the fasteners are installed in areas where the router bit will not cut and recessed so the router base will not catch on the fastener.

Using the template guide:

1. Use a bandsaw to remove excess wood around the template.
2. Press the template guide into the template and follow the edge.

SECTION 3: ACCESSORIES

G7984—Face Shield

H1298—Dust Sealed Safety Glasses

H1300—UV Blocking, Clear Safety Glasses

H2347—Uvex® Spitfire Safety Glasses

H0736—Shop Fox® Safety Glasses

Safety Glasses are essential to every shop. If you already have a pair, buy extras for visitors or employees. You can't be too careful when it comes to shop safety!

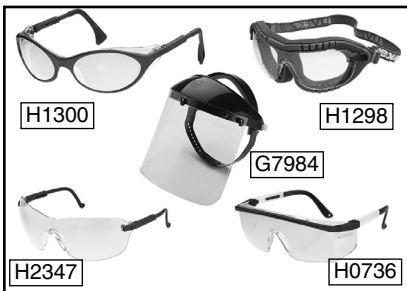

Figure 14. Our most popular safety glasses.

H2499—Small Half-Mask Respirator

H3631—Medium Half-Mask Respirator

H3632—Large Half-Mask Respirator

H3635—Disposable Cartridge Filter Pr.

Wood dust is now considered a known carcinogen and has been linked to nasal cancer and severe respiratory illnesses. If you work around dust everyday, a half-mask respirator can be a lifesaver. Also compatible with safety glasses!



Figure 15. Half-mask respirator and disposable cartridge filters.

H5554—20 Pc. Carbide 1/4" Router Bit Set

H3168—30 Pc. Carbide 1/4" Router Bit Set

Grizzly Industrial carries an extensive selection of 1/4" shank router bits. The following router bit sets are a very small portion of what Grizzly carries. For the latest models and pricing, check our website, www.grizzly.com, our catalog, or call 1-800-523-4777.



Figure 16. Model H5554 20-Pc. 1/4" shank router bit set.



Figure 17. Model H3168 30 pc. 1/4" shank router bit set.

Call 1-800-523-4777 To Order

G1530—Router Pad

This natural rubber pad eliminates holding or clamping work while routing or sanding. It effectively grips the workpiece for safe non-slip routing. Thin pad can be easily rolled up and stored when not in use. Pad measures 1/8" x 24" x 36"

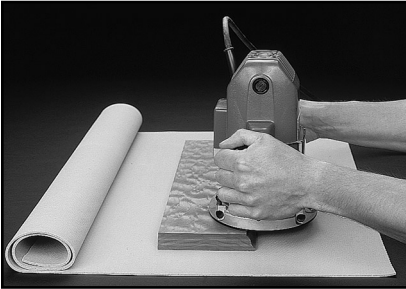

Figure 18. G1530 router pad.

G3468—Step Gauge

Use this solid brass router gauge to set consistent router bit depth. Measures in 1/16" increments. Also includes decimal equivalents. Made in USA.

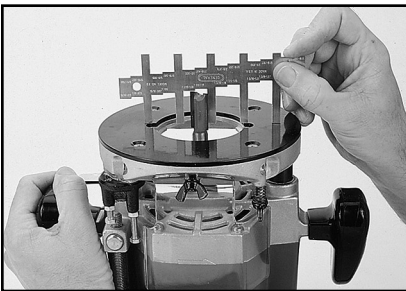

Figure 19. G3468 Step Gauge.

G6474—Router Magic

Teach your router to do magic you never dreamed possible. All you need are a handful of router bits and the extraordinary jigs, fixtures and techniques inside this book. More than 50 new jigs and fixtures with step-by-step instructions. 314 pages.

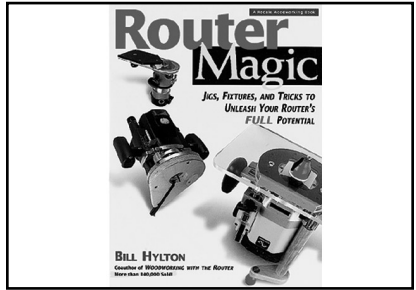

Figure 20. G6474 Router Magic.

H4836—The Art of the Router

This book stresses the versatility and cutting efficiency of this essential tool. Describes router bits, tables, and joinery techniques. But most of it is devoted to router projects, as artisans reveal their secret techniques and favorite ways to use the tool. 144 pages.

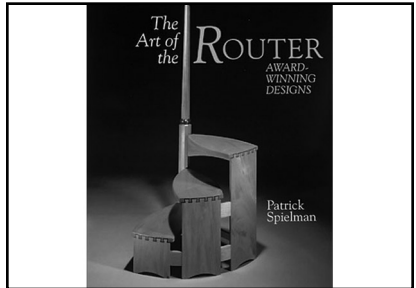

Figure 21. H4836 The Art of the Router

Call 1-800-523-4777 To Order

SECTION 4: MAINTENANCE

Router Maintenance



Router maintenance is simple. Keep the router free from dust, dirt and grease and always store it in a dry place. Plastic parts can easily be cleaned with a damp cloth, but never use water to clean any electrical parts. Solvents should also be avoided on plastic because of the possibility of damage.

Inspect the router for loose parts, damaged cord or switch, and inspect the bits for chips or cracks. Replace the bit if it is worn or damaged. Continuous use of a worn or damaged bit will not only decrease working efficiency, but also overload the motor, so the bit must be frequently checked.

With the exception of the motor brushes, the electrical components of this router are not user serviceable.

Contact our Technical Support at (570) 546-9663 for any repair work that requires opening the motor housing and for replacement parts.

Replacing Brushes

Motor brushes will become loaded with carbon deposits or wear out over time. Extend the life of the motor brushes by removing them periodically and cleaning off the carbon deposits.

If the motor will not run, makes squealing or grinding noises, or performance is dramatically decreased, check to see if the motor brushes need to be replaced. When replacing the motor brushes, replace both at the same time.

To replace the motor brushes:

1. Remove the caps on the sides of the motor housing as shown in **Figure 22**.



Figure 22. Replacing the motor brushes.

2. Replace the motor brushes and re-install the caps.

H7790 Parts

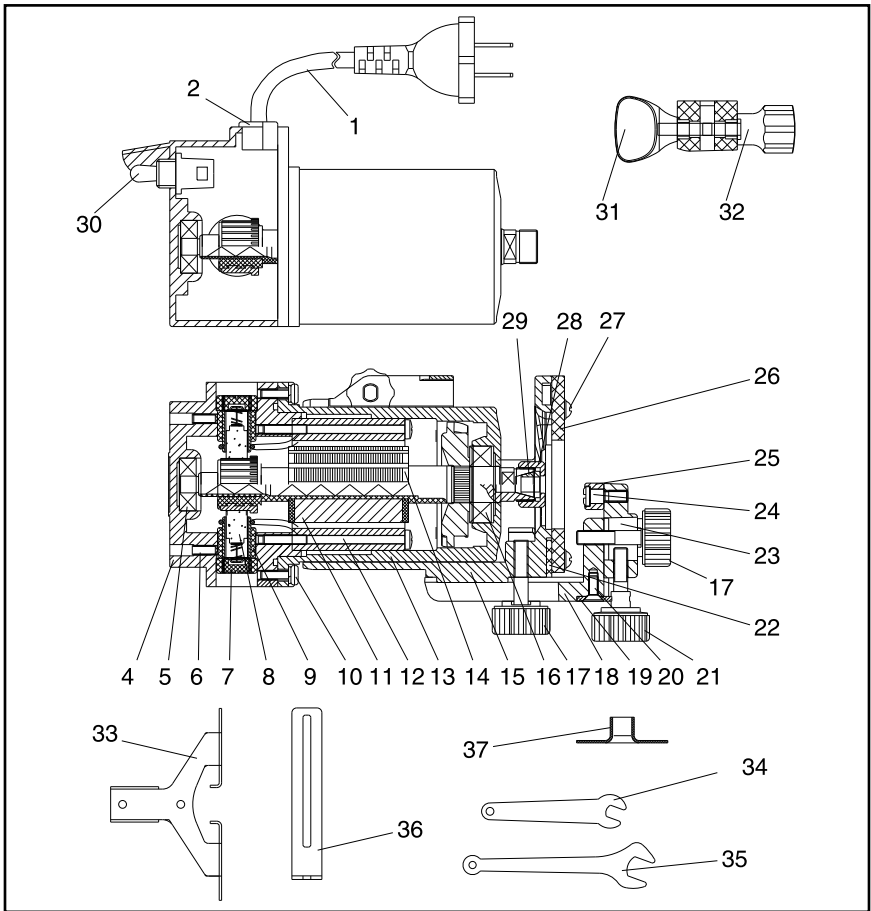

REF PART #	DESCRIPTION
1	PWRCRD110L POWER CORD 110V, W/PLUG
2	PH7790002 STRAIN RELIEF
4	PH7790004 BACK COVER
5	P627 BALL BEARING 627ZZ
6	PSS23M SET SCREW M4-.7 X 10
7	PH7790007 BRUSH COVER
8	PH7790008 CARBON BRUSH
9	PH7790009 BRUSH TUBE
10	PS02M PHL P HD SCR M4-.7 X 12
11	PH7790011 STATOR
12	PS85M PHL P HD SCR M4-.7 X 60
13	PH7790013 SHELL
14	PH7790014 ROTOR
15	PH7790015 OUTSIDE COVER
16	P6200 BALL BEARING 6200ZZ
17	PH7790017 LOCK KNOB M6-1 X 25
18	PH7790018 TRIM GUIDE BRACKET
19	PH7790019 KNOB RETAINER

REF PART #	DESCRIPTION
20	PFH19M FLAT HD SCR M4-.7 X 10
21	PH7790021 ADJUSTING KNOB M6-1 X 20
22	PH7790022 BLOCK
23	PH7790023 TRIM GUIDE PLATE
24	PH7790024 SHOULDER SCREW M5-.8 X 11
25	PH7790025 BUSHING
26	PH7790026 BASE PLATE
27	PHTEK15M TAP SCREW M4 X 10
28	PH7790028 COLLET NUT
29	PH7790029 COLLET
30	PH7790030 SWITCH
31	PH7790031 CLASPING KNOB
32	PH7790032 GEAR GUIDING KNOB
33	PH7790033 STRAIGHT GUIDE
34	PH7790034 WRENCH 10MM
35	PH7790035 WRENCH 17MM
36	PH7790036 GUIDE ADJ BRACKET
37	PH7790037 TEMPLATE GUIDE

H7791 Parts

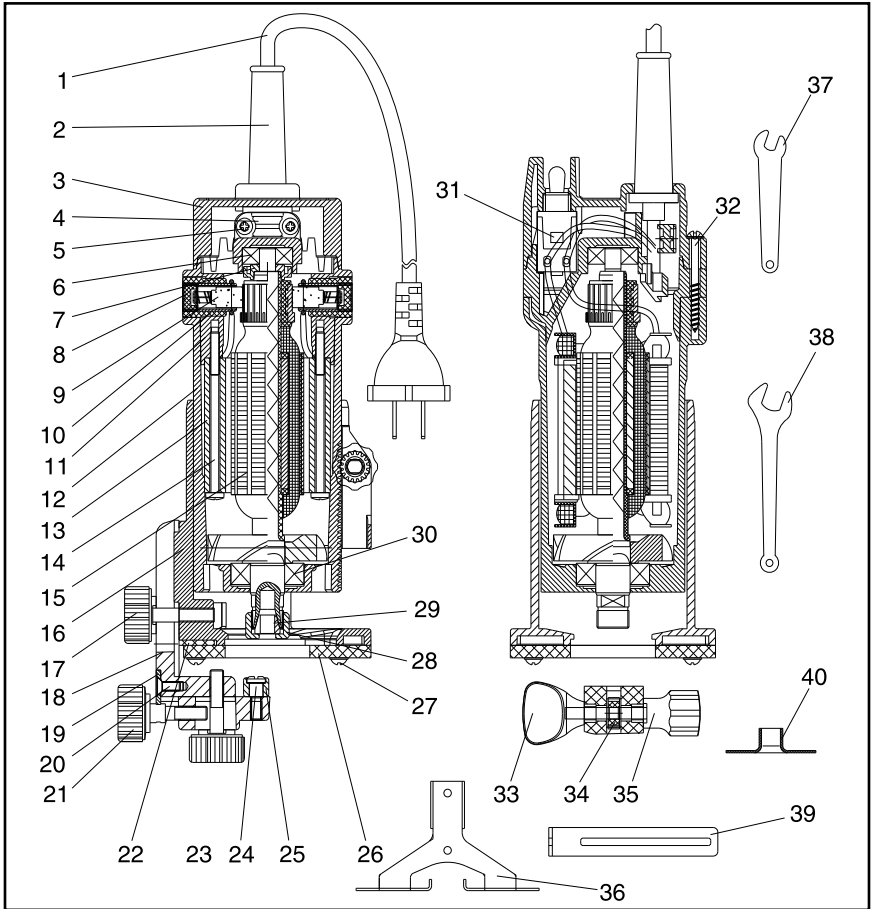

REF	PART #	DESCRIPTION
1	PH7791001	POWER CABLE
2	PH7791002	CABLE JACKET
3	PH7791003	BACK COVER
4	PH7791004	CABLE CLAMP
5	PS56M	PHLP HD SCR M4-.7 X 16
6	P627	BALL BEARING 627ZZ
7	PH7791007	BEARING GASKET
8	PH7791008	BRUSH TUBE
9	PH7791009	BRUSH COVER
10	PH7791010	CARBON BRUSH
11	PH7791011	MID COVER
12	PH7791012	SHELL
13	PH7791013	STATOR
14	PH7791014	PHLP HD SCR M4-.7 X 70
15	PH7791015	ROTOR
16	PH7791016	OUTSIDE COVER
17	PH7790017	LOCK KNOB M6-1 X 25
18	PH7790018	TRIM GUIDE BRACKET
19	PH7790019	KNOB RETAINER
20	PFH19M	FLAT HD SCR M4-.7 X 10

REF	PART #	DESCRIPTION
21	PH7790021	ADJUSTING KNOB M6-1 X 20
22	PH7790022	BLOCK
23	PH7790023	TRIM GUIDE PLATE
24	PH7790024	SHOULDER SCREW M5-.8 X 11
25	PH7790025	BUSHING
26	PH7790026	BASE PLATE
27	PHTEK15M	TAP SCREW M4 X 10
28	PH7790028	COLLET NUT
29	PH7790029	COLLET
30	P6200	BALL BEARING 6200ZZ
31	PH7791031	SWITCH
32	PS65M	PHLP HD SCR M4-.7 X 40
33	PH7790031	CLASPING KNOB
34	PH7791034	LIFT GEAR
35	PH7790032	GEAR GUIDING KNOB
36	PH7790033	STRAIGHT GUIDE
37	PH7790034	WRENCH 10MM
38	PH7790035	WRENCH 17MM
39	PH7790036	GUIDE ADJ BRACKET
40	PH7790037	TEMPLATE GUIDE

WARRANTY AND RETURNS

Grizzly Industrial, Inc. warrants every product it sells for a period of **1 year** to the original purchaser from the date of purchase. This warranty does not apply to defects due directly or indirectly to misuse, abuse, negligence, accidents, repairs or alterations or lack of maintenance. This is Grizzly's sole written warranty and any and all warranties that may be implied by law, including any merchantability or fitness, for any particular purpose, are hereby limited to the duration of this written warranty. We do not warrant or represent that the merchandise complies with the provisions of any law or acts unless the manufacturer so warrants. In no event shall Grizzly's liability under this warranty exceed the purchase price paid for the product and any legal actions brought against Grizzly shall be tried in the State of Washington, County of Whatcom.

We shall in no event be liable for death, injuries to persons or property or for incidental, contingent, special, or consequential damages arising from the use of our products.

To take advantage of this warranty, contact us by mail or phone and give us all the details. We will then issue you a "Return Authorization Number," which must be clearly posted on the outside as well as the inside of the carton. We will not accept any item back without this number. Proof of purchase must accompany the merchandise.

The manufacturers reserve the right to change specifications at any time because they constantly strive to achieve better quality equipment. We make every effort to ensure that our products meet high quality and durability standards and we hope you never need to use this warranty.

Please feel free to write or call us if you have any questions about the machine or the manual.

Grizzly Industrial, Inc.
1203 Lycoming Mall Circle
Muncy, PA 17756
Phone: (570) 546-9663
Fax: (800) 438-5901

E-Mail:
techsupport@grizzly.com

Web Site: <http://www.grizzly.com>

Thank you again for your business and continued support. We hope to serve you again soon!



WARRANTY CARD

Name _____

Street _____

City _____ State _____ Zip _____

Phone # _____ Email _____ Invoice # _____

Model # _____ Order # _____ Serial # _____

*The following information is given on a voluntary basis. It will be used for marketing purposes to help us develop better products and services. **All information is strictly confidential.***

1. How did you learn about us?

Advertisement Friend Catalog
 Card Deck Website Other: _____

2. Which of the following magazines do you subscribe to?

Cabinet Maker Popular Mechanics Today's Homeowner
 Family Handyman Popular Science Wood
 Hand Loader Popular Woodworking Wooden Boat
 Handy Practical Homeowner Woodshop News
 Home Shop Machinist Precision Shooter Woodsmith
 Journal of Light Cont. Projects in Metal Woodwork
 Live Steam RC Modeler Woodworker West
 Model Airplane News Rifle Woodworker's Journal
 Modeltec Shop Notes Other:
 Old House Journal Shotgun News

3. What is your annual household income?

\$20,000-\$29,000 \$30,000-\$39,000 \$40,000-\$49,000
 \$50,000-\$59,000 \$60,000-\$69,000 \$70,000+

4. What is your age group?

20-29 30-39 40-49
 50-59 60-69 70+

5. How long have you been a woodworker/metalworker?

0-2 Years 2-8 Years 8-20 Years 20+ Years

6. How many of your machines or tools are Grizzly?

0-2 3-5 6-9 10+

7. Do you think your machine represents a good value? Yes No

8. Would you recommend Grizzly Industrial to a friend? Yes No

9. Would you allow us to use your name as a reference for our customers in your area?

Note: *We never use names more than 3 times.* Yes No

10. Comments: _____

Send a Grizzly Catalog to a friend:

Name _____
Street _____
City _____ State _____ Zip _____

FOLD ALONG DOTTED LINE

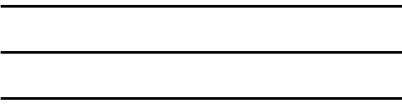

GRIZZLY INDUSTRIAL, INC.
P.O. BOX 2069
BELLINGHAM, WA 98227-2069



TAPE ALONG EDGES--PLEASE DO NOT STAPLE

Free Manuals Download Website

<http://myh66.com>

<http://usermanuals.us>

<http://www.somanuals.com>

<http://www.4manuals.cc>

<http://www.manual-lib.com>

<http://www.404manual.com>

<http://www.luxmanual.com>

<http://aubethermostatmanual.com>

Golf course search by state

<http://golfingnear.com>

Email search by domain

<http://emailbydomain.com>

Auto manuals search

<http://auto.somanuals.com>

TV manuals search

<http://tv.somanuals.com>