

Please read these instructions carefully and keep for future reference.

## ULTRAGLISS DIFFUSION

017110 - 0403

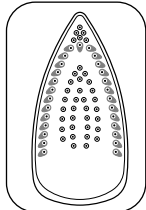
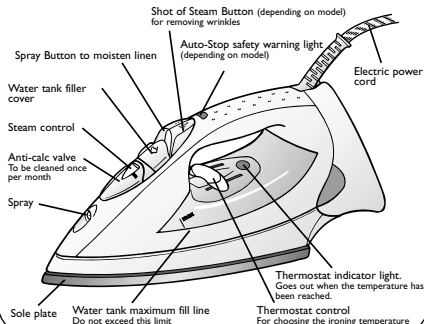

**Warning!** Remove the sole plate protector before heating up the iron (depending on the model).

**Warning!**

Before using your iron with the steam function for the first time, we recommend that you operate it in horizontal position for a few moments, away from your linen, ie press several times on the shot of steam button.

During the first few uses, a harmless odor and smoke may be given off. This has no effect on the use of the iron and will disappear quickly.



### What water to use ?

Your appliance has been designed to function with tap water. However, it is necessary to operate the Self-Clean function regularly in order to eliminate hard water deposits. If your water is very hard (check with your water authority), it is possible to mix tap water with store-bought demineralized water in the following proportions : 50% tap water, 50% demineralized water.



### Types of water not to use :

Heat concentrates the elements contained in water during evaporation. The types of water listed below contain organic waste or mineral elements that can cause spitting, brown staining, or premature wear of the appliance: water from clothes dryers, scented or softened water, water from refrigerators, batteries, or air conditioners, pure distilled water, or rain water.

## I - STEAM IRONING

### Filling the water tank

- Unplug your iron before filling it.
- Set the steam control on DRY (A).
- Fill the boiler up to the lower line indicated (B).
- Open the water tank filler cover completely (C), set the iron on a table (not when the iron hot) shown in the diagram (D) below, and fill the tank.
- Do not exceed the MAX line indicated on the water tank (with the iron set on its heel).
- Close the water tank filler cover.

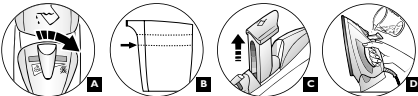

### Setting the temperature

- Set the temperature control shown in the diagram below (E) referring to the table below (or on the heel).
- The thermostat light comes on. Wait for the light to go off and come on again before you start ironing (F).



### Setting the steam level (G)

- In order to avoid water dripping from the iron onto the linen:
- Turn off the steam when ironing silk or synthetic fabrics.
- Set it at the minimum position for wool.



### What temperature and which steam setting to use ?

FABRIC	POSITION OF THERMOSTAT CURSOR	STEAM SETTING POSITION
LINEN	MAX	MAX
COTTON	●●●	
WOOL	●●	MIN
SILK	●	
SYNTHETIC Polyester, Acetate, Acrylic, Nylon	●	DRY

■ = STEAM ZONE



### Moistening the linen (Spray)

- When steam or dry ironing, press several times on the Spray Button to moisten the linen (H) and to remove stubborn creases.
- Make sure that there is water in the tank before using this button.

### Recommendations: Fabrics and ironing temperatures:

- Your iron heats up quickly; begin by ironing those fabrics that are ironed at low temperatures, then go on to those requiring a higher temperature;
- If you turn down the thermostat, wait until the thermostat light comes back on before beginning to iron again.
- When ironing fabrics with mixed fibres, set the ironing temperature for the most delicate fibre.

### Obtaining more steam for removing wrinkles (depending on the mode)

- Press the shot of steam button from time to time (I).
- Wait a few seconds between each shot before pressing the button again.

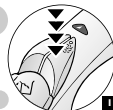

### Vertical steam ironing (depending on the mode)

- Hang up the garment on a hanger and hold the fabric slightly taut with one hand.
- Set the thermostat control on MAX (J).
- Press the shot of steam button (K) repeatedly (K), moving the iron from top to bottom (L).
- Hold the iron a few centimetres from the fabric to avoid burning delicate fabrics.



### Auto-Stop safety feature (depending on the mode)

- The electronic system cuts off the electric power and the Auto-Stop warning light flashes if the iron is left vertically on its heel for more than 8 minutes, or in a horizontal position for more than 30 seconds (M).
- To restart the iron, just move it gently until the warning light stops flashing.

**Note:** When the Auto-Stop warning light is on, it is normal for the thermostat light to be off.



## 2 - DRY IRONING



- Set the steam control on DRY (see diagram A).
- Set the temperature.
- You may start ironing when the thermostat light goes out and comes on again.

## 3 - MAINTAINING YOUR IRON

### BE CAREFUL !

Unplug your iron and let it cool off before cleaning it.

### • CLEANING THE ANTI-CALC VALVE (Once per month) :

- Unplug your iron and empty the water tank.
- To remove the anti-calc valve, pull it up using the tabs located on each side (N).



### NEVER TOUCH THE END OF THE VALVE.



- Soak the valve in a cup of white spirit vinegar or plain lemon juice for 4 hours (O).
- Rinse the valve in tap water.
- Place the steam control on dry.
- Replace the anti-scale valve.

THE IRON WILL NOT FUNCTION WITHOUT THE ANTI-CALC VALVE

### 3- MAINTAINING YOUR IRON (continued)

#### • USING THE SELF-CLEANING FUNCTION :

In order to extend the life of your iron, use the Self-Cleaning function once per month.

- Unplug your iron and set the steam control on DRY  $\frac{3}{4}$ .
- Fill the water tank up to the limit (see recommendations for the types of water to use).
- Leave water tank filler cover open until the end of the operation.
- Place your iron on its heel and set the thermostat control on MAX.
- Plug in your iron and wait until the thermostat light goes out.
- Unplug the iron and hold it over a sink in the horizontal position.
- Place the steam control on MAX.
- Raise the anti-calc valve without removing it completely.
- Shake the iron gently over the sink until all of the water in the water tank (with the impurities) has flowed out via the sole plate.
- At the end of the operation, push the anti-calc valve back into position.
- Turn the iron back on for 2 minutes, setting it on its heel, to dry the sole plate.
- Unplug the iron, and when the soleplate is just warm, wipe it with a soft cloth.

#### Recommendation :

The self-cleaning function helps to delay the scaling of your iron.

#### • CLEANING THE SOLE PLATE:

- While the soleplate is still just warm, clean it by rubbing it with a moist, non-metallic pad.

### 4- STORING YOUR IRON

- Unplug it and wait until the sole plate has cooled off.
- Empty the water tank and set the steam control to DRY.
- Store the iron on its heel.

### GUARANTEE (U.K. ONLY)

Details of the guarantee are shown on the guarantee card enclosed with the appliance. This guarantee does not affect your statutory rights. Should service or further information be required please contact the Tefal Customer Relations Department (see Helpline or enclosed Service Information leaflet). Do not attempt to dismantle the appliance yourself – this will negate the guarantee. In line with a policy of continuous product improvement, Tefal reserves the right to change product specifications without prior notice.

### 5- IS THERE A PROBLEM ?

#### Problems

- The iron does not heat up.

#### Possible causes

- The auto-stop safety switch has operated.
- Thermostat control not correctly positioned

#### Solutions

- Restart the iron by lightly moving it.
- Set the thermostat control to the required fabric to be ironed.

- Water drips from the holes in the sole plate.

- The chosen temperature is too low and does not allow for the formation of steam.
- You are using steam while the iron is not hot enough.
- You are using the shot of steam button too often.
- The steam flow is too high.
- You have stored the iron horizontally without emptying it and without setting it to DRY.

- Set the thermostat in the coloured zone (from ● to MAX).

- Wait until the thermostat light goes out.

- Wait a few seconds between each use of the button.

- Reduce the steam flow.

- See the section "Storing your iron".

- Brown streaks come through the holes in the sole plate and stain the linen.

- You are using chemical descaling agents.
- You are using pure distilled water.

- Do not add any descaling agents to the water in the water tank.
- Do a self-cleaning and use tap water or 50 % tap water and 50 % demineralized water..

- Fabric fibres have accumulated in the holes of the sole plate and are burning.

- Your linen is not rinsed sufficiently or you have ironed a new garment before washing it.

- Do a self-cleaning.
- Clean the sole plate with a non-metallic sponge. Vacuum the holes of the sole plate from time to time.

- Ensure linen is rinsed thoroughly to remove any soap deposits or chemicals on new garments which have been sucked up by the iron.

- The sole plate is dirty or brown and can stain the linen.

- You are using too high a temperature.

- You are using starch.

- Clean the sole plate as indicated above. See the temperature table to correctly set the thermostat.

- Clean the sole plate as indicated above. Always spray starch onto the reverse side of the fabric to be ironed.

- There is little or no steam.

- The water tank is empty.

- The anti-calc valve is dirty.

- Your iron has a build-up of scale.

- Your iron has been used dry for too long.

- Fill it with tap water.

- Clean the anti-calc valve.

- Clean the anti-calc valve and do a self-cleaning.

- Do a self-cleaning.

- The sole plate is scratched or damaged.

- You have placed your iron flat on a metallic rest-plate.

- You have ironed over a zip.

- Always set your iron on its heel.

- Try to avoid ironing over zips which may have rough edges.

### FOR YOUR SAFETY

- Warning! The voltage of your electrical installation must correspond to that of the iron (220V-240V or 127V depending on the model). Connecting to the wrong voltage may cause irreversible damage to the iron and will invalidate the guarantee.
- This iron must always be plugged into an earthed socket.
- If using a mains extension lead, ensure that it is correctly rated (10A or 13A for UK only), with an earth.
- If the electrical cord becomes damaged, it must be immediately replaced by an Approved Service Centre to avoid any danger.
- Never immerse your iron in water!
- The appliance must be unplugged before filling or emptying the water tank.
- If the appliance falls, have it checked by a professional before using it again; unseal damage may be dangerous.
- The sole plate may be very hot:
  - Never touch it.
  - Always let it cool off before putting it away.
  - Never leave your iron unattended when it is plugged in or while the soleplate is still hot.
  - Always keep your iron out of the reach of children.

#### • NEVER DISMANTLE YOUR IRON ; ALWAYS CONTACT AN APPROVED SERVICE CENTRE.

This product has been designed for domestic use only. Any professional use, inappropriate use or failure to comply with the instructions, the manufacturer accepts no responsibility and the guarantee will not apply.

### SAFETY POINTS FOR REWIREABLE OR MOULDED PLUG.

The mains lead is fitted with a BS 1363 13 A plug. If the plug supplied with the product is not suitable for your socket outlet, then it must be removed (cut off, if it is a moulded-on plug) and a suitable 3 pin plug fitted in accordance with the instructions given below.

IF YOU ARE IN ANY DOUBT, PLEASE CONTACT A QUALIFIED ELECTRICIAN.

WARNING: This appliance must be earthed. Dispose of a plug that has been cut from the power supply cord, as such a plug is hazardous if inserted in a live 13 amp socket outlet elsewhere in the house.

How to connect the cord to a U.K. plug :

WARNING: The wires in the mains lead are coloured in accordance with the following code :

Green & Yellow Earth  
Blue Neutral  
Brown Live

Please read the instructions given below before connecting the cord to a plug. If you are in any doubt please consult a qualified electrician.

As the colours of the wires in the mains lead of this appliance may not correspond with the coloured markings identifying the terminals in your plug, proceed as follows :

- The wire that is coloured GREEN & YELLOW must be connected to the terminal in the plug which is marked with the letter E, or the earth symbol  $\downarrow$ , or coloured GREEN or GREEN & YELLOW.

- The wire that is coloured BROWN must be connected to the terminal which is marked with the letter L or coloured RED.

- The wire that is coloured BLUE must be connected to the terminal which is marked with the letter N or coloured BLACK.

- This appliance requires a 13 amp fuse.

- Should the fuse need to be replaced an ASTA marked fuse, approved to BS 1362, of the same rating must be used.

- Always replace the fuse cover after fitting a fuse. The plug must NOT be used if the cover is omitted or lost until a replacement is obtained - make certain that only the correct fuse cover is used and fitted.

- For plugs with a detachable fuse cover the replacement must be the same as the colour insert in the base of the plug or as directed by the embossed wording on the base of the plug.

- If the detachable fuse cover is lost, a replacement may be purchased from a Tefal Service Centre (see enclosed Service Information leaflet).

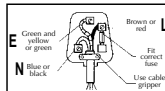

## Free Manuals Download Website

<http://myh66.com>

<http://usermanuals.us>

<http://www.somanuals.com>

<http://www.4manuals.cc>

<http://www.manual-lib.com>

<http://www.404manual.com>

<http://www.luxmanual.com>

<http://aubethermostatmanual.com>

Golf course search by state

<http://golfingnear.com>

Email search by domain

<http://emailbydomain.com>

Auto manuals search

<http://auto.somanuals.com>

TV manuals search

<http://tv.somanuals.com>