

# GRUNDIG

## GUADAB08IP DAB Radio with iPod docking station User Guide

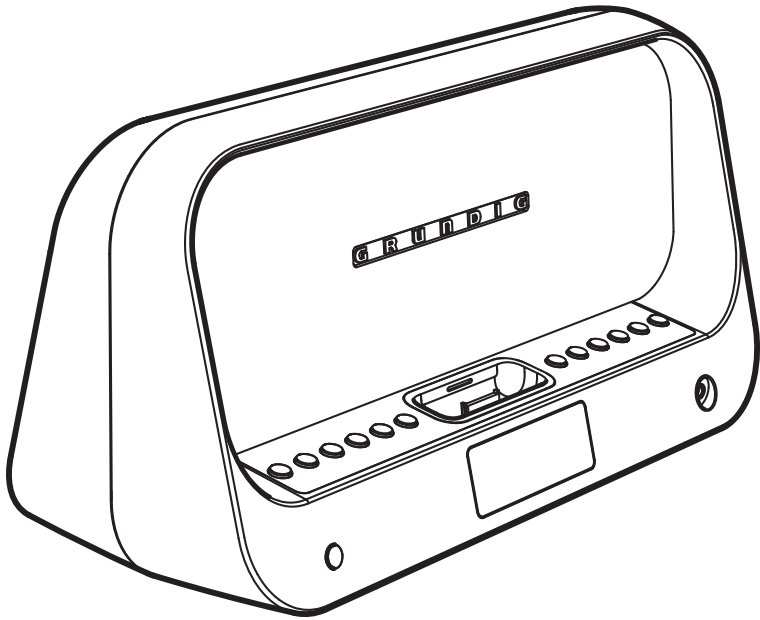

**IMPORTANT:** Please read all instructions carefully before use and keep for future reference

## Introduction

**Thank you for choosing this Grundig DAB Radio with Docking Station. Not only can you listen to your favourite DAB radio stations, but you can also listen to all the songs and albums on your iPod.**

It's really simple to use; you can fully operate your DAB Radio with Docking Station using the supplied Remote Control.

Throughout this User Guide the DAB Radio with Docking Station will be referred to as the DAB Radio.

### **Safety is important**

Use of any electrical equipment should be undertaken with care. Please read the Safety instructions on page 17 before you operate this DAB Radio.

## Key Features

### **DAB radio**

DAB (Digital Audio Broadcasting) is the next generation of radio.

DAB was developed in Europe by a consortium of broadcasters and manufacturers.

DAB uses digital audio compression techniques to transform the source material, i.e. music and speech, into digital code before it is transmitted. The code consists of electronic 'ones and zeros' called binary digits or bits. The binary code is then multiplexed or grouped together to create a superior signal, when compared with the older, analogue system, with the following key benefits:

- Near CD quality sound
- Interference free reception
- No need to retune

### **iPod Docking**

Any iPod can be connected to the DAB radio to allow all your songs to be played through the DAB radio speakers. Various adaptors are provided to allow all iPods to be connected.

## What's in the box

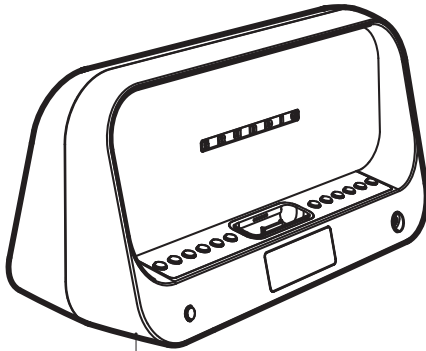

DAB Radio with iPod Docking Station

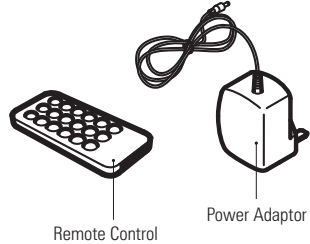

Remote Control

Power Adaptor

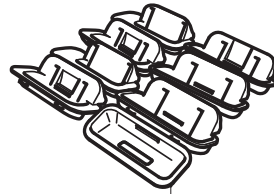

8 x iPod Adaptors



This User Guide



Quick Start Guide

## Contents

<b>01</b> Your DAB Radio ..... 4	<b>05</b> Troubleshooting ..... 15
<b>02</b> Get going ..... 6	<b>06</b> Specifications ..... 16
<b>03</b> Daily use ..... 9	<b>07</b> Warnings ..... 17
<b>04</b> Advanced features ..... 13	<b>08</b> Guarantee ..... 18

# 01 Your DAB Radio

## FRONT

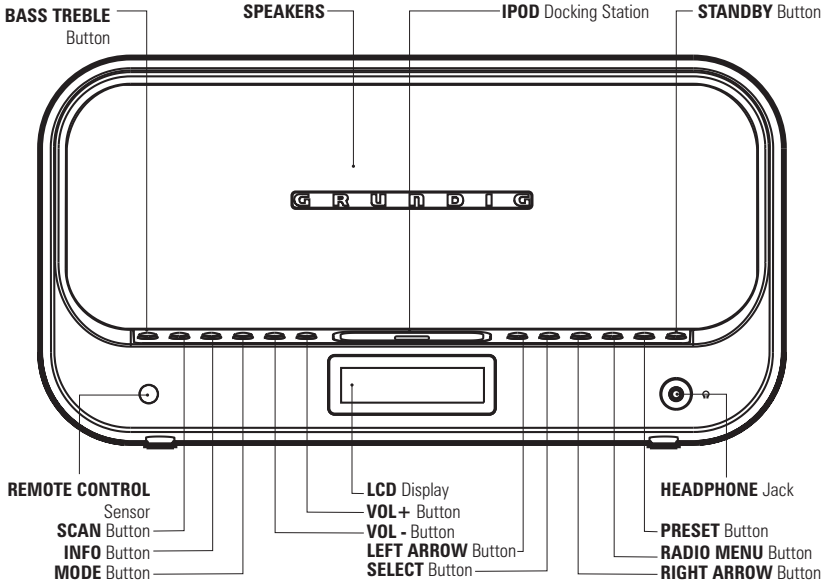

## REAR

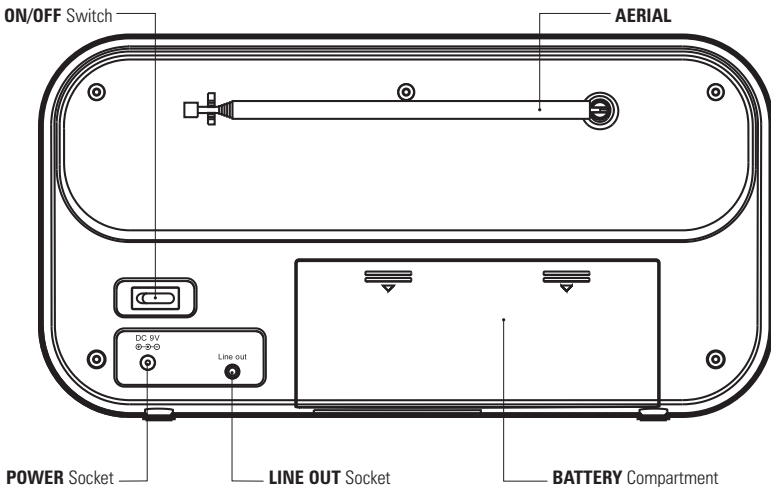

## REMOTE CONTROL

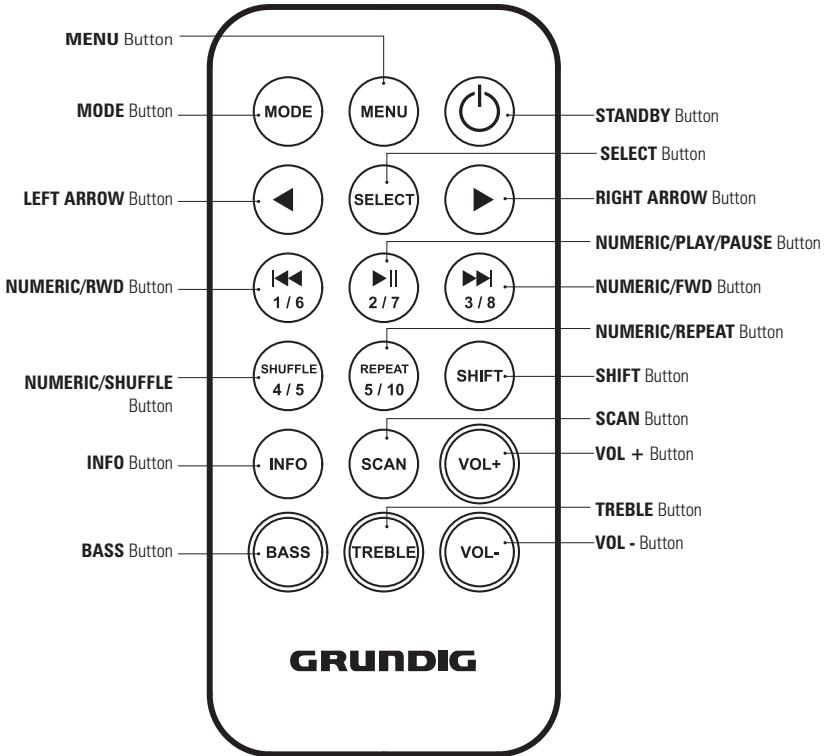

## 02 Get going

1

### Setting up the DAB Radio

Insert the connector of the Power Adaptor into the Power Socket of the DAB Radio.

Insert the Power Adaptor into the wall socket and turn the socket on.

Turn the **ON/OFF** Switch at the rear of the DAB Radio to the ON (I) position.

Unclip and extend the Aerial at the rear of the DAB Radio to ensure the best reception is received.

Press the **STANDBY** button to turn the DAB Radio on.

When the DAB Radio is switched on for the first time, it will begin to search for all available digital radio stations. Once the search is complete, the first available station will be heard.

2

### Using the DAB Radio with Batteries

The DAB Radio can be powered by 6 'C' type Batteries. This allows the DAB Radio to be used outside or away from wall sockets.

To remove the Battery Compartment Cover, press firmly and pull away from the DAB Radio.

Insert 6 'C' type batteries into the battery compartment, following the polarity diagram on the inside.

Replace the Battery Compartment Cover.

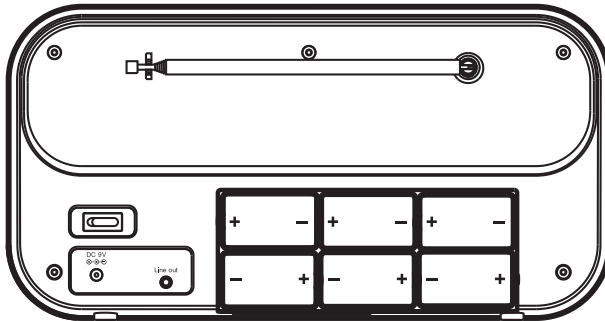

3

### Using the Remote Control

The Remote Control can be used to operate the DAB Radio. Before using the Remote Control, the Safety Tab should be removed.

To open the Remote Control Battery Compartment, press the Battery Compartment Cover Tabs together and remove.

Carefully remove the Safety Tab which covers the battery.

Replace the Battery Compartment Cover.

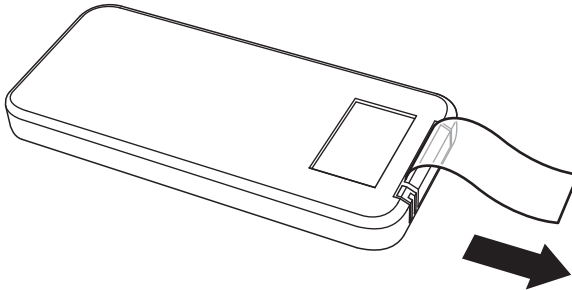

To use the Remote Control, simply direct it towards the Remote Control Sensor on the front of the DAB Radio and press the desired buttons.

4

### iPod Docking

Any iPod can be connected to the DAB Radio to allow all your songs to be played through the DAB Radio speakers.

To connect an iPod to the DAB Radio, select the compatible adaptor from one of the 8 iPod Adaptors supplied. The iPod Adaptors have markings on the bottom which clearly identify which iPod they should be used with.

If your iPod is not compatible with any of the supplied iPod Adaptors, use the adaptor supplied with your iPod.

Place the iPod Adaptor into the recess on the front of the DAB Radio and then insert your iPod into the Adaptor.

**DON'T FORGET!** Your iPod will charge while docked with the DAB Radio (iPod mode only).

Press the **STANDBY** button.

Press the **MODE** button repeatedly until iPod is displayed on the LCD Display. Your iPod will automatically continue playback of the last song played.

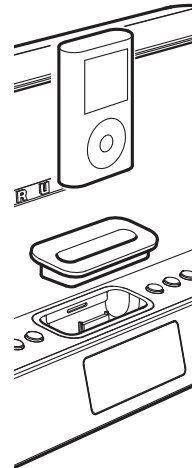

## 02 Get going

5

### Using Headphones

A pair of headphones (not supplied) with a 3.5mm diameter stereo plug and 8-32 ohm impedance is required. Plug the headphones into the Headphone Socket on the front of the DAB Radio.

When headphones are connected, the speakers are automatically disconnected.

6

### Connecting to External Devices

Your DAB Radio can be connected to external devices, for example a Home Stereo. Simply connect a suitable lead (not supplied) between the Line Out Socket on the rear of the DAB Radio and the external device.



**DONT FORGET!** Some functions described in this User Guide can only be performed using the DAB Radio or the Remote Control.

### Switching On

- 1 To turn the DAB Radio on, press the **STANDBY** button.
- 2 To turn the DAB Radio off, press the **STANDBY** button again.

**DONT FORGET!** Ensure the **ON/OFF** Switch is in the on (I) position before turning the DAB Radio on.

### Adjusting the Volume

- 1 To increase the volume, press the **VOL +** button.
- 2 To decrease the volume, press the **VOL -** button.

### Adjusting the Bass and Treble Levels

- 1 Press the **BASS TREBLE** button once to adjust the bass levels and twice to adjust the treble. The Settings screen will be shown.
- 2 To increase or decrease the levels, press the **RIGHT** and **LEFT ARROW** buttons respectively. The levels will increase or decrease in 2 decibel (dB) increments from -6 to +6 dB.
- 3 To accept the new level, press the **SELECT** button.

### Modes

The DAB Radio has three modes of operation. These are:

- iPod
- DAB Radio
- FM Radio

### iPod

You can dock an iPod with the DAB Radio and listen to all your favourite songs through the DAB Radio's speakers. With the iPod docked, you can control all the basic functions of the iPod using the DAB Radio or Remote Control.

**DONT FORGET!** Only the functions described in this User Guide can be performed using the DAB Radio or Remote Control.

### Selecting the iPod Mode

- 1 Dock your iPod with the DAB Radio as described on page 7.
- 2 Press the **STANDBY** button.
- 3 Press the **MODE** button repeatedly until iPod is displayed on the LCD Display. Your iPod will automatically continue playback of the last song played.

### Pausing play

- 1 To pause play during playback, press the **NUMERIC/PLAY/PAUSE** button. The pause symbol will appear on the iPod display.
- 2 To resume playback, press the **NUMERIC/PLAY/PAUSE** again.

### Skipping to the next/previous track

- 1 To skip to the next track, press the **NUMERIC/FWD** Button.
- 2 To skip to the previous track, press the **NUMERIC/RWD** Button.

### Shuffle Play

- 1 To randomly play all the songs on your iPod, press the **SHUFFLE** button on the remote control.

**DONT FORGET!** The mode you have the iPod set to will determine whether the DAB Radio shuffles all the songs on the iPod or just the album you are listening to.

### Menu Navigation

You can access the menu system of your iPod using the Remote Control.

- ❶ To access the iPod menu system, press the **MENU** button.
- ❷ Use the **LEFT** or **RIGHT ARROW** buttons to highlight the menu options.
- ❸ Use the **SELECT** button to select a menu option.

### Repeat Play

- ❶ To repeat the song you are currently listening to, press the **REPEAT** button on the remote control.
- ❷ To repeat the album you are currently listening to, press the **REPEAT** button twice on the remote control.

### DAB Radio

#### Selecting the DAB Radio Mode

- ❶ Press the **STANDBY** button.
- ❷ Press the **MODE** button repeatedly until a DAB Radio station is shown on the LCD Display.

**DONT FORGET!** The first time you turn on your DAB Radio it will automatically begin to scan for DAB radio stations. A progress bar will show the progress of the scan.

When the scan is complete, a list of the available DAB stations will be displayed on the second line of the LCD Display, in numerical and then alphabetical order.

If you have used the DAB Radio before, the most recently selected DAB radio station will be heard.

#### Selecting stations

- ❶ Press the **LEFT** and **RIGHT ARROW** buttons to scroll through the available stations. As you scroll the available station names will appear at the bottom of the LCD Display.
- ❷ To listen to a selected station, press the **SELECT** button.

#### Presetting stations

The Preset function allows you to store your

favourite stations for easy access. You can preset up to 10 DAB radio stations in the DAB Radio memory.

- ❶ Select the station you want to preset using the **LEFT** and **RIGHT ARROW** buttons.
- ❷ Press the **SELECT** button to listen to the selected station.
- ❸ Press the **PRESET** button.
- ❹ Use the **LEFT** and **RIGHT ARROW** buttons to select the preset number you would like to save the station against.
- ❺ Press and hold the **SELECT** button. The LCD Display will show 'Preset X Saved'. The station is now successfully saved against the selected preset number.

#### Selecting a preset station

- ❶ To select a preset station, press the appropriate **NUMERIC** button on the remote control. The DAB Radio will retune to the selected preset station.

**DONT FORGET!** If the preset number is above 5, press the **SHIFT** button before the **NUMERIC** button.

- ❷ To select a preset station using the buttons on the DAB Radio, press the **PRESET** button.
- ❸ Use the **LEFT** and **RIGHT ARROW** buttons to highlight the preset station.
- ❹ Press the **SELECT** button. The DAB Radio will retune to the selected preset station.

**DONT FORGET!** If you have not preset any stations, 'Empty Preset X' will be displayed on the second line of the LCD Display.

#### Information Display

When listening to a DAB radio station you can change the information that will appear on the second line of the LCD Display. There are several types of information that are sent by broadcasters which can be displayed. These are:

- Dynamic Label Segment (DLS) - this is scrolling text information supplied by the broadcaster. Information could be the name of an artist or music title, the DJ's name or the contact details for the radio station.

- Program Type (PTY) - displays the station program type, for example 'Pop'
- Multiplex Name - displays the broadcasting area and collection of radio stations on this frequency e.g.: BBC National DAB, Digital 1 Network.
- Time and Date - supplied by the broadcaster.
- Channel and Frequency - e.g.: 12B 225.64 MHz
- Signal Information - the data rate at which the signal is being transmitted.
- Signal Error - provides details of the signal error rate, shown as a number between 0 - 99. It will not be possible to satisfactorily listen to a DAB radio station with a signal error rate of 30 or above. Try adjusting the aerial or relocating your radio to improve the reception.

- 1 To change the information shown on the second line of the display, press the **INFO** button.

### Scanning for stations

It may be necessary to retune the DAB Radio if you move it from one location to another, for example, when you go on holiday. There are two types of automatic scanning available. These are:

- Fast Scan - retunes the existing stations.
- Full Scan - performs a full scan to retune the existing stations and also searches for any new stations available.

- 1 To perform a Fast Scan, press the **SCAN** button. 'Fast Scanning' will be shown on the 1st line of the LCD Display complete with a progress bar and the number of stations found during the scan. Once the scan is complete, the DAB Radio will tune back to the last station you listened to.

- 2 To perform a Full Scan, press and hold the **SCAN** button. 'Full Scanning' will be shown on the 1st line of the LCD Display complete with a progress bar and the number of stations found during the scan. Once the scan is complete, the DAB Radio will tune back to the last station you listened to.

### FM Radio

#### Selecting the FM Radio Mode

- 1 Press the **STANDBY** button.
- 2 Press the **MODE** button repeatedly until an FM Radio station is shown on the LCD Display.

#### Scanning for FM stations

- 1 To automatically scan for an FM station, press the **SCAN** button. The DAB Radio will scan for the next available FM station.
- 2 To scan for another station, press the **SCAN** button again.
- 3 To manually tune an FM station, press the **LEFT** and **RIGHT ARROW** buttons. Each press of the **ARROW** buttons will increase or decrease the frequency by 0.05 MHz.

#### Presetting stations

The Preset function allows you to store your favourite FM stations for easy access. You can preset up to 10 FM radio stations in the DAB Radio memory.

**DONT FORGET!** Presetting FM radio stations will not overwrite your DAB Radio station resets.

- 1 Scan for the FM radio station you want to preset.
- 2 Press the **PRESET** button.
- 3 Use the **LEFT** and **RIGHT ARROW** buttons to select the preset number you would like to save the station against.
- 4 Press and hold the **SELECT** button. The LCD Display will show 'Preset X Saved'. The station is now successfully saved against the selected preset number.

### Selecting a preset station

- 1 To select a preset station, press the appropriate **NUMERIC** button on the remote control. The DAB Radio will retune to the selected preset station.

**DONT FORGET!** If the preset number is above 5, press the **SHIFT** button before the **NUMERIC** button.

- 2 To select a preset station using the buttons on the DAB Radio, press the **PRESET** button.
- 3 Use the **LEFT** and **RIGHT ARROW** buttons to highlight the preset station.
- 4 Press the **SELECT** button. The DAB Radio will retune to the selected preset station.

**DONT FORGET!** If you have not preset any stations, 'Empty Preset X' will be displayed on the second line of the LCD Display.

### Information Display

When listening to an FM radio station you can change the information that will appear on the second line of the LCD Display. In FM Radio mode, the DAB Radio will receive Radio Data System (RDS) information. RDS information includes:

- Station Name
- Program Content
- Current Time
- Station Frequency

- 1 To change the information shown on the second line of the display, press the **INFO** button.

## Radio Menu

The radio menu allows you to configure the settings for the DAB Radio.

- ❶ To access the Radio menu, press the **RADIO MENU** button. The Radio menu will be shown on the LCD Display.
- ❷ Press the **LEFT** and **RIGHT ARROW** buttons to scroll through the available features.
- ❸ Press the **SELECT** button to select an option.

**DONT FORGET!** If you access the Radio menu and do not make a selection after a few seconds, the DAB Radio will return to the previous display.

**DONT FORGET!** In FM Radio mode you will only be able to select the 'Clock and SW' version, all the other options are only available in DAB Radio mode.

## Station Order

The Station Order feature allows you to set the way in which the DAB radio stations are displayed.

The available options are:

- Fav Station - displays your favourite stations in numerical then alphabetic order. As you use the DAB Radio, the stations you listen to most are monitored. These are saved as favourite stations and are indicated by a heart shaped icon.
  - Alphanumeric - displays all available in numerical then alphabetic order.
  - Active Station - displays the stations which can be received in your area first followed by the stations which cannot be received.
  - Prune Stations - displays only the stations which can be received in your area.
- ❶ With the Radio menu displayed, press the **LEFT** and **RIGHT ARROW** buttons to highlight 'Station Order'.
  - ❷ Press the **SELECT** button.
  - ❸ Press the **LEFT** and **RIGHT ARROW** buttons to highlight station order.

- ❹ Press the **SELECT** button to confirm the selection. The station list will be displayed in the chosen way.

## Manual Tune

The Manual Tune feature allows you to manually tune a specific station and add this to the station list.

- ❶ With the Radio menu displayed, press the **LEFT** and **RIGHT ARROW** buttons to highlight 'Manual Tune'.
- ❷ Press the **SELECT** button. The station numbers and frequencies will be displayed at the bottom of the LCD Display.
- ❸ Press the **LEFT** and **RIGHT ARROW** buttons to highlight station number you wish to manually tune.
- ❹ Press the **SELECT** button to confirm the selection. The DAB Radio will scan for the selected station. If the station is found, it will be added to the station list.

## Clock

The Clock feature allows you to manually enter the time or to set the DAB Radio to automatically update the clock every time the DAB Radio is turned on.

- ❶ With the Radio menu displayed, press the **LEFT** and **RIGHT ARROW** buttons to highlight 'Clock'.
- ❷ Press the **SELECT** button. The following options are shown in the bottom of the LCD Display.
  - Auto-Set Clock
  - Set Clock
- ❸ Press the **LEFT** and **RIGHT ARROW** buttons to highlight you want to set.
- ❹ To set the DAB Radio to automatically update the clock every time the DAB Radio is turned on, choose the 'Auto-Set Clock' option.
- ❺ Press the **SELECT** button.

- 6 To manually set the clock, choose the 'Set Clock' option. The current time will be shown in the bottom of the LCD Display with the Hours between two arrows.
- 7 To adjust the Hours, press the **LEFT** and **RIGHT ARROW** buttons to increase or decrease the Hours.
- 8 Press the **SELECT** button. The Minutes will be shown between two arrows.
- 9 To adjust the Minutes, press the **LEFT** and **RIGHT ARROW** buttons to increase or decrease the Minutes.
- 10 Press the **SELECT** button. The current year will be shown in the bottom of the LCD Display between two arrows.
- 11 To adjust the Year, press the **LEFT** and **RIGHT ARROW** buttons to increase or decrease the Year.
- 12 Press the **SELECT** button. The current Month will be shown in the bottom of the LCD Display between two arrows.
- 13 To adjust the Month, press the **LEFT** and **RIGHT ARROW** buttons to increase or decrease the Month.
- 14 Press the **SELECT** button. The current Day will be shown in the bottom of the LCD Display between two arrows.
- 15 To adjust the Day, press the **LEFT** and **RIGHT ARROW** buttons to increase or decrease the Day.
- 16 Press the **SELECT** button. The clock will be updated and saved.

**DONT FORGET!** If you turn off the DAB Radio at the **ON/OFF** Switch, the Clock will automatically be updated and the preset time will be lost.

### Dynamic Range Compression (DRC) Value

The DAB Radio is fitted with DRC. This function is used to listen to stations at lower volumes while maintaining subtle effects and keeping the dialogue audible. There are three levels of DRC, these are:

- 0 - No DRC is applied.
  - ½ - 50% compression applied.
  - 1 - 100% compression applied.
- 1 With the Radio menu displayed, press the **LEFT** and **RIGHT ARROW** buttons to highlight 'DRC Value'.
  - 2 Press the **SELECT** button.
  - 3 Press the **LEFT** and **RIGHT ARROW** buttons to highlight the desired DRC value.
  - 4 Press the **SELECT** button to set the DRC value.

### SW Version

The SW Version function allows you to display information on the current software.

- 1 With the Radio menu displayed, press the **LEFT** and **RIGHT ARROW** buttons to highlight 'SW Version'. The software version information is displayed.

### Resetting the DAB Radio

The DAB Radio can be reset to the factory defaults at any time. Once a reset has been performed, the DAB Radio will automatically begin to scan for all available stations.

- 1 To reset the DAB Radio, press and hold the **RADIO MENU** button. After a few seconds, 'Press **SELECT** to confirm reset' will be shown on the LCD Display.
- 2 Press the **SELECT** button to perform the reset.

Problem	Possible Cause	What to do
The DAB Radio does not power on.	<ol style="list-style-type: none"> <li>1. The Power Adaptor is not connected to the DAB Radio</li> <li>2. The wall socket is not turned on.</li> <li>3. The Batteries are flat.</li> </ol>	<ol style="list-style-type: none"> <li>1. Connect the Power Adaptor to the DAB Radio.</li> <li>2. Turn on the power at the wall socket.</li> <li>3. Replace the batteries.</li> </ol>
The DAB Radio will not receive any DAB radio stations.	<ol style="list-style-type: none"> <li>1. The Aerial is not unclipped and extended.</li> <li>2. There is electrical interference from nearby electrical appliances.</li> </ol>	<ol style="list-style-type: none"> <li>1. Unclip and fully extend the Aerial.</li> <li>2. Reposition the DAB Radio to reduce the interference.</li> </ol>
The DAB Radio will not receive any FM radio stations.	<ol style="list-style-type: none"> <li>1. The Aerial is not unclipped and extended.</li> <li>2. The FM radio station is not correctly tuned.</li> <li>3. There is electrical interference from nearby electrical appliances.</li> </ol>	<ol style="list-style-type: none"> <li>1. Unclip and fully extend the Aerial.</li> <li>2. Perform a Scan to retune the station.</li> <li>3. Reposition the DAB Radio to reduce the interference.</li> </ol>
No sound.	<ol style="list-style-type: none"> <li>1. The volume is turned down.</li> <li>2. Headphones are connected to the DAB Radio.</li> </ol>	<ol style="list-style-type: none"> <li>1. Increase the volume.</li> <li>2. Disconnect the headphones.</li> </ol>
My iPod will not dock with the DAB Radio	<ol style="list-style-type: none"> <li>1. Incorrect iPod adaptor used.</li> </ol>	<ol style="list-style-type: none"> <li>1. Select the correct iPod Adaptor.</li> </ol>

### Need extra help?

Don't worry we are just at the other end of the phone. If you are experiencing problems using your new product, before returning it to the retailer, just call **0871 230 1777** or visit **[www.grundig.co.uk](http://www.grundig.co.uk)**

### Need a spare part?

In the unlikely event of you needing spare parts, please contact our spares department on: **0871 230 0790**

## 06 Specifications

<b>Power Supply (Input)</b>	<ul style="list-style-type: none"><li>• 230 V ~ 50 Hz</li><li>• 6 x 'C' type batteries</li></ul>
<b>Power Supply (Output)</b>	<ul style="list-style-type: none"><li>• 9 V DC 1200 mA</li></ul>
<b>Power Output</b>	<ul style="list-style-type: none"><li>• 2 x 2 W RMS @ 10% THD output</li></ul>
<b>Radio Frequency Coverage</b>	<ul style="list-style-type: none"><li>• 174-240 MHz</li><li>• 87.5-108 MHz</li></ul>

**IMPORTANT:** This manual contains for-reference-only graphics and information that are subject to change without prior notice.



- Unqualified attempts to repair the DAB Radio unit will invalidate the warranty.
- Refer repairs of the DAB Radio to qualified service personnel only.
- Do not disassemble the DAB Radio.
- Store the DAB Radio in a clean, dry environment.
- Wipe dust off the DAB Radio with a clean, dry and soft cloth.
- For stubborn stains use a damp (not dripping) cloth.
- Do not expose the DAB Radio to rain or moisture, dripping or splashing.
- Do not use any cleaning solutions on the DAB Radio.

### Servicing

The DAB Radio contains no user serviceable parts. When servicing, refer to qualified service personnel. Call the Grundig Helpline if you are ever in doubt about the operation or safety of this product.



### WEEE

This appliance is labelled in accordance with European Directive 2002/96/EG concerning used electrical and electronic appliances (Waste Electrical and Electronic Equipment - WEEE).

The guideline determines the framework for the return and recycling of used appliances.

### Sound levels

Your hearing is very important to you and to us, so please take care when using the DAB Radio. It is strongly recommended that you follow the listed guidelines in order to prevent possible damage or loss of hearing, especially when using headphones.

#### Establish a safe sound level

Over time your hearing will adapt to continuous loud sounds and will give the impression that the volume has in fact been reduced. What seems normal to you may in fact be harmful. To guard against this **before your hearing adapts**, set the volume to a low level.

Slowly increase the level until you can hear comfortably and clearly and without distortion. Damage to your hearing is accumulative and is irreversible. Any ringing or discomfort in the ears indicates that the volume is too loud.

Once you have established a comfortable listening level, **do not increase the sound level.**

## 08 Guarantee

The DAB Radio is guaranteed for twelve months from the date of original purchase. If any defect due to faulty materials or workmanship, contact the Grundig Helpline. Have your receipt of purchase on hand.

The guarantee is subject to the following provisions:

- It is only valid within the boundaries of the country of purchase.
- The product must be correctly installed and operated in accordance with the instructions contained in this User Guide.
- The unit must be used solely for domestic purposes.
- The guarantee will be rendered invalid if the unit is re-sold or has been damaged by inexpert repair.
- The manufacturer disclaims any liability for incidental or consequential damages.
- The guarantee is in addition to, and does not diminish, your statutory or legal rights.

**GRUNDIG**

Technical Support: 0871 230 1777

DCS-JUL08-GUADB08IP

## Free Manuals Download Website

<http://myh66.com>

<http://usermanuals.us>

<http://www.somanuals.com>

<http://www.4manuals.cc>

<http://www.manual-lib.com>

<http://www.404manual.com>

<http://www.luxmanual.com>

<http://aubethermostatmanual.com>

Golf course search by state

<http://golfingnear.com>

Email search by domain

<http://emailbydomain.com>

Auto manuals search

<http://auto.somanuals.com>

TV manuals search

<http://tv.somanuals.com>