

## Instruction Manual

# HAAN®

EXPERIENCE STEAM. DISCOVER CLEAN.™

*name: **PowerPro™**  
model numbers: **HS-22 Series***

*“The ideal portable steam cleaner  
for use around the house.”*

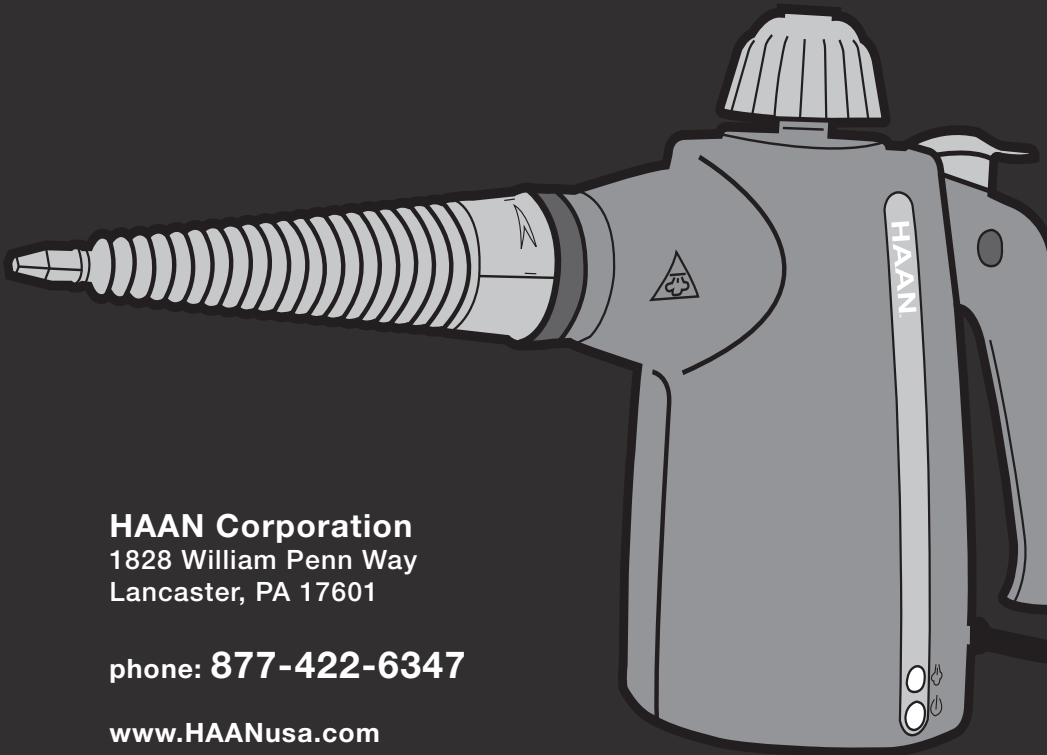

**HAAN Corporation**  
1828 William Penn Way  
Lancaster, PA 17601

phone: **877-422-6347**

[www.HAANusa.com](http://www.HAANusa.com)

## **Notice**

The information contained in this document is subject to change without notice.

**HAAN Corporation** assumes no responsibility for any errors that may appear in this document nor does it make expressed or implied warranty of any kind with regard to this material, including, but not limited to, the implied warranties of merchantability and fitness for a particular purpose.

**HAAN Corporation** shall not be liable for incidental or consequential damages in connection with or arising out of the furnishing, performance, or use of this document and the program materials which it describes.

All rights reserved. No part of this document may be photocopied, reproduced or translated to another language without prior written consent of **HAAN Corporation**.

**HAAN®** is a registered trademark of the **HAAN Corporation**.

**HAAN® Experience Steam. Discover Clean.™** is a trademark of the **HAAN Corporation**.

# Introduction

Congratulations on purchasing a **HAAN®** product. Now you have an easy way to clean just about anything in and around your home.

Your handheld steam cleaner uses steam to remove tough grease, dirt and grime. Steam is nature's purest and most powerful cleaner for safely cleaning all hard surfaces in your home without harsh chemicals, for a perfectly ecological approach. No film, no residue – just clean, germ-free surfaces.

**HAAN®** products are so easy to assemble, you can put them to use right away – anywhere you want to clean and sanitize – from your kitchen and living room to your bathroom floors.

Backed with a one-year limited warranty, your quality **HAAN®** product is sure to give you years of dependability. And our Customer Care representatives are available to answer any of your questions about your new handheld steam cleaner.

Thousands of **HAAN®** customers have already fallen in love with **HAAN®** steam cleaners. We're confident you will, too.

Thank you again for purchasing the **HAAN®** PowerPro™ handheld steam cleaner.

*The **HAAN®** Team*

# Important Safety Instructions

**Basic precautions should be observed when using an electrical appliance, including the following:**

## **IMPORTANT**

Be sure to read ALL instructions and warnings before using your HAAN® Handheld Steam Cleaner.



## **WARNING**

Risk of electrical shock: Be sure to read and follow all instructions and warnings.



## **CAUTION**

The unit emits steam at 212°F to sanitize the area of use. This means that the steam head and attachments get very hot during use. Care should be taken when using this appliance. **DO NOT touch them during use except in the approved manner as outlined in this manual.**

## **SAVE THESE INSTRUCTIONS:**

For household use only. Any other use of this appliance will void the manufacturer's warranty.

1. Do not direct steam at people, animals, or at electrical outlets.
2. Do not expose to rain.
3. Store indoors.
4. Unplug from outlet when not in use and before conducting service maintenance or trouble-shooting.
5. Do not leave steam cleaner unattended.
6. Do not leave the steam cleaner connected to an electrical outlet when not in use.
7. Do not service steam cleaner when it is plugged in.
8. Do not use with damaged cord or plug.
9. Do not use steam cleaner if it has been dropped, damaged, left outdoors or dropped into water. Return to a service center.
10. Do not handle steam cleaner with wet hands.
11. Do not pull or carry by cord, use cord as a handle, close door on cord, pull cord around sharp corners or expose cord to heated surfaces.
12. Do not unplug by pulling on cord.
13. Do not use appliance in an enclosed space filled with vapor given off by oil-based paint thinner, some moth-proofing substances, flammable dust, or other explosive or toxic vapors.
14. Do not allow unit to be used as a toy.
15. Do not use on leather, wax polished furniture or floors, synthetic fabrics, velvet or other delicate, steam-sensitive materials.
16. Do not immerse in water or any other liquid.
17. Do not use for any purpose other than described in this User Manual.
18. Use only manufacturer's recommended attachments – use of attachments not provided or sold by HAAN® may cause fire, electric shock or injury.

# Important Safety Instructions

19. Never put descaling, aromatic, alcoholic or detergent products into the steam cleaner, as this may damage it or make it unsafe for use.
20. Unplug by grasping the plug, not the cord.
21. Close attention is necessary when used by or near children.
22. If the circuit breaker activates while using the steam function, discontinue product use immediately and contact the customer support center. (Beware of the risk of electrical shock.)
23. Do not allow the product to be disassembled and/or modified by anyone other than an authorized service technician. (Doing so can result in fire and/or electrical shock.)
24. This product is NOT for space heating purposes.

## IMPORTANT ►



### WARNING

**DO NOT modify the plug. Improper connection of the equipment-grounding conductor can result in a risk of electrical shock.**

**If an extension cord is necessary, a minimum of 15 ampere/14 gauge cord should be used. Cords rated for less may overheat.**

## Grounding Instructions:

The handheld cleaner must be connected to a grounded (3-prong) wiring system. Grounding provides a safe path of least resistance for electrical current in the event the unit should malfunction or break down, thereby reducing the risk of electrical shock. The cord for this product has an equipment-grounding conductor and a grounding plug. Do not plug it into an outlet that is not properly installed and grounded in accordance with all local codes and ordinances.

Check with a qualified electrician or service person if you aren't sure if the outlet is properly grounded. If it will not fit the outlet, have a proper outlet installed by a qualified electrician. This appliance is designed for use on a nominal 120-volt circuit and has a grounding attachment plug as illustrated below. Make certain that the appliance is connected to an outlet having the same configuration as the plug. No plug adapter should be used with this appliance.

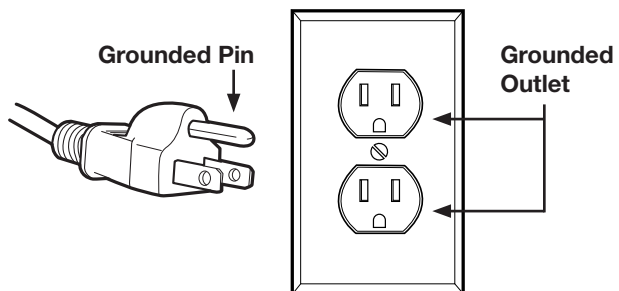

## Care & Maintenance

### IMPORTANT

Always ensure that your handheld steamer is **UNPLUGGED** from the wall receptacle prior to cleaning or emptying the water tank.



### CAUTION

Do not immerse your handheld steamer in water or any other liquid.

1. Do not introduce detergents and/or soap into the water tank.  
NOTE: Tap water can be used in the handheld steamer. If the water in your area is hard, it is recommended that distilled/purified water be used. Doing so can extend the life of the product.
2. Unplug the handheld steamer from the electrical outlet after every use.
3. Press the steam button to fully discharge all remaining pressure.
4. When finished cleaning always empty the water tank. Failure to do so can lead to unpleasant stagnant water odors and tank discoloration.
5. To clean the body of your handheld steam cleaner, wipe it down with a damp cloth.
6. Let the handheld steamer cool completely before storing.
7. When storing, organize the power cord by using the supplied twist tie.
8. Store the unit upright in a protected dry cool area.

# Product Parts

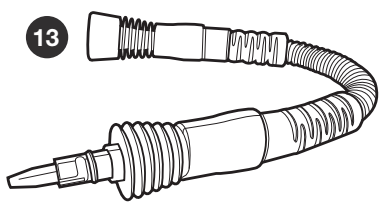
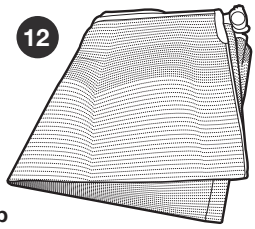
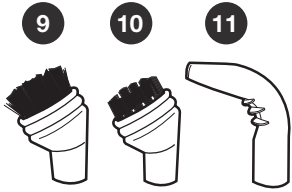
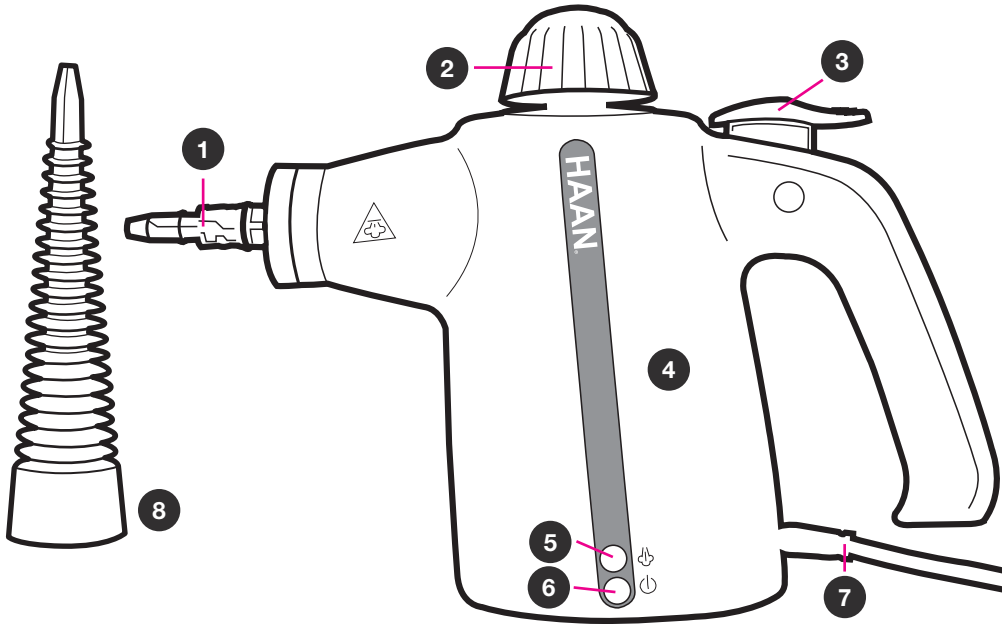

1. Steam Nozzle
2. Pressure Locking Safety Cap
3. Easy Control Trigger
4. Main Body / Water Tank
5. Steam Indicator
6. Power Indicator
7. Power Cord
8. Concentrator Nozzle
9. Wire Bristle Brush
10. Detail Brush
11. Angled Nozzle
12. Accessory Bag
13. Flexible Extension Hose
14. Funnel
15. Measuring Cup
16. Squeegee Attachment
17. Steel Wool
18. Garment/Surface Attachment
19. Cleaning Sock
20. Microfiber Towel and Sponge

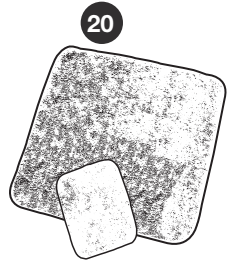
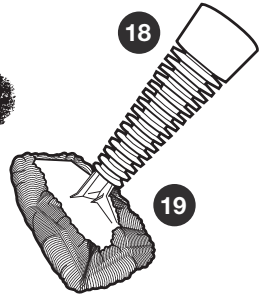
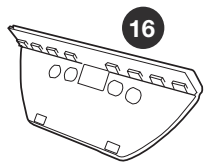

# Before Using Your Handheld Steam Cleaner

Be sure to read **ALL** instructions and warnings *before* using your Handheld Steam Cleaner.



## CAUTION

After plugging in the power cord and beginning to heat, a fixed amount of water is released due to the build-up of internal pressure. After heating is complete, spray the steam 2 to 3 times before affixing or switching any additional attachment.



## CAUTION

Use a grounded receptacle. Use only a heavy duty extension cord rated for 15 amps minimum – **DO NOT** use an ordinary extension cord. To provide continued protection against the risk of electric shock, connect to a properly grounded outlet only.



## CAUTION

The handheld steam cleaner is designed to clean hard surfaces and upholstery that will withstand high heat. **DO NOT** use on soft plastic and cold glass. On surfaces that have been treated with wax, or on some no-wax floors, the sheen may be removed by the heat and steam action. **DO NOT** use on unsealed wood. This could cause the wood panel to rise. It is recommended that an isolated surface area be tested to verify suitability before proceeding to the rest of the area.



## CAUTION

After use, pressure will exist within the product. Press the Control Trigger to eliminate this pressure prior to opening the Pressure Locking Safety Cap.

## Using Your Handheld Steam Cleaner - Operating Instructions

1

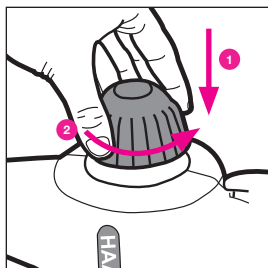

Push all the way down on the Pressure Locking Safety Cap. While cap is pressed, turn counterclockwise to unlock. Continue turning until the cap is loose.

2

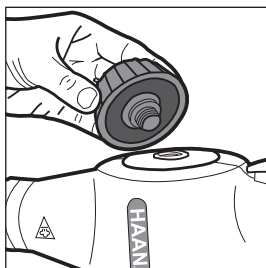

Remove Pressure Locking Safety Cap.

3

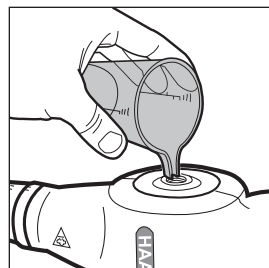

Fill the Measuring Cup with 300ml of water and pour into the water tank.



4

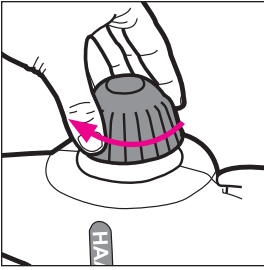

Turn the Pressure Locking Safety Cap clockwise to tighten. You will need to press all the way down and turn to lock. The cap will spin freely when properly tightened.

5

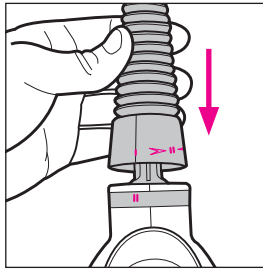

To attach the Concentrator Nozzle, Flexible Extension Hose or Garment/Surface Attachment, line up the indicator line "I" on the accessory attachment with the double indicator line "II" on the handheld unit.

6

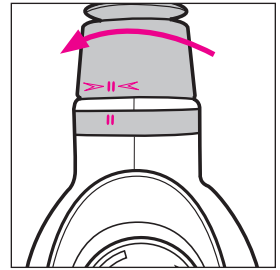

Press accessory onto the Steam Nozzle and rotate so the two double lines "II" match. This is the locked position.

7

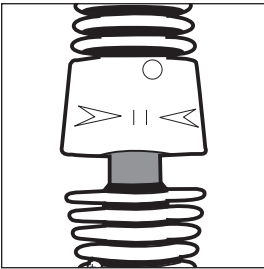

Steps 5-6 can be repeated to add the Concentrator Nozzle or Garment/Surface Attachment onto the end of the Flexible Extension Hose.

8

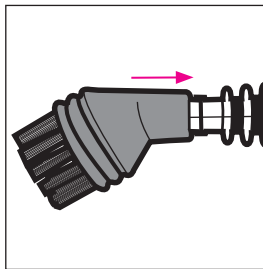

To attach the brushes and angled nozzle, just push onto the end of the handheld unit, Concentrator Nozzle or Extended Flexible Hose.

9

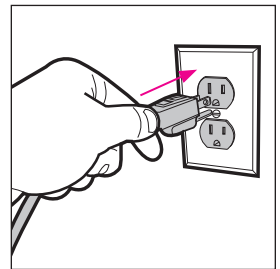

With the desired accessory secured to the unit, turn unit on by plugging into a grounded electrical outlet.

10

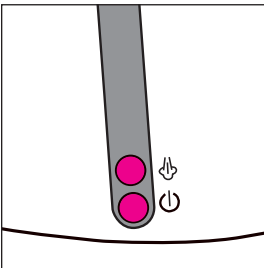

When plugged in, both the Power Indicator and Steam Indicator will light up. Wait 2-3 minutes for unit to heat up.

11

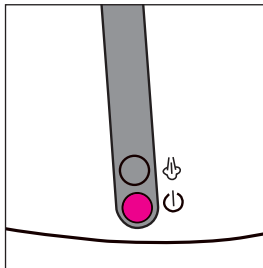

The Steam Indicator will turn off when the unit is ready to use.

12

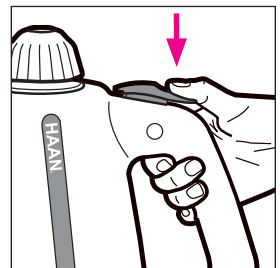

Press the Easy Control Trigger 2-3 times before steam cleaning to release any residual water built up in the nozzle.

**NOTE:** During extended periods of constant steaming the unit will need to occasionally re-pressurize. While building up pressure, the Steam Indicator will turn on. When the unit has re-pressurized the Steam Indicator will turn off.

**NOTE:** A slight odor may occur when using the unit for the first time.

Download from [www.Somanuals.com](http://www.Somanuals.com). All Manuals Search And Download.

# Refilling The Water Tank During Use

1

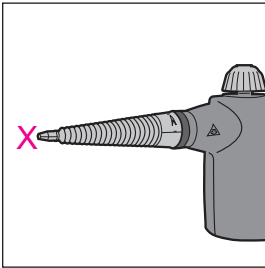

Steam will stop being emitted from the nozzle when the Water Tank is empty.

2

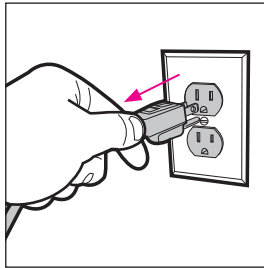

Unplug the unit from the electrical outlet.

3

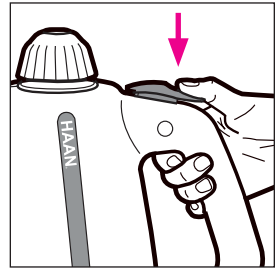

Press the Easy Control Trigger to release all steam remaining inside the tank.

4

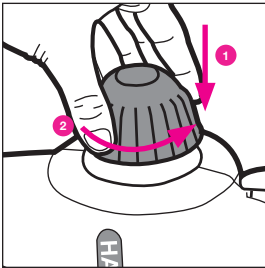

WAIT AT LEAST 3 MINUTES BEFORE REMOVING THE PRESSURE LOCKING SAFETY CAP. This allows the pressure inside the tank to dissipate.

5

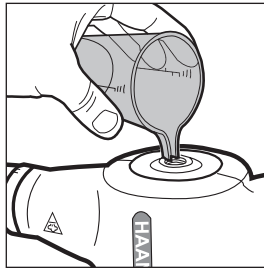

Follow operating instructions 3-12 to continue steam cleaning with the Handheld steam cleaner.

**NOTE:** When finished steam cleaning, always empty any left over water from the water tank. Turn the unit upside down and allow water to drain from the tank.

## Using The Accessories

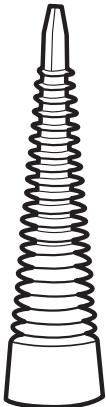

### Concentrator Nozzle:

Use for general steam cleaning. Perfect for cleaning household areas like window frames, shelves, tile, etc. Also can be used in the garage and yard to clean wheel rims, recycling bins, garbage cans, sports equipment, gym bags and athletic shoes.

## Using The Accessories Continued

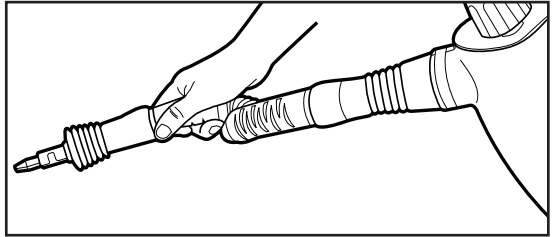
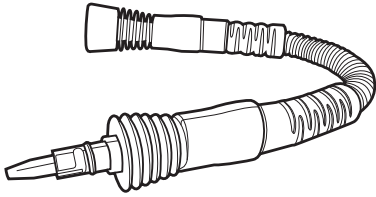

### **Flexible Extension Hose:**

Adds maneuverability when cleaning hard to reach areas.



### **Wire Bristle Brush Attachment:**

Can be used with the Concentrator Nozzle and Flexible Extension Hose. Perfect for scrubbing and steam cleaning hardened and oily grime from kitchen countertops, stovetops, cutting boards, outdoor grilles, etc.



### **Detail Brush Attachment:**

Can be used with the Concentrator Nozzle and Flexible Extension Hose. Great for cleaning small areas and delicate items such as tile grout, automotive interior detailing, faucets, etc.

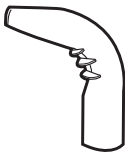

### **Angled Nozzle Attachment:**

Can be used with the Concentrator Nozzle and Flexible Extension Hose. Effectively clean and sanitize under the toilet rim. Also great for cleaning hard to reach corners and openings.

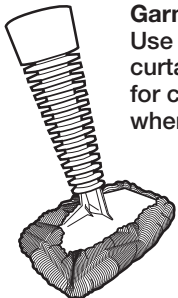

### **Garment/Surface Attachment (with or without cleaning sock):**

Use to clean, freshen and disinfect sofas, carpets, bedding, pillows, curtains, clothing and other soft surfaces throughout the home. Great for cleaning pet beds and plush toys. The cleaning sock should be used when cleaning hard surfaces.

**NOTE:** The cleaning sock is machine washable and should be air dried.

**DO NOT USE FABRIC SOFTENER WHEN WASHING THE CLEANING SOCK.**

## Using The Accessories Continued

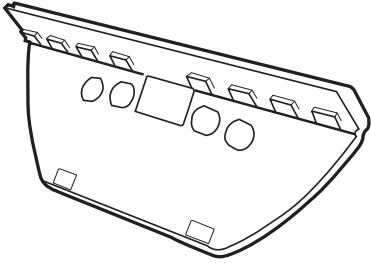

### Squeegee Attachment:

Use to clean areas like windows and shower walls. To use, connect to the Garment/Surface attachment by fastening the top two hooks and then clipping onto the bottom. It may be necessary to slightly push down on the tab in order to clip into place.



### Steel Wool:

Add extra cleaning power for difficult areas. Attach to the brushes by wrapping around the bristles.

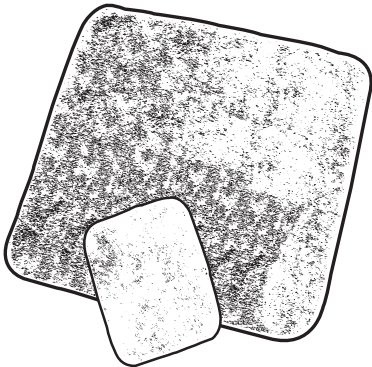

### Microfiber Towel and Sponge:

Use these to wipe away the excess water after cleaning.

**NOTE:** The microfiber towel and sponge are machine washable. It can be machine dried on a low setting. However, for a longer life air drying is recommended.

**DO NOT USE FABRIC SOFTENERS WHEN WASHING THE MICROFIBER TOWEL OR SPONGE.**

# Troubleshooting

Problem	Solution
<b>Water leaks from nozzle.</b>	<ul style="list-style-type: none"><li>• Use no more than 300ml of water in the tank per use.</li><li>• Ensure unit is in an upright position.</li><li>• Wait until the start-up heating cycle is complete.</li></ul>
<b>Unit not operating.</b>	<ul style="list-style-type: none"><li>• Ensure plug is set firmly in outlet.</li><li>• Replace fuse or reset breaker.</li></ul>
<b>Unit does not emit steam.</b>	<ul style="list-style-type: none"><li>• Ensure water tank is filled with water.</li></ul>
<b>Accessory is loose.</b>	<ul style="list-style-type: none"><li>• Reattach accessory and ensure it is tight and properly attached.</li></ul>
<b>Steam emitted when refilling the water tank.</b>	<ul style="list-style-type: none"><li>• Allow unit to completely cool before refilling.</li><li>• Pour water slowly when filling tank.</li></ul>

# Commonly Asked Questions

## **Q: What surfaces can be sanitized by using the steam cleaner?**

A: Your steam cleaner is designed to clean hard surfaces like laminates & countertops, stovetops and tile, ceramic and glass as well as upholstery; any surface that will withstand high heat.

DO NOT use on soft plastic and cold glass. On surfaces that have been treated with wax, or on some no-wax floors, the sheen may be removed by the heat and steam. DO NOT use on unsealed wood. This could cause the wood panel to rise. It is recommended that an isolated surface area be tested to verify suitability before proceeding to the rest of the area.

## **Q: Why does the “Steam Ready” light go on and off when steam cleaning?**

A: This indicates the unit is re-pressurizing itself.

## **Q: How long does a tank of water last?**

A: A full tank will last approximately 7.5 minutes.

## **Q: Do I have to use distilled water?**

A: No. But if the tap water in your area is hard it is recommended that distilled/purified water be used to extend the life of your handheld steam cleaner.

## **Q: Does the HAAN® work on pet stains?**

A: Yes, the HAAN® is able to spot clean fresh pet stains by loosening and lifting the stain.

## **Q: Why can't I open the Pressure Locking Safety Cap during operation?**

A: The high water temperature and pressure inside the tank present a safety hazard. The cap is designed so that it can only be removed when the internal tank pressure and / or temperature is low.

## **Q: Will the HAAN® PowerPro™ HS-22Q clean grout?**

A: Yes, but it needs a little help. Steam the grout to loosen dirt and then scrub with the Detail Brush attachment. However, it will not remove discoloration as this has been absorbed into the grout.

## **Q: Where does the dirt go?**

A: The HS-22Q does not have a suction feature, so it does not pick up loose dirt. Before steaming, vacuum or sweep away loose dirt. After steaming it is recommended that the steamed area be wiped down with a towel to remove any loosened dirt.

## **Couldn't find the Answer to your Question?**

**Call Customer Care at 877-HAAN DIRECT / 877-422-6347**

**To order additional accessories or replacement parts call  
customer care at:**

**877-HAAN DIRECT / 877-422-6347**

**Or visit:**

**[www.HAANusa.com](http://www.HAANusa.com)**

## Notes:



## Product Specifications: Model HS-22Q Series

<b>Color</b>	Black or Red
<b>Size</b>	12.5" W x 5.0" D x 9.0" H
<b>Weight</b>	2.8 lb
<b>Voltage/Hz</b>	120V, 60Hz
<b>Wattage</b>	1200 watts
<b>Cord Length</b>	12' 9"
<b>Tank Capacity</b>	10.1 fluid ounces (300ml)
<b>Heat-up Time</b>	less than 3 minutes
<b>Operating Time</b>	7.5 minutes with constant steam
<small>*Base Dimensions approximated. Base depth measured without nozzle or attachments.</small>	

## One-Year Limited Warranty

Your HAAN® Steamer is warranted to be free from defects in material and workmanship for a period of one (1) year from the date of purchase when utilized for normal household use by the original purchaser only. The included Warranty Registration Card should be filled out and returned within thirty (30) days of purchase. This will register your product.

Should any defect covered by the terms of the limited warranty be discovered within one year, HAAN Corporation will repair or replace the defective part. To process a warranty claim, contact customer care at 877-422-6347 for further assistance and instructions. A customer care agent will conduct trouble shooting in an attempt to fix any minor problems. Should trouble shooting not provide any result, a return authorization will be issued. Proof of purchase is required and should accompany the return. Freight costs must be prepaid by the purchaser.

The liability under this warranty is limited solely to the cost of the replacement parts or the complete unit at our option. Labor charges are not included.

This warranty is extended to the original purchaser of the unit and excludes all other legal and/or conventional warranties. The responsibility of HAAN Corporation, if any, is limited to the specific obligations expressly assumed by it under the terms of the limited warranty. In no event is HAAN Corporation liable for incidental or consequential damages of any nature whatsoever. Some states/provinces do not permit the exclusion or limitation of incidental or consequential damages, so the above may not apply to you. This warranty gives you specific legal rights which vary from state to state or province to province.

**Warranty Notice: failure to complete and return the product registration card will not diminish your warranty rights.**

# Product Registration

Please fill out and mail this Product Registration Card within thirty (30) days of purchase in order to validate the fore said Limited Warranty. The registration will allow us to contact you in the unlikely event of a product safety notification. By returning this card you acknowledge that you have read and understood the instructions for use and the warnings set forth within the instructions.

First Name \_\_\_\_\_ Last Name \_\_\_\_\_

Address \_\_\_\_\_

City \_\_\_\_\_ State/Province \_\_\_\_\_

Zip Code/Postal Code \_\_\_\_\_ Country/Territory \_\_\_\_\_

Product Name/Model number \_\_\_\_\_

Date Purchased \_\_\_\_\_ Place of Purchase \_\_\_\_\_

(Fold here and tape closed before mailing)

**Warranty Notice:** FAILURE TO COMPLETE AND RETURN THIS PRODUCT REGISTRATION CARD WILL NOT DIMINISH YOUR WARRANTY RIGHTS.

**Privacy Notice:** We use this information requested on this card to process your registration, thereby allowing you to receive the benefits of being a registered user, and for use in post-sales services. Other uses of your information are governed by the choices you make in answering the questions and the HAAN® privacy policy. For information on this policy contact 877 - HAAN DIRECT.

1) Yes! I would like HAAN® to send me information on products and services including new product releases, events and special offers. You may contact me by:

EMAIL  \_\_\_\_\_

PHONE  \_\_\_\_\_

MAIL  \_\_\_\_\_

2) What other HAAN® products have you purchased?

\_\_\_\_\_  
\_\_\_\_\_

Cut along dashed line



**Product Registration  
HAAN Corporation  
1828 William Penn Way  
Lancaster, PA 17601**

3) Where did you purchase your HAAN® product?

---

---

---

4) How did you hear about HAAN®?

---

---

---

5) We like to hear from our product owners. Please add any comments here:

---

---

---

---

---

---

---

---

---

---

## Free Manuals Download Website

<http://myh66.com>

<http://usermanuals.us>

<http://www.somanuals.com>

<http://www.4manuals.cc>

<http://www.manual-lib.com>

<http://www.404manual.com>

<http://www.luxmanual.com>

<http://aubethermostatmanual.com>

Golf course search by state

<http://golfingnear.com>

Email search by domain

<http://emailbydomain.com>

Auto manuals search

<http://auto.somanuals.com>

TV manuals search

<http://tv.somanuals.com>