

# Haier®

## TFT-LED LCD TV OWNER'S MANUAL

Please READ this manual carefully before operating your TV, and keep it for future reference.

# Haier

# Haier

**MODELS :**

LEC19B1320  
LEC22B1380  
LEC22B1380W  
LEC24B1380



## Contents

Safety and warnings.....	2-3
Introduction.....	4
Stand installation guide.....	5
Installation.....	6-9
Remote Control.....	10
Operation.....	11-15
Trouble Shooting.....	16
DVD Operation.....	17-20
DVD Trouble Shooting.....	21
Warranty.....	22

## ***SAFETY AND WARNINGS***

### **Important Safety Instructions**

- 1) Read these instructions.
- 2) Keep these instructions.
- 3) Heed all warnings.
- 4) Follow all instructions.
- 5) Do not use this Television near water.
- 6) Clean only with dry cloth.
- 7) Do not block any ventilation openings, install in accordance with the instructions.
- 8) Do not install near any heat sources such as radiations, heat registers, stoves, or other Television (including amplifiers) that produce heat.
- 9) Do not defeat the safety purpose of the polarized plug. If the provided plug does not fit into your outlet, consult an electrician for replacement of the obsolete outlet.
- 10) Protected the power cord from being walked on or pinched particularly at plugs, convenience receptacles, and the point where they exit from the Television.
- 11) Only use attachments/accessories specified by the manufacturer.
- 12) Unplug this Television during lighting storms or when unused for long periods of time.
- 13) Refer all servicing to qualified service personnel. Servicing is required when the Television has been damaged in any way, such as; power-supply cord or plug is damaged, liquid has been spilled or objects have fallen into the Television, the Television has been exposed to rain or moisture, does not operate normally, or has been dropped.
- 14) Only use attachments/accessories specified provided by the manufacturer, the product is supplied by AC adapter, the AC adapter is used as disconnect device, the disconnect device shall remain readily operable.
- 15) The ventilation should not be impeded by covering the ventilation openings with items, such as newspapers, table-cloth, curtains, etc.
- 16) No naked flame sources, such as lighted candles, should be placed on the Television.
- 17) Attention should be drawn to the environmental aspects of battery disposal.
- 18) The use of Television in moderate climate.

### **WARNING:**

To reduce the risk of fire or electric shock, do not expose this Television to rain or moisture.

### **WARNING:**

The batteries shall not be exposed to excessive heat such as sunshine, fire or the like.

### **WARNING:**

Never place heavy or sharp objects on the LCD panel or frame.



This marking indicates that this product should not be disposed with other household wastes throughout the EU. To prevent possible harm to the environment or human health from uncontrolled waste disposal, recycle it responsibly to promote the sustainable reuse of material resources. To return your used device, please use the return and collection systems or contact the retailer where the product was purchased. They can take this product for environmental safe recycling.

Haier is committed to safely recycling electronic products and product materials. Please check for a local recycling location in the United States at: [1800RECYCLING.COM](http://1800RECYCLING.COM) or call 1.800.RECYCLING.

## SAFETY AND WARNINGS

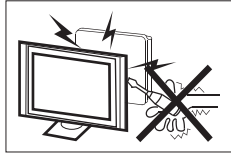

High voltages are used in the operation of this television receiver. Do not open the cabinet. Refer servicing to qualified service personnel.



Never stand on, lean on, or suddenly push the television or its stand. You should pay special attention to children. Serious injury may result if it falls.

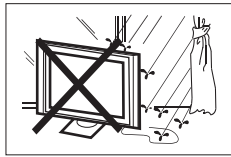

To prevent fire or electrical shock hazard, do not expose the television receiver to rain or moisture.

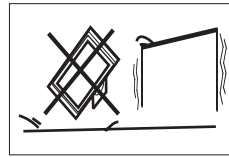

Do not place your television on an unstable cart, stand, shelf or table. Serious injury to an individual and/or damage to the television may result if it falls.



Do not drop or push objects into the television cabinet slots or openings. Never spill any kind of liquid on the television receiver.

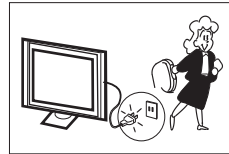

When the television receiver is not used for an extended period of time, it is advisable to disconnect the AC power cord from the AC outlet.



Do not block the ventilation holes on the back cover of the TV. Adequate ventilation is essential to prevent failure of electrical components.

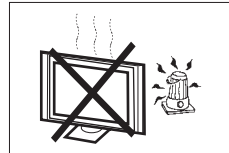

Avoid exposing the television receiver to direct sunlight and other sources of heat. Do not stand the television receiver directly on other products which give off heat, e.g. video cassette players and audio amplifiers. Do not place naked flame sources, such as lighted candles on or near the television.

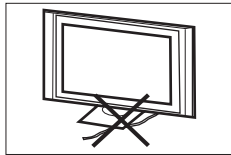

Do not trap the power supply cord under the television receiver's stand.

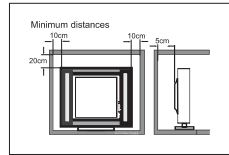

If the television is to be built into a compartment or similar enclosure, the minimum distances must be maintained. Heat build-up can reduce the life of your television, and can also be dangerous.

**Main features**

- Integrated ATSC TV tuner for HDTV broadcast reception
- High brightness provides a vivid and brilliant picture
- Deeper blacks and brighter whites with high contrast
- Wide Screen aspect ratio (16:9) for a complete home theater experience
- HDMI input for true digital connection
- VGA port for connection to PC
- Built-in stereo speaker system
- Full-function Remote Control

**Accessories**

- Power adapter..... 1
- Infrared Remote Control..... 1
- User's Manual ..... 1
- Battery(AAA)..... 2

**Main parameter**

Viewing Picture Size (diagonal)	19 inches	22 inches	24 inches
Resolution:	1366x768	1920x1080	1920x1080
Power supply	DC 12V, 3A (Power adaptor supplied)		
Audio Output Power (THD ≤ 7%):	2x3W		
Aspect Ratio:	16:9		
TV System:	ATSC Digital system and NTSC Analog system		
Video Signal System:	NTSC		
Receiving Channel:	Cable :1-135/ Air: 2-69 (ATV&DTV)		
High-Definition Multimedia Interface (HDMI) Input	x 2		
YCb(Pb)Cr(Pr) Input	x 1		
Composite Video Input	x 1		
Analog RGB (VGA) Input	x 1		
Audio Input	x 2		
Headphone Output	x 1		
Coaxial Output	x 1		
USB Input	x 1		
Horizontal definition (TV line)	Composite Video Input >=350 Video Input >=400 YCb(Pb)Cr(Pr) >=400		

## Base Stand Assembly Instruction

1. Place the TV with the display side down on a flat surface. Use a cloth to protect the display. Position the stand base plate onto the bottom of the stand pole.

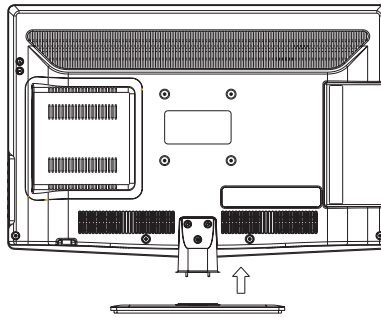

2. Attach the stand base plate to the stand pole by firmly tightening the supplied screw.

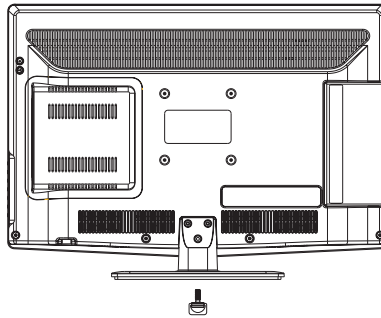

Front panel

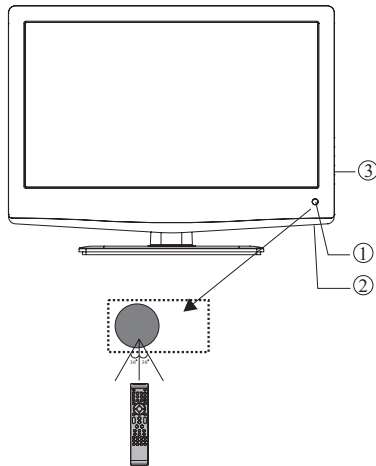

- 1: Remote control sensor.
- 2: Indicator LED: BLUE ● POWER ON.  
RED ● STANDBY.
- 3: Side panel keys

Side panel

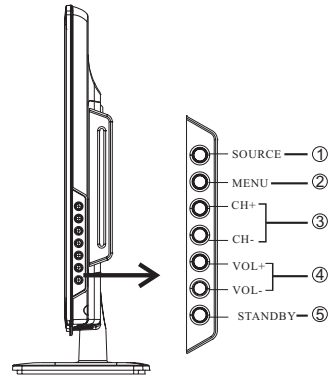

- 1. **SOURCE:** Display the input source menu.
- 2. **MENU:** Display main MENU.
- 3. **CH+/CH-:** In TV mode, press "CH+" or "CH-" to change the channel up and down. In MENU mode, press "CH+" or "CH-" to select items in standby mode, press "CH+" or "CH-" to turn on the TV.
- 4. **VOL+/VOL-:** Adjust sound level. In MENU mode, press "VOL+ " or "VOL- " to adjust the item that you selected.
- 5. **STANDBY:** Press this button to turn the unit ON from STANDBY mode. Press it again to turn the set back to STANDBY.

REAR Connections

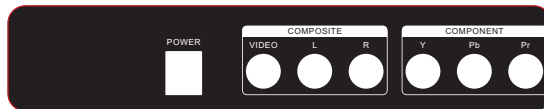

All the terminals are (from left to right):  
POWER SOCKET, VIDEO, AUDIO INPUT, YPbPr INPUT  
Note: AV and YPbPr share one audio channel.

SIDE Connections



All the terminals are (from left to right):  
HDMI1, HDMI2, USB, VGA, HEADPHONE, PC AUDIO, COAXIAL, RF.  
Note: 1. When HDMI1 has an input signal coming from a DVI source then the audio input signal must be connected to the PC audio input.  
2. When HDMI2 has an input signal coming from a DVI source then the audio input signal must be connected to the YPbPr/AV audio input.

**ANTENNA**

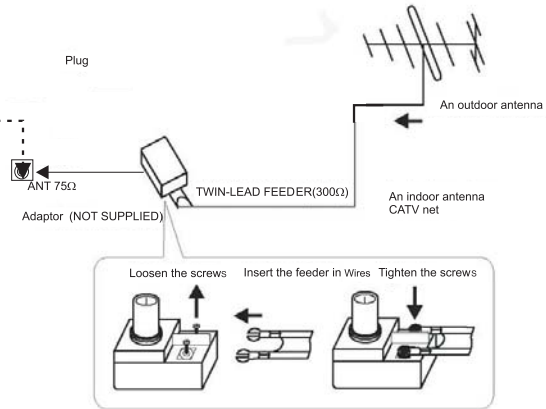
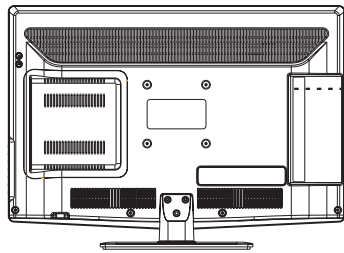

Note:  
Aerial connections: IEC (female).  
Input impedance: 75Ω unbalanced.

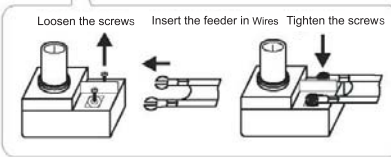

**PC**

**STEPS:**

Be sure both the TV and computer are set to

Power off.

1. Connect VGA and audio cable.

2. Connect the power cord.

3. Power on the TV, switch to PC mode.

4. Power on the PC.

This sequence is very important.

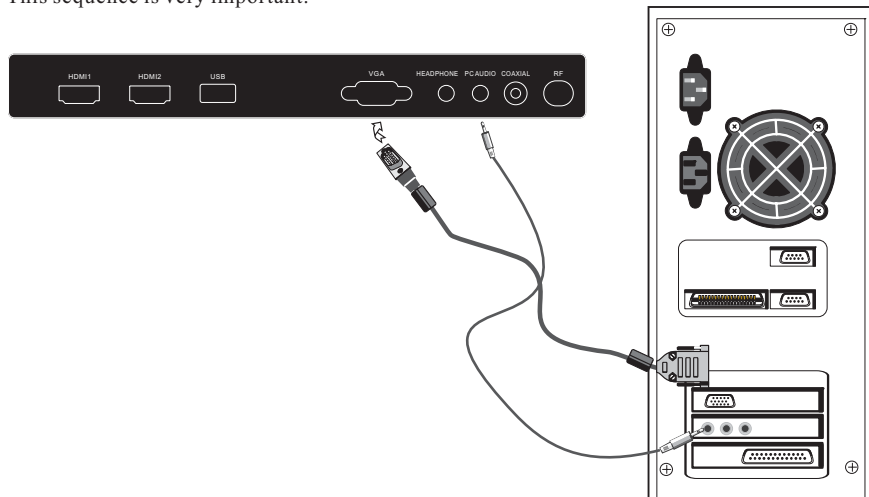



## INSTALLATION

Apply power to the TV by connecting the included AC adaptor to the power input on the back of the set. Make sure when plugging the adaptor into an AC receptacle that the polarized plug is properly inserted. Do not attempt to file or cut the blade.

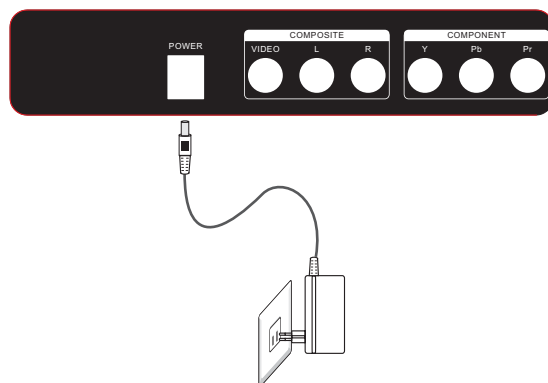

## PC

### PRESET MODE

	RESOLUTION	V.Freq.(Hz)	H.Freq.(KHz)
1	720*400	70	31.47
2	640*480	60	31.47
3	640*480	75	37.50
4	800*600	60	37.88
5	800*600	75	46.88
6	1024*768	60	48.36
7	1024*768	70	56.48
8	1024*768	75	60.02
9	1280*1024	60	63.98
10	1280*1024	75	80.00

AV EQUIPMENT

You can use the input terminals on TV set rear as follows.

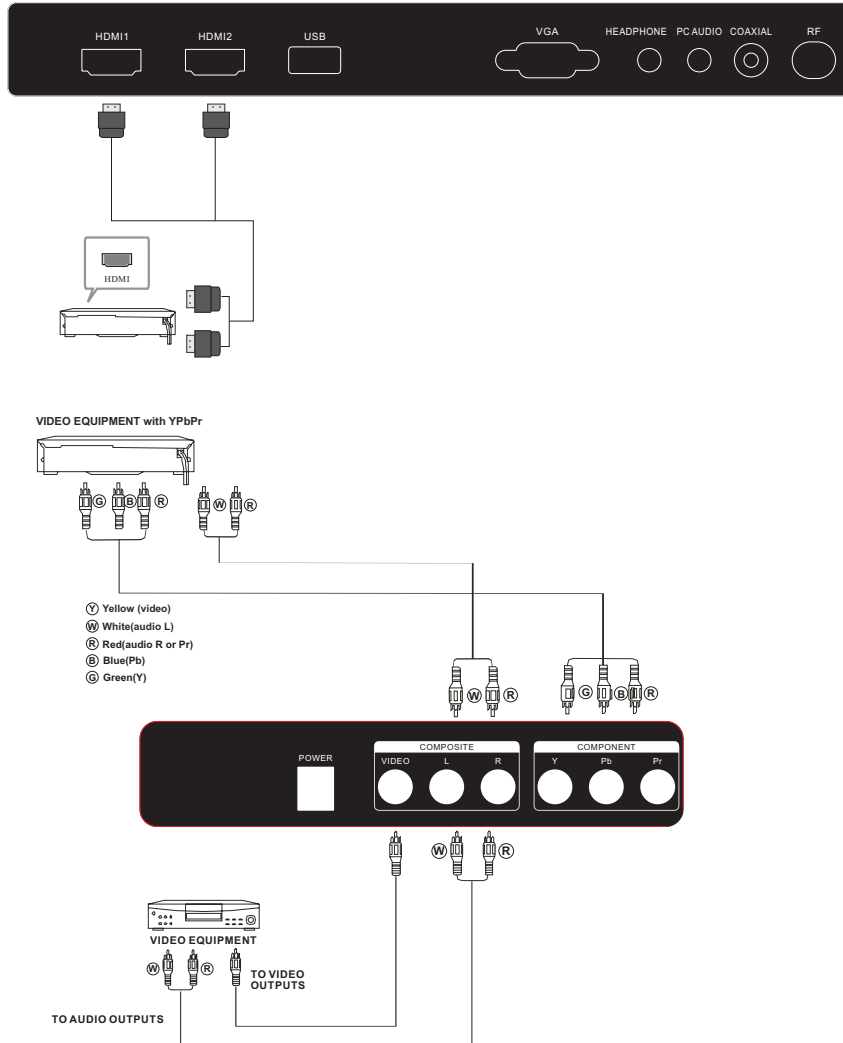

The television's inputs can be connected to the following types of equipment: VCR, multi disc player, DVD, camcorder, video game or stereo system, etc.....  
YPbPr can support these video formats:480i,576i,480p,576p,720p,1080i.

## REMOTE CONTROL

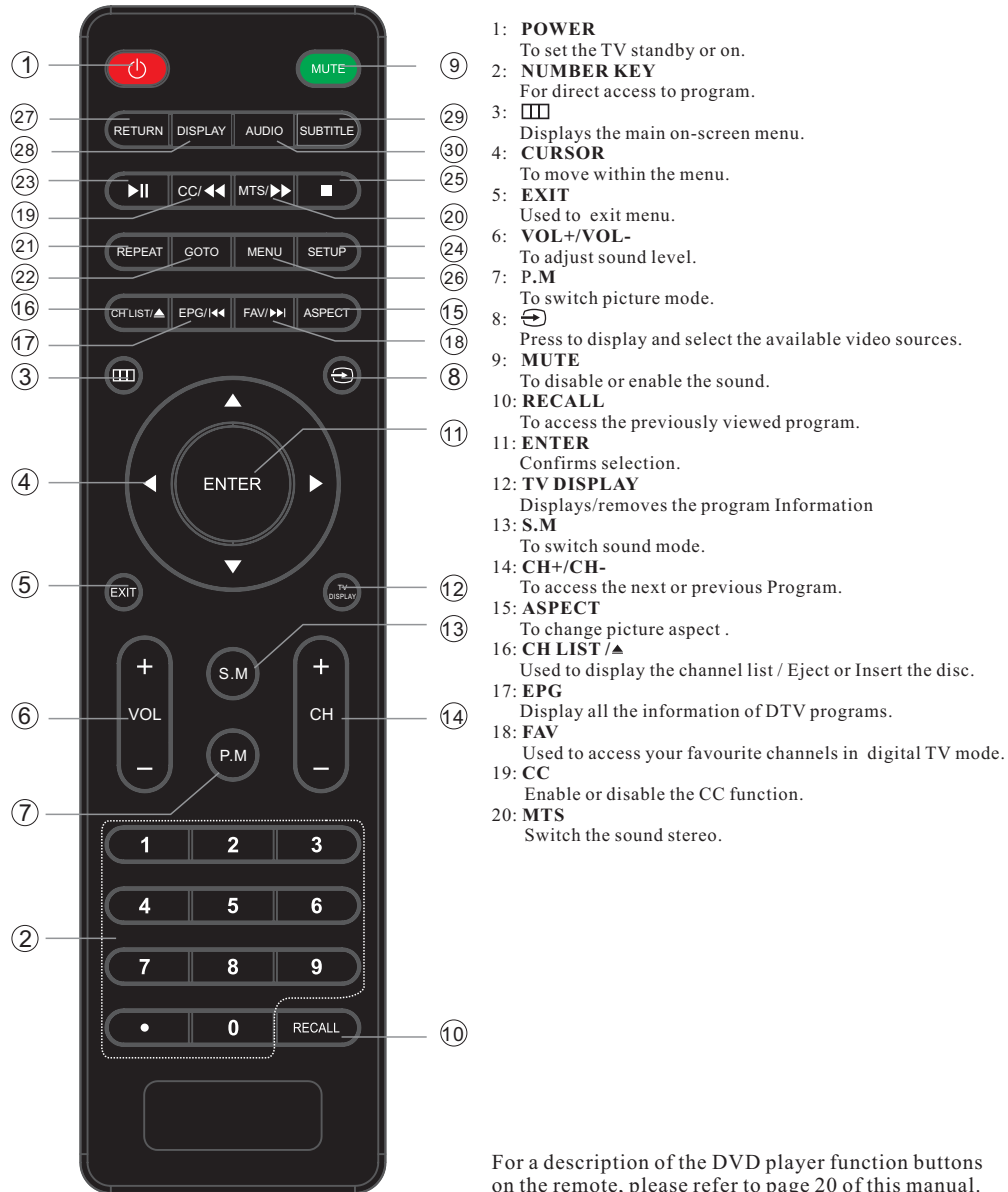

For a description of the DVD player function buttons on the remote, please refer to page 20 of this manual.

**1. PICTURE MENU**

The first item of the MENU is the PICTURE MENU. This menu provides several video adjustment options for fine tuning the video display. Press ▼▲ to select, press ◀▶ to adjust, press MENU to exit.

- 1). Picture Mode: Select the user picture mode (Standard, Sports, Movie, Custom, Vivid).
- 2). Brightness: This will adjust the light output of the complete picture, which will mainly affect the dark areas of the picture.
- 3). Contrast: This will adjust the intensity of bright parts in the picture but keep the dark parts unchanged.
- 4). Color: This will adjust the saturation level of the colors to suit your personal preference.
- 5). Tint: Allows you to select color mix (tint) of the picture.
- 6). Sharpness: This will adjust sharpness of fine details in the picture.

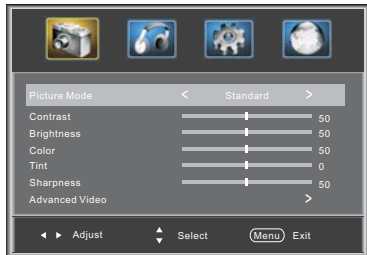

**Note:**  
If you want to adjust contrast, brightness, color, and sharpness, the picture mode must be set to "Custom".

**Advanced Video:**  
Press ▼▲ to select Advanced Video, press ▶, and the screen shown below will be displayed.

- 1). Color Temp: This will adjust color temperature (Cool, Normal, Warm) to suit your preference.
- 2). Aspect: This will vary the size of the image on the TV screen. There are four modes which can be selected (Wide, Zoom, Cinema and Normal).
- 3). Noise Reduction: Adjust to reduce the appearance of noise in the picture (dots). There are five modes to choose from (Strong, Auto, Off, Weak and Middle).



**2. AUDIO menu**

The second item of the MENU is the AUDIO MENU. You can adjust sound options here. Press ▼▲ to select, press ◀▶ to adjust, press MENU to exit.

- 1). Sound Mode: Select the user sound mode (Standard, News, Music, Theater, Sports, Custom).
- 2). Bass: Adjust to increase or decrease lower-pitched sounds.
- 3). Treble: Adjust to increase or decrease higher-pitched sounds.
- 4). Balance: Adjust to emphasize left or right speaker balance.
- 5). Surround: Turn on or off the simulated surround sound feature.
- 6). AVL: Auto Volume Level, this will reduce the differences in volume level between TV programming.
- 7). Digital Output: Select the digital sound signal that will output from the coaxial audio output.
- 8). Audio Language: Select the audio language (English, French, Spanish).

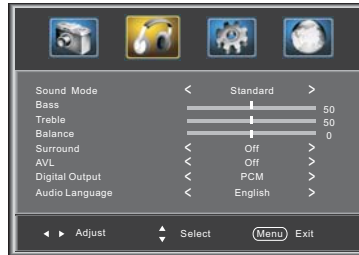

**Note:**  
The Audio language option is only available for ATSC (DTV) programs.

**3. SETUP MENU**

The third item of the MENU is the SETUP MENU. You can set system settings here. Press ▼▲ to select, press ◀▶ to adjust, press MENU to exit.



**Note:**  
Restore Default: Reset all settings to the factory default value.  
Channel names that have been changed through the option in the Channel Menu are not reset when a restore default is initiated.

**3.1. Parental Controls:**

Press ▼▲ to select Parental Controls, press ▶, and the screen shown below will be displayed.

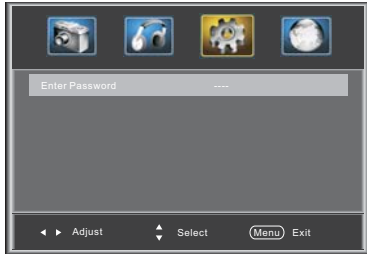

Input the password, and you will enter the Parental Control menu. The factory default password is 0000.

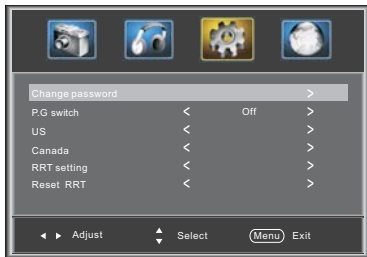

**Change Password:**  
Press ►, and the screen shown below will be displayed.

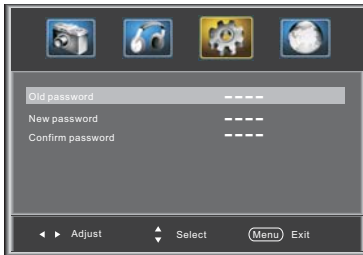

- 1). Old password: Input the old password
- 2). New password: Input the new password
- 3). Confirm password: Input the new password again

**P.G. switch:**  
When the Parental Control is ON, the options shown below can be adjusted.

**US:** Press ►, and the screen shown below will be displayed.

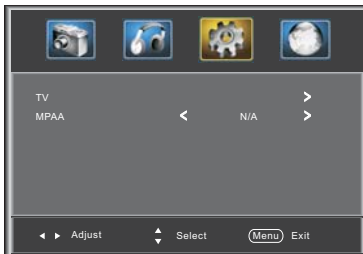

1): TV: Press ►, and the screen shown below will be displayed.



Rating	Content	Content				
		FV (Fantasy violence)	V (Violence)	S (Sexual situation)	L (Adult language)	D (Sexually suggestive dialog)
Suggested age	TV-Y (All children)					
	TV-Y7 (Direct to order children)	X				
	TV-G (General audience)					
	TV-PG (Parental Guidance suggested)		X	X	X	X
	TV-14 (Parents strongly cautioned)		X	X	X	X
	TV-MA (Mature audience only)		X	X	X	

Press the ENTER key to lock/unlock Parental Controls.

- 2). MPAA: switch the movie-rating control level: N/A, G, PG, PG-13, R, NC-17, X.

Rating	Description
G	General audiences. All Ages admitted
PG	Parental Guidance suggested. Some material may not be Suitable for children.
PG-13	Parents strongly cautioned. Some material .may be Inappropriate for children under 13.
R	Restrict. Under 17 requires accompanying parent or adult guardian (age varies in some jurisdictions).
NC-17	No one 17 and under admitted.
X	X is an order rating that is unified with NC-17 but may be encoded in the data of older movies.

**Canada:** Press ►, and the screen shown below will be displayed.



- 1): Canada English: switch the English-rating control level: EXEMPT, C, C8+, G, PG, 14+, 18+.

Rating	Description
E	Exempt: Includes news, sports, documents and other information programming; talk shows, music videos, and variety programming.
C	Children: Intended for younger children under the age of 8 years. Pays careful attention to themes that could threaten their sense of security and well-being.
C8+	Children over 8 years old: Contains no portrayal of violence as the preferred, acceptable, or only way to resolve conflict; nor encourage children to imitate dangerous acts which they may see on the screen.
G	General: Considered acceptable for all age groups. Appropriate viewing for the entire family, contains very little violence, physical, verbal or emotional.
PG	Parental Guidance: Intended for a general audience, but may not be suitable for younger children (under the age of 8) because it could contain controversial themes or issues.
14+	Over 14 Years: Could contain themes where violence is one of the dominant elements of the storyline, but it must be integral to the development of plot or character. Language usage could be profane and nudity, present within the context of the theme.
18+	Adults: Intended for viewers 18 years and older and might contain depictions of violence, which while related to the development of plot, character or themes, are intended for adult viewing. Could contain graphic language and portrayals of nudity.

2) Canada French: switch the French-rating control level: E, G, 8ANS+, 13 ANS+, 16ANS+, 18ANS+.

Rating	Description
E	Exempt programming
G	General: All ages and children, contains minimal direct violence, but may be integrated into the plot in a humorous or unrealistic manner.
8ans+	General but inadvisable for young children: May be viewed by a wide public audience, but could contain scenes disturbing to children under 8 who cannot distinguish between imaginary and real situations. Recommended for viewing with parental guidance.
13ans+	Over 13 years: Could contain scenes of frequent violent scenes and intense violence.
16ans+	Over 16 years: Could contain frequent violent scenes and violence.
18ans+	Over 18 years: Only for adult viewing. Could contain frequent violent scenes and extreme violence.

RRT setting: in ATSC digital TV mode, it could be adjusted

Reset RRT: Press **▶**, and the screen shown below will be displayed.



### 3.2 Timer

You can adjust sleep timer and time related settings here. Press **▼▲** to select, press **◀▶** to adjust, press **MENU** to exit.

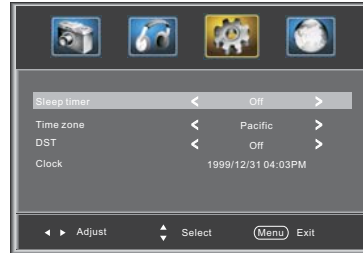

Sleep Timer: You can set the sleep timer.

Note:

Time zone, DST and Clock are available in ATSC mode, and the Clock can't be adjusted.

### 3.3 Closed Caption: switch the closed caption mode.

Press **▼▲** to select Closed Caption, press **▶**, and the screen shown below will be displayed.

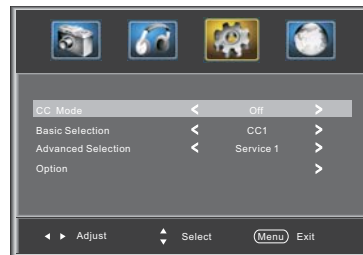

1): Advanced selection: only available in ATSC mode.

2): Option: You can edit the closed caption options.

Press **▶**, and the screen shown below will be displayed.



NOTE: Only available in ATSC mode.

### 3.4 Menu Settings

You can adjust Menu Settings here.  
Press  $\blacktriangledown/\blacktriangle$  to select, press  $\blacktriangleleft/\blacktriangleright$  to adjust, press MENU to exit.

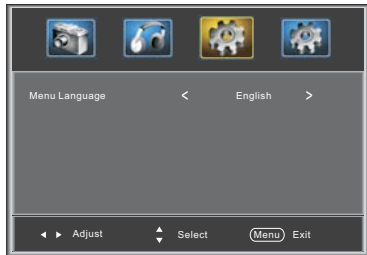

### 3.5 VGA Settings: Only available in VGA (PC input) mode.

Press  $\blacktriangledown/\blacktriangle$  to select VGA Settings, press  $\blacktriangleright$ , and the screen shown below will be displayed.



- 1). H-Pos: Adjust the horizontal position of the screen.
- 2). V-Pos: Adjust the vertical position of the screen.
- 3). Clock: Fine tune the screen width.
- 4). Phase: Fine tune the phase of the screen. Usually you don't need to adjust this item option.
- 5). Auto: Auto adjust to fit the screen.

### 4. Channel MENU

Here you add/skip TV channels and customize displayed channel info.  
Press  $\blacktriangledown/\blacktriangle$  to select, press  $\blacktriangleleft/\blacktriangleright$  to adjust.



- 1). Air/Cable: Select Air TV signal or Cable TV signal.
- 2). Auto Scan: If it's the first time using the TV, you should perform a full channel scan in order to capture and store all available channels.  
Press the  $\blacktriangleright$  to confirm, and the screen shown below will be displayed.

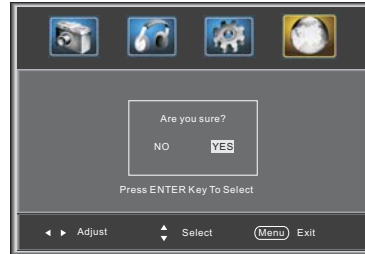

Select "YES" and press the **ENTER** to confirm, and the screen shown below will be displayed, which indicates that the auto search is progressing.

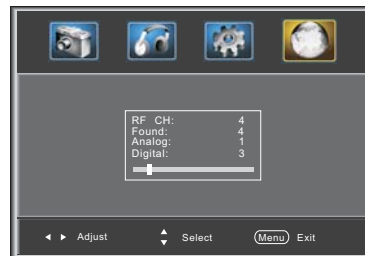

- 3). Favorite: Press  $\blacktriangleleft/\blacktriangleright$  to add/delete favorite channels.
- 4). Show/Hide: Press the ENTER button to display or hide channels.
- 5). Channel NO. : Display the current channel number. Press  $\blacktriangleleft/\blacktriangleright$  to change the channel.
- 6). Channel label: Press  $\blacktriangledown/\blacktriangle$  to edit the current channel name.
- 7). DTV signal: Display DTV signal strength.  
Signal strength indicator is for reference only, it cannot be selected or adjusted.

**5. Multimedia MENU**

With an external storage device attached to the USB input, you can use the Multimedia Menu to display JPEG pictures and play MP3 music.

Before starting operation, verify USB storage device is of FAT32 file system format. This television does not support NTFS or other formats. Please use a high-speed USB 2.0 device with a maximum capacity of 50GB.

1. Select a Photo  
The screen shown below will be displayed.

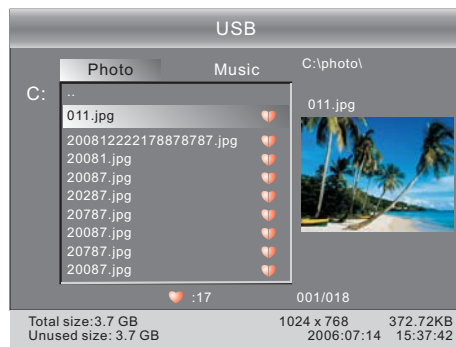

Use **◆** select the .jpg files or folders, press ENTER to play, press EXIT to stop playing or go to the previous menu.

2. Select Music  
The screen shown below will be displayed.



















Use **◆** select the .MP3 files or folders, press ENTER to play, press EXIT to go to the previous menu.

- : play
- : pause
- : stop
- : fast backward
- : previous
- : next
- : fast forward
- : repeat all
- : random play

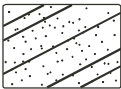

## TROUBLE SHOOTING

Trouble phenomenon Symptom		Inspection Check
Picture	Audio	
 Snow	 Noise	antenna position, direction or connection
 Ghost	 Normal audio	antenna position, direction or connection
 Interference	 Noise	electronic equipment, car/ motorcycle, fluorescent light
 Normal Picture	 Mute	Volume (check if mute is activated or if the audio system connections are not correct)
 No picture	 Mute	Power cord is not inserted Power switch is not opened Contrast and brightness/volume setup Press standby key on the remote control for inspecting
 No color	 Normal audio	Color control
 Picture breaking up	 Normal audio or weak	Retune channel
 No color	 Noise	TVsystem

The LCD TV panel is built with very high precision technology giving you fine picture details in vibrant color. Occasionally, a few non-active pixels may appear on the screen as a fixed point of red, green, blue, black or white. Please note this does not affect the performance of the product.

**DVD SIDE PANEL  
(LEC19B1320)**

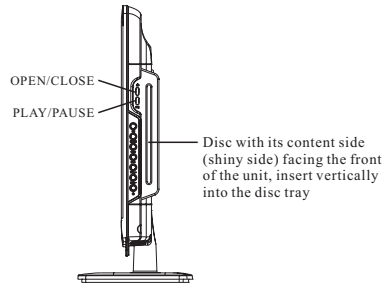

**DVD SIDE PANEL  
(LEC22B1380 / LEC22B1380W / LEC24B1380)**

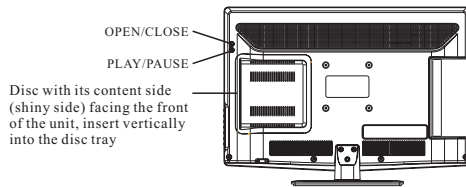

**How to play a DVD disc**

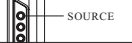
1. Change TV input source to "DVD" mode by pressing  button on remote or Source button  on the side of the TV.

2. Place DVD disc in player with the content side (shiny side) facing the front of the unit.

3. DVD disc will automatically be loaded in to the player and begin to play.

4. To eject the DVD disc, press  Eject/Insert button on remote or the  button on the side of the unit



Caution

This DVD Player has a Class 1 laser which may be harmful to your eyes. Do not attempt to disassemble the cabinet or make any adjustments. Refer all servicing to a qualified professional.

**Features**

Disc formats supported by this player:



MPEG4 files on discs



Multi-angle



Dolby Digital



Subtitle choices



KODAK picture CD



Audio choices



MP3 files on CD-R/CD-RW

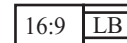

TV Aspect Ratio modes



DVD video



Parental Lock

This product incorporates copyright protection technology that is protected by method claims of certain U.S. patents and other intellectual property rights owned by Macro vision Corporation and other rights owners. Use of this copyright protection technology must be authorized by Macro vision Corporation, and is intended for home and other limited viewing uses only. Unless otherwise authorized by Macro vision Corporation. Reverse engineering or disassembly is prohibited.

The product complies with the KODAK Picture CD format and will display KODAK Picture CDs. The "KODAK Picture CD Compatible" logo is a trademark of Eastman Kodak Company and is used with permission.

Manufactured under license from Dolby Laboratories. "Dolby" and the double-D symbol are trademarks of Dolby Laboratories. Confidential Unpublished Works. 1992-1997 Dolby Laboratories, Inc. All rights reserved.

**MENU OPERATION**

Press the SETUP button on the remote control, the SETUP MENU will be displayed. After accessing the setup menu, press the direction buttons for up and down movement to select an item desired, and press RIGHT direction button to select the SUBMENU item. Then press the ENTER/OK button to confirm. Press LEFT direction button return to the menu of upper level. To exit the setup, press the SETUP button again. In the SETUP MENU, you may choose any of the following options as you like.

**LANGUAGE SETUP**

Select Language in the setup menu, and display the Language submenu:

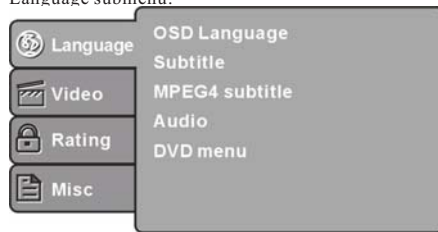

**OSD Language**

Use this item to select the desired language for the setup menu and screen display.

**Subtitle**

This option provides the preset subtitle language.

**MPEG4 Subtitle(optional)**

Select different MPEG4 subtitle encoding option.  
**Note:** Not all players support this item.

**Audio**

Select the built-in disc dubbing language options.

**DVD Menu**

This option provides the film's menu language options.

**VIDEO SETUP**

Select Video in the setup menu, and display the Video submenu:

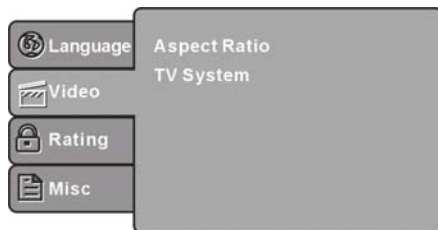

**SYSTEM SETUP**

**Aspect Ratio**

Select the aspect ratio.

**Notes:**

The image display ratio is related to the recorded disc format. Some disc can not display images in the aspect ratio you choose. If you play a disc recorded in 4:3 format on a wide screen TV, black bars will appear on the left and right side of the screen. You must adjust the screen setting depending on the type of the television you have.

**TV System**

Select the different TV system.

**Note:** The DVD player setting should be matched to your TV set. For more information of output format, refer to the instructions or your TV set.

**RATING SETUP**

Select Rating in the setup menu, and display the Rating submenu:

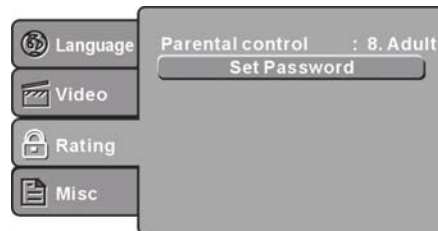

**Parental Control**

Set the parental control feature of the player  
**Note:** Password is needed before setting Parental Control.

**Set Password**

Input four digits (password), then press ENTER /Ok to confirm.

**Note:** If you forget your password, please use the universal password 6666 to unlock.

**MISC SETUP**

Select MISC in the setup menu, and display the submenu:

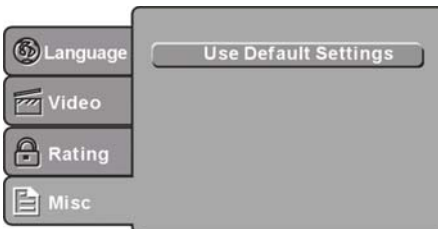

**Use Default Settings**

Reset setup data to factory default value.

**MP3/WMA/JPEG PLAYBACK**



The MP3/WMA disc has such a directory structure as shown picture above.

Press **Direction key** to choose the root directory and then press ENTER/OK button to enter into the sub directory. Press **Direction key** to choose the desired track and then press ENTER/OK or **PLAY** to enjoy the music or movie. If you want to return to the upper menu, press **Direction key** to choose  the icon and press ENTER/OK button.

**Filter:** Allows selecting the categories of files displayed in the browser list.

**Repeat:** To switch different repeat playing mode

**Mode:** Select different playing mode as follows:

**Normal:** Shuffle mode is cancelled.

**Shuffle:** Shuffle mode enabled. When playback reaches the end of the current chapter/track, playback jumps to a random chapter/track. As the end of each chapter/track is reached, another random chapter/track will be played until all tracks/chapters have been played or the Shuffle mode is cancelled by toggling to a different **Mode** Option.

**Edit Mode:** To enable programmed playback mode. When you select the mode, press **LEFT** Direction key to directory and press ENTER/OK to choose the desired track and press **Add to program** and press **Program view** and press the **Edit mode** to cancel the edit mode. At last press **Left key** to display program track and press ENTER/OK to start program playback.

**Program view:** Display program track.

**Brower view:** Display track directory.

**Add to program:** Choice the track press **Add to program** to add the track of the program play directory.

**Clear program:** In the complete stop state (press the **STOP** button twice), First press Edit mode to enable the edit mode. Press Left key to program track and press ENTER/OK to cancel the desired track. press **Clear program** to delete the track of the program play directory.

**PICTURE CD PLAYBACK**

The PICTURE CD disc has such a directory structure as shown in the following picture.

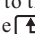

Press **Direction key** to choose the root directory and then press ENTER/OK button to enter into the sub directory. Press **Direction key** to choose the desired picture and then press ENTER/OK or **PLAY** to enjoy the picture. If you want to return to the upper menu, press **Direction key** to choose  the icon and press ENTER/OK button.

**Image rotation**

In picture play state, press **Direction key** to rotate the picture.

**Function Buttons****INSERT/EJECT ▲**

Eject the disc, press the INSERT/EJECT key; Insert the disc, press the INSERT/EJECT key again.

Insert a disc into the DVD player but could not get it to work press the INSERT/EJECT key on the remote or on the TV unit to eject the disc. When a disc is ejecting or is ejected but not take out, press the INSERT/EJECT key on the remote or on the TV unit to insert the disc.

**SUBTITLE**

Press the button to choose different captions (*Requires support from disc*)

**GOTO**

For DVD discs, press the button to choose the desired title and chapter and search the desired title time and chapter time. For Super VCD, VCD, CD discs, press this button to search the desired disc time and track time and choose the desired track.

Note: During VCD playback, the PBC mode must be set to OFF.

**0-9 keys**

These keys are used to input the time, as well as title, chapter and track numbers. When a numeric item is displayed on the screen, press the 0-9 keys to select the desired entry, and press ENTER/OK to confirm.

When a VCD is playing (with PBC off), press the 0-9 keys to select a track directly.

**MENU**

During DVD playback, press MENU to display the disc menu of the current title. During VCD/SVCD playback, press MENU to control PBC ON/OFF.

**SETUP**

Press the button to enter the system setting menu. Press the button again to exit the menu.

**RETURN**

When DVD/SVCD/VCD displaying, press RETURN button to the menu (PBC ON only).

**DISPLAY**

Press the button to show the information of the current playing disc.

**ENTER**

Press the button to confirm your choice on screen.

**REV ◀◀**

During DVD, CD MP3 or VCD playback, press REV to scan in reverse. The player will review the disc at different times speed. Press PLAY/PAUSE to resume normal playback.

**FWD ▶▶**

During DVD, CD, MP3, or VCD playback, press FWD to scan forward. The player will cue the disc at different speed. Press PLAY/PAUSE to resume normal playback.

**PREV ◀◀**

During DVD, CD, MP3, or VCD playback, press PREV to play the previous chapter, title or track.

**NEXT ▶▶**

During DVD, CD, MP3, or VCD playback, press NEXT to play the next chapter, title or track.

**STOP ■**

Press the button once and the player will be in memory stop state. Continuously press this button twice and the player will be in complete stop state.

**Play/Pause ▶||**

In pause state or stop state, press the button, the player will be in playing state. In play state, press the button the player will be in pause state.

**REPEAT**

Press to select between different repeat modes — Repeat Chapter / Repeat Title / Repeat Off (for DVD discs) , Repeat Single / Repeat Folder / All / Repeat Off (for VCD / CD / MP3 discs)

**AUDIO**

Changes the audio language or audio channel.

If you have any questions, please consult the troubleshooting guide below:

### **NO PICTURE OR SOUND**

- Ensure the power button is on.
- Ensure the power outlet is operational.
- Ensure the power cord is not damaged.
- Ensure the power plug is connected firmly to the outlet.

### **PICTURE BUT NO SOUND**

- Ensure the audio is not set to mute.
- Ensure you have set the player's AUDIO settings correctly.

### **POOR PICTURE OR SOUND**

- Ensure you have set the player's AUDIO settings correctly.
- Ensure the disc is not scratched or stained.

### **"BAD DISC" DISPLAYED**

- Ensure the disc is not warped, damaged or deformed.
- Ensure the disc is not badly stained or damaged.
- Ensure the disc format is compatible with the player.
- Please check whether you have tried to play a software CD. If so, please restart the player.

### **REMOTE NOT WORKING**

- Make sure the Main unit's POWER button is on.
- Ensure the remote batteries are working.
- Point the remote control directly at the player's IR sensor.
- Remove any obstacles between the remote and the IR sensor.

### **UNIT NOT WORKING**

- Turn off the power, and then turn it on again.

### **"NO DISC" DISPLAYED**

- Ensure you have put the disc on the tray.
- Ensure the disc is not upside down.
- Ensure the disc is not distorted, stained or scratched.

## Warranty

This Haier brand product, when shipped in its original container, will be free from defective workmanship and materials, and agrees that it will, at its option, either repair the defect or replace the defective product with a new or re-manufactured equivalent, for parts or labor for the periods set forth below:

This warranty does not apply to the appearance of the product or the exterior of the product, which has been damaged or defaced, altered or modified in design or construction. It does not apply to the additional excluded items set forth below:

The warranty commences on the date the item was purchased and the original purchase receipt must be presented to the authorized service center before warranty repairs are rendered.

The limited warranty described herein is in addition to whatever implied warranties may be granted to purchasers by law. ALL IMPLIED WARRANTIES INCLUDING THE WARRANTIES OF MERCHANTABILITY AND FITNESS FOR USE ARE LIMITED TO THE PERIOD(S) FROM THE DATE OF PURCHASE SET FORTH BELOW. Some states do not allow limitations on how long an implied warranty lasts, so the above limitation may not apply to you.

Neither the sales personnel of the seller nor any other person is authorized to make any warranties other than those described herein, or to extend the duration of any warranties beyond the time period described herein on behalf of Haier.

The warranties described herein shall be the sole and exclusive warranties granted by Haier and shall be the sole and exclusive remedy available to the purchaser. Correction of defects in the manner and for the period of time described herein, shall constitute complete fulfillment of all abilities and

Responsibility of Haier to the purchaser with respect to the product, and shall constitute full satisfaction of all claims, whether based on contract, negligence, strict liability or otherwise. In no event shall Haier be liable, or in any way responsible for any damages or defects in the product which were caused by repairs or attempted repairs performed by anyone other than an authorized service center or dealer; nor shall Haier be liable, or in any way responsible for incidental or consequential economic or property damage. Some states do not allow the exclusion of incidental or consequential damages, so that above exclusion may not apply to you.

THIS WARRANTY GIVES YOU SPECIFIC LEGAL RIGHTS. YOU MAY ALSO HAVE OTHER RIGHTS WHICH VARY FROM STATE TO STATE.

Warranty period for this product is 90 days labor, 1 year parts. Additional items excluded from warranty coverage: non-rechargeable batteries. What to do to obtain service or to obtain product literature, accessories, supplies or customer assistance: Simply call 1-877-337-3639. Be sure to have proof of purchase.

# Haier®



## Free Manuals Download Website

<http://myh66.com>

<http://usermanuals.us>

<http://www.somanuals.com>

<http://www.4manuals.cc>

<http://www.manual-lib.com>

<http://www.404manual.com>

<http://www.luxmanual.com>

<http://aubethermostatmanual.com>

Golf course search by state

<http://golfingnear.com>

Email search by domain

<http://emailbydomain.com>

Auto manuals search

<http://auto.somanuals.com>

TV manuals search

<http://tv.somanuals.com>