

Top Load Clothes Washer

Machine a laver

Lavadora de ropa con carga superior

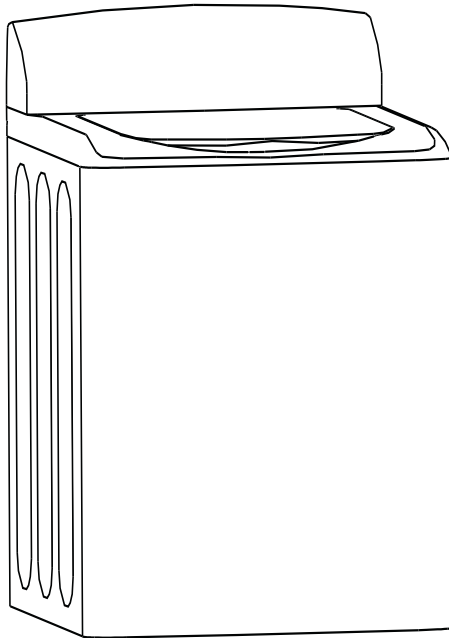

User Manual

Model # HLT364XXQ, GWT900AW, GWT800AW, GWT700AW

Guide de l'Utilisateur

Modèle # HLT364XXQ, GWT900AW, GWT800AW, GWT700AW

Manual del Usuario

Para Modelo de # HLT364XXQ, GWT900AW, GWT800AW, GWT700AW

Haier

Quality • Innovation • Style

IMPORTANT SAFETY INSTRUCTIONS

WARNING - To reduce the risk of fire, electric shock, or injury to persons when using your appliance, follow the basic precautions, including the following:

1. **Read all of the instructions before using this appliance.**
2. Use this appliance only for its intended purpose as described in this use and care guide.
3. Use only detergents or softeners recommended for use in a clothes washer and keep them out of the reach of children.
4. This washer must be properly installed in accordance with the installation instructions before it is used.
5. Never unplug your washer by pulling on the power cord. Always grasp the plug firmly and pull straight out from the outlet.
6. Replace immediately worn power cords, loose plugs/power outlets.
7. Unplug your washer before cleaning.
8. If your old washer is not being used, we recommend that you remove the door. This will reduce the possibility of danger to children.
9. Do not operate your washer in the presence of explosive flames.
10. Do not use washer to wash clothes soaked, spotted or washed in gasoline, dry cleaning solvents or any other explosive or flammable substances that could ignite and explode.
11. Clothes or rags used to clean flammable or explosive materials should not be washed in the washer till all traces of this material has been removed, to avoid an accident.
12. Do not add or mix any flammable or explosive substances to the wash.
13. Do not try to remove clothes while the tub or the agitator is moving. Let it come to a complete stop before use.
14. Washer loading door must be closed when agitator and tub is spinning.
15. Do not operate your washer when parts are missing or parts are broken.
16. Do not use the washer for commercial clothes washing.
17. Do not operate washer unless all enclosure panels are properly in place.
18. Do not tamper with controls.

19. To reduce risk of injury do not allow children to play in or on the washer.
20. Washer must be connected to proper electrical outlet with the correct electrical supply.
21. Proper grounding must be ensured to reduce the risk of shock or fire. **DO NOT CUT OR REMOVE THE GROUNDING PLUG.** If you do not have a 3-prong electric receptacle outlet in the wall, have a certified electrician install the proper receptacle. The wall receptacle **MUST** be properly grounded.
22. Hydrogen gas may be produced if the water heater has not been used in more than 2 weeks. This could be explosive and can explode under certain circumstances. If this is the case, before using the washer, turn on all the hot water faucet's and let the hot water run for a few minutes. This will let the trapped hydrogen escape. During this process do not turn on an electric appliance, smoke, light a match/lighter or use a flame to avoid an accident, as hydrogen gas is flammable and can explode.

SAVE THESE INSTRUCTIONS

DANGER

Risk of child entrapment. Before you throw away your old washer, take off the door so that children may not easily get trapped inside.

Thank you for using our Haier product. This easy-to-use manual will guide you in getting the best use of your washer.

Remember to record the model and serial number. They are on a label in back of the washer.

Model number

Serial number

Date of purchase

Staple your receipt to your manual.

You will need it to obtain warranty service.

Table Of Contents

	PAGE
SAFETY INSTRUCTIONS	1
OPERATING INSTRUCTIONS	4-8
Parts and Features	4
Operations	5
Normal Operating Sounds	7
Lint Filter.....	8
Safety Lid Switch	8
CARE AND CLEANING GUIDE	9
Cleaning and Maintenance	9
Moving and Vacationing	9
Storage of your Washer.....	9
TROUBLESHOOTING	10
INSTALLATION INSTRUCTIONS	12-14
Tools and Materials Required.....	12
Unpacking your Washer	13
Leveling your Washer	13
Steps for Installation	14
ELECTRICAL CONNECTIONS	16
Grounding Instructions	16
Power Interruptions	16
WARRANTY	17

OPERATING INSTRUCTIONS

Parts and Features

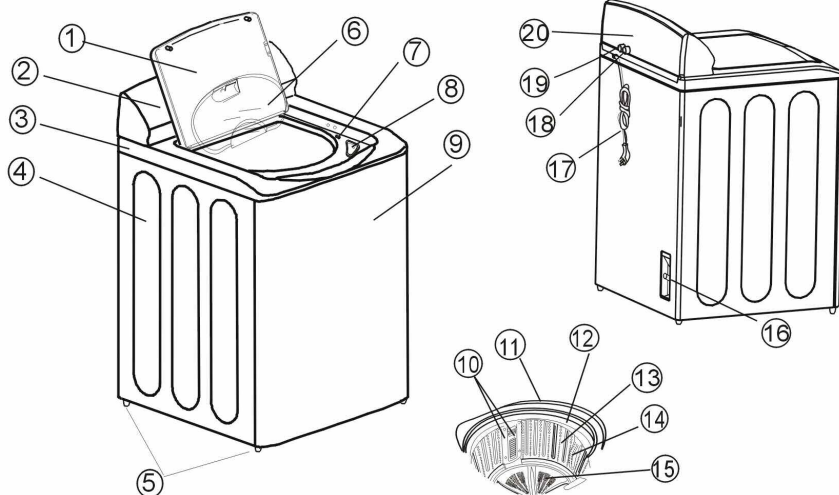

- | | |
|---------------------------|-------------------------------|
| 1. Top Lid | 11. Outer Tub Cover |
| 2. Control Panel | 12. Balance Ring |
| 3. Control Panel Seat | 13. Inner Tub |
| 4. Cabinet | 14. Stick |
| 5. Leveling Legs | 15. Pulsator |
| 6. Inner Cover | 16. Drain Hose joint |
| 7. Door Switch | 17. Power Cord (120Volt/60Hz) |
| 8. Bleach Injection Inlet | 18. Cold Water Inlet Valve |
| 9. Front Panel | 19. Hot Water Inlet Valve |
| 10. Filter, Filter Cover | 20. Back Cover |

Operations



Note: Features may vary per model.

Delay Start

- When not activated, the display shows a cycles' remaining time through the wash process.
- When Delay Start is selected, the indicator light will display a minimum delay of 2 hours. Push button once for every additional 1 hour delay for up to 24 hours.

Cycles

- Normal - For regular washing, such as cotton.
- Heavy - For washing bigger, thicker and heavily soiled laundry.
- Whites - For washing cotton fabrics and whites
- Colors - For washing color fabrics.
- Quick - For quick washing of lightly soiled laundry.
- Delicate - For washing of delicate fabrics.
- Hand Wash - To have hand wash effect on clothes.
- Wrinkle Control - For reducing wrinkles.
- Custom Cycle - To maintain prior settings in memory.

Process Select

This is to select a wash process.

- Soak will not work in the Hand Wash, Delicates and Quick Cycles.
- Water level indicator will shut off if only Spin is selected.

Extra Rinse

- Once a program is selected press the Process Select button to have 2nd Rinse. The washer will add a 2nd rinse.

Soak

- Selecting this function will allow heavily soiled clothes to soak. No agitation occurs until washer begins "wash" cycle.

Wash Speed / Spin Speed

- To select wash or spin speed.

Water Level

- Water levels may be set at the beginning of the wash or in pause.
- During Soak, Wash or Rinse, press this button to manually replenish water. Release for the water to stop. Function automatically is inactive when water reaches the overflow protection level.

Cycle Signal

- Signal volume can be adjusted soft–loud or off.

Soil Level

- Select clothes soil level.
- Wash cycle increases 2 minutes for each level increased.

Temperature Wash / Rinse

- To select inlet water temperature for wash and rinse.

Auto Temp Control

- Models with this feature will automatically adjust water to the proper temperature.

Power Off

- If washer is ON push button once to shut off the power.

Start / Pause

- Once washer is powered and selections are chosen, push this button once to start the wash.
- While unit is working, push this button once to pause it.
- If unit is in pause mode, push this button once to resume operation.

Delay Start Indicator

- Indicates remaining minutes when cycle is in progress.
- Indicates remaining hours during delay process.
- Indicates faults codes or conditions that are not normal.

Time List of Each Program (minute)

PROGRAM	TOTAL TIME (min)	
	Including Soak	Not Including Soak
Whites	About 75-81	About 45-51
Heavy	About 77-83	About 47-53
Normal	About 59-69	About 39-49
Quick Wash	/	About 25
Delicate	/	About 36-42
Hand Wash	/	About 38-44

Note: Total time may be affected by water inlet and drain time. It may also be affected by the water pressure. Normal, Heavy and Cotton programs could combine the process of soak during which the washing machine first soaks for about 20-30 minutes with slight agitation after water filling and then begins to wash.

Loading the Washer

- Load each item loosely.
- Separate the white and colored clothes. Separate heavy clothes from light clothes.
- Carefully check all pockets and cuffs for small items. They can easily slide into the tub and may damage the tub.
- Pre-treat all stains and heavily soiled areas for best results.
- Do not overload your washer.
- When loading wet items, keep water level high enough so items can float easily in the water.
- Close the door properly after loading the clothes. If you keep the lid up, the agitation will not start.

Proper Use of Detergent

- It is good washing practice to add the detergent to the water before you add the clothes so that the detergent can work effectively on your clothes.
- It is recommended to use HE (High Efficiency Detergent). This washer needs less suds to give good wash performance.

Note: You can use less or more detergent depending on the size of the load, water type in your living area whether it is soft or hard and whether the clothes are heavily soiled or lightly soiled.

Bleach Dispenser

- Bleach dispenser is located on front corner under the loading door.
- Pour in recommended amount of bleach into dispenser during the first wash fill.

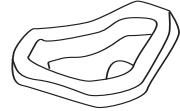

Note: Use only liquid bleach in dispenser.

Warning:

- Be careful not to spill undiluted bleach on the washer cabinet or your clothes. As it is a strong chemical, it may damage some of your clothes or the finish of the washer if not properly diluted.
- Use the manufacturer's chart, on product container for recommended use of liquid or powder bleach.

Normal Operating Sounds

The following sounds are normally heard during the operation of the washer:

- Tumbling sounds: This is normal as the heavy wet clothes in the washer are continuously being tossed around.
- Air rushing noise: This happens when the washer tub spins at very high RPM.
- Wash and Rinse cycles going on and off will also make clicking sounds.

Lint Filter

- The lint filter must be used during washing
- It must be cleaned after each wash.

1. Take off the lint filter. Pull up the lint filter from the inner tub.

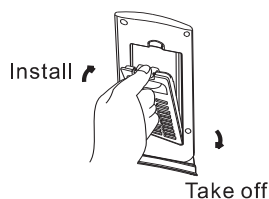

2. Remove the lint filter.
3. Reinstall the lint filter.

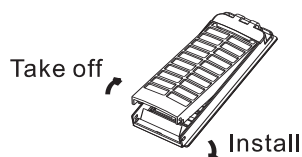

Install the Inner Cover

1. Open the top lid of the washing machine.
2. Put the inner cover component on the outer tub cover, aiming the inner cover shaft to the installation hole of the corresponding outer tub cover shaft groove.
3. Insert the inner cover shaft of one side into the corresponding outer tub cover shaft groove, then push the other inner cover shaft into the corresponding outer tub cover shaft groove.
4. Do not disassemble after installation.

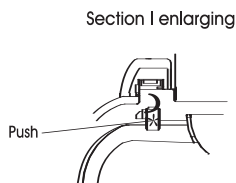
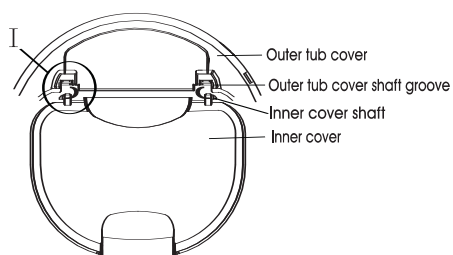

CARE AND CLEANING GUIDE

Warning: Always unplug your washer to avoid electric shock before cleaning. Ignoring this warning may result in death or injury. Before using cleaning products, always read and follow manufacture's instructions and warnings to avoid personal injury or product damage.

Cleaning & Maintenance

- Use only damp or sudsy cloth for cleaning control panel.
- To avoid any kind of damage to cabinet finish, wipe washer cabinet as needed. If you spill liquid/powdered softener, bleach or detergent on the cabinet, wipe cabinet immediately because it can damage the finish.
- Do not use any abrasive, harsh chemicals, ammonia, chlorine bleach, concentrated detergent, solvents or metal scouring pads. Some of these chemicals may dissolve, damage and/or discolor your washer.
- Remove pins or other sharp objects from clothes to prevent scratching of interior parts.
- Leave lid open after you are done washing to allow inside of washer to dry and prevent bad odors.

Moving & Vacationing

- Turn off water supply faucet's and disconnect hoses. Drain water from all hoses. This will prevent from damaging due to water leakage if the hoses accidentally get ruptured or they become loose.
- Disconnect electrical plug.
- Dry inner wash tub. If moving washer, disconnect drain hose.
- Turn the leveling legs clockwise all the way in.
- Move and store your washer in upright position only.
- To prevent mold or mildew, leave lid open so moisture inside machine can evaporate.

Storage of Your Washer in Cold Environment

- The washer must be stored at room temperature.
- If you just got delivery of a washer when outside temperature is below freezing, do not operate until washer has warmed to room temperature.
- Do not install or operate your washer where room temperature is below freezing.

TROUBLESHOOTING

Washer does not operate:

- Check if unit is plugged in.
- Check if the electrical wall receptacle is of proper voltage.
- Check if the circuit breaker needs to be reset or if the fuse needs to be replaced.
- Check if the washer is overloaded: load may need to be re-balanced and clothes may need to be redistributed.
- Check if the lid is open. You may have to close the lid properly.
- The washer pauses in some cycles. This is normal in delicate or hand-washable cycle, which has short soak period where your clothes are being soaked for very short period of time. You will not hear washer operation for a short period of time. When the soak time is over, it will start automatically.

Problems with water:

- Not enough water coming out: Water faucet may need to be turned on fully. Water hoses may be tangled up. Straighten up hoses. Check water level selection, it may need to be readjusted.
- Water temperature is incorrect: Check your water heater temperature. Hot water needs to be at a temperature at least 120°F - 140°F (49°C - 60°C). Check to make sure the inlet hoses are properly connected. (e.g. hot to hot and cold to cold.)
- Water leaks: This is due to not properly installing drain hose or fill hoses. Your home drain may be clogged or having constant water pressure. You may need to tighten hoses, check the plumbing or call a plumber.
- Water will not drain: This is due to not installing your drain hose properly. You may need to connect the drain hose properly. Check the position of the drain hose. In order to drain properly, make sure that top of drain outlet is less than 4 ft. (1.2m) above the floor.

Washer is making noise:

- Washer may need to be reinstalled. (Check washer installation section.)
- Washer load may need to be re-balanced, as the load may be uneven.
- Coins, loose change, buttons or other heavy objects could make noise (read Operation Guide – Normal Operating Sounds.)
- Squealing Sounds: Due to overloaded wash tub.
- Vibration Noises: Due to not leveling washer properly on the floor and uneven distribution of clothes in the tub.

Problems with clothes:

- Clothes are too wrinkled: this is due to improper sorting, overloading and washing in too hot water repeatedly. Avoid overloading and resort your load. Do not mix heavy clothes such as work clothes with light clothes such as blouses, light shirts and delicate items. You may need to wash in warm or cold water.
- Have soap residue: detergent may not be dissolving in water. Check water temperature or you need to add detergent as wash tub is being filled with water before you load your clothes to avoid soap residue on clothes.
- Spots or stains on your clothes: this is due to incorrect use of fabric softener. You may need to read proper instructions on the container and follow proper directions for using the softener.
- Clothes are grayed or yellowed: this is due to not pouring enough detergent for large loads. you may have to add more detergent to the load.
- Clothes are ripped and have holes/excessive wear and tear: this is due to sharp objects such as pins and belt buckles left in pockets. You will need to remove small loose sharp objects. Fasten belts, zippers, metal snaps etc. Check if you are using undiluted bleach. never add undiluted bleach to wash.

Notes:

<u>Trouble Codes</u>	<u>Reason</u>
E0	Top lid not closed during delay start sequence
E1	Blockage of drain hose.
E2	Top lid not closed during wash operation
E3	The washer is out of balance
E4	Water inlet valve closed The water pressure is too low
E5	The water level sensor fault - Call service
E7	The communication fault - Call service

INSTALLATION INSTRUCTIONS

Tools and Materials Required

You will need to have following tools to help you in the installation of your washer:

- Pliers
- Wrench
- Tape Measure
- Gloves
- Level

Accessories Supplied	Quantity
1. Hot & Cold water inlets	2
2. Drain Hose Hook	1
3. Drain Hose Clamp	1
4. Outer Drain Hose	1

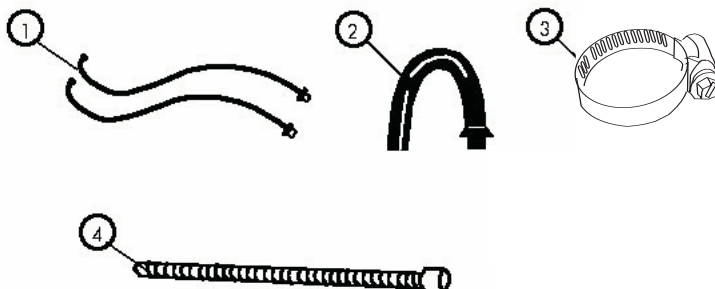

Unpacking Your Washer

- Remove all packing materials. This includes the foam base and all adhesive tape holding the washer accessories inside and outside.
- Open the top lid to remove the styrofoam drum brace. Pull to remove.
Note: Save drum brace. Reinstall when moving the washer.
- Inspect and remove any remains of packing, tape or printed materials before using the washer.

Leveling Your Washer

- Your washer has 4 leveling legs; which are located on the four bottom corners. After properly placing your washer in its final position, you can level your washer.
- Leveling legs can be adjusted by turning them counterclockwise to raise your washer or turning them clockwise to lower your washer.

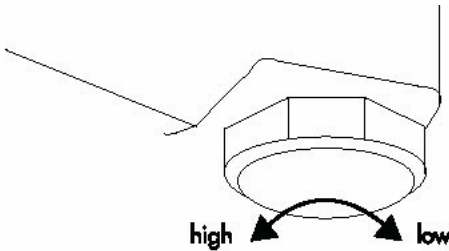

Warning: Leveling of washer is very important to prevent vibration during spin.

Steps for Installation

- Select a suitable location for the washer on a hard even surface away from direct sunlight or heat source e.g. radiators, baseboard heaters, cooking appliances etc. Any floor unevenness should be corrected with the leveling legs located on the bottom corners of the washer. The washer must be placed at room temperature. You must not place washer where the temperature is at below freezing.

Installing Your Washer

Read installation instructions carefully before installation.

Caution: If, after completing these steps, you are unsure that unit is properly installed, contact a qualified installer. To ensure that your washer is properly installed it is recommended that it be installed by a certified installer.

1. Insert a new flat washer into each end of the water inlet hoses. Firmly put the washer in the coupling.

Note: You may have to use pliers to tighten the coupling.

Do not over tighten because you may cause damage to the valve.

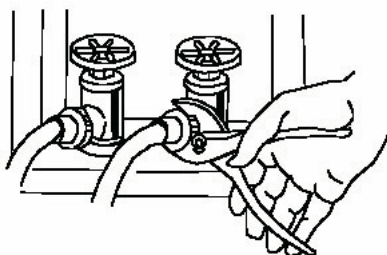

2. Connect the hot and cold water inlet hoses to the hot and cold water faucet.

3. Connect the other end to their respective washer inlet located at the rear of the washer.

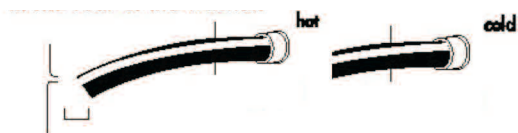

Note: Hot water needs to be at a temperature of at least 120°F - 140°F. (49°C - 60°C) for the soap to dissolve and to avoid soap residue remaining on clothes.

4. Using the drain hose clamp, attach the drain hose to the unit as shown below. Install the drain hose hook to the outer drain hose tube.

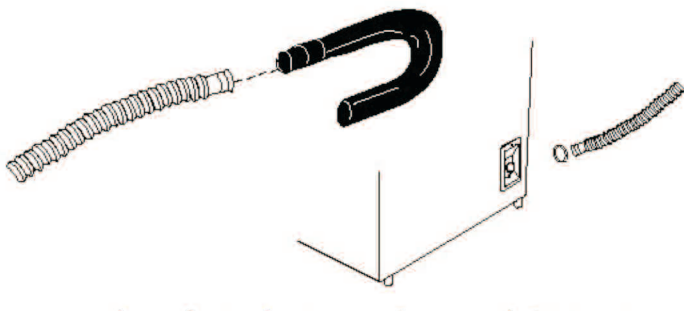

5. Plug in the washer to a regular 115 volt / 60 Hz, 15 amp outlet.

ELECTRICAL CONNECTIONS

Grounding Instructions

This appliance must be grounded. In the event of an electrical short circuit, grounding reduces the risk of electric shock by providing an escape wire for the electrical current. This appliance is equipped with a cord having a grounding wire with a grounded plug. The plug must be inserted into an outlet that is properly installed and grounded.



- Improper use of the plug can result in a risk of electric shock.
- Consult a qualified electrician or service person if the grounding instructions are not completely understood or if in doubt as to whether the appliance is properly grounded.

Wiring Requirements

- This appliance must be plugged into at least a 15 AMP 110-115 VOLT, 60 HZ GROUNDED OUTLET.

Note: Where a standard two-prong outlet is encountered, it is the personal responsibility and obligation of the consumer to have it replaced with a properly grounded three-prong outlet.

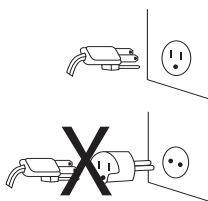

Extension Cords:

We do not recommend that you use an extension cord.

Power Interruptions

Occasionally, there may be power interruptions due to thunderstorms or other causes. Remove the power cord from the AC outlet when a power outage occurs. When power has been restored, re-plug the power cord to AC outlet. If the outage lasts for a prolonged period of time, clean the washer before using it again.

LIMITED WARRANTY

In Home Service

Full ONE Year Warranty

For 12 months from the date of original retail purchase, Haier will repair or replace any part free of charge including labor that fails due to a defect in materials or workmanship.

Limited Warranty

After one year from the original retail purchase date, Haier will provide a part at no cost, as indicated below, to replace said part as a result of a defect in materials or workmanship. Haier is solely responsible for the cost of the part. All other costs such as labor, trip charge, etc are the responsibility of the owner.

Second through Fifth Year

Haier will provide the outer washtub and related outer tub assembly parts should the part fail to hold water.

Second through Seventh Year

Haier will provide the inner stainless steel wash tub if defective in material or workmanship.

Note: This warranty commences on the date the item was purchased and the original purchase receipt must be presented to the authorized service representative before warranty repairs are rendered.

Exceptions: Commercial or Rental Use Warranty

90 days labor from date of original purchase

90 days parts from date of original purchase

No other warranty applies

For Warranty Service

Contact your nearest authorized service center. All service must be performed by a Haier authorized service center. For the name and telephone number of the nearest authorized service center please call 1-877-337-3639.

Before calling please have available the following information:

Model number and serial number of your appliance. The name and address of the dealer you purchased the unit from and the date of purchase.

A clear description of the problem.

A proof of purchase (sales receipt).

This warranty covers appliances within the continental United States, Puerto Rico and Canada. What is not covered by this warranty:

Replacement or repair of household fuses, circuit breakers, wiring or plumbing.

A product whose original serial number has been removed or altered.

Any service charges not specifically identified as normal such as normal service area or hours.

Damage to clothing.

Damage incurred in shipping.

Damage caused by improper installation or maintenance.

Damage from misuse, abuse accident, fire, flood, or acts of nature.

Damage from service other than an authorized Haier dealer or service center.

Damage from incorrect electrical current, voltage or supply.

Damage resulting from any product modification, alteration or adjustment not authorized by Haier.

Adjustment of consumer operated controls as identified in the owner's manual.

Hoses, knobs, lint trays and all attachments, accessories and disposable parts.

Labor, service transportation, and shipping charges for the removal and replacement of defective parts beyond the initial 12-month period.

Damage from other than normal household use.

Any transportation and shipping charges.

THIS LIMITED WARRANTY IS GIVEN IN LIEU OF ALL OTHER WARRANTIES, EXPRESSED OR, INCLUDING THE WARRANTIES OF MERCHANTABILITY AND FITNESS FOR A PARTICULAR PURPOSE

The remedy provided in this warranty is exclusive and is granted in lieu of all other remedies.

This warranty does not cover incidental or consequential damages, so the above limitations may not apply to you. Some states do not allow limitations on how long an implied warranty lasts, so the above limitations may not apply to you.

This warranty gives you specific legal rights, and you may have other rights, which vary, from state to state.

Haier America
New York, NY 10018

IMPORTANT

Do Not Return This Product To The Store

If you have a problem with this product, please contact the "Haier Customer Satisfaction Center" at 1-877-337-3639.

DATED PROOF OF PURCHASE REQUIRED FOR WARRANTY SERVICE

IMPORTANT

Ne pas Réexpédier ce Produit au Magasin

Pour tout problème concernant ce produit, veuillez contacter le service des consommateurs 'Haier Customer Satisfaction Center' au 1-877-337-3639.
UNE PREUVE D'ACHAT DATEE EST REQUISE POUR BENEFICIER DE LA GARANTIE.

IMPORTANTE

No regrese este producto a la tienda

Si tiene algún problema con este producto, por favor contacte el "Centro de Servicio al Consumidor de Haier" al 1-877-337-3639 (Válido solo en E.U.A).

NECESITA UNA PRUEBA DE COMPRA FECHADA PARA EL SERVICIO DE LA GARANTIA

Made in China
Fabriqué en Chine
Hecho en China

Haier

Haier America
New York, NY 10018

Printed in China

Free Manuals Download Website

<http://myh66.com>

<http://usermanuals.us>

<http://www.somanuals.com>

<http://www.4manuals.cc>

<http://www.manual-lib.com>

<http://www.404manual.com>

<http://www.luxmanual.com>

<http://aubethermostatmanual.com>

Golf course search by state

<http://golfingnear.com>

Email search by domain

<http://emailbydomain.com>

Auto manuals search

<http://auto.somanuals.com>

TV manuals search

<http://tv.somanuals.com>