

# AUTOMATIC DRUM WASHING MACHINE

## USER MANUAL

HW55-1010

HW55-1010ME



# Haier

03 - 09

8 - 15

16- 20

**TABLE OF CONTENTS****BEFORE USE**

>COMPONENTS .....	03
>PREPARATION .....	04
>SAFETY INSTRUCTIONS .....	05
>INSTALLATION .....	06

**USING THE APPLIANCE**

>CONTROL PANEL .....	08
>PROGRAM SELECTION .....	10
>CONSUMPTION AND TECHNICAL DATA ..	11
>WASHING METHODS .....	12
>SETUP .....	14

**MAINTENANCE**

>CLEANING & CARE .....	16
>DISPLAY CODES .....	18
>TROUBLESHOOTING .....	19

**LEGEND**

Yes



No



Optional



For your safety, any instructions in this manual with this "Warning" sign must be followed strictly.

**DISPOSAL**

The symbol on the product or on its packing indicates that this product may not be treated as household waste. Instead it shall be handed over to the applicable collection point for the recycling of electrical and electronic equipment. By ensuring this product is disposed of correctly, you will help prevent potential negative consequences for the environment and human health, which could otherwise be caused by inappropriate waste handling of this product. For more detailed information about recycling of this product, please contact your local city office, your household waste disposal service or the shop where you purchased the product.

**COMPONENTS**

Please read these instructions carefully before using this appliance. The instructions contain important information which will help you get the best out of the appliance and ensure safe and proper installation, use and maintenance.

Keep this manual in a convenient place so you can always refer to it for the safe and proper use of the appliance.

If you sell the appliance, give it away, or leave it behind when you move house, make sure you also pass on this manual so that the new owner can become familiar with the appliance and safety warnings.

**ACCESSORIES**

Check the accessories and literature

in accordance with this list:

1x Inlet hose assembly

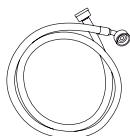

1x Bottom Cover



1x User manual



1x Drain hose bracket

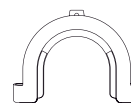

3x Blanking plugs



# 04

# BEFORE USE

## PREPARATION

### PREPARING THE MACHINE

Remove all the packing materials to prevent unsteadiness, including the polystyrene base. Upon opening the package, water drops may be seen on the plastic bag and the porthole. This is normal phenomenon resulting from water tests in the factory.

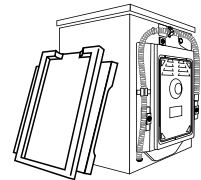

### DESCRIPTION

This diagram may be slightly different from the layout of the washing machine you have just purchased due to technical improvements.

Control panel

Door handle

Work top

Washer door

Detergent distribution drawer

Filter cover



Drain hose

Water inlet valve

Power cord

Back cover

Back cover screws

Transportation bolts

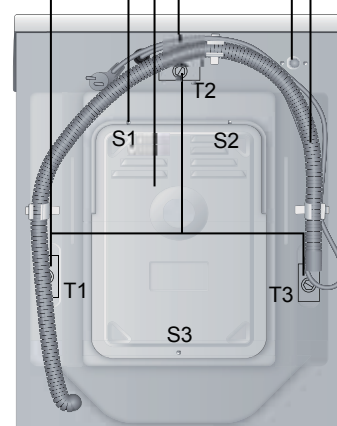



## SAFETY INSTRUCTIONS

### **BEFORE SWITCHING THE APPLIANCE ON FOR THE FIRST TIME**

- DO ...
- ... Make sure that the transport bolt are removed.
  - ... Use a separate earthed socket for the power supply.
  - ... Make sure that the plug is accessible.
  - ... Hold the plug and not the electric cable when unplugging the power supply.
  - ... Make sure that the fuses in the power circuit are rated for 15A.
  - ... Keep away from heat sources and direct sun light to prevent plastic and rubber components from aging.
  - ... Make sure that the power cord is not caught under or in the appliance and avoid damage to the power cable.
  - ... Check that hose joints and connections are firm and no water can leak. If joints are loose or there is leakage, turn off the water supply and refix. Do not use the washing machine until the hoses are properly fixed.

### **DURING DAILY USE OF THE APPLIANCE**

- DO ...
- ... Pull up zips and fix loose threads to prevent the items from being entangled. If necessary, put small items into a net bag or pillow.
  - ... Turn off the machine after each wash program and switch it off at the mains to save electricity and for safety. Wipe clean the lower part of the porthole.
  - ... Keep the door slightly open when the washing machine is not in use to prevent formation of odours.
  - ... Let the power cord be replaced by the manufacturer, his service agent or other accordingly qualified persons, in case it is damaged.
  - ... Ensure that the appliance is not used by persons with reduced physical, sensory or mental capabilities, lack of experience and knowledge without supervision or instruction by a person responsible for their safety.
  - ... Supervise children to ensure that they do not play with the appliance.

- DO NOT ...
- ... Touch or use the appliance when barefoot or with wet or damp hands or feet.
  - ... Use flammable detergent or dry cleaning agent.
  - ... Use any flammable sprays in close vicinity to the appliance.
  - ... Remove or insert the plug in the presence of flammable gas.
  - ... Allow children or infirm persons to play with the appliance or packing materials.
  - ... Install the appliance outdoors in a damp place, or in an area which may be prone to water leaks such as under or near a sink unit. In the event of a water leak allow the machine to dry naturally.
  - ... Place the washing machine directly on a carpet, or close to a wall or furniture.

- DO NOT ...
- ... Touch the washer door during the washing process - it gets hot!
  - ... Place heavy objects or sources of heat or damp on top of the appliance.
  - ... Hot wash foam rubber or sponge-like materials.
  - ... Open the detergent distribution drawer during the wash cycle.
  - ... Force the washer door open. The door is fitted with a self-lock device and will open shortly after the washing procedure is ended.
  - ... Open the washer door if the water level is visibly over the porthole.
  - ... Cover the washing machine with plastic cover so that inside dampness cannot be kept in.

**INSTALLATION****ADJUSTING THE BOTTOM COVER**

When open the carton package, you will find a metalline board which is laid on the top of the washing machine as shown fig.1, the board used for reducing noise and rat proof by install it under the cabinet when setting as shown in fig.2.

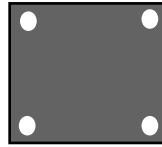

Fig.1

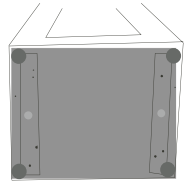

Fig.2

**DISMANTLE THE TRANSPORTATION BOLTS**

The transportation bolts are designed for clamping anti-vibration components inside of the washing machine during the transportation process.

1. Remove the back cover.
2. Remove the three bolts on the rear side and take out the synthetic stabilisers from within the machine.
3. Replace the back cover.
4. Fill the holes left by the bolts with blanking plugs.

**Note:**

**1. Before removing the back panel for any reason. Isolate the electric power from the washing machine by switching of the supply and removing the plug.**

**2. When you replace the back cover, the convexity must face to outside, and you have to insert the back cover from the two gaps as shown in fig.3.**

**3. Keep the transportation bolts and synthetic stabilisers in a safe place for later use.**

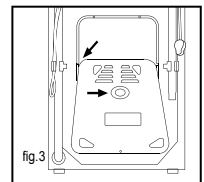
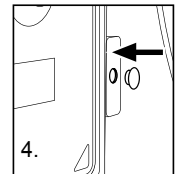
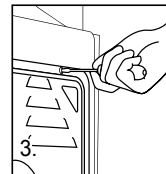
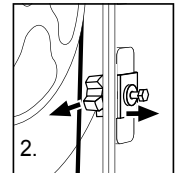
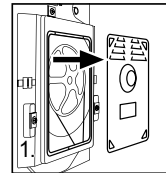
**ADJUSTING THE WASHING MACHINE**

There are adjustable feet under the bottom of the washing machine. Before use, they should be adjusted so that the machine is level. This will minimise vibrations and thus noise during use. It will also reduce wear and tear. We recommend using a spirit level to level the appliance. The floor should be as stable and flat as possible.

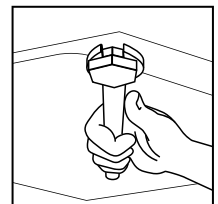

### INLET HOSE

1. Connect the nut on the inlet hose to the connector on the water valve.
2. Apply inlet hose to a water tap with cold, fresh water.

**Note: Use the hose-set supplied with the appliance. Old hose-sets should not be reused.**

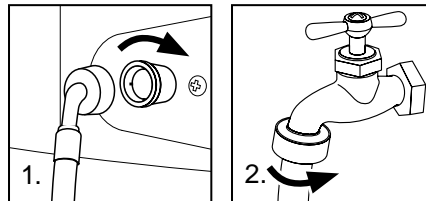

### DRAIN HOSE

1. Use the drain hose bracket to keep the end of the drain hose retained and prevent the outflow of water. Don't extend the length of the drain hose; if an extended hose is required, please consult a serviceman.
2. The height of the drainage outlet must be 80-100 cm. Fix the drain hose to the clip at the back of the washing machine to prevent it from dropping off.

**Note: The drain hose should not be submerged in water and should be securely fixed and leak-free. If the drain hose is placed on the ground or if the pipe is at a height of less than 80cm, the washing machine will continuously drain while being filled (self-siphoning).**

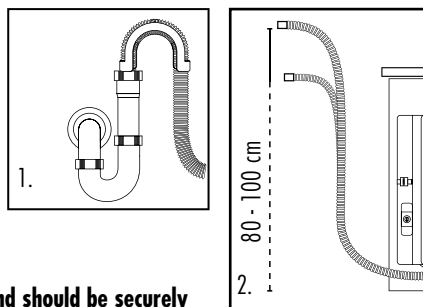

### CONNECTING TO THE POWER SUPPLY

Before connecting to the power supply, check:

- The socket is adequate for the maximum power of the washing machine (For safety, fuses in the power circuit should be rated for no less than 15A).
- The voltage should meet the requirement.
- The power outlet should be capable of accepting the washing machine plug.
- Connect the machine to an earthed socket outlet.

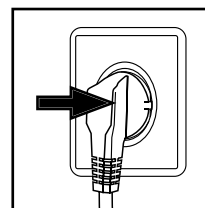

## CONTROL PANEL

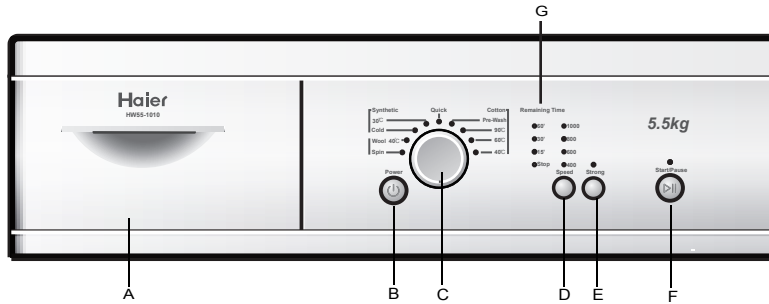

- |          |                               |          |                               |
|----------|-------------------------------|----------|-------------------------------|
| <b>A</b> | Detergent distribution drawer | <b>D</b> | Spinning Speed Setting Button |
| <b>B</b> | Power Button                  | <b>E</b> | Strong button                 |
| <b>C</b> | Program knob                  | <b>F</b> | Start/Pause Button            |
| <b>G</b> | Remianing Time                |          |                               |

**OPERATIONAL FUNCTIONS**

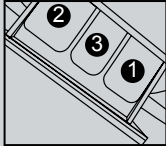
A	→Detergent distribution drawer	<p>— The drawer contains three compartments:</p> <p>1: Prewash detergent 2: Main wash detergent 3 :Fabric softener</p> 
B	→ Power Button	<p>— Press this button to switch on the washing machine. Press and hold 2s to switch it off.</p>
C	→ Program knob	<p>— By turning the knob clockwise/counter-clockwise, the required program can be selected. There are 9 programs available. After a program is selected, the corresponding light will go on.</p>



D → Spinning Speed Setting Button    \_ Touch this button lightly to select the desired speed. When a speed is set, the indicator light will be light on

E → Strong button    \_ Touch this button lightly, the indicator light will be light on . you can increase the washing time, rinsing times in main wash stage of the selected program, which is suitable for dirty clothes.

F →Start/Pause Button    When the washing machine is connected to the power socket and a program is selected, lightly touch this button to start operation. During a wash cycle, touch it lightly ,operation will stop and the indicator light start blinking.Touch it again to resume operation. To cancel a wash program during a wash cycle, touch his button, when the indicator light start blinking, press the Power switch, the program will be cancelled.

G → Remianing Time    The column of 'Time to end' indicator lights shows the approximate time remaining before the wash program ends.  
 If all the lights are off, there is more than 60 minutes before the program ends.  
 When the 60' light is on, there is between 60 and 30 minutes to the end of the program.  
 When the 30' light is on, it is between 30 and 15 minutes to the end of the program.  
 When the 15' light is on, it is less than 15 minutes remaining to the end of the program.  
 The Stop light will illuminate at the end of the wash program.  
 Note        If all 4 'Time to end' lights flash during a wash program, please refer to the 'To much foam' explanation.

# 10

# USING THE APPLIANCE

## PROGRAM SELECTION

### PROGRAM MODES

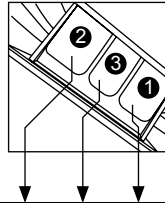

- 1 Detergent compartment for prewash mode
- 2 Detergent compartment
- 3 Compartment for softener and other additives

Program			Temperature	2	3	1	Recommended Laundry	Preset spin speed
1	Cotton	- Prewash	60°C	<input checked="" type="checkbox"/>	<input type="checkbox"/>	<input checked="" type="checkbox"/>	Very heavy soiling	1000 rpm
2		- 90°C	90°C	<input checked="" type="checkbox"/>	<input type="checkbox"/>	<input checked="" type="checkbox"/>	Heavy soiling	1000 rpm
3		- 60°C	60°C	<input checked="" type="checkbox"/>	<input type="checkbox"/>	<input checked="" type="checkbox"/>	Soiled cotton	1000 rpm
4		- 40°C	40°C	<input checked="" type="checkbox"/>	<input type="checkbox"/>	<input checked="" type="checkbox"/>	Non-fade and medium soiled	1000 rpm
5		- Quick	40°C	<input checked="" type="checkbox"/>	<input type="checkbox"/>	<input checked="" type="checkbox"/>	Medium soiled laundry	1000 rpm
6	Synthetic	- 30°C	30°C	<input checked="" type="checkbox"/>	<input type="checkbox"/>	<input checked="" type="checkbox"/>	Non-fade heavily soiled synthetic fibre	1000 rpm
7		- Cold	/	<input checked="" type="checkbox"/>	<input type="checkbox"/>	<input checked="" type="checkbox"/>	Fade and medium soiled synthetic fibre	1000 rpm
8		- Wool 40°C	40°C	<input checked="" type="checkbox"/>	<input type="checkbox"/>	<input checked="" type="checkbox"/>	Fade and medium soiled synthetic fibre	600 rpm
9		- Spin	/	<input checked="" type="checkbox"/>	<input checked="" type="checkbox"/>	<input checked="" type="checkbox"/>	/	1000 rpm

Yes     No     Optional

## CONSUMPTION AND TECHNICAL DATA

### CONSUMPTION TABLE

The wash cycle times are intended as a guide only. The actual time used may vary due to different water pressure, initial water temperature, etc.

PROGRAM		Max. LOAD	ENERGY CONSUMPTION	WATER CONSUMPTION	TEMPERATURE	WASHING TIME
Cotton	→ Prewash	5.5 kg	1.16 kWh	52L	60°	around 2:16 h
	→ 90°C	5.5 kg	1.56 kWh	46L	90°C	around 2:08 h
	→ 60°C <sup>*)</sup>	5.5 kg	0.95 kWh	49L	60°C	around 2:59 h
	→ 60°C	5.5 kg	1.14 kWh	45L	60°C	around 1:59 h
	→ 40°C	5.5 kg	0.43 kWh	45L	40°C	around 1:47 h
	→ Quick	2.5 kg	0.31 kWh	30L	40°C	around 0:29 h
Synthetic	→ 30°C	3 kg	0.34 kWh	32L	30°C	around 1:10 h
	→ Cold	3 kg	0.10 kWh	32L	/	around 1:00 h
	→ Wool 40°C	2kg	0.41 kWh	31L	40°C	around 0:50 h

<sup>\*)</sup> EN 60456 test program / Energy label program with Cotton 60°C ,max. spin speed and intense function.

### TECHNICAL DATA

	HW55-1010	HW55-1010ME
Power source	220 - 240V~/50Hz	220 - 240V~/50Hz
Max. working current (A)	10	10
Water pressure (MPa)	0.03≤P ≤1	0.03≤P ≤1
Nominal load (kg)	5.5	5.5
Spinning speed (r/min)	1000	1000
Washing programs	9	9
Max power (W)	2000	2000
Dimensions (HxDxW mm)	850 x 520 x 595	850 x 520 x 595
Net weight (kg)	65	65

**WASHING METHODS**

This washing machine is for domestic use only. If the machine is used for commercial purposes the guarantee will not be valid anymore. Do not use it for purposes other than that for which it was designed. Follow the instructions given on the label of each garment and wash only machine-washable garments.

**POWER SUPPLY**

Connect the washing machine to the power supply (220V to 240V~/50Hz).

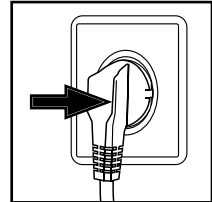
**WATER CONNECTION**

Turn on the tap. The water must be clean and clear.

**Note: Before use, check for leakage in the joints between the tap and the inlet hose by turning on the tap.**

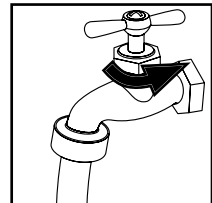
**PREPARING THE LAUNDRY**

- Sort out clothes according to fabric (cotton, synthetics, wool or silk) and to how dirty they are.
- Separate white clothes from coloured ones. Wash them first by hand to check if they fade or run.
- Empty pockets (keys, coins, etc.) and remove the harder decorative objects (e.g. brooches).

**Attention: Small parts (like buttons, etc) may lead to repair work which user has to pay by themselves and can cause damage in the machine.**

- Garments without hems, underwear, finely woven textile such as fine curtains are to be put into wash bag (it is better not to wash them in a washing machine).
- Close zippers and hooks, make sure the buttons are sewn on tightly and place small items such as socks, belts, bras, etc. in the wash bag.
- Unfold large pieces of fabric such as bed sheets, bedspreads, etc.
- Turn shirts inside out.

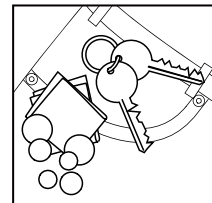
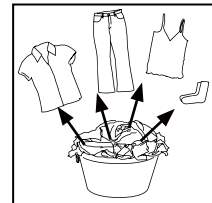

## LOADING THE MACHINE

Open the washer door, put in the laundry piece by piece. Close the door tightly.

- When first using the washing machine, let it run unloaded for one program to prevent the laundry from being tainted by oil or dirty water from the washing machine. Before washing you should run the machine without laundry, but with detergent, with 60°C program.
- Do not overload the washing machine.

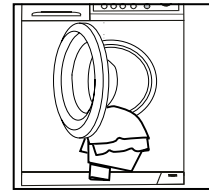

## SELECTING DETERGENT

The washing efficiency and the performance is determined by the quality of detergent used. Special non-foaming detergent produces good washing results. Use specific detergents for synthetic and woollen goods. Do not use dry cleaning agents such as trichloroethylene and similar products.

**Note: Do not add more detergent than needed. Please follow the dosage recommendation on the detergent package.**

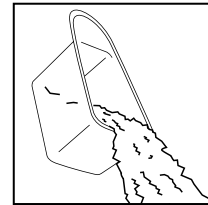

## ADDING DETERGENT

Slide out the detergent drawer and put the required detergent and softening agent into the corresponding compartments. Push back the drawer gently. (Refer to the instructions on the drawer)

### **Caution:**

- For prewashing program, detergent should be added to both compartments 1 and 2. For other programs, do not add detergent to compartment 1.
- Use liquid detergent according to the instructions on its package. Do not use liquid detergent if the prewash mode .
- Do not overuse softener; otherwise, it will damage the artificial fibers.

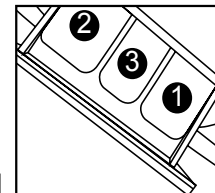

## SELECTING PROGRAM

To get the best washing results, an appropriate washing program should be selected according to the laundry type. Please turn the program knob to select the right program.

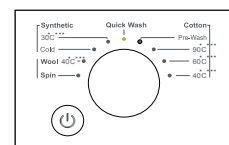

## SELECTING FUNCTIONAL

Select the required options. (Refer to the "Control panel" pages 08 and 09)

**SETTING SPIN SPEED**

Touch this button lightly to select the desired speed. When a speed is set, the indicator light will be light on.

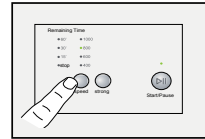
**STRONG BUTTON**

Touch this button lightly, the indicator light will be light on. you can increase the washing time, rinsing times in main wash stage of the selected program, which is suitable for dirty clothes

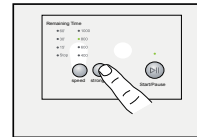
**START WASHING**

When the washing machine is connected to the power socket and a program is selected, lightly touch this button to start operation. During a wash cycle, touch it lightly, operation will stop and the indicator light start blinking. Touch it again to resume operation. To cancel a wash program during a wash cycle, touch this button, when the indicator light start blinking, press the Power switch, the program will be cancelled.

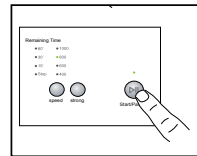



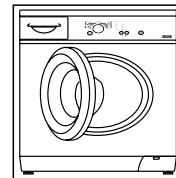



















**AFTER WASHING**

Turn off the water supply and unplug the power cord. Open the washer door to prevent formation of moisture and odours. Let the door open while not used.

**TIPS FOR SAVING ENERGY**

1. Collect clothes for one full wash load.
2. Avoid overloading the washing machine.
3. Prewash only heavily soiled clothes.
4. Reduce the amount of detergent or choose standard or delicate wash programs for slightly soiled clothes.
5. Choose a proper washing temperature. Modern detergents can wash with very good result already in lower temperature than 60°C. Only use higher temperature than 60°C for heavily soiled laundry.
6. Follow the dosage recommendation on the detergent package to avoid using too much detergent.
7. **After entire washing cycle finish, all indicate lights go out**

## CARE CHART

	Resistant material		Bleachable in cold water		Don't dry clean
	Delicate fabric		Do not bleach		Dry flat
	Washable at 95 °C		Iron at 200 °C		Hung to dry
	Washable at 60 °C		Iron at 150 °C		Dry on clothes hanger
	Washable at 40 °C		Iron at 100 °C		Tumble dry, normal heat
	Washable at 30 °C		Don't iron		Tumble dry, reduced heat
	Hand wash		Dry cleaning with any solvent		Don't tumble dry
	Dry clean only		Dry cleaning with pericloride		
	Wool Seal		Dry cleaning with aviation fuel		

## LOAD REFERENCE

Bed sheet (single)	Cotton	Approximately 800g
Blanket	Wool	Approximately 3000g
Blended fabric clothes	/	Approximately 800g
Jackets	Cotton	Approximately 800g
Jeans	/	Approximately 800g
Overalls	Cotton	Approximately 950g
Ladies Pyjamas	/	Approximately 200g
Shirts	/	Approximately 300g
Socks	Blended fabrics	Approximately 50g
T-Shirts	Cotton	Approximately 300g
Underwear	Blended fabrics	Approximately 70g

**CLEANING & CARE****AFTER WASHING**

Turn off the water supply and pull out electricity plug after each wash. Open the washer door to prevent formation of moisture and odours. If the washing machine is left idle for a long period, drain the water in the machine and replace the drain hose.

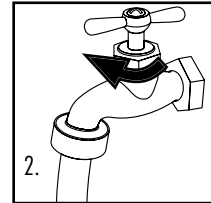
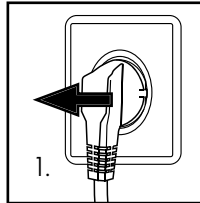
**CLEANING THE DETERGENT DRAWER**

Clean the detergent distribution drawer regularly.

Swing out the drawer, flush it clean with water and then replace it.

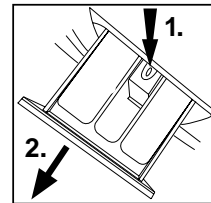
**CLEANING THE MACHINE**

Unplug the machine during cleaning and maintenance. Use a soft cloth dampened with soap liquid to clean the machine case and rubber components. Do not use organic chemicals or corrosive solvents.

**CLEANING THE FILTER**

Clean the filter once a month:

1. Open the bottom cover.
2. Remove the filter by turning counterclockwise.
3. Flush the filter clean with running water.
4. Replace the filter by turning clockwise and remount the cover.

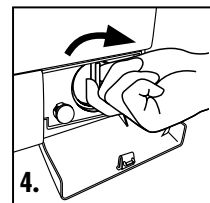
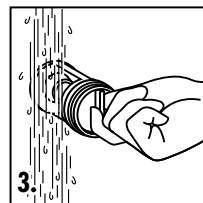
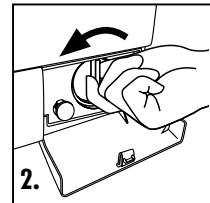
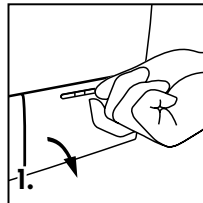
**Caution:**

**1. The filter must be in place, or it may lead to leakage.**

**2. Place a container under the drain pump filter, to collect any excess water that may come out of the drain pump when the filter is removed.**



## **WATER INLET VALVE AND INLET VALVE FILTER**

To prevent blockage to the water supply by ingress of foreign substances, clean the water inlet valve and inlet valve filter regularly.

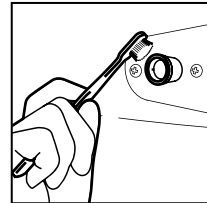

## **MOVING THE MACHINE**

If the machine is to be moved to a distant location, replace the transportation bolts removed before installation to prevent damage as shown below.

1. Remove the blanking plugs.
2. Remove the back cover
3. Insert the synthetic stabilisers and the transportation bolts.
4. Tighten the bolts with a spanner.
5. Replace the back cover.

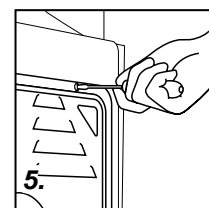
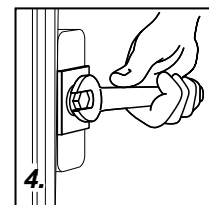
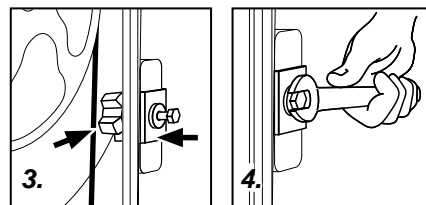
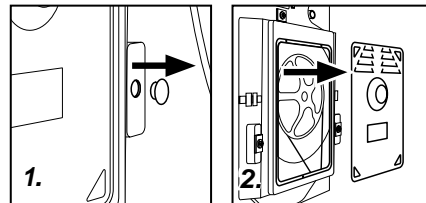

## **LONG PERIODS OF DISUSE**

If the washing machine is left idle for a long period, pull out the electrical plug and turn off the water supply. Open the washer door to prevent formation of moisture and odours. Let the door open while not used.

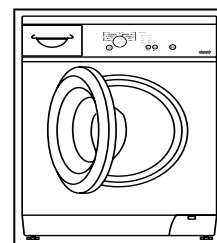

**DISPLAY CODES****DISPLAY CODES AND SPECIAL FUNCTIONS**

ERROR MESSAGE	CAUSES	SOLUTIONS
Err1:The start/pause lamp off and the buzzer beeping	→ Door is not properly shut.	_ Shut the door properly.
Err2:The start/pause lamp twinkles twice in 4 seconds.	→ Drainage error, water not emptied within 4 minutes.	_ Clean the filter and check the drain hose for blockage. If error still exists, please contact the maintenance personnel.
Err3:The start/pause lamp twinkles 3 times in 4 seconds .	→ Temperature sensor not properly connected or damaged.	_ Contact the maintenance personnel.
Err4:The start/pause lamp twinkles 4 times in 4 seconds .	→ Heater error (Appears at the end of a cycle).	_ Reduce load and then start washing again. If problem still exists, please contact the maintenance personnel.
Err5:The start/pause lamp twinkles 5 times in 4 seconds .	→ The drain hose is in water.	_ Make sure the drain hose is not in water.
Err7:The start/pause lamp twinkles 7 times in 4 seconds .	→ Motor overheat protection or damage.	_ Contact the maintenance personnel.
Err8:The start/pause lamp twinkles 8 times in 4 seconds .	→ Water exceeds protective level.	_ Contact the maintenance personnel.

→ Foam test function: If the washing machine find much foam,the LED lamp of "time to end" will twinkle completely for 15 mins,then the washing machine will go on washing. of course, you can touch "Start/pause" to cancel this function.But you had better to hold this function for protecting motor.

→ Power-off memory function: In case of abrupt power failure or the need to cut off the power during a program cycle, the present settings will be saved and the preset operation will resume when the power is on again.

→ To cancel a program

Press the "Start/Pause" button, then switch off the power and the program is automatically cancelled. Turn the program selector again to choose another program.

## TROUBLESHOOTING

### TROUBLESHOOTING

The following circumstances do not constitute problems. Do not contact the Service Center until the problem has been confirmed.

PROBLEM	CAUSES	SOLUTIONS
Washing machine fails to operate.	<ul style="list-style-type: none"> <li>→ Poor connection to the power supply.</li> <li>→ Power failure.</li> <li>→ The washer door is not properly closed.</li> <li>→ Machine has not been switched on.</li> </ul>	<ul style="list-style-type: none"> <li>_ Check connection to the power supply.</li> <li>_ Check the power supply.</li> <li>_ Close the washer door properly.</li> <li>_ Make sure the machine is switched on.</li> </ul>
Washing machine cannot be filled with water.	<ul style="list-style-type: none"> <li>→ The "Start/Pause" button is not pressed.</li> <li>→ Water tap is not turned on.</li> <li>→ Water pressure is less than 0,03 MPa.</li> <li>→ The inlet hose is kinked.</li> <li>→ Water supply failure.</li> <li>→ The program knob is not properly set.</li> <li>→ The washer door is not properly closed.</li> <li>→ The inlet hose filter is blocked.</li> </ul>	<ul style="list-style-type: none"> <li>_ press the "Start/Pause" button.</li> <li>_ Turn on the water tap.</li> <li>_ Check water pressure.</li> <li>_ Check the inlet hose.</li> <li>_ Ensure the water supply.</li> <li>_ Set the program knob properly.</li> <li>_ Close the washer door properly.</li> <li>_ Unblock the inlet hose filter.</li> </ul>
Machine is draining while being filled.	<ul style="list-style-type: none"> <li>→ The height of the drain hose is below 80 cm.</li> <li>→ The drain hose is in water.</li> </ul>	<ul style="list-style-type: none"> <li>_ Install drain hose within 80-100 cm of height.</li> <li>_ Make sure the drain hose is not in water.</li> </ul>
Drainage failure.	<ul style="list-style-type: none"> <li>→ Drain hose is blocked.</li> <li>→ Drain hose end is higher than 100 cm above the floor level.</li> <li>→ The filter is blocked.</li> </ul>	<ul style="list-style-type: none"> <li>_ Unblock the drain hose.</li> <li>_ Make sure the drain hose end is lower than 100 cm above floor level.</li> <li>_ Unblock the filter.</li> </ul>
Strong vibration while spinning.	<ul style="list-style-type: none"> <li>→ Not all transportation bolts have been removed.</li> <li>→ Washing machine is located on an uneven surface or is not level.</li> <li>→ Machine load is over 5 kg.</li> </ul>	<ul style="list-style-type: none"> <li>_ Remove all transportation bolts.</li> <li>_ Make sure the washing machine is on an even surface and levelled.</li> <li>_ Reduce amount of laundry in the drum.</li> </ul>
Operation stops before completing wash cycle.	<ul style="list-style-type: none"> <li>→ Water or electricity failure.</li> </ul>	<ul style="list-style-type: none"> <li>_ Check the power supply.</li> </ul>
Operation stops for a period of time.	<ul style="list-style-type: none"> <li>→ Washing machine gives an error message.</li> </ul>	<ul style="list-style-type: none"> <li>_ Check display codes.</li> </ul>
Excessive foam in the drum, which is spilled to the distribution drawer.	<ul style="list-style-type: none"> <li>→ The detergent is not a low-foaming type or for manual wash.</li> <li>→ Excessive use of detergent.</li> </ul>	<ul style="list-style-type: none"> <li>_ Check if your detergent is appropriate.</li> <li>_ Reduce amount of detergent in the distribution drawer.</li> </ul>
Automatic adjustment of the washing time.	<ul style="list-style-type: none"> <li>→ The washing program duration will be adjusted according to the initial water temperature.</li> </ul>	<ul style="list-style-type: none"> <li>_ This is normal and doesn't affect the functionality.</li> </ul>



## Free Manuals Download Website

<http://myh66.com>

<http://usermanuals.us>

<http://www.somanuals.com>

<http://www.4manuals.cc>

<http://www.manual-lib.com>

<http://www.404manual.com>

<http://www.luxmanual.com>

<http://aubethermostatmanual.com>

Golf course search by state

<http://golfingnear.com>

Email search by domain

<http://emailbydomain.com>

Auto manuals search

<http://auto.somanuals.com>

TV manuals search

<http://tv.somanuals.com>