

AUTOMATIC DRUM WASHING MACHINE

USER MANUAL

HW80-B1486

HW80-B1286

HW70-B1486

HW60-B1286



Haier

TABLE OF CONTENTS

BEFORE USE

>COMPONENTS	03
>PREPARATION	04
>SAFETY INSTRUCTIONS	05
>INSTALLATION	06
>CONTROL PANEL	08

USING THE APPLIANCE

>PROGRAM SELECTION	12
>CONSUMPTION AND TECHNICAL DATA ..	14
>WASHING METHODS	15
>CLEANING & CARE	19

MAINTENANCE

>DISPLAY CODES	21
>TROUBLESHOOTING	22

LEGEND



Yes



No



Optional



For your safety, any instructions in this manual with this "Warning" sign must be followed strictly.

DISPOSAL

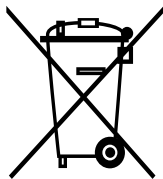

As a responsible manufacturer we care about the environment. As such we urge you to follow the correct disposal procedure for your product and packaging materials.

This will help conserve natural resources and ensure that it is recycled in a manner that protects health and the environment.

You must dispose of this product and its packaging according to local laws and regulations. Because this product contains electronic components, the product and its accessories must be disposed of separately from household waste when the product reaches its end of life.

Contact your local authority to learn about disposal and recycling. The product and packaging should be taken to your local collection point for recycling. Some collection points accept products free of charge.

We apologize for any inconvenience caused by minor inconsistencies in these instructions, which may occur as a result of product improvement and development.

COMPONENTS

THANKS FOR PURCHASING A HAIER PRODUCT

Please read these instructions carefully before using this appliance. The instructions contain important information which will help you get the best out of the appliance and ensure safe and proper installation, use and maintenance.

Keep this manual in a convenient place so you can always refer to it for the safe and proper use of the appliance.

If you sell the appliance, give it away, or leave it behind when you move house, make sure you also pass on this manual so that the new owner can become familiar with the appliance and safety warnings.

ACCESSORIES

Check the accessories and literature

in accordance with this list:

1x Inlet hose assembly

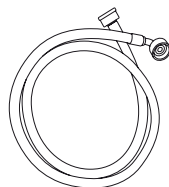

1x Bottom Cover



1x User manual



1x Drain hose bracket

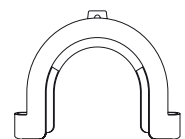

4x Blanking plugs

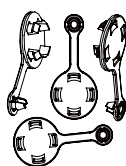

PREPARATION**PREPARING THE MACHINE**

Remove all the packing materials to prevent unsteadiness, including the polystyrene base. Upon opening the package, water drops may be seen on the plastic bag and the porthole. This is normal phenomenon resulting from water tests in the factory.

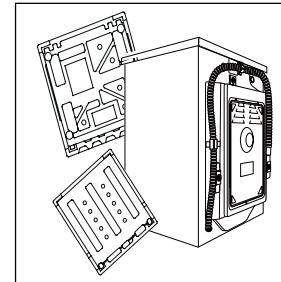
**DESCRIPTION**

This diagram may be slightly different from the layout of the washing machine you have just purchased due to technical improvements.

Control panel

Power

Work top

Door handle

Washer door

Detergent distribution drawer

Filter cover



Drain hose

Water inlet valve

Power cord

Back cover screws

Back cover

Transportation bolts

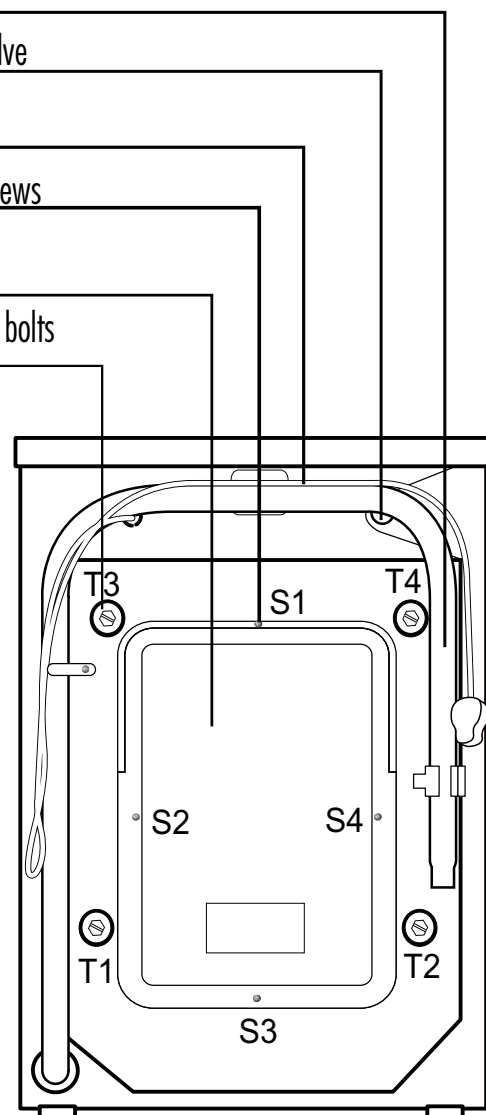



SAFETY INSTRUCTIONS

BEFORE SWITCHING THE APPLIANCE ON FOR THE FIRST TIME

DO ...

- ... Make sure that the transport bolts are removed before use.
- ... Make sure that all packing materials have been removed.
- ... Make sure that the fuses in the power circuit are rated for 13A.
- ... Use a separate earthed socket for the power supply.
- ... Make sure that the plug is accessible.
- ... Hold the plug and not the electric cable when plugging in, unplugging the power supply.
- ... Keep away from heat sources and direct sun light to prevent plastic and rubber components from aging.
- ... Make sure that the power cable is not caught or trapped under, or in the machine to avoid damage to the power cable.
- ... Check that hose joins and connections are secure and there are no water leaks. If joints are loose or there is a leak, turn off the water supply and tighten or remake the connections to stop the leak. Do not use the washing machine until the hoses are properly secured and free of any water leaks.
- ... Check the water inlet or drain hoses are not folded trapped or kinked.

DURING DAILY USE OF THE APPLIANCE

DO ...

- ... Pull up zips and fix loose threads to prevent the items from being entangled. If necessary, put small items into a net bag or pillow.
- ... Check there are no coins, hair clips in the laundry and empty all pockets.
- ... Turn off the washing machine after each wash program, and switch it off at the mains to save electricity and for safety. Wipe clean the lower part of the porthole.
- ... Keep the door slightly open when the washing machine is not in use to prevent formation of odours.
- ... Ensure the power cable is replaced by the manufacturer, his service agent or other qualified persons, if it is damaged.
- ... Ensure that the washing machine is not used by persons with reduced physical, sensory or mental capabilities, lack of experience and knowledge without supervision or instruction by a person responsible for their safety.
- ... Supervise children to ensure that they do not play with the washing machine.

DO NOT ...

- ... Touch or use the washing machine when barefoot or with wet or damp hands or feet.
- ... Use flammable detergent or dry cleaning agents.
- ... Use any flammable sprays in close vicinity to the washing machine.
- ... Remove or insert the plug in the presence of flammable gas.
- ... Allow children or infirm persons to play with the appliance or packing materials.
- ... Install the washing machine outdoors in a damp place, or in an area which may be prone to water leaks such as under or near a sink unit. In the event of a water leak allow the machine to dry naturally.
- ... Place the washing machine directly on a carpet, or close to a wall or furniture.

DO NOT ...

- ... Touch the washing machine door during the washing process – it can get hot!
- ... Place objects or sources of heat or damp on top of the appliance.
- ... Hot wash foam rubber or sponge-like materials.
- ... Open the soap detergent distribution drawer during the wash cycle.
- ... Force the washer door open during the wash cycle. The door is fitted with a self-locking device. The door will unlock and can be opened shortly after the wash program has ended.
- ... Open the washer door if the water level is visibly over the porthole.
- ... Cover the washing machine with plastic cover so that condensation inside the machine cannot escape.

INSTALLATION**ADJUSTING THE BOTTOM COVER**

Before removing the transportation bolts, please fix the bottom cover to the bottom of the washing machine. Lay down the machine (fig. 1.), screw off the feet and adjust the bottom cover with the four holes corresponding the screw holes of the feet. Then screw the feet back on through the cover and fix it thus securely to the bottom of the machine (fig. 2.).

It keeps out the dampness and reduces the noise.

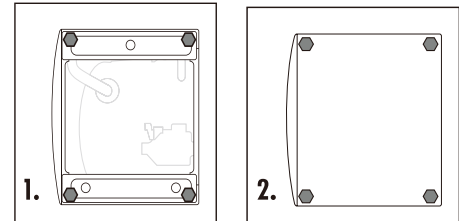
**DISMANTLE THE TRANSPORTATION BOLTS**

The transportation bolts are designed for clamping anti-vibration components inside of the washing machine during the transportation process.

1. Remove the back cover.
2. Remove the four bolts on the rear side and take out the synthetic stabilisers from within the machine.
3. Replace the back cover.
4. Fill the holes left by the bolts with blanking plugs.

Note:

1. When you replace the back cover, the convex surface must face to outside, and you have to insert the back cover in the two slots as shown in fig. 5.

2. Keep the transportation bolts and synthetic stabilisers in a safe place for later use.

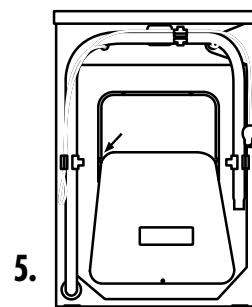
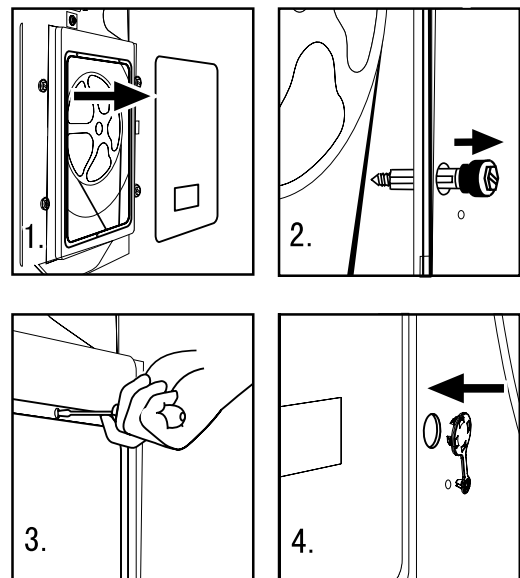
**ADJUSTING THE WASHING MACHINE**

There are adjustable feet under the bottom of the washing machine. Before use, they should be adjusted so that the machine is level. This will minimise vibrations and thus noise during use. It will also reduce wear and tear. We recommend using a spirit level to level the appliance. The floor should be as stable and flat as possible.

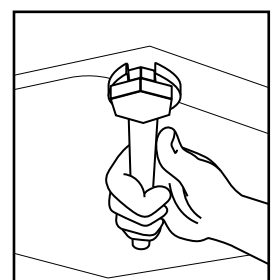

INLET HOSE

1. Connect the nut on the inlet hose to the connector on the water valve.
2. Apply inlet hose to a water tap with cold, fresh water.

Note: Use the hose-set supplied with the appliance. Old hose-sets should not be reused.

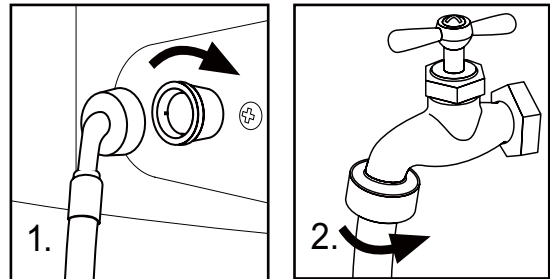

DRAIN HOSE

1. Use the drain hose bracket to keep the end of the drain hose retained and prevent the outflow of water. Don't extend the length of the drain hose; if an extended hose is required, please consult a serviceman.
2. The height of the drainage outlet must be 80-100 cm. Fix the drain hose to the clip at the back of the washing machine to prevent it from dropping off.

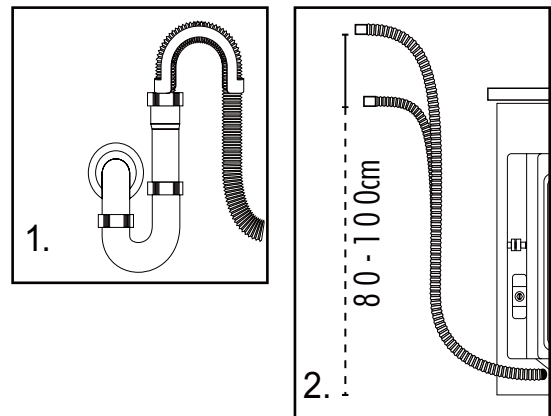

Note: The drain hose should not be submerged in water and should be securely fixed and leak-free. If the drain hose is placed on the ground or if the pipe is at a height of less than 80cm, the washing machine will continuously drain while being filled (self-siphoning).

CONNECTING TO THE POWER SUPPLY

Before connecting to the power supply, check:

- The socket is adequate for the maximum power of the washing machine (For safety, fuses in the power circuit should be rated for no less than 13A).
- The voltage should meet the requirement.
- The power outlet should be capable of accepting the washing machine plug.
- Connect the machine to an earthed socket outlet.

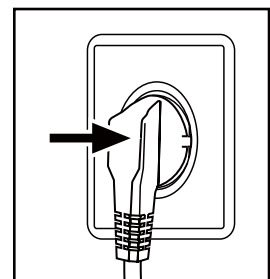

CONTROL PANEL

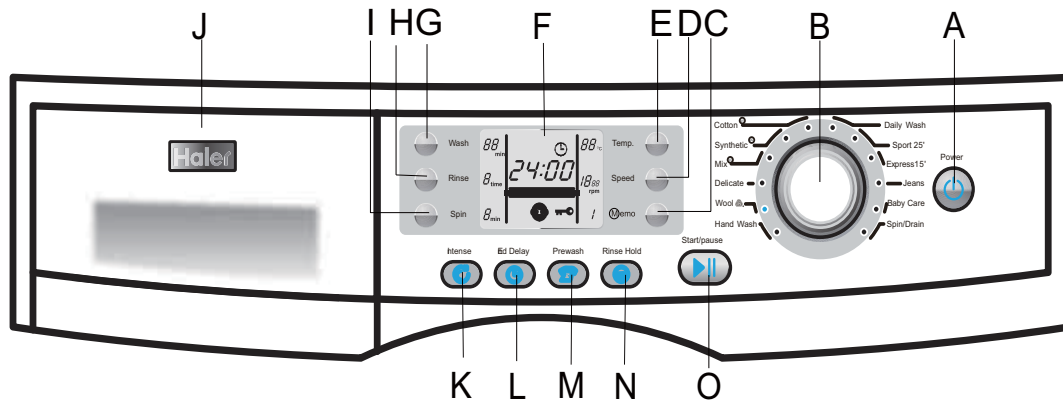

- | | | | | | |
|----------|-------------------------------|----------|-------------------------------|----------|------------------------|
| A | Power Switch | F | Display screen | K | Intense washing button |
| B | Program knob | G | Washing time | L | End Delay Button |
| C | Memo button | H | Times of rinse | M | Pre-wash button |
| D | Spinning Speed Setting button | I | Spinning time | N | Rinse Hold button |
| E | Washing temperature button | J | Detergent distribution drawer | O | Start/Pause button |

OPERATIONAL FUNCTIONS

A – Power Switch – Press the Power button to switch on the washing machine. Press it again to switch off the washing machine. Press On/Off button gently for 2 seconds to switch off the machine as all buttons are soft touch.

B – Program Knob – By turning the Program knob clockwise or anti-clockwise, anyone of the 12 programs can be selected. As the knob is turned the adjacent indication light will illuminate.

C – Memo button – This function can be used in conjunction with the following programmes. Cotton/Synthetic/Mix. After choosing one of these, you, the customer can set the following, washing time, washing temperature, rinse time, spin speed, spin time and choose some additional functions such as Intense/Delay/Prewash/Rinse hold according to the requirement. When the combination of wash program has been selected, this bespoke selection can be stored for reuse another day by pressing the “memo” button for 2 seconds, the display screen will show the corresponding number. (1 represents the programme that has been saved under cotton; 2 represents the programme that has been saved under synthetic; 3 represents for the programme that has been saved under Mix). This means the programme chosen by you the customer, has been saved. Next time, when you to use one of these Cotton/Synthetic/Mix custom wash programs, press “Memo”, the corresponding programme having been saved will be displayed, press “Start/pause” button to start this programme. Also, the setting programme can be used many times until you set a new one, the previous programme will be over written. Refer to the Wash Program Options table for details.

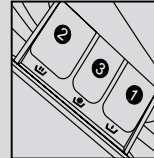
D	– Spin Speed button	_ Press the “Speed” button to select the spin speed. The maximum selectable spin speed varies with the wash program.
E	– Washing temperature button	_ Press the “Temp.” button to select the water wash temperature (-, 15, 20, 30, 40, 50, 60, 70, 80, 90). The maximum allowable heating temperature varies with programs. Note: “--” in the temperature display indicates non-heated washing.
F	Display screen	_ Display screen displays the following: washing time, program remaining time, number of rinses, spin time, set water temperature, speed, child lock state, door lock state, wash progress bar, and alarm message.
G	Wash time	_ Press button to set washing time. Press and hold this button to change the wash time. The time will increase in steps. Note this function is not applicable to the “ Spin/Drain ” program
H	Number of rinses	_ Press the “Rinse” button to select the times of rinsing and the maximum allowable number of rinses is 8.
I	Spin time	_ Press the “Spin” button to select spinning time. The maximum allowable spinning time varies with programs. See the following table for details.
J	– Soap Detergent distribution drawer	<p>_ Open the drawer, three compartments can be seen:</p> <p>Compartment 1: Prewash detergent</p> <p>Compartment 2: Detergent for programs 1 to 11.</p> <p>Compartment 3: Softener, conditioning agent, perfume, etc</p>  <p>The recommendation on the type of detergents is suitable for the various washing temperatures, please refer to the manual of detergent.</p>
K	Intense	_ Press the Intense button to increase the washing time during the main washing stage of the selected program. This feature is applicable for dirty clothes. The illuminated icon indicates the “Intense” function is selected. This additional function applies to “cotton”, “memory”, “synthetic”, “Silent”, “heavy” and Sport wash programs only. This button must be pressed before starting a program.
L	–End Delay	<p>_ Press the End Delay button and the illuminated icon indicates that the “delay” function is selected. The delay time increased by 30 minutes each press of “Delay” button. The time will change continuously if you press button until you release it. The delay time is the end time of wash program. For example, 6:00 means the after 6 hours the washing machine will have started after a delay and completed the selected wash program in 6 hours.</p> <p>Note 1. The delay time must be longer than the program’s running time. The “Delay” function is not available for “Spin/Drain” program.</p> <p>Note 2. The delay time must be longer than the program time; otherwise, the washing machine starts the wash program immediately.</p>

- M Pre-Wash _Press the "Pre-wash" button to select or cancel the prewash program. The prewash program can be selected for washing heavily soiled clothes. Press the "Prewash" button, the "Pre-wash" icon will illuminate. Press the "Pre-wash" again, the prewash function will be cancelled and the "Pre-wash" icon will go out. When selecting the prewash function, add a proper amount of detergent into the prewash box, otherwise do not add any detergent into the prewash box. This additional function applies to "cotton", "memory", "synthetic" and "Sport wash" programs only.
- N Rinse Hold _Press "Rinse Hold " button to start-up/shutdown the crease-resistant and soak function. This feature is only selectable with the "cotton", "synthetic", "Delicate", "Sport 25", and "Jeans" programs. When the process runs the last rinse, the washing machine does not pump the water out, the clothes will remain soaking in water, and the soak icon flashes, the remaining wash time does not decreasing. If you need to continue the process, you can press "Rinse Hold" button or "Start /Pause" button to cancel this function, and the icon will disappear, and the washing machine will continue to the wash program. This feature and the "End Delay" function cannot be selected at the same time.
- O → Start/
Pause Button _Press the "Start/pause" button, the washer will start and the indicator light remains on. If this button is pressed when the washing machine is in operation, the washing machine will pause and the indicator light will flash. If the Start/Pause button is pressed followed by the Power button, the wash program is ended and the washing machine is switched off.

WASH PROGRAM OPTIONS

PROGRAM	WASH DURATION (MINUTES)	NUMBER OF RINSE CYCLES	SPIN DURATION (MINUTES)	INTENSE FUNCTION
Hand Wash	5-30	0-9	1-4	No
Wool	5-30	0-9	1-4	No
Delicate	5-30	0-9	1-4	No
Mix	5-50	0-9	4-7	Yes
Synthetic	5-50	0-9	4-7	Yes
Cotton	5-60	0-9	4-7	Yes
Daily wash	5-40	0-9	4-7	Yes
Sport 25	5-40	0-9	1-4	Yes
Express 15	5-20	0-9	1-4	No
Jeans	5-40	0-9	4-7	Yes
Baby Care	5-50	0-9	4-7	No
Spin / Drain	—	—	4-7	No

AUTO WEIGH FUNCTION

Auto weigh is a feature that is available for the Cotton, Synthetic and Mix wash programs. When the AUTO feature is selected, the washing machine will rotate the drum at the beginning of the wash cycle before the water is added to determine the approximate weight of the dry laundry. The computer in the washing machine then will adjust the quantity of water required to wash the laundry. It is not recommended that the AUTO feature is used with liquid soap if the liquid is placed in the drum with the dry laundry. The liquid soap will be tipped on the dry laundry during the drum rotation weighing phase, and may damage the laundry. The auto weigh feature is not recommended with very absorbent laundry like duvets or blankets. If the auto weigh function is not required, press the Wash or Rinse or Spin buttons to cancel the auto weigh function.

QUICK START GUIDE

1. Open door and put laundry in drum, checking that there are no coin, clips, paper tissues or sharp objects in the clothing
2. If using liquid detergent place the detergent in the manufactures recommended container in the drum. Note. Do not use the auto weigh function with liquid detergent, it may spoil the cloths.
3. Open soap drawer and fill with soap powder and fabric conditioner as required. Do not use more than the manufactures recommended amount.
4. Close the door
5. Turn on water and electrical power, if not already on.
6. Press the Power button to switch on the washing machine
7. Select the wash program by turning program knob or press Memo button if 'custom wash' has been previously saved.
8. If selecting Cotton, Synthetic or Mix wash programs, the washing machine default to the AUTO weigh program. If auto weigh is not required, e.g. using liquid detergent, press the Wash or Rinse or Spin buttons to cancel the auto weigh function.
9. Change temperature, spin speed, spin duration any delayed start etc. as required, see "BUTTON OPERATION FUNCTIONS" section of this manual for details.
10. Press Start/Pause button to start the wash program.

PROGRAM SELECTION

PROGRAM MODES

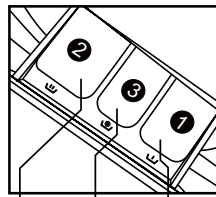

- 1 Detergent compartment for prewash mode
- 2 Detergent compartment
- 3 Compartment for softener and other additives

Program	Temperature Maximum	Preset				Recommended Laundry	Preset spin speed
			2	3	1		
1 → Hand Wash	-- to 40 °C	30°C	<input checked="" type="checkbox"/>	<input type="checkbox"/>	<input checked="" type="checkbox"/>	Cotton fabrics	800 rpm
2 → Wool	-- to 40 °C	30°C	<input checked="" type="checkbox"/>	<input type="checkbox"/>	<input checked="" type="checkbox"/>	Woolen fabrics	600 rpm
3 → Delicate	-- to 40 °C	30°C	<input checked="" type="checkbox"/>	<input type="checkbox"/>	<input checked="" type="checkbox"/>	Cotton fabrics	800 rpm
4 → Mix	-- to 40 °C	40°C	<input checked="" type="checkbox"/>	<input type="checkbox"/>	<input type="checkbox"/>	Cotton or synthetic	1000 rpm
5 → Synthetic	-- to 60 °C	40°C	<input checked="" type="checkbox"/>	<input type="checkbox"/>	<input type="checkbox"/>	Chemical fiber fabrics	1000 rpm
6 → Cotton	-- to 90 °C	60°C	<input checked="" type="checkbox"/>	<input type="checkbox"/>	<input type="checkbox"/>	Cotton fabrics	1000 rpm
7 → Daily Wash	-- to 60 °C	40°C	<input checked="" type="checkbox"/>	<input type="checkbox"/>	<input checked="" type="checkbox"/>	Cotton fabrics	1000 rpm
8 → Sport 25'	-- to 40 °C	30°C	<input checked="" type="checkbox"/>	<input type="checkbox"/>	<input checked="" type="checkbox"/>	Sports wear	800 rpm
9 → Express 15'	-- to 40 °C	--	<input checked="" type="checkbox"/>	<input type="checkbox"/>	<input checked="" type="checkbox"/>	Cotton or synthetic	800 rpm
10 → Jeans	-- to 60 °C	40°C	<input checked="" type="checkbox"/>	<input type="checkbox"/>	<input type="checkbox"/>	Jeans	1000 rpm
11 → Baby Care	-- to 90 °C	80°C	<input checked="" type="checkbox"/>	<input type="checkbox"/>	<input checked="" type="checkbox"/>	Cotton or synthetic	1000 rpm
12 → Spin/Drain			<input checked="" type="checkbox"/>	<input checked="" type="checkbox"/>	<input checked="" type="checkbox"/>	None	1000 rpm

Yes No Optional

CONSUMPTION AND TECHNICAL DATA

CONSUMPTION TABLE

PROGRAM	MAX. LOAD		TEMPERATURE	WASHING TIME	SPIN DRYING PERFORMANCE	
	HW80-*86/HW70-*86/HW60-*86				HW80-*86/HW70-*86/HW60-*86	
→ Hand Wash	2 kg/2 kg/1kg		30°C	0:38		/
→ Wool	2 kg/2 kg/1kg		30°C	0:35		/
→ Delicate	2 kg/2 kg/1kg		30°C	0:38		/
→ Mix	5 kg/5 kg/3kg		40°C	Auto		/
→ Synthetic	4 kg/3.5kg/3kg		40°C	Auto		/
→ Cotton	8 kg/7kg/6kg		60°C	Auto		53%
→ Daily Wash	4 kg/3.5kg/3kg		40°C	0:41		/
→ Sport 25'	4 kg/3.5kg/3kg		30°C	0:25		/
→ Express 15'	2 kg/2kg/1kg		--	0:15		/
→ Jeans	4 kg/3.5kg/3kg		40°C	0:58		/
→ Baby Care	4 kg/3.5kg/3kg		80°C	1:53		/
→ Spin/Drain	/		/	0:08		/

The standard 60 °C and 40 °C cotton programmes are suitable to clean normally soiled cotton laundry and they are the most efficient programmes in terms of combined energy and water consumptions for washing that type of cotton laundry; The actual water temperature may differ from the declared cycle temperature;

TECHNICAL DATA

	HW80-B1286/B1486	HW70-B1486	HW60-B1286
Power source	220 - 240V~/50Hz	220 - 240V~/50Hz	220 - 240V~/50Hz
Max. working current (A)	10	10	10
Water pressure (MPa)	0.03≤P ≤1	0.03≤P ≤1	0.03≤P ≤1
Nominal load (kg)	8	7	6
Spinning speed (r/min)	1200/1400	1400	1200
Washing programs	12	12	12
Max power (W)	2000	2000	2000
Dimensions (HxDxW mm)	850 X 650 X 595	850 X 600 X 595	850 X 520 X 595
Net weight (kg)	74	70	65
Power consumption of the off-mode(W)	0.39	0.39	0.41
Power consumption of the left-on mode(W)	0.39	0.39	0.40

WASHING METHODS

This washing machine is for domestic use only. If the machine is used for commercial purposes the guarantee will not be valid anymore. Do not use it for purposes other than that for which it was designed. Follow the instructions given on the label of each garment and wash only machine-washable garments.

**POWER SUPPLY**

Connect the washing machine to the power supply (220V to 240V~/50Hz).

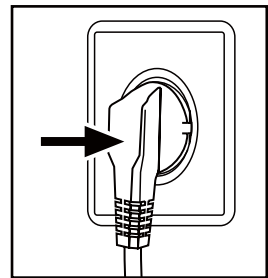
**WATER CONNECTION**

Turn on the tap. The water must be clean and clear.

Note: Before use, check for leakage in the joints between the tap and the inlet hose by turning on the tap.

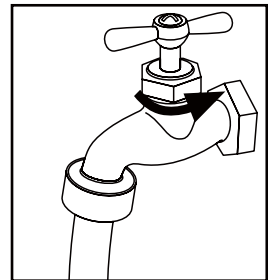
**PREPARING THE LAUNDRY**

- Sort out clothes according to fabric (cotton, synthetics, wool or silk) and to how dirty they are.
- Separate white clothes from coloured ones. Wash them first by hand to check if they fade or run.
- Empty pockets (keys, coins, etc.) and remove the harder decorative objects (e.g. brooches).

Attention: Small parts (like buttons, etc) may lead to repair work which user has to pay by themselves and can cause damage in the machine.

- Garments without hems, underwear, finely woven textile such as fine curtains are to be put into wash bag (it is better not to wash them in a washing machine).
- Close zippers and hooks, make sure the buttons are sewn on tightly and place small items such as socks, belts, bras, etc. in the wash bag.
- Unfold large pieces of fabric such as bed sheets, bedspreads, etc.
- Turn shirts inside out.

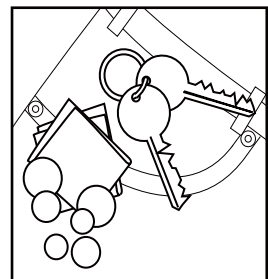
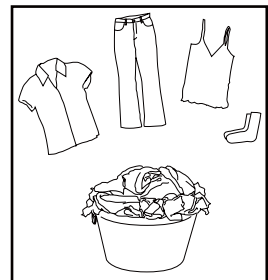

LOADING THE MACHINE

Open the washer door, put in the laundry piece by piece. Close the door tightly.

- When first using the washing machine, let it run unloaded for one program to prevent the laundry from being tainted by oil or dirty water from the washing machine. Before washing you should run the machine without laundry, but with detergent, with 60°C program.
- Do not overload the washing machine.

SELECTING DETERGENT

The washing efficiency and the performance is determined by the quality of detergent used. Special non-foaming detergent produces good washing results. Use specific detergents for synthetic and woollen goods. Do not use dry cleaning agents such as trichloroethylene and similar products.

Note: Do not add more detergent than needed; otherwise, it may cause the situations as following and washing machine malfunction impacting washing machine's life.

1. Due to the increasing foam, the rinse time will be longer than normal;
2. The foam may overflow from the detergent drawer because of the increasing pressure of the foam;
3. It may remain foam without cleaning out after the final spinning cycle.

Recommendation:

1. Clean the detergent drawer once a week.
2. When using the prewashing program, please add half of the rating dosage.
3. Please follow the dosage recommendation on the powder or liquid detergent package.

Note: If the Cotton or Synthetic function is used the washing machine defaults to the Auto weigh function. Do not use liquid detergent with the auto weigh program, because during the initial part of the program the drum rotates and concentrated liquid detergent will be tipped onto the laundry and may damage the fabric or affect the colours.

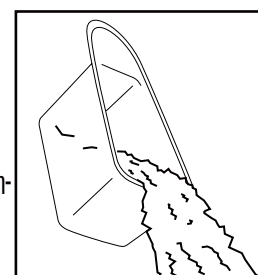

ADDING DETERGENT

Slide out the detergent drawer and put the required detergent and softening agent into the corresponding compartments. Push back the drawer gently. (Refer to the instructions on the drawer)

Caution:

→ For prewashing program, detergent should be added to both compartments 1 and 2.

For other programs, do not add detergent to compartment 1.

→ Use liquid detergent according to the instructions on its package. Do not use liquid detergent if the pre-wash mode or "Start delay" is selected.

→ Do not overuse softener; otherwise, it will damage the artificial fibers.

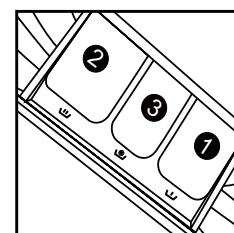

SELECTING PROGRAM

To get the best washing results, an appropriate washing program should be selected according to the laundry type. Please turn the program knob to select the right program.

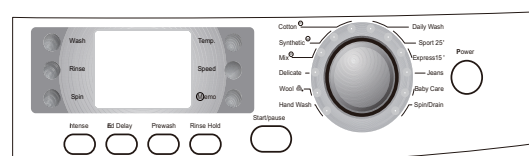

SELECTING FUNCTIONAL

Select the required options. (Refer to the "Control panel" pages 08 and 10)

SETTING WASHING TEMPERATURE

Press and hold down the temperature button until the desired temperature is selected .

SETTING SPIN SPEED

Press and hold down the speed button until the desired speed is selected. See "Operational functions" on the "Control panel" pages (08 and 10) for selecting temperature and spin speed. It is advisable to select the recommended value.

WASHING

Press the Start/Pause button. The washing machine will operate according to the preset programs. The washing machine will stop operation automatically when a washing cycle ends. The "End" sign will appear on the display. Open the washer door and take out the laundry.

AFTER WASHING





























Turn off the water supply and unplug the power cord. Open the washer door to prevent formation of moisture and odours. Let the door open while not used.



TIPS FOR SAVING ENERGY

1. Collect clothes for one full wash load.
2. Avoid overloading the washing machine.
3. Prewash only heavily soiled clothes.
4. Reduce the amount of detergent or choose standard or delicate wash programs for slightly soiled clothes.
5. Choose a proper washing temperature. Modern detergents can wash with very good result already in lower temperature than 60°C. Only use higher temperature than 60°C for heavily soiled laundry.
6. Follow the dosage recommendation on the detergent package to avoid using too much detergent.

CARE CHART

	Resistant material		Bleachable in cold water		Don't dry clean
	Delicate fabric		Do not bleach		Dry flat
	 Washable at 95 °C		Iron at 200 °C		Hung to dry
	 Washable at 60 °C		Iron at 150 °C		Dry on clothes hanger
	 Washable at 40 °C		Iron at 100 °C		Tumble dry, normal heat
	 Washable at 30 °C		Don't iron		Tumble dry, reduced heat
	Hand wash		Dry cleaning with any solvent		Don't tumble dry
	Dry clean only		Dry cleaning with perchloride		
	Wool Seal		Dry cleaning with aviation fuel		

LOAD REFERENCE

Bed sheet (single)	Cotton	Approximately 800g
Blanket	Wool	Approximately 3000g
Blended fabric clothes	/	Approximately 800g
Jackets	Cotton	Approximately 800g
Jeans	/	Approximately 800g
Overalls	Cotton	Approximately 950g
Ladies Pyjamas	/	Approximately 200g
Shirts	/	Approximately 300g
Socks	Blended fabrics	Approximately 50g
T-Shirts	Cotton	Approximately 300g
Underwear	Blended fabrics	Approximately 70g

CLEANING & CARE**AFTER WASHING**

Turn off the water supply and pull out electricity plug after each wash. Open the washer door to prevent formation of moisture and odours. If the washing machine is left idle for a long period, drain the water in the machine and replace the drain hose.

CLEANING THE DETERGENT DRAWER

Clean the detergent distribution drawer regularly.

Swing out the drawer, flush it clean with water and then replace it.

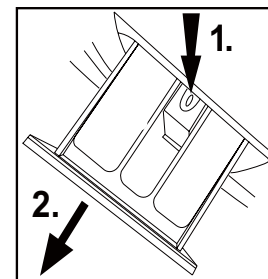
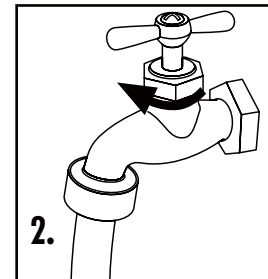
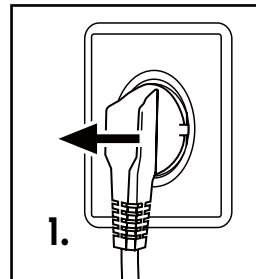
**CLEANING THE MACHINE**

Unplug the machine during cleaning and maintenance. Use a soft cloth dampened with soap liquid to clean the machine case and rubber components. Do not use organic chemicals or corrosive solvents.

CLEANING THE FILTER

Clean the filter once a month:

1. Open the bottom cover.
2. Remove the filter by turning counterclockwise.
3. Flush the filter clean with running water.
4. Replace the filter by turning clockwise and remount the cover.

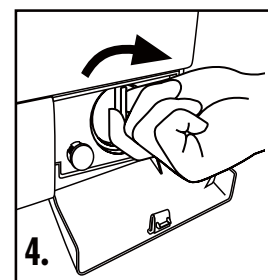
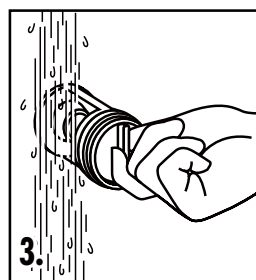
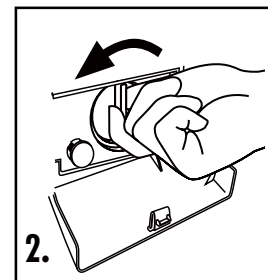
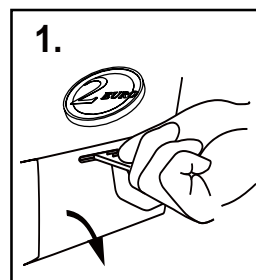
**Caution:**

1. The filter must be in place, or it may lead to leakage.

2. Place a container under the drain pump filter, to collect any excess water that may come out of the drain pump when the filter is removed.

WATER INLET VALVE AND INLET VALVE FILTER

To prevent blockage to the water supply by ingress of foreign substances, clean the water inlet valve and inlet valve filter regularly.

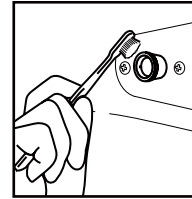

MANUALLY OPENING THE WASHING MACHINE DOOR

To add clothing when washing after the wash program has started or after a power cut, you want to remove the clothing, do the following steps.

1. Make sure the level of water in drum must under the lowest edge of the door window,
2. The temperature of water is not over 50°C
3. The machine is switch off at the power supply so the drum cannot turn.
4. Disconnect the drain hose and place the open end in a bucket lower the end so that the water in the washing machine drains out.
5. Reconnect the drain hose to the drain system.
6. Open the filter access door at the bottom of cabinet, you can see a ring pull handle. Gently pull the sprung loaded handle down, and pull the door at the same time to open it.
7. You can add or remove the clothing. Caution, the clothing will be very wet.
8. Close the filter door.

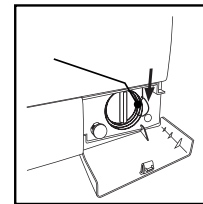

MAINTENANCE OR SERVICE WASH

A maintenance wash is recommended to be done to clean the washing machine out by running a high-temperature (90°C Cotton) program. This is especially recommended if you do a significant number of low temperature washes a month. The high temperature kills off bacteria and unwanted fungal growth. A service (or maintenance) wash involves putting the washing machine on the hottest wash (90°C Cotton Wash) with only the detergent inside - and no laundry. If you normally use a washing machine detergent that doesn't contain bleach, then buy some detergent that does, and use it for your maintenance washes. This will help kill off bacteria and prevent black mould and grease. Tip: Look for something like, "bleaching agents" in the ingredients. Do not put cleaning bleach (like Domestos) in the washing machine this will damage the machine. There are certain types of bleach example oxygen bleaches like 'Wish' that are appropriate for laundry. To check if your washing machine is being badly affected, carefully examine the inside of the door seal for slime. Pull the lip in front of the drum and look underneath on lip of the tub as it can accumulate a slime, which causes smells, and rots the seal.

MOVING THE MACHINE

If the machine is to be moved to a distant location, replace the transportation bolts removed before installation to prevent damage as shown below

1. Remove the back cover
2. Remove the blanking plugs.
3. Insert the synthetic stabilisers and the transportation bolts.
4. Tighten the bolts with a spanner.
5. Replace the back cover.

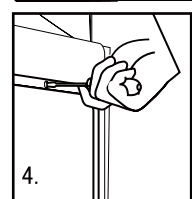
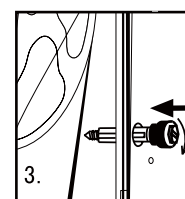
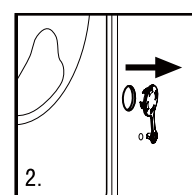
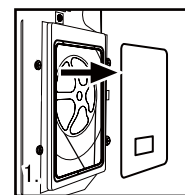

LONG PERIODS OF DISUSE

If the washing machine is left idle for a long period, pull out the electrical plug and turn off the water supply. Open the washing machine door to prevent formation of moisture and odours. Let the door open while not used.



DISPLAY CODES**DISPLAY CODES AND SPECIAL FUNCTIONS**

CODES	CAUSES	SOLUTIONS
Err1	→ Door is not properly shut.	_ Shut the door properly, and then press the Start/Pause button.
Err2	→ Drainage error, water not emptied within 6 minutes.	_ Clean the filter and check the drain hose for blockage. If error still exists, please contact the maintenance personnel.
Err3	→ Temperature sensor not properly connected or damaged.	_ Contact the maintenance personnel.
Err4	→ Heater error (Appears at the end of a cycle).	_ Contact the maintenance personnel.
Err5	→Water level not met in 8 minutes. →The height of the drain hose is below 80 cm. → The drain hose is in water.	_ Make sure that tap is turned on, and water pressure is normal. If problem still exists, please contact the maintenance personnel. _ Install drain hose within 80-100 cm of height. _ Make sure the drain hose is not in water.
Err7	→ Motor error.	_ Contact the maintenance personnel.
Err8	→ Water exceeds protective level.	_ Contact the maintenance personnel.
Er10	→ The signal of Water level sensor is wrong.	_ Contact the maintenance personnel.
EuAr	→ The PBC and the motor can't communicate.	_ Contact the maintenance personnel.
End	→ End of wash cycle.	
1:25	→The remaining time is 1 hour 25 minutes.	
19:30	→Status information:Preset time for delayed operation.	
UNb	After the last rinsing cycle finishes,spinning fails completely due to unbalance of the laundry.	

→ Control panel lock function: Press the "Delay" and the "Start/Pause" buttons simultaneously for 3 seconds after starting a program. It can no longer be changed by operating buttons or knobs. To unlock press the "Delay" and "Start/Pause" buttons again for 3 seconds.

→ Power-off memory function: In case of abrupt power failure or the need to cut off the power during a program cycle, the present settings will be saved and the preset operation will resume when the power is on again.

→ To cancel a program

Press the "Start/Pause" button, then switch off the power and the program is automatically cancelled. Turn the program selector again to choose another program.

Note: During the spin process, if too much foam is inspected, in order to protect the motor, the washing machine will eliminate the foam automatically; the motor will stop and the drain pump will drain the water continuously for 90 seconds. If it happens more than 3 times, the motor will stop until the end of cycle without spinning.

TROUBLESHOOTING

TROUBLESHOOTING

The following circumstances do not constitute problems. Do not contact the Service Center until the problem has been confirmed.

PROBLEM	CAUSES	SOLUTIONS
Washing machine fails to operate.	<ul style="list-style-type: none"> → Poor connection to the power supply. → Power failure. → The washer door is not properly closed. → Machine has not been switched on. 	<ul style="list-style-type: none"> _ Check connection to the power supply. _ Check the power supply. _ Close the washer door properly. _ Make sure the machine is switched on.
Washing machine cannot be filled with water.	<ul style="list-style-type: none"> → The "Start/Pause" button is not pressed. → Water tap is not turned on. → Water pressure is less than 0,03 MPa. → The inlet hose is kinked. → Water supply failure. → The program knob is not properly set. → The washer door is not properly closed. → The inlet hose filter is blocked. 	<ul style="list-style-type: none"> _ press the "Start/Pause" button. _ Turn on the water tap. _ Check water pressure. _ Check the inlet hose. _ Ensure the water supply. _ Set the program knob properly. _ Close the washer door properly. _ Unblock the inlet hose filter.
Machine is draining while being filled.	<ul style="list-style-type: none"> → The height of the drain hose is below 80 cm. → The drain hose is in water. 	<ul style="list-style-type: none"> _ Install drain hose within 80-100 cm of height. _ Make sure the drain hose is not in water.
Drainage failure.	<ul style="list-style-type: none"> → Drain hose is blocked. → Drain hose end is higher than 100 cm above the floor level. → The filter is blocked. 	<ul style="list-style-type: none"> _ Unblock the drain hose. _ Make sure the drain hose end is lower than 100 cm above floor level. _ Unblock the filter.
Strong vibration while spinning.	<ul style="list-style-type: none"> → Not all transportation bolts have been removed. → Washing machine is located on an uneven surface or is not level. → Machine load is over Max load. 	<ul style="list-style-type: none"> _ Remove all transportation bolts. _ Make sure the washing machine is on an even surface and levelled. _ Reduce amount of laundry in the drum.
Operation stops before completing wash cycle.	<ul style="list-style-type: none"> → Water or electricity failure. 	<ul style="list-style-type: none"> _ Check the power supply.
Operation stops for a period of time.	<ul style="list-style-type: none"> → Washing machine gives an error message. → Washing machine is in soaking cycle? 	<ul style="list-style-type: none"> _ Check display codes. _ Press the rinse hood button or the Start/pause button again to cancel it.
Excessive foam in the drum, which is spilled to the distribution drawer.	<ul style="list-style-type: none"> → The detergent is not a low-foaming type or for manual wash. → Excessive use of detergent. 	<ul style="list-style-type: none"> _ Check if your detergent is appropriate. _ Reduce amount of detergent in the distribution drawer.
Automatic adjustment of the washing time.	<ul style="list-style-type: none"> → The washing program duration will be adjusted 	<ul style="list-style-type: none"> _ This is normal and doesn't affect the functionality.
Spinning fails	<ul style="list-style-type: none"> → Unbalance of the laundry 	<ul style="list-style-type: none"> _ Add clothes or run a spinning program again.

INSTALLATION

Electrical connection



Any electrical work that is required to install this washing machine **MUST** be carried out by a qualified electrician.



Warning: **THIS APPLIANCE MUST BE EARTHED**

Before making any electrical connections, ensure that:

- Ensure the power socket is suitable for the maximum power of the washing machine (fuses in the power circuit must be 13 amp).

- The supply voltage should be the same as that indicated in the technical specifications and the appliance rating plate (located where shown).



- The appliance should be earthed and in compliance with the applicable law.

- Additional earth cables should not be necessary if the plug and socket are earthed. If necessary, an additional earth cable should be attached to the earth terminal on the back of the washing machine and earthed.

- When installed, the power socket must be within easy reach.

- The use of adapters, multiple connectors or extension cables are not recommended.

- The appliance must be connected to a 220-240 volt 50 cycle AC supply by means of a three pin socket, suitably earthed and protected by a 13 amp fuse.

- Should the fuse need to be replaced, a 13 amp fuse approved to BS1363/A must be used.

- The plug contains a removable fuse cover that must be refitted when the fuse is replaced. If the fuse cover is lost or damaged, the plug must not be used until a replacement cover has been fitted or the plug is replaced.

- A damaged plug should be cut off as close to the plug body as possible, the fuse should be removed and the plug disposed of safely.

Plug replacement (UK & Ireland only)

Should you need to replace the plug; the wires in the power cable are coloured in the following way:

Blue – Neutral 'N'

Brown – Live 'L'

Green & Yellow – Earth 'E'

As the colours of the wires in the power cable may not correspond with the coloured markings identifying the terminals in your plug, and proceed as follows:

The green & yellow wire must be connected to the terminal in the plug that is marked with the letter E or by the earth symbol.

The blue wire must be connected to the terminal that is marked with the letter N.

The brown wire must be connected to the terminal that is marked with the letter L.

If the power lead is damaged, it must be replaced by a qualified electrician.

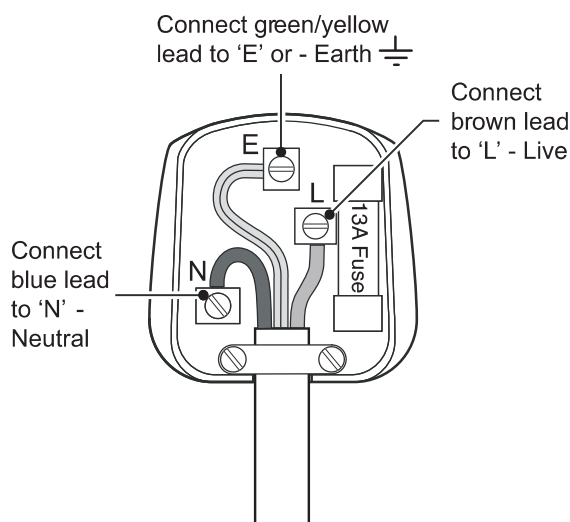

Free Manuals Download Website

<http://myh66.com>

<http://usermanuals.us>

<http://www.somanuals.com>

<http://www.4manuals.cc>

<http://www.manual-lib.com>

<http://www.404manual.com>

<http://www.luxmanual.com>

<http://aubethermostatmanual.com>

Golf course search by state

<http://golfingnear.com>

Email search by domain

<http://emailbydomain.com>

Auto manuals search

<http://auto.somanuals.com>

TV manuals search

<http://tv.somanuals.com>