

UNIVERSAL PICKUP RACK

Model 67498

INSTRUCTIONS AND PRECAUTIONS

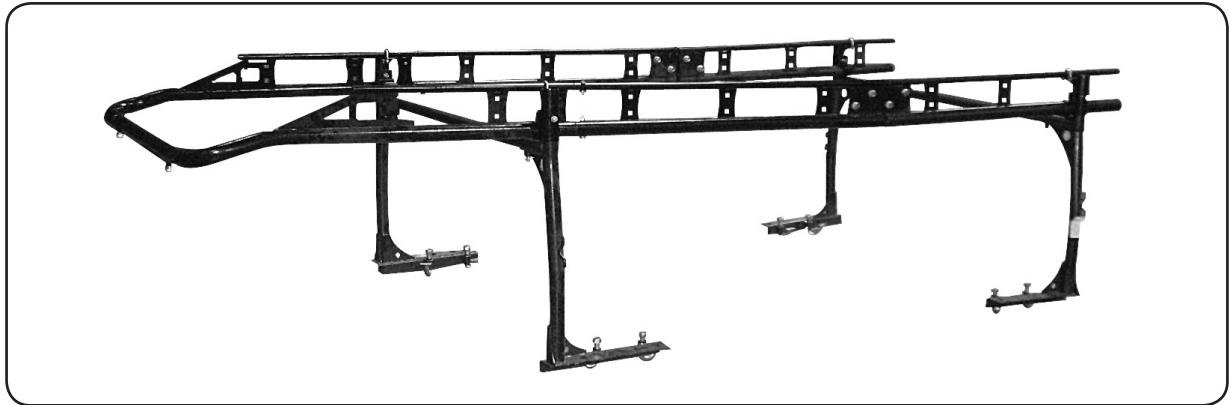

Visit our website at: <http://www.harborfreight.com>



SAVE THESE INSTRUCTIONS. READ ALL PRECAUTIONS AND INSTRUCTIONS.

Copyright© 2009 by Harbor Freight Tools®. All rights reserved. No portion of this document or any artwork contained herein may be reproduced in any shape or form without the express written consent of Harbor Freight Tools. Diagrams within this document may not be drawn proportionally. Due to continuing improvements, actual product may differ slightly from the product described herein. Tools required for assembly and service may not be included.

For technical questions or replacement parts, please call 1-800-444-3353.

SPECIFICATIONS

Weight Capacity	With Over-Cab Section: 1500 lb. Without Over-Cab Section: 1200 lb.
-----------------	---

UNPACKING

When unpacking, make sure that the item is intact and undamaged. If any parts are missing or broken, please call Harbor Freight Tools at 1-800-444-3353 as soon as possible.

IMPORTANT SAFETY INFORMATION

Assembly Precautions

1. Assemble only according to these instructions. Improper assembly can create hazards.

2. Wear ANSI-approved safety goggles and heavy-duty work gloves during assembly.
3. Keep assembly area clean and well lit.
4. Keep bystanders out of the area during assembly.
5. Do not assemble when tired or when under the influence of drugs, alcohol or medication.

Use Precautions

1. This product is not a toy. Do not allow children to play with or near this item.
2. Use as intended only.
3. Inspect before every use; do not use if parts are loose or damaged.
4. Maintain product labels and nameplates. These carry important safety information. If unreadable or missing, contact Harbor Freight Tools for a replacement.

Safety Warnings

1. Do not exceed 1500 lb. capacity for over-cab configuration, or 1200 lb. capacity for bed-only configuration. Be aware of dynamic loading! Sudden movement may briefly create excess load, causing product failure. Vehicle structure may require reinforcement to allow full capacity. Do not overload vehicle. Consult vehicle manufacturer.
2. Wear ANSI-approved goggles and heavy-duty work gloves during assembly.
3. Use as intended only.
4. Verify that installation surfaces have no hidden wires or components before drilling.
5. Secure load before use. Follow traffic regulations for loads transported.
6. Inspect before every use; do not use if parts loose or damaged.
7. Install and use according to manual instructions.
8. Do not modify this product or use it for any use other than its intended purpose.
9. Check to see if the vehicle manufacturer requires a reinforcing kit for this installation.
10. In the event that this rack is to be mounted on the truck bed:
 - a. All floor mounting bolts near gas tanks must be installed from underneath to avoid tank rupture in the event of a collision.
 - b. Inspect underneath truck bed for fuel lines, electrical wiring, brake lines, etc. before drilling.
11. All loads placed on this Pickup Rack must be secured against movement in any direction, bouncing or shifting of load.
12. Along with the weight capacity of this Pickup Rack, be aware of the weight bearing capabilities of the vehicle, suspension, and tires.
13. Driving techniques must take into consideration the change in center of gravity, and the different driving and handling characteristics when the Pickup Rack is loaded.
14. Trucks with bedliners may have to be modified to allow the use of the J-Bolts.
15. Loaded Pickup Rack is not recommended for unimproved or poorly maintained roads.
16. If this rack cannot be installed according to instruction, do not use.
17. Loads extending beyond the back of the truck must have a red flag (day) or red light (night). Check local DOT regulations.
18. Avoid having material protruding beyond the sides which may injure a passerby.
19. After assembly and mounting on vehicle, double check all connections to make sure all fasteners are properly and securely tightened.
20. Be aware of cross winds when traveling with items placed on the rack.

ASSEMBLY INSTRUCTIONS



Read the **ENTIRE IMPORTANT SAFETY INFORMATION** section at the beginning of this document including all text under subheadings therein before set up or use of this product.

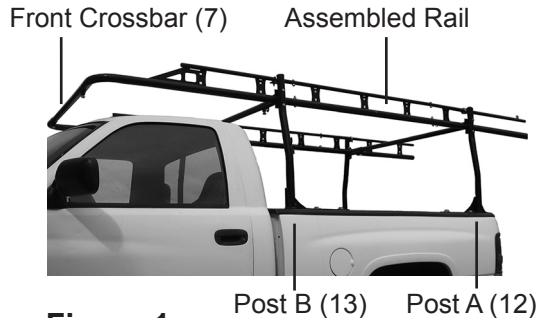

Figure 1

This Rack is designed to fit over a standard or short bed pickup truck, with or without the section over the vehicle cab. You can adjust the location of the Posts along the Assembled Rail to fit your vehicle.

J-Bolt Configuration

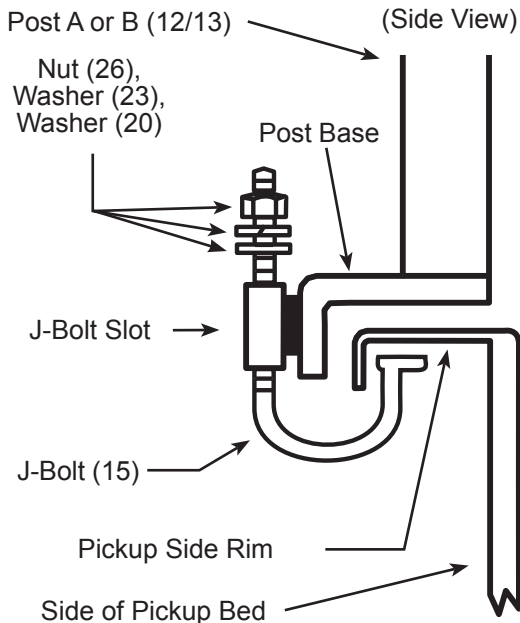

Figure 2

Use the J-Bolt (15) configuration as shown in Figure 2 for bolting the Rack to the truck bed without drilling holes

through the top of the rim. You will need to cut holes in the side of a liner if the truck bed has a liner, or if the side of the truck bed is solid, without an inner rim.

Drilled and Bolted Configuration

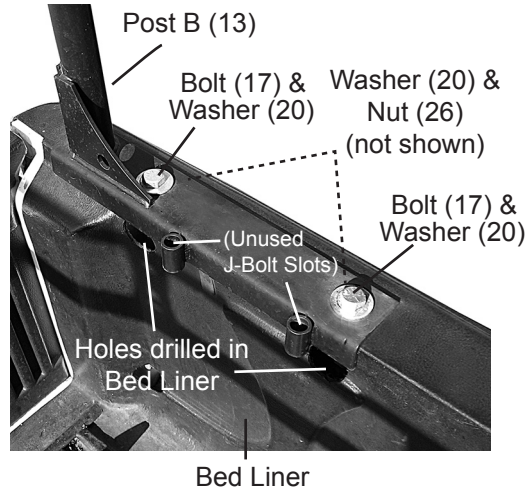

Figure 3

To mount the Rack by bolting it to the top of the truck bed rim, you will need to drill holes in the top of the Pickup rim to attach the Posts (12/13). If the truck bed has a liner, or the side of the truck bed is solid, you will also need to cut 2" holes in the side so you have access to the bottom of the Bolts (17) to add the Washers (20) and Nuts (26).

CAUTION: Do not drill any holes until you have fully assembled the rack and placed it on the truck bed to double check the hole placement.

Preparation

1. Lay out and identify all parts.
- Note:** Some parts are similar, but not identical, such as Post A (12) and Post B (13). Use the Assembly Diagram to help identify all parts.
2. Determine approximately where to attach the Posts (12/13) to the rim of the truck bed without interfering with other structures or hidden components within the truck bed. Record the distance

between posts and mark the location for the bolts on the truck bed.

Attaching the Side Rails Together

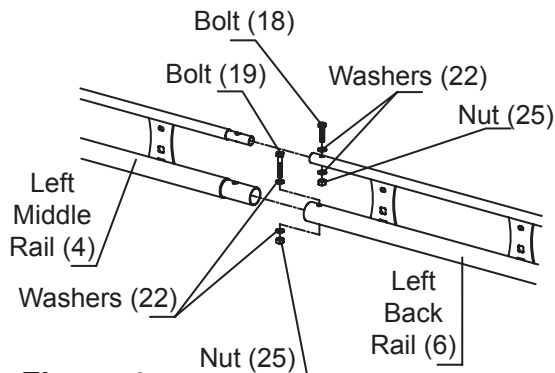

Figure 4

Slide the Left Middle Rail (4) into the Left Back Rail (6) and secure the smaller bar sections together with the Bolt (18), two Washers (22), and a Nut (25), and the larger bar sections together with the Bolt (19), two Washers (22), and a Nut (25).

Attach the Right Middle and Right Back Rails (3 & 5) in the same manner.

Attaching the Posts to the Side Rails

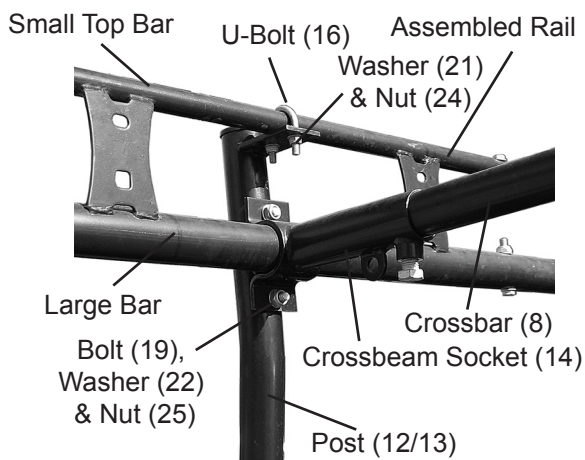

Figure 5

1. Lay one Post A and one Post B on the ground at the approximate distance apart as in step 2 under "Preparation" and lay one assembled Rail section over the Posts, so the large lower bar fits into the cupped section near the top of the Posts

and the smaller bar sits on top of the flange at the top of the Posts. Position the Rail so the vertical supports are not in the way of attaching the Posts.



Figure 6

- Note:** The vertical supports on the Rail sections should be positioned so they are on the inside of the framework. The Posts can be positioned anywhere along the Rails between the vertical supports.
2. Working with one Post at a time, straddle the large bottom bar of the Rail with the Crossbeam Sockets (14), aligning the holes on the Crossbeam Sockets with the holes in the Post.
 3. Secure the Crossbeam to the large bar and Post with two Bolts (19), four Washers (22) and two Nuts (25).
 4. Secure the small top bar to the top flange of the Post with the U-Bolt (16), two Washers (21) and two Nuts (24).
 5. Repeat steps 1-4 above for the other assembled Rail section and remaining Posts.
 6. Double check the distances between the Posts and adjust their distances so they will fit on the truck bed as determined in step 2 under "Preparation".

Optional Construction with Bar over Cab

This unit can be assembled as a smaller Rack by omitting the pieces positioned over the Truck Cab, or it can be assembled as

shown on the manual cover, with the extra section over the truck cab. If assembling in the smaller configuration, skip this section and go to "Completing the Rack" below. If assembling with the over-cab section, attach the Left Front and Right Front Rails (2 & 1) to the assembled rail sections using the same hardware as used for attaching the other side rail sections.

Note: The Rack supports up to 1500 lbs in the over-cab configuration and up to 1200 lbs in the smaller configuration.

Completing the Rack

1. Working with one assembled section, slide the Crossbars (8 & 9) into the Crossbeam Sockets (14). If making the over-cab construction also slide the front Crossbar (7) into the Front Rail (1 or 2) and tighten in place with the Hex Bolts (17).
2. Slide the other ends of the Crossbars into the other assembled section, insert the Hex Bolts, but do not fully tighten so you can adjust the width of the Rack, if needed.

Note: If assembling with the J-Bolts (15), loosely pre-assemble the J-Bolts (15), Nuts (26) and Washers (20/23) through the J-Bolt Slots in the Post bases.

Note: If attaching to a truck bed with a liner, use a Cargo Bar (sold separately - SKU 66172) to press the liner up against the truck bed sides to get a snug fit on the truck bed and liner.

Attaching the Rack to the Truck

1. With a helper, lift the assembled Rack and position on the vehicle.
2. Drill holes in the truck bed and/or liner as needed.
3. If using the J-Bolts, hook them under the Pickup Side Rim. Adjust the width or post positions as needed until the

Rack is ready to secure. Secure in place through the base of the Posts with the Hex Bolts (17), Washers (20), and Nuts (26), or tighten the Nuts on the J-Bolts, as needed for your vehicle.

4. Adjust and tighten the Hex Bolts holding the Crossbars. Check that all connections are secure and all bolts are tight.
5. Insert the Large and Small End Caps (10, 11) into the ends of the bars and posts.

Note: You may want to shorten the length of the Back Rails by sawing off the ends before inserting the End Caps.

OPERATION

1. Secure all loads in place.
2. Be aware of dynamic loading. Dropping, swinging or bouncing load may briefly create excess load causing product failure.
3. Cargo protruding beyond the back of the truck and Rack must be identified by a red flag by day and a red light by night. Check local DOT regulations.

PLEASE READ THE FOLLOWING CAREFULLY

THE MANUFACTURER AND/OR DISTRIBUTOR HAS PROVIDED THE PARTS LIST AND ASSEMBLY DIAGRAM IN THIS MANUAL AS A REFERENCE TOOL ONLY. NEITHER THE MANUFACTURER OR DISTRIBUTOR MAKES ANY REPRESENTATION OR WARRANTY OF ANY KIND TO THE BUYER THAT HE OR SHE IS QUALIFIED TO MAKE ANY REPAIRS TO THE PRODUCT, OR THAT HE OR SHE IS QUALIFIED TO REPLACE ANY PARTS OF THE PRODUCT. IN FACT, THE MANUFACTURER AND/OR DISTRIBUTOR EXPRESSLY STATES THAT ALL REPAIRS AND PARTS REPLACEMENTS SHOULD BE UNDERTAKEN BY CERTIFIED AND LICENSED TECHNICIANS, AND NOT BY THE BUYER. THE BUYER ASSUMES ALL RISK AND LIABILITY ARISING OUT OF HIS OR HER REPAIRS TO THE ORIGINAL PRODUCT OR REPLACEMENT PARTS THERETO, OR ARISING OUT OF HIS OR HER INSTALLATION OF REPLACEMENT PARTS THERETO.

Part	Description	Qty
1	Right Front Rail	1
2	Left Front Rail	1
3	Right Middle Rail	1
4	Left Middle Rail	1
5	Right Back Rail	1
6	Left Back Rail	1
7	Front Crossbar	1
8	Middle Crossbar	1
9	Rear Crossbar	1
10	Small End Cap	6
11	Large End Cap	8
12	Post A	2
13	Post B	2

Part	Description	Qty
14	Crossbeam Sockets	4
15	J-Bolt	8
16	U-Bolt	4
17	Hex Bolt M16 x 30	14
18	Bolt M10 x 40	4
19	Bolt M10 x 70	12
20	Washer 16	24
21	Washer 8	8
22	Washer 10	32
23	Spring Washer 16	8
24	Nut M8	8
25	Nut M10	16
26	Nut M16	16

Record Product's Serial Number Here: _____

Note: If product has no serial number, record month and year of purchase instead.

Note: Some parts are listed and shown for illustration purposes only, and are not available individually as replacement parts.

PARTS LIST & ASSEMBLY DIAGRAM

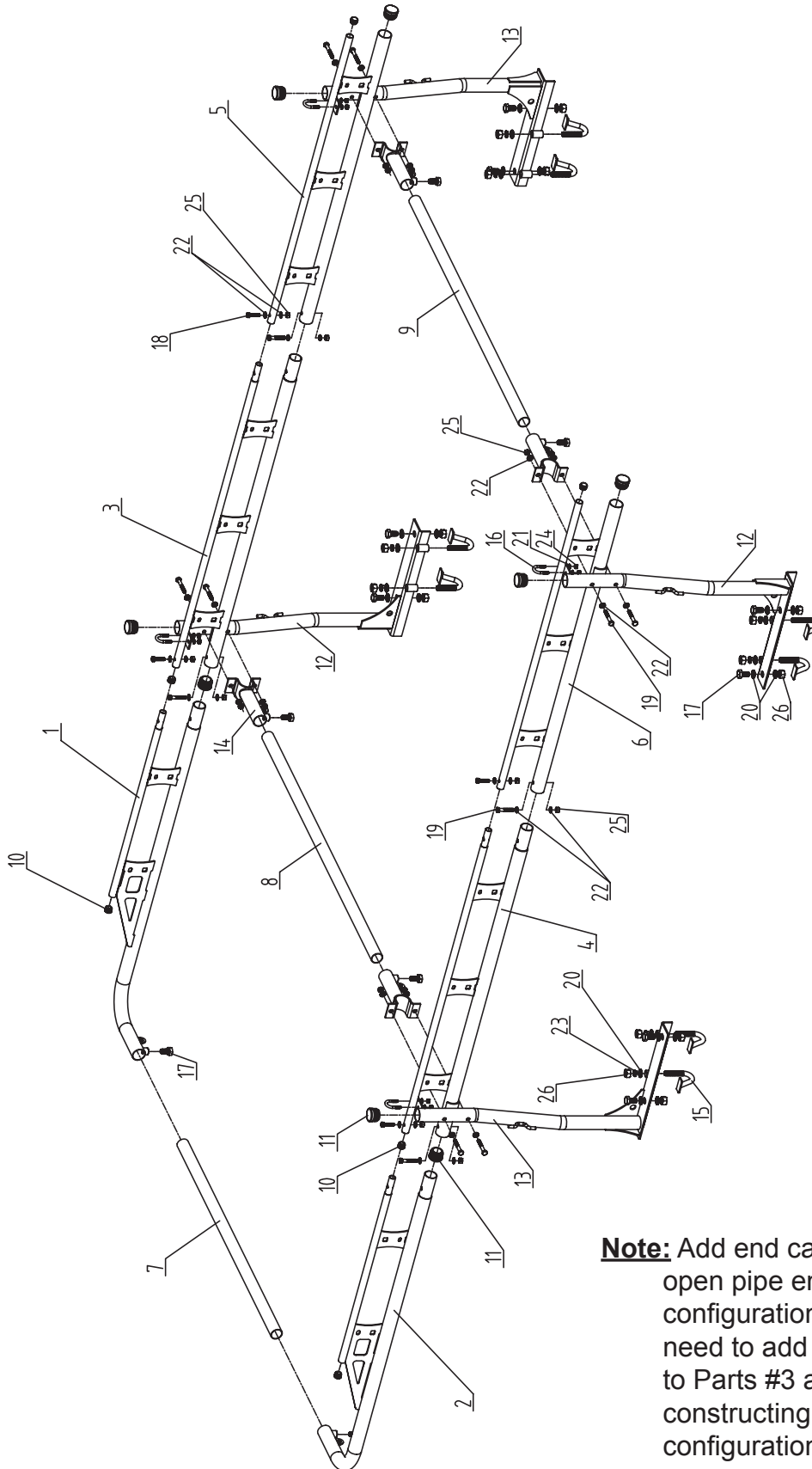

Note: Add end caps only to open pipe ends of finished configuration. You will not need to add end caps to Parts #3 and #4 if constructing the over-cab configuration.

LIMITED 90 DAY WARRANTY

Harbor Freight Tools Co. makes every effort to assure that its products meet high quality and durability standards, and warrants to the original purchaser that this product is free from defects in materials and workmanship for the period of 90 days from the date of purchase. This warranty does not apply to damage due directly or indirectly, to misuse, abuse, negligence or accidents, repairs or alterations outside our facilities, criminal activity, improper installation, normal wear and tear, or to lack of maintenance. We shall in no event be liable for death, injuries to persons or property, or for incidental, contingent, special or consequential damages arising from the use of our product. Some states do not allow the exclusion or limitation of incidental or consequential damages, so the above limitation of exclusion may not apply to you. THIS WARRANTY IS EXPRESSLY IN LIEU OF ALL OTHER WARRANTIES, EXPRESS OR IMPLIED, INCLUDING THE WARRANTIES OF MERCHANTABILITY AND FITNESS.

To take advantage of this warranty, the product or part must be returned to us with transportation charges prepaid. Proof of purchase date and an explanation of the complaint must accompany the merchandise. If our inspection verifies the defect, we will either repair or replace the product at our election or we may elect to refund the purchase price if we cannot readily and quickly provide you with a replacement. We will return repaired products at our expense, but if we determine there is no defect, or that the defect resulted from causes not within the scope of our warranty, then you must bear the cost of returning the product.

This warranty gives you specific legal rights and you may also have other rights which vary from state to state.

3491 Mission Oaks Blvd. • PO Box 6009 • Camarillo, CA 93011 • (800) 444-3353

Free Manuals Download Website

<http://myh66.com>

<http://usermanuals.us>

<http://www.somanuals.com>

<http://www.4manuals.cc>

<http://www.manual-lib.com>

<http://www.404manual.com>

<http://www.luxmanual.com>

<http://aubethermostatmanual.com>

Golf course search by state

<http://golfingnear.com>

Email search by domain

<http://emailbydomain.com>

Auto manuals search

<http://auto.somanuals.com>

TV manuals search

<http://tv.somanuals.com>