

LUX LIGHT METER

MODEL 91194

OPERATING INSTRUCTIONS



3491 Mission Oaks Blvd., Camarillo, CA 93011
Visit our Web site at <http://www.harborfreight.com>

Copyright© 2004 by Harbor Freight Tools®. All rights reserved. No portion of this manual or any artwork contained herein may be reproduced in any shape or form without the express written consent of Harbor Freight Tools.

For technical questions, please call 1-800-444-3353.

PRODUCT SPECIFICATIONS

Item	Description
Electrical Requirements	One 9-Volt Battery (Not Included)
Display	3-1/2 Digit with a Maximum Display Reading of 1999
Measuring Range	1 ~ 2,000, 20,000, 50,000 Lux
Repeatability	±2%
Overrange Display	The Highest Display Digit "1"
Accuracy	±4% Reading ±0.5% Full-Scale ±4% Reading ±5 digit (10,000 -50,000 Lux) ±5% Reading ±10 digit (50,000+ Lux)
Measuring Rate	2.0 times/sec.
Photo Detector	One Silicon Photo Diode
Temperature Characteristic	±0.1%/°C
Accessories	Carrying Case
Weight	0.7 Pounds

SAVE THIS MANUAL

You will need this manual for the safety warnings and precautions, assembly, operating, inspection, maintenance and cleaning procedures, parts list and assembly diagram. Keep your invoice with this manual. Write the invoice number on the inside of the front cover. Keep this manual and invoice in a safe and dry place for future reference.

UNPACKING

When unpacking, check to make sure all the parts shown in this manual and the carrying case are included. If any parts are missing or broken, please call Harbor Freight Tools at the number shown on the cover of this manual as soon as possible.

GENERAL SAFETY WARNINGS AND PRECAUTIONS

- Check for damaged parts.** Before using this product, carefully check that it will operate properly and perform its intended function. Check for damaged parts and any other conditions that may affect the operation of this product.
NOTE: Individual replacement parts are not available for this product.
- Maintain this product with care.** Keep this product clean and dry when in use and during storage for better product performance. Service and maintenance should be performed regularly by a qualified technician. When in use, the Photo Detector (5) (white sphere) must be kept clean.

3. **Use the right product for the job.** There are certain applications for which this product was designed. Do not modify this product, and do not use this product for a purpose for which it was not intended.
4. **Maintain labels and nameplates on this product.** These carry important information. If unreadable or missing, contact Harbor Freight Tools for a replacement.
5. **Do not use this product in excessive heat and humidity conditions.**
6. **Do not allow children to handle this product.** This product is constructed with small parts that may pose a serious choking hazard if swallowed.
7. **WARNING!** The warnings, precautions, and instructions discussed in this manual cannot cover all possible conditions and situations that may occur. The operator must understand that common sense and caution are factors, which cannot be built into this product, but must be supplied by the operator.

OPERATING INSTRUCTIONS

NOTE: For additional references to the parts listed in the following pages refer to **Figure A**, below.

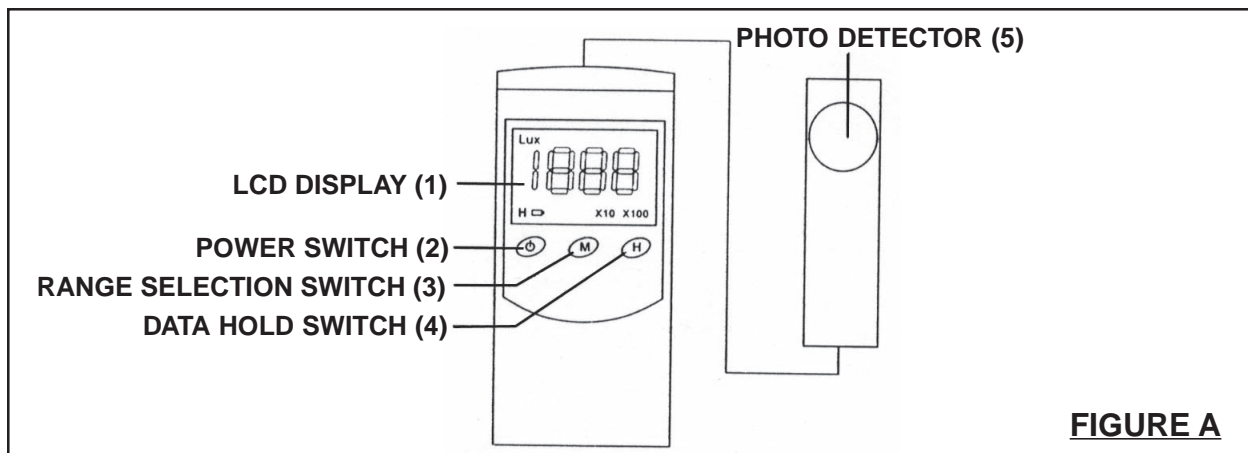

1. Press the Power Switch (2) to turn the Light Meter "ON". Press the Power Switch again to turn the Light Meter "OFF". **(See Figure A.)**
2. Press the Range Selection Switch (3) to select between the ranges of 1 ~ 2,000/ 20,000/50,000(200,000) Lux. At the same time, the LCD Display (1) will indicate the value by which to multiply to receive the correct value. **(See Figure A.)**

3. Face the Photo Detector (5) in a horizontal position toward the light source. **(See Figure A, previous page.)**
4. Read the number on the LCD Display (1). If the LCD Display only shows “1”, the input signal is too strong and a higher measuring range should be selected. **(See Figure A.)**
5. Press the Data Hold Switch (4) and “H” will illuminate on the LCD Display (1). The most recent value will continue to show on the LCD until the Power Switch (2) is pressed or the Data Hold Switch is pressed again. **(See Figure A.)**
6. After completing the measurement, make sure the Light Meter is turned “OFF” and the Photo Detector (5) is covered. Then, store the unit in its Carrying Case. **(See Figure A.)**

TO REPLACE THE BATTERY

When the 9 volt Battery (not included) becomes low, the letters “BT” will illuminate on the LCD Display (1). To replace the Battery, remove the Screw on the Battery Compartment Door located on the back of the Light Meter. Then remove the Battery Compartment Door by sliding it down. Remove the old Battery. Install a new 9 volt Battery. Then, replace the Battery Compartment Door and the Screw. **(See Figure B.)**

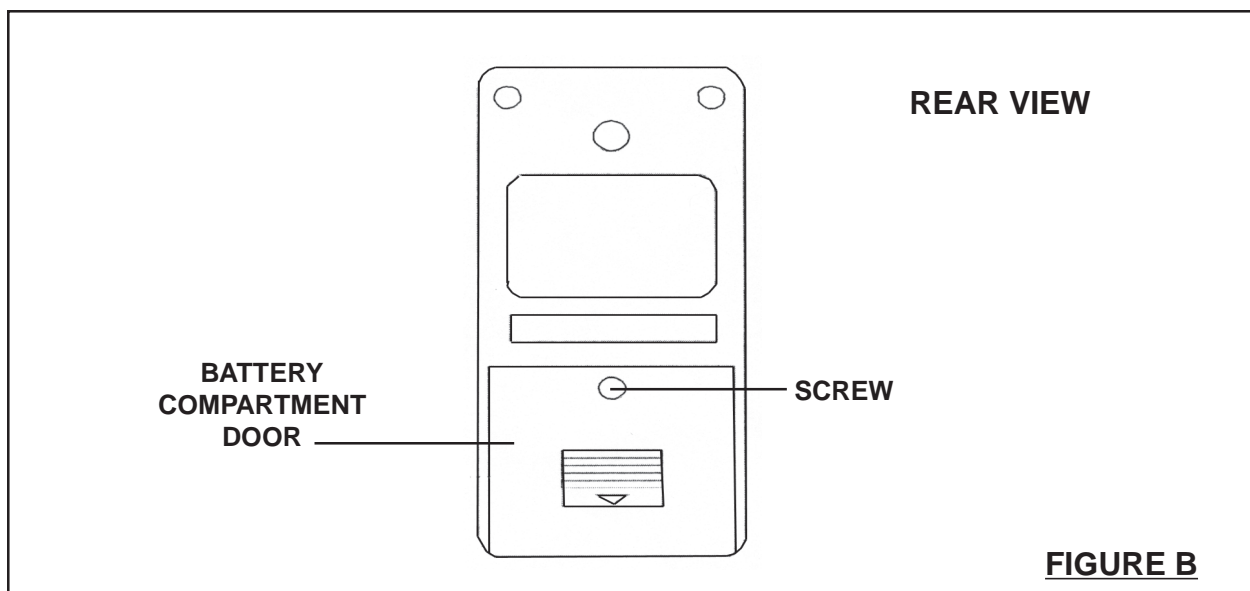

SPECTRAL SENSITIVITY CHARACTERISTICS

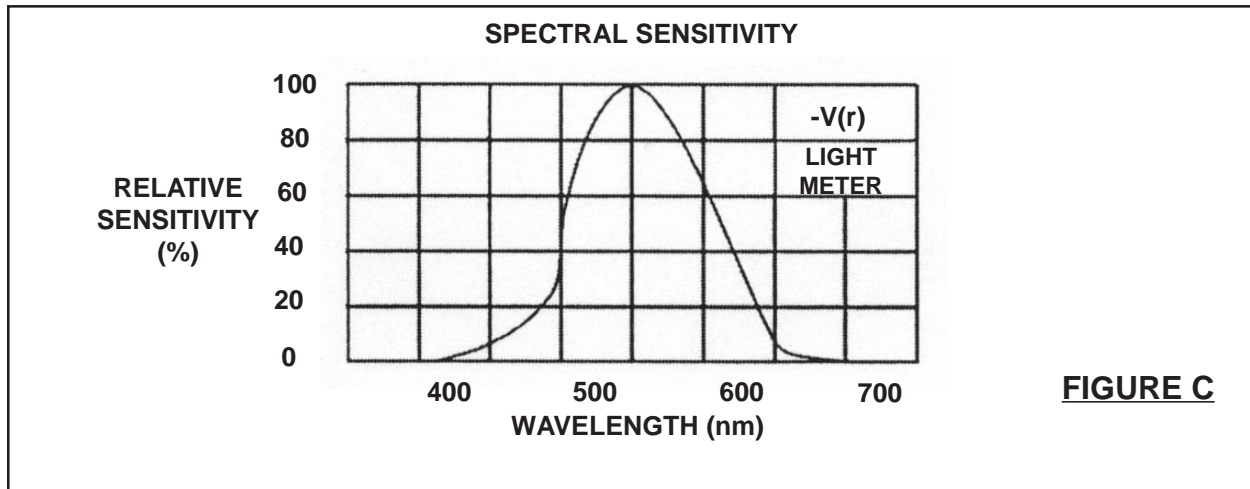

INSPECTION, MAINTENANCE, AND CLEANING

1. **Before each use**, inspect the general condition of the Light Meter. Check for broken, loose or missing parts; low Battery; any condition that may affect the proper operation of the product. If a problem occurs, have the problem corrected before further use. **Do not use damaged equipment.**
2. **Do not use abrasives or solvents to clean this product.**

Please Note:

While the manufacturer has made every effort to ensure this is a reliable and accurate tool, neither Harbor Freight Tools nor the manufacturer can be held responsible for any errors in lighting placement/adjustment; the costs of any wasted film, time, etc.; or any other costs incidental to any errors in measurement.

NOTE: No individual replacement parts are available for this product.

Free Manuals Download Website

<http://myh66.com>

<http://usermanuals.us>

<http://www.somanuals.com>

<http://www.4manuals.cc>

<http://www.manual-lib.com>

<http://www.404manual.com>

<http://www.luxmanual.com>

<http://aubethermostatmanual.com>

Golf course search by state

<http://golfingnear.com>

Email search by domain

<http://emailbydomain.com>

Auto manuals search

<http://auto.somanuals.com>

TV manuals search

<http://tv.somanuals.com>