

FCC STATEMENT

This device complies with part 15 of the FCC Rules. Operation is subject to the following two conditions: (1) This device may not cause harmful interference, and (2) this device must accept any interference received, including interference that may cause undesired operation.

This equipment has been tested and found to comply with the limits for a Class B digital device, pursuant to part 15 of the FCC Rules. These limits are designed to provide reasonable protection against harmful interference in a residential installation. This equipment generates, uses and can radiate radio frequency energy, and, if not installed and used in accordance with the instructions, may cause harmful interference to radio communications. However, there is no guarantee that interference will not occur in a particular installation. If this equipment does cause harmful interference to radio or television reception, which can be determined by turning the equipment off and on, the user is encouraged to try to correct the interference by one or more of the following measures:

- Reorient or relocate the receiving antenna.
- Increase the separation between the equipment and the receiver.
- Consult the dealer or an experienced radio/TV technician for help.

Changes or modifications to this unit not expressly approved by the party responsible for compliance could void the user's authority to operate the equipment.



OVER 12 months
08478/08479

**Thank you for purchasing
this PLAYSKOOL product!**

Busy Gears™

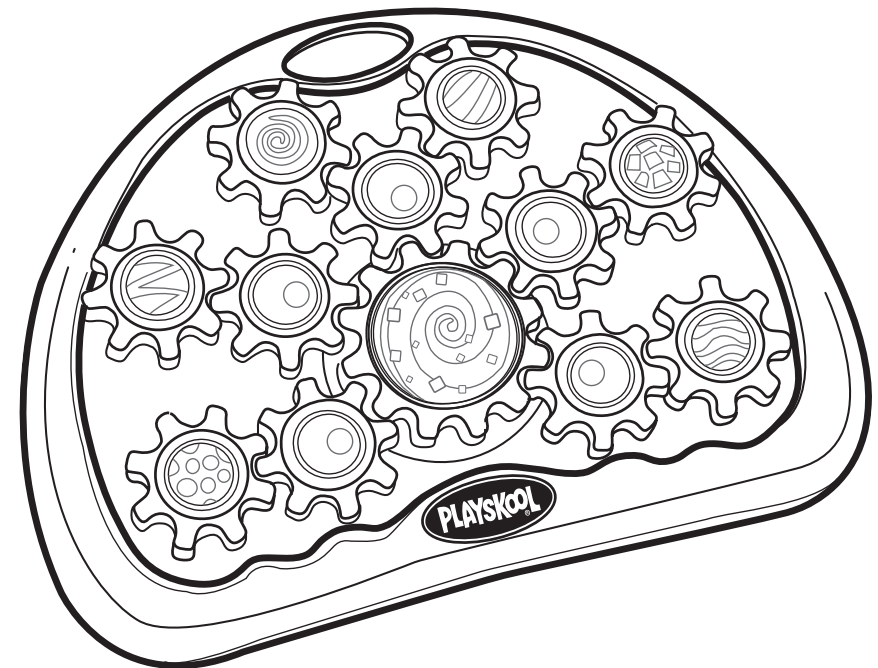

© 2005 Hasbro. All Rights Reserved.
TM & ® denote U.S. Trademarks
08478/08479 P/N 6493970000

Batteries included.

Replace with 3 x 1.5V "AA" or R6 size batteries. Alkaline batteries recommended. Phillips/cross head screwdriver (not included) required for battery replacement.

PLAYSKOOL®

ADULT PLEASE NOTE: THIS TOY IS SHIPPED IN "DEMO" MODE. MOVE SWITCH ON BACK OF TOY TO "PLAY" POSITION BEFORE USING AT HOME.

TO PLAY

•This toy features 11 removable gears for lots of hands-on, developmental play for toddlers!

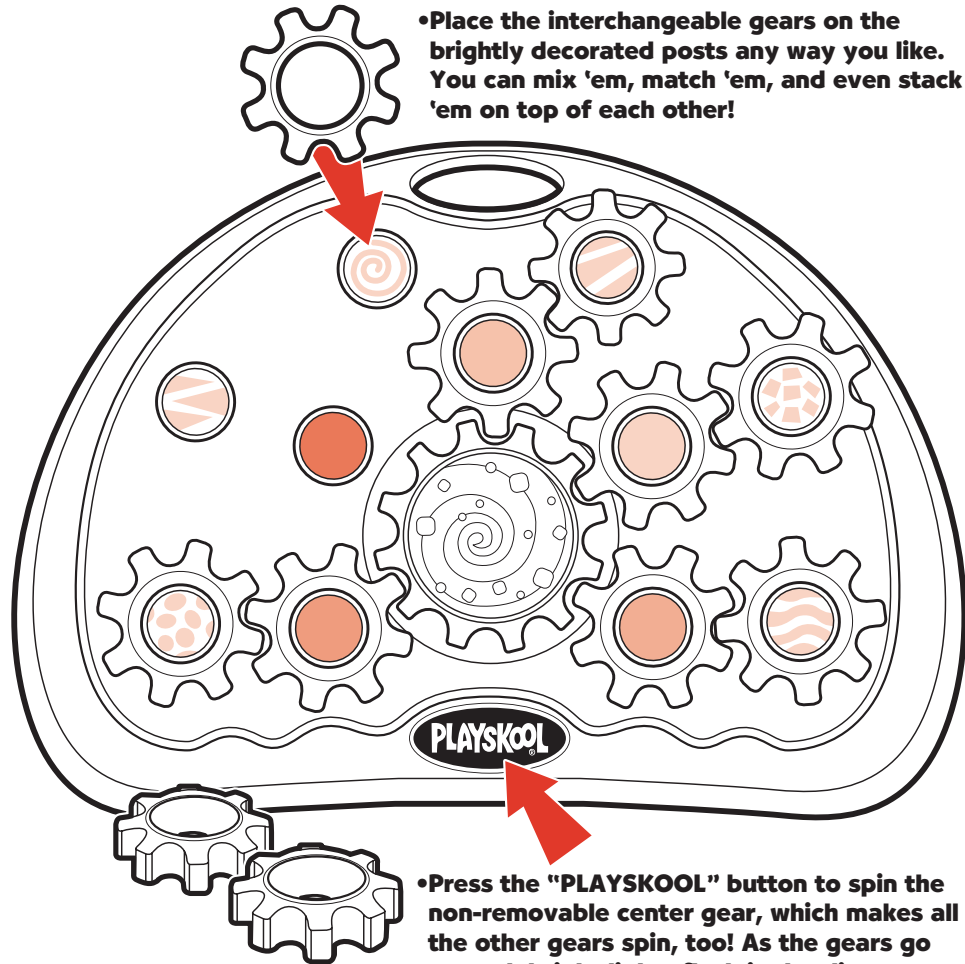

•Place the interchangeable gears on the brightly decorated posts any way you like. You can mix 'em, match 'em, and even stack 'em on top of each other!

•Press the "PLAYSKOOL" button to spin the non-removable center gear, which makes all the other gears spin, too! As the gears go around, bright lights flash in dazzling patterns and toddler will hear happy music and fun sounds!

Note: Gears must be linked to the center gear to spin.

•You can also stack the gears, sort them by color (color matching game), or count them with your child!

•To prevent accidental activation when storing the toy, move the switch on the back of the toy to the "OFF" position.

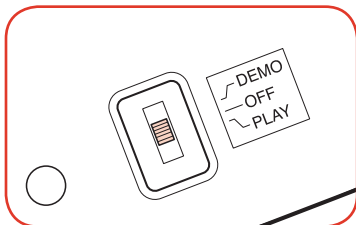

TO REPLACE BATTERIES

Use a Phillips/cross head screwdriver (not included) to loosen screw in battery compartment door (screw stays attached to door). Remove door. Remove and discard old batteries. Replace with 3 fresh 1.5V "AA" or R6 size batteries. Alkaline batteries recommended. Replace door and tighten screw.

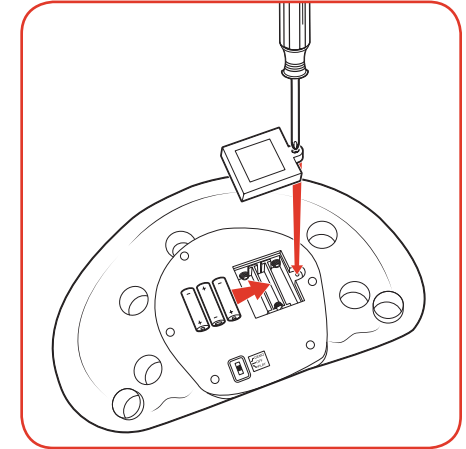

⚠ CAUTION: TO AVOID BATTERY LEAKAGE

1. Be sure to insert the batteries correctly and always follow the toy and battery manufacturers' instructions;
2. Do not mix old and new batteries or alkaline, standard (carbon-zinc) or rechargeable (nickel-cadmium) batteries;
3. Always remove weak or dead batteries from the product.

IMPORTANT: BATTERY INFORMATION

Please retain this information for future reference.

Batteries should be replaced by an adult.

⚠ CAUTION:

1. Always follow the instructions carefully. Use only batteries specified and be sure to insert item correctly by matching the + and - polarity markings.
2. Do not mix old batteries and new batteries or standard (carbon-zinc) with alkaline batteries.
3. Remove exhausted or dead batteries from the product.
4. Remove batteries if product is not to be played with for a long time.
5. Do not short circuit the supply terminals.
6. Should this product cause, or be affected by, local electrical interference, move it away from other electrical equipment. Reset (switching off and back on again or removing and re-inserting batteries) if necessary.
7. RECHARGEABLE BATTERIES: Do not mix these with any other types of battery. Always remove from the product before recharging. Recharge batteries under adult supervision. DO NOT RECHARGE OTHER TYPES OF BATTERIES.

Free Manuals Download Website

<http://myh66.com>

<http://usermanuals.us>

<http://www.somanuals.com>

<http://www.4manuals.cc>

<http://www.manual-lib.com>

<http://www.404manual.com>

<http://www.luxmanual.com>

<http://aubethermostatmanual.com>

Golf course search by state

<http://golfingnear.com>

Email search by domain

<http://emailbydomain.com>

Auto manuals search

<http://auto.somanuals.com>

TV manuals search

<http://tv.somanuals.com>