

TO PLAY

The WEEBALOT CASTLE has all kinds of fun activities that make playtime exciting and interactive! Here are a few play suggestions:

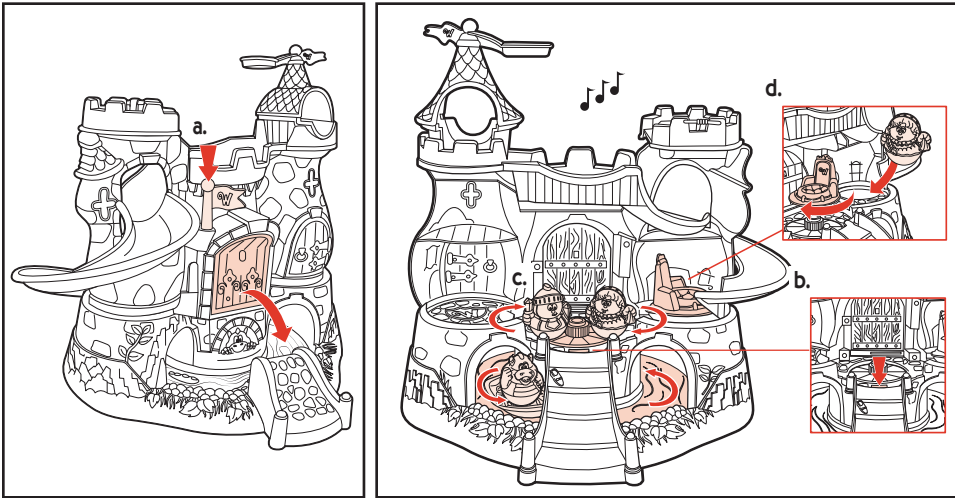

NOTE: To enable full play, locate the ON/OFF switch on the bottom of the toy and turn "ON."

- Press the flag down to lower the drawbridge, play fun music and sounds and to make the moat and dance floor turn! **NOTE:** Raise the drawbridge manually and click back into place to reset.
- Press the button on the top of the stairway to play a different set of songs and sounds and also to make the moat and dance floor turn!
- Place WEEBLES figures on the dance floor and watch them do the WEEBLES waltz!
- Slide WEEBLES figures down the silly slide and onto the throne or slide the throne to the side and the WEEBLES figures can drop into a hidden passage!
- Read the exciting tale in the story board book (included) and "relive" the adventure with the castle and your WEEBLES figures!

NOTE: When not in use, turn the toy "OFF" to conserve battery life.

FCC STATEMENT

This equipment has been tested and found to comply with the limits for a Class B digital device, pursuant to part 15 of the FCC Rules. These limits are designed to provide reasonable protection against harmful interference in a residential installation. This equipment generates, uses and can radiate radio frequency energy, and, if not installed and used in accordance with the instructions, may cause harmful interference to radio communications. However, there is no guarantee that interference will not occur in a particular installation. If this equipment does cause harmful interference to radio or television reception, which can be determined by turning the equipment off and on, the user is encouraged to try to correct the interference by one or more of the following measures:

- Reorient or relocate the receiving antenna.
- Increase the separation between the equipment and the receiver.
- Consult the dealer or an experienced radio/TV technician for help.

Visit



© 2006 Hasbro. All Rights Reserved.
TM & ® denote U.S. Trademarks
08625 P/N 6583800000

Download from Www.Somanuals.com. All Manuals Search And Download.

OVER 18 months

08625

PLAYSKOOL

Weebalot Castle™

Weebles
Storybook World
Weebles wobble, but they don't fall down!



Includes castle (2 pieces), roof/slide top, slide bottom, 4 WEEBLES figures, 1 boat, 1 bed, 1 chair, 1 round table, 1 throne, 1 staircase, 1 draw-bridge ramp, 1 wobbly turret, 1 lookout turret and 1 story board book.

3x
1.5v C or R14 size
**BATTERIES
REQUIRED**

Phillips/cross head screwdriver
(not included) required for
battery replacement. Alkaline
batteries recommended.

Adult assembly required.

**Thank you for choosing this
PLAYSKOOL brand product!**

TO INSERT BATTERIES

Use a Phillips/cross head screwdriver (not included) to loosen screw in battery compartment door. Remove door. Insert 3 x 1.5V "C" or R14 size batteries. Alkaline batteries recommended. Replace door and tighten screws.

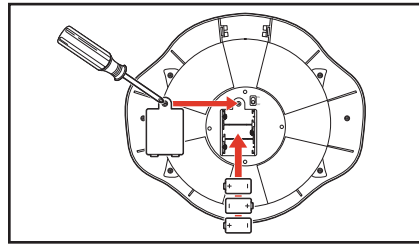

⚠ CAUTION: TO AVOID BATTERY LEAKAGE

- 1) Be sure to insert the batteries correctly and always follow the toy and battery manufacturers' instructions.
- 2) Do not mix old and new batteries or alkaline, standard (carbon-zinc) or rechargeable (nickel-cadmium) batteries.
- 3) Always remove weak or dead batteries from the product.

IMPORTANT: BATTERY INFORMATION

Please retain this information for future reference.
Batteries should be replaced by an adult.

⚠ CAUTION:

1. Always follow the instructions carefully. Use only batteries specified and be sure to insert them correctly by matching the + and - polarity markings.
2. Do not mix old batteries and new batteries or standard (carbon-zinc) with alkaline batteries.
3. Remove exhausted or dead batteries from the product.
4. Remove batteries if product is not to be played with for a long time.
5. Do not short circuit the supply terminals.
6. Should this product cause, or be affected by, local electrical interference, move it away from other electrical equipment. Reset (switching off and back on again or removing and re-inserting batteries) if necessary.
7. **RECHARGEABLE BATTERIES:** Do not mix these with any other types of battery. Always remove from the product before recharging. Recharge batteries under adult supervision. **DO NOT RECHARGE OTHER TYPES OF BATTERIES.**

TO ASSEMBLE

There are several easy assembly steps you'll need to follow to get started:

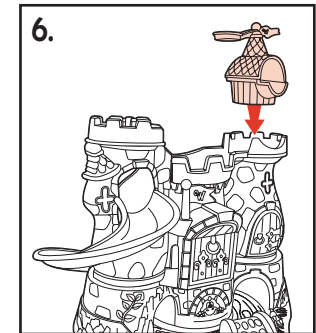
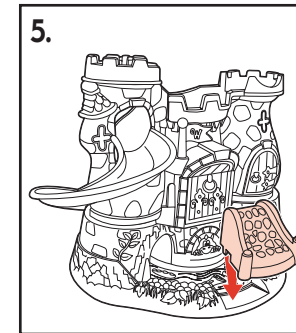
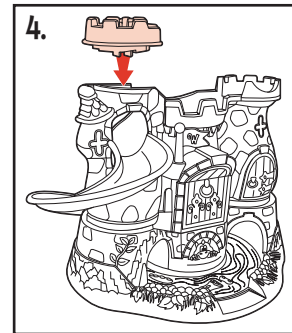
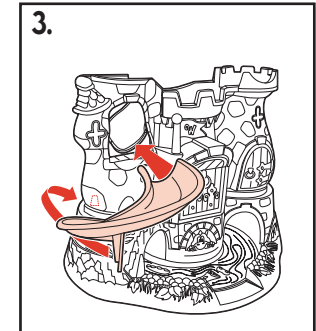
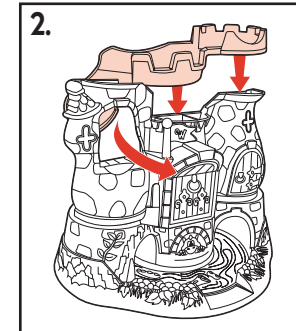
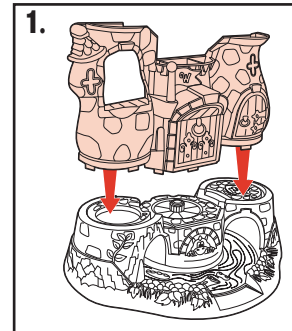

1. Snap the castle front into the castle base as shown.
2. Snap the roof/slide to the castle front as shown.
3. Snap the slide to the points on the castle front and the castle base as shown.
4. Snap the wobbly turret to the castle front as shown.

NOTE: To test whether the piece is secure, pull lightly on the turret. If the turret remains in place, it is secure. If it can be removed easily, push the turret into place again with increased pressure until both tabs lock.

5. Attach the drawbridge ramp to the front of the castle base as shown.
6. Place the lookout turret on top of the castle as shown.
7. Snap the throne to the back of the castle base as shown.
8. Attach the staircase to the rear of the castle base as shown.

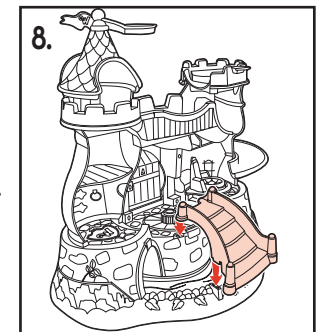
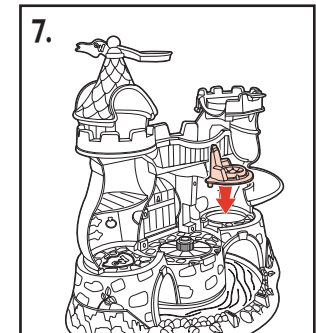

Free Manuals Download Website

<http://myh66.com>

<http://usermanuals.us>

<http://www.somanuals.com>

<http://www.4manuals.cc>

<http://www.manual-lib.com>

<http://www.404manual.com>

<http://www.luxmanual.com>

<http://aubethermostatmanual.com>

Golf course search by state

<http://golfingnear.com>

Email search by domain

<http://emailbydomain.com>

Auto manuals search

<http://auto.somanuals.com>

TV manuals search

<http://tv.somanuals.com>