



Installation and User Handbook

Freestanding Frost Free Freezer Model FZ92P

**It is essential that you read through this instruction book carefully
before you first use your appliance.**

Contents

	Page
Electrical Supply	3
Get to know your Appliance / Checklist / How Frost Free Works	4
Installation	5
Door Reversal	6
The Controls	7
Storing Food	8
Caring for your Appliance	9
Troubleshooting	10
Service Cover / Guarantee	11
Key Contacts	Back Cover

For details of spares, service and guarantee see separate service leaflet.

Retention of the Instruction Book

This Instruction Book must be kept handy for reference as it contains important details on the safe and proper use of the appliance.

If you sell or pass the appliance to someone else, or move house and leave it behind, make sure this Book is also provided so the new owner can become familiar with the appliance and safety warnings.

Technical Safety

The refrigerant R600a is environmentally friendly but flammable, take care not to damage the refrigerant circuit pipes. If refrigerant does escape, immediately ensure that the area is well ventilated.

Do not use electrical appliances; i.e. ice makers, inside the appliance.

In the event that the appliance is damaged, contact the supplier immediately before connecting to the mains.

To guarantee safe operation, ensure that the appliance is set up and connected as described in these operating instructions, and that any repairs and work on the appliance are only carried out by an authorised service office.

Disposal Notes:

The packaging is designed to protect the appliance and individual components during transport and is made of recyclable materials.

Corrugated board/board

Moulded polystyrene (foamed, CFC-free polystyrene).

Polythene bags and sheets

Polypropylene straps

Keep packaging materials away from children - polythene sheets and bags can suffocate!

Please return packaging material to your nearest official collection point so that the various materials can be reused or recycled as far as possible.

Ensure that the refrigerant circuit is not damaged, before the appliance that is no longer needed is taken away for disposal. In this way the refrigerant will not escape into the environment.

Exact details of the refrigerant used can be found on the type plate. The heat insulator is PU with Pentane.

Information on collection dates or collection points can be obtained from the waste disposal authorities or local council.

**WARNING: AVOID ACCIDENTS TO CHILDREN. WHEN DISCARDING AN OLD FRIDGE OR FREEZER BE CERTAIN TO MAKE THE LOCK UNUSABLE. IF POSSIBLE, REMOVE THE DOOR AND DISCARD SEPERATELY.
DO NOT ATTEMPT TO SIT ON TOP OF YOUR APPLIANCE. IT IS NOT DESIGNED FOR SUCH USE AND YOU COULD INJURE YOURSELF OR DAMAGE THE APPLIANCE BY SUCH ABUSE.**

Electrical Supply

WARNING: This appliance must be earthed.

Fuses

Your appliance comes fitted with a plug and a 13A fuse. If you need to replace the fuse, only those rated at 13A and ASTA approved to BS1362 should be used. If you lose the fuse cover, a replacement may be obtained from your local Electricity company.

Correct replacement is identified by colour coding or the marking on base of plug.

WARNING: Do not use plug unless fuse cover is fitted.

Changing the Plug

Cut off and dispose of the supplied plug if it does not fit your socket.

WARNING: To avoid a shock hazard do not insert the discarded plug into a socket anywhere else.

IMPORTANT: WIRES IN THE MAINS LEAD ARE COLOURED IN ACCORDANCE WITH THE FOLLOWING CODE:

Green/Yellow	-	Earth
Blue	-	Neutral
Brown	-	Live

If you change the plug, the colour of wires in the mains lead may not correspond with the colour of the markings identifying terminals in the plug. You should therefore wire it as shown.

Green and yellow (Earth) wire to terminal marked 'E', symbol \oplus or coloured green and yellow.

Blue (Neutral) wire to terminal marked 'N' or coloured black.

13A ASTA approved fuse to BS1362.

Brown (Live) wire to terminal marked 'L' or coloured red.

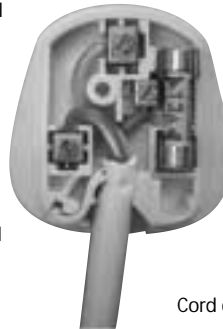

Cord clamp

Changing the Mains Lead

A special lead can be ordered from our Service Department UK: 08709 066 066 or Republic of Ireland: 1850 302 200

If you have damaged the existing lead or require a longer one a charge will be made. It is strongly advised that this work is carried out by a qualified electrician.

CE marking certifies that this appliance conforms to the following EEC directives:-



Low Voltage Equipment - 72/23/EEC & 93/68 EEC

Electromagnetic Compatibility - 89/336/EEC, 92/31/EEC & 93/68/EEC

Door Reversal

WARNING: Switch off electrical supply and pull out mains plug.

If you need to change the door opening side, lower the appliance onto its back and follow the pictorial instructions below, **in numerical order**, to ensure doors function properly.

Note: You may require assistance to carefully lay the appliance onto its back, onto a suitable protective material (ie. the original packaging).

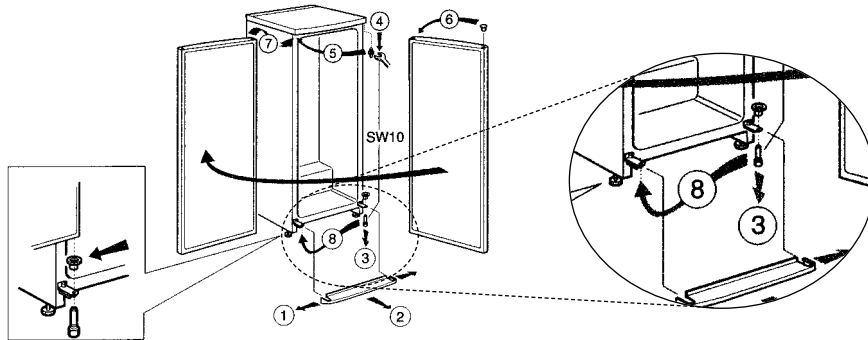

Insert the open door into the door bearing (A)
IMPORTANT: The door journal (B) must be in front of the door switch (C)

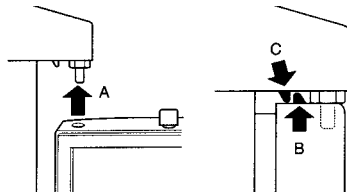

Changing the door handle

Follow the pictorial instruction below, **in numerical order**:

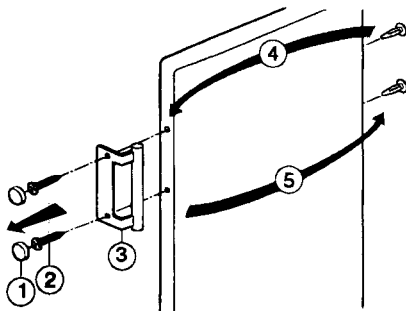

Attaching the base panel

The base panel (1) is enclosed with the appliance and can be found, either within the appliance itself or at the rear of the condenser (black grille).

- Slide the base panel (1) onto the plastic guides (2), until it locks into position.

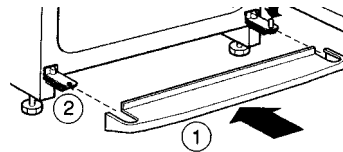

Alternatively you may wish our Service Department to quote for an Engineer to carry out the conversion for you, call UK: 08709 066 066 or Republic of Ireland: 1850 302 200

Installing your Appliance

Where to put your appliance.

Climatic Class can be found on the Rating Plate and this specifies the ambient temperatures at which the appliance may be operated.

Climatic Class	Permitted Ambient Temperature
SN	+10°C to 32°C
ST	+18°C to 38°C

Avoid locating near anything which gives off heat, a cooker or radiator for example or in a position where sunlight is liable to shine directly onto the appliance. In such a position your appliance will have to work harder and will cost more to run and may be damaged by the heat.

If installation next to a heat source is unavoidable, use a suitable insulating plate, or comply with the following minimum distances:

3cm to an electric cooker,
30cm to an oil or coal-fired cooker.

If the appliance is installed next to another freezer or refrigerator, observe a minimum distance of 2cm between the appliances to prevent condensation.

Appliances with handles must be positioned 55mm, from the wall on the hinge side, so that the door can be opened by 90°.

Make sure that the electrical socket is easily accessible, the best position is at the side of or above the appliance.

Air Circulation

The heated air must be able to escape through the rear of the appliance. If the air flow is obstructed, the refrigerating unit must work harder, which increases the power consumption. Therefore NEVER cover the ventilation slots.

Adjusting the Feet

Note: An unsteady appliance can cause problems.

The height adjustable feet have been fully screwed in at the factory. When installing the appliance use a screwdriver to adjust the feet. Unscrew the feet initially by 5mm, place the appliance in its final position and continue to adjust the feet until the appliance is standing firm and is level (use a spirit level to check).

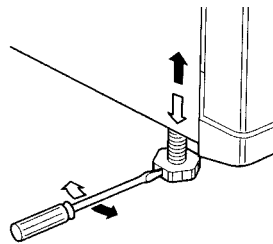

Securing the Appliance

Once in its final position and level, the appliance must be fixed to the wall to prevent it from tilting forward.

- Place the metal lug (2) on the left or right side of the air grid and mark the fixing hole on the wall.
- Drill the hole and insert a wall plug (1).
- Insert the metal lug (2) into the air grid and screw to the wall (3).

(Size 5 wall plugs and screws are available from DIY stores).

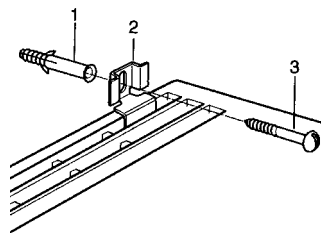

Clean before Using

We recommend before using your appliance that you clean the interior and exterior (see page 9).

Final check

Before you start using your appliance, check:

1. It is thoroughly dry inside,
2. Air can circulate freely,
3. The feet have been adjusted, ie. all four are firmly on the ground

Get to know your Appliance

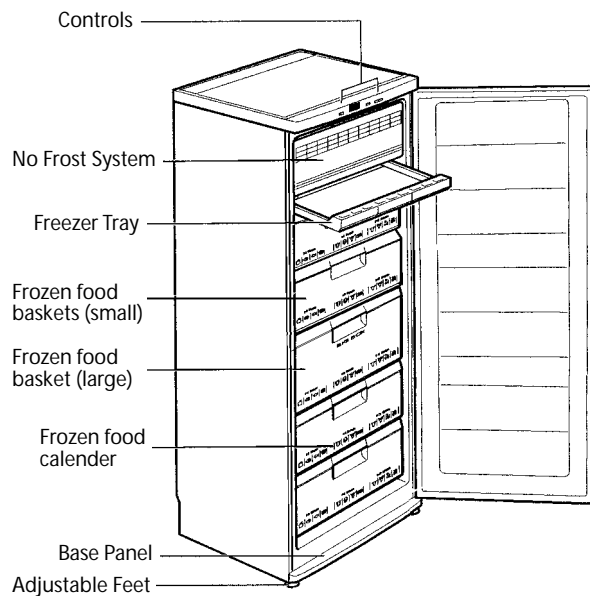

Maximum Freezer Capacity:

Food should be frozen right through as quickly as possible. Only in this way are vitamins, nutritional values, appearance and taste retained.

Therefore, you should not exceed the maximum freezing capacity of the appliance.

The following quantities of food may be frozen at any one time:

20kg / 24h

CHILDREN SHOULD NOT BE ALLOWED TO PLAY WITH THE APPLIANCE OR TAMPER WITH THE CONTROLS

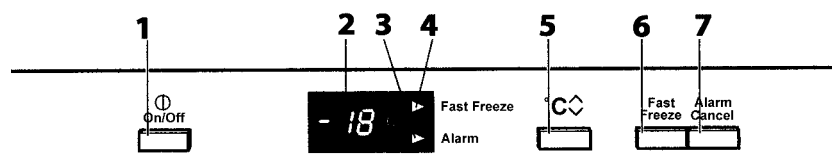

Control Panel...

- | | | | |
|---|-----------------------|---|------------------------------|
| 1 | Mains On / Off Switch | 5 | Temperature Selection Button |
| 2 | Temperature Display | 6 | Fast Freeze Button |
| 3 | The 'Alarm' Display | 7 | Alarm Cancel Button |
| 4 | Fast freeze Display | | |

The Controls

WARNING: Appliances must NOT be placed in a room where the temperature goes below the minimum or above the maximum specified, for prolonged periods (see page 5).

WARNING: When checking temperatures DO NOT use a mercury filled thermometer as breakage would cause a health hazard.

Leave the appliance to stand upright in its required location for at least 15 minutes before you plug in and switch on the electricity supply.

WARNING: Ensure the mains cable is not trapped underneath or behind the appliance. Plug in and switch on...

- Press the mains on/off switch (1). The warning tone sounds and the temperature display (2) flashes, the alarm display (3) illuminates.
- Press the Alarm Cancel button. The warning tone is cancelled and the temperature display (2) stops flashing.

At internal cabinet temperatures warmer than +19°C, "-" is displayed. Only at lower temperatures are the values displayed with "°C".

The appliance left the factory with a pre-set temperature of -18°C.

Pre-set temperatures can be altered by following instructions under, 'Temperature Selection Button'.

Note: When the operating temperature is reached, the alarm display (3) will go out.

Running-in the Compressor

Your appliance is operated by a compressor, which maintains the appliances internal temperature. For the first two months the compressor has to work a little harder and may result in more noise than usual.

Whether the compressor is running or not, it is normal to hear sounds created by the liquid and gases sealed within the refrigeration system

Temperature Display (2):

(displays 3 different temperatures)

- a. **Current temperature in the freezer compartment**, without any buttons having been pressed.
- b. When Temperature Selection Button (5) is pressed, the **temperature selection for the freezer compartment** is displayed for five

seconds. Then the 'current temperature in the freezer compartment' is redisplayed.

- c. If the temperature display (2) flashes, the freezer compartment became too warm. When the Alarm Cancel button is pressed, the **warmest temperature reached in the freezer compartment** is displayed for five seconds. The display will then return to show the 'current temperature in the freezer compartment', without flashing.

The Alarm Display (3):

This will illuminate and the warning tone sounds simultaneously when it becomes too warm in the freezer compartment.

It will go out when the freezer compartment has reached its operational temperature.

Fast Freeze Display (4):

This will only illuminate when 'Fast Freeze' is on.

°C ♦ Temperature Selection Button (5):

Setting the temperature in the freezer compartment:

- Press the temperature selection button (5). The pre-set temperature is displayed for five seconds in the temperature display (2).
- Press the temperature selection button (5) repeatedly until the desired temperature is displayed. The value last selected is stored.

(The temperature selection is displayed consecutively from -18°C to -26°C, returning to -18°C after -26°C).

Fast Freeze Button (6):

Switches 'Fast Freeze' on and off. Fast Freeze Display (4) indicates that 'Fast Freeze' is on.

Alarm Cancel Button (7):

Press to stop Temperature Display (2) flashing and cancel any warning tones:

- when the appliance is first switched on.
- if it becomes too warm in the freezer compartment, ie. frozen food could begin to thaw.
- when large quantities of fresh food are placed in the appliance.
- if the door has been left open for too long.

Also, when pressed, the warmest temperature reached in the freezer compartment is shown in the temperature display (2).

Storing Food

Your appliance has been designed for the storage of edible foodstuffs only, do not use to store poisonous, flammable or dangerous substances.

To ensure your appliance operates as efficiently as possible:

- Avoid opening the doors unnecessarily or for longer than needed.
- Allow hot or warm food to cool down before placing in the appliance, as placing hot food in the appliance reduces efficiency.
- Follow packaging "best by/use by" instructions or your suppliers advice on suitable maximum storage time.
- Pack foods airtight, to retain moisture and prevent flavour / odour transference. Plastic bags, aluminium foil, plastic stretch wrap and containers with lids are ideal.

Storing Food in your Freezer

Follow these recommendations when storing food in your freezer compartment:

- Freeze and store either fresh food or long term commercially frozen foods.
- Generally speaking long term storage means up to 3 months but this can vary, so always follow your supplier's recommendations otherwise refer to the pictorial guide on the drawer fronts.
- Store and defrost commercially frozen food in accordance with the instructions of the manufacturer.
- Always defrost frozen food before cooking unless instructions on the packet state otherwise.
- Refer to the storage life pictorial guides, which are on the drawer fronts, when freezing fresh food (Time in months).
- Select frozen food last when shopping, transport in a cool bag and place in the freezer compartment as soon as possible on arriving home.
- Label and date food before placing in freezer.
- Thawed food should be either cooked and eaten or re-frozen within 24 hours.
- Liquid filled bottles or sealed fizzy drinks must not be stored in the freezer or chiller compartment, as they may burst.
- Lollipops and water ices should not be given to children directly from the freezer. The low temperature may cause 'freezer burns' on their lips.
- Store ice cream towards the top of the freezer and remove from the freezer 15-30 minutes before serving.

"Fast Freeze"

Several hours before placing fresh food in the freezer compartment, Press the 'Fast Freeze' button (6)

4-6 hours is usually adequate. If the maximum freezing capacity is used, 24 hours is required.

(Small quantities of fresh food, up to 2kg, can be frozen without 'Fast Freeze').

'Fast Freeze' display (4) indicates that 'Fast Freeze' is on. After being switched on, the refrigerating unit runs constantly and the freezer compartment drops to a very low temperature.

'Fast Freeze' switched off automatically when the fresh food has frozen solid (after several hours for small quantities, no more than two days for large quantities).

Where 'Fast Freeze' is selected but no food is in the freezer, then 'Fast Freeze' will automatically cancel after 26 hours.

Freezer Drawers

Store all fresh food to be frozen and commercially frozen food in the individual baskets.

Use the large frozen food basket preferentially for the freezing and storage of larger food items, such as poultry etc.

Always make sure that the drawers have been pushed back in as far as possible, to their stop position.

Freezer Tray

The freezer tray can be used to freeze items individually, such as fruit, herbs and vegetables. Distribute the food items evenly across the freezer tray and allow to freeze for about 10 - 12 hours. When frozen place in freezer bags or containers and store in the baskets.

Ice Packs

In the event of a power failure or malfunction, refreezable ice packs delay the thawing of the frozen food being stored. This is most effectively achieved and energy consumption is minimized, by placing refreezable ice packs in the top compartment directly on the food. Refreezable ice packs can also be used to temporarily keep food cool, eg. in a cooling bag.

Caring for your Appliance

Note: With the fully automatic No-Frost system, the freezer compartment remains ice free. Defrosting is no longer necessary.

Cleaning the Interior of your Appliance

We recommend that you clean your appliance before using for the first time.

WARNING: Switch off electricity supply and pull out mains plug before cleaning.

Remove food and wrap or cover to keep it frozen.

Remove shelves, trays and baskets and wash these in warm soapy water, dry thoroughly. Wipe the freezer interior with a clean cloth wrung out in either a solution of one teaspoonful of bicarbonate of soda to one pint of water or Milton sterilising fluid, diluted according to manufacturers' instructions. Dry the interior thoroughly with a clean cloth before replacing fittings and food.

Cleaning the Door Seal

Use soap and water on a clean damp cloth to wipe along and in between the creases of the door seal, dry thoroughly.

WARNING: Do not use detergent, it will damage the door seal.

Cleaning the Exterior of your Appliance

IMPORTANT: Never use a steam cleaner. If live components come into contact with condensing steam, they may short circuit or cause an electric shock.

WARNING: Do not use any household cleaner, abrasive powders or wax polish. These not only damage the surfaces, but also leave a smell within the appliance.

Use a small amount of detergent on a clean damp cloth to wipe the exterior surface, dry thoroughly.

Use a vacuum cleaner to remove dust from underneath the appliance and around the air grille at the base to prevent it becoming blocked. You do not need to remove the air grille for cleaning.

No water should be allowed into the control panel during cleaning.

Reconnect the mains plug and switch on.

Going away

If you expect to be away and don't want to use your appliance, switch off electrical power supply and pull out the mains plug. Remove food, clean and dry the interior thoroughly.

Note: Leave doors ajar to prevent the accumulation of odours.

Spare Parts

Please remember your new appliance is a complex piece of equipment.

'DIY' repairs or unqualified and untrained service people may put you in danger, could damage the appliance and might mean you lose cover under the Parts Guarantee.

If you do experience a problem with the appliance don't take risks; call in our Service Engineer.

Our parts are designed exclusively to fit our appliances. Do not use them for any other purpose as you may create a safety hazard.

Troubleshooting.

PROBLEM...	CHECK...
The appliance won't work. None of the displays illuminate.	<ol style="list-style-type: none"> 1. Check plug is firmly positioned in wall socket and the power supply is switched on. 2. Check the power supply with another appliance. 3. Check fuse.
The appliance is making a lot of noise.	<ol style="list-style-type: none"> 1. Check that the appliance is level. 2. Is the appliance overloaded? Do Not exceed the Max. Freezer Capacity. 2. Ensure rear pipework is clear of wall and skirting board.
The freezer door is difficult to open.	A well sealed freezer door can be difficult to open. This is partly due to the difference in temperature between the room and internal compartment. If you have just closed the freezer door, it may be particularly difficult to open immediately. Wait 5 minutes for the internal and external pressure to equalise and try again.
The Alarm Display (3) illuminates, the warning tone sounds.	<p>It is too warm in the freezer compartment.</p> <p>Is there adequate air circulation? (see page 5) Check all temperature settings (see page 7) Have you observed maximum freezer capacity (see page 6) Has hot food recently been placed in the appliance? Is the air grille blocked?</p> <p>Press the Alarm Cancel button (7) to cancel the warning tone.</p>
There has been a power failure, the Temperature Display (2) is flashing.	The freezer compartment became too warm. Press the Alarm Cancel button (7) to stop the display from flashing. The warmest temperature reached in the freezer is displayed and then clears. If it displays a temperature more than +3° C, the food must be used or cooked and refrozen.
The freezer compartment door was left open for a long time and the freezer compartment no longer reaches the selected temperature.	<p>The refrigerating unit in the No-Frost system is covered in so much ice that it can no longer defrost automatically...</p> <p>Remove all stored food, wrap and place in a cool location.</p> <p>Switch off and unplug the appliance. Put a couple of bowls of hot water in baskets (on heat resistant base) and close the door. Defrost water will go into the evaporation pan at the rear of the appliance, sponge this several times to prevent overflowing.</p> <p>After about 1 hour, when all the defrost water has run into the evaporation pan, clean and thoroughly dry the interior, plug in and switch on.</p>
The display shows "E1".	The electronics are defective, call for a Service Engineer.

After Sales Service

Satisfaction Guaranteed or your money back...

Hotpoint gives you a unique 'Satisfaction Guaranteed' promise - valid for ninety days after you have purchased your Hotpoint product. If there is a technical problem with your Hotpoint appliance, call Hotpoint Service. If necessary, we will arrange for an engineer to call. If the technical problem is not resolved under this Guarantee, Hotpoint will replace your appliance, or if you prefer, give you your money back.

Hotpoint appliances carry, for the first 12 months, a fully inclusive parts and labour guarantee plus FREE replacement parts for the first five years provided that they are fitted by our own Service Engineer.

When the 12 months parts and labour guarantee expires we offer three after sales service options:

Repair Service

UK: 08709 066 066 or Republic of Ireland: 1850 302 200
Call our National Service Line and benefit from our additional 5 years FREE parts, although the engineers time and labour is chargeable. All repairs carry a fully inclusive parts and labour guarantee for 12 months from the date of repair.

Note: Chargeable service is offered on the basis of payment on completion to our Service Engineer, who will issue a receipt.

Extended Warranties

UK: 08709 088 088 or Republic of Ireland: 1850 502 200
Whether you have just one or a number of Hotpoint appliances in your kitchen, Hotpoint offer two Service Cover Plans to give you complete peace of mind. They enable you to extend your first 12 months labour guarantee by either 1 or 4 years, so that you can have FREE repairs during the membership period.

Service Cover

FREE service repairs for a single Hotpoint appliance during the period of cover.
At an additional cost Service Cover with maintenance includes an annual electrical and safety check along with replacement of any parts if necessary.

Kitchen Cover

An annual payment covers repairs for all your Hotpoint appliances which are less than ten years old. Additional Hotpoint appliances purchased after you have joined Hotpoint Kitchen Cover are automatically included during the annual period of cover without further charge.

Easy payment methods

We offer a number of payment methods: cheque, credit card, switch, cash or by taking advantage of one of our Service Cover Plans you can spread the cost by direct debit. For further details call: 08709 088 088

Appliance registration

To benefit from the above options, complete and return the Appliance Registration questionnaire supplied with this appliance. Full details and costs of our Service/Kitchen Cover options, together with an application form, will then be sent to you towards the end of the 12 month guarantee period.

Hotpoint Genuine Parts & Accessories

A wide range of parts and accessories are available from Hotpoint Genuine Parts & Accessories Mail Order Hotline
UK: 08709 077 077 or Republic of Ireland: 01 842 6836

Hotpoint Guarantee

From the moment your appliance is delivered, Hotpoint guarantees it for five years.

- Hotpoint appliances carry a fully inclusive 12 months parts and labour guarantee plus FREE replacement parts for the first five years, provided that they are fitted by our own Service Engineer (evidence will be required of date and place of purchase).
- All Hotpoint servicing is carried out by our own Service Organisation located throughout the United Kingdom and Republic of Ireland. We will be happy to deal with any problems which you may have.
- For Hotpoint Refrigeration and Freezer appliances, we cover the loss of food up to £250 during the first year guarantee period (subject to product malfunction). Claims must be verified by a Hotpoint representative.

Our Engineers will use every effort to avoid damage to floor coverings and adjacent units when carrying out repairs/service work, but in locations where the Engineer advises you that it will be impossible to move appliances without risk of damage, he will only proceed with your approval that no liability is accepted.

Guarantee terms and conditions...

Your guarantee is only applicable in the United Kingdom or Republic of Ireland and is subject to provision(s) that you appliance:

- Has been used solely for domestic purposes and is on domestic premises ie. not for commercial or trade use.
- Has been used solely in accordance with the instruction book.
- Has been properly connected to a suitable electrical supply voltage as stated on the appliance rating plate.
- Has not been subject to misuse, accident, modified or repaired by anyone other than our own Service Engineers.

Key Contacts

Service

With the largest appliance manufacturer's service team in Europe and trained specialists directly employed by us to ensure your complete confidence.

Repair Service

UK: 08709 066 066

Republic of Ireland: 1850 302 200

You will be asked for the following information:-

- Name, address and postcode.
- Telephone number
- Model / Serial number of the appliance
- Clear and concise details of the query or fault
- Place and Date of purchase

(Please keep the receipt as evidence will be required when the engineer calls).

Extended Warranty

To join: UK 08709 088 088

Republic of Ireland: 1850 502 200

Genuine Parts & Accessories Mail Order Hotline

UK: 08709 077 077

Republic of Ireland: (01) 842 6836

For further product information 08701 50 60 70

All Hotpoint Services are offered as an extra benefit and do not affect your statutory rights.



General Domestic Appliances Limited, Morley Way, Peterborough, PE2 9J

FP066 - 03

Free Manuals Download Website

<http://myh66.com>

<http://usermanuals.us>

<http://www.somanuals.com>

<http://www.4manuals.cc>

<http://www.manual-lib.com>

<http://www.404manual.com>

<http://www.luxmanual.com>

<http://aubethermostatmanual.com>

Golf course search by state

<http://golfingnear.com>

Email search by domain

<http://emailbydomain.com>

Auto manuals search

<http://auto.somanuals.com>

TV manuals search

<http://tv.somanuals.com>