

COOKER HOOD

USER HANDBOOK FOR INSTALLATION AND OPERATION MODEL HTU30



Your new Cooker Hood

Using your new Cooker Hood is very simple. Nevertheless, to get the best results it is important that you read this handbook thoroughly **before** installing and using your appliance for the first time.

Electrical Requirements

Any permanent electrical installation must comply with the latest I.E.E. Regulations and local electricity company regulations. For your own safety, this should be undertaken by a qualified electrician eg. your local electricity company or a contractor who is on the roll of the National Inspection Council for Electrical Installation Contracting (NICEIC).

Please ensure that when the appliance is installed it is easily accessible for the engineer in the event of a breakdown.

INCORRECT INSTALLATION COULD AFFECT THE SAFETY OF THE APPLIANCE

If the Cooker Hood is permanently wired in, it must be via a suitable double pole isolating switch placed in a readily accessible position adjacent to the unit.

Electrical Connection

Before connecting to the mains supply ensure that the mains voltage corresponds to the voltage on the rating plate, inside the Cooker Hood.

WARNING: THIS APPLIANCE MUST NOT BE EARTHED!

It is fitted with a 2 core mains supply cable and must be permanently connected to the electricity supply via a double pole switch having 3mm minimum contact gap on each pole. A Switched Fuse Connection Unit to BS 1363 Part 4, is a recommended mains supply connection accessory to ensure compliance with the Safety Requirements applicable to fixed wiring instructions.

DISCONNECT THE COOKER HOOD FROM THE MAINS SUPPLY BEFORE CARRYING OUT ANY KIND OF MAINTENANCE OR CLEANING.

WARNING:
CHILDREN SHOULD NOT BE ALLOWED TO PLAY WITH THE APPLIANCE OR TAMPER WITH THE CONTROLS.



CE marking certifies that this appliance conforms to the following EEC directives:-
Low Voltage Equipment - 72/23/EEC
Electromagnetic Compatibility - 89/336/EEC

Contents

| | Page |
|-------------------------------------|-------------|
| Electrical Requirements | 2 |
| Get to know your Cooker Hood | 4 |
| Installing your Cooker Hood | 5-7 |
| Installation | |
| Mounting Height | |
| Thermal cut-out | |
| Mounting beneath Cabinets | |
| Operating your Cooker Hood | 8 |
| The Controls | |
| Do's and Don'ts | |
| Caring for your Cooker Hood | 9-10 |
| Filters and their Replacement | |
| Cleaning | |
| How to Replace the Light | |
| Troubleshooting | 11 |
| Key Contacts | Back Cover |

Appliance manufactured in EU.

Retention of the Instruction Book

This Instruction Book must be kept handy for reference as it contains important details on the safe and proper use of the appliance.

If you sell or pass the appliance to someone else, or move house and leave it behind, make sure this Book is also provided so the new owner can become familiar with the appliance and safety warnings.

If the book is lost or damaged a copy may be obtained from:
GDA Ltd., Morley Way, Peterborough, PE2 9JB

Get to know your Cooker Hood.

Unpacking

Before installation, ensure that you have removed all packing pieces. Care should be taken that the fixing kit, ducting spigot and literature pack are retained.

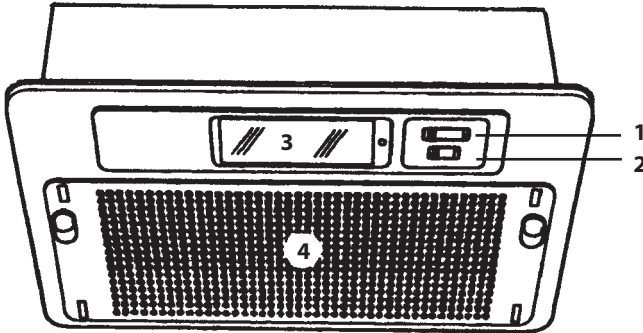

View of the Cooker Hood

- 1 Motor switch
- 2 Light switch
- 3 Work surface lamp
- 4 Grille

Dimensions

| | |
|--------|-------|
| Height | 175mm |
| Width | 525mm |
| Depth | 290mm |

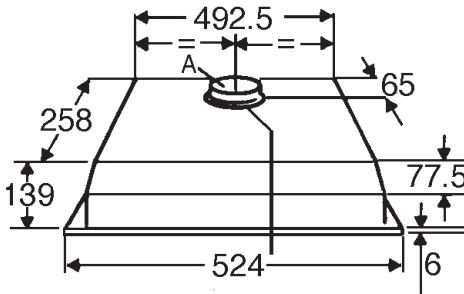

All measurements are in millimetres

Installing your Cooker Hood

This Cooker Hood is guaranteed and will give lasting service.

The guarantee is only applicable if the hood has been installed in accordance with the installation instructions detailed in this book. The manufacturer disclaims all liability for any damage or injury caused as a result of not following the instructions contained in the following text.

SAFETY WARNINGS: THIS COOKER HOOD IS DESIGNED FOR DOMESTIC USE ONLY.

When used in the extraction mode the Cooker Hood ducting must not be connected to a flue which is used for exhausting fumes from a central heating flue or water heating flue.

NOTE: All installations must comply with local authorities and building regulation requirements for the discharge of exhaust air into the atmosphere.

Your new Cooker Hood can be used in the following ways:

- External exhausting model
- Recycling model

These distances between hobs and grease filter must be observed.

Minimum 600mm - over an electric hob.

Minimum 700mm - over a gas or mixed fuel hob.

Minimum 400-450mm - over a high level grill.

Suggestions for the Installation and use:

- The horizontal sections of the pipe must be slanted slightly upwards (about 10%) to ensure an easy flow of air outwards.
- The hood is more efficient in the exhaust mode, therefore this position should be selected during the warmer months of the year when no heating is being used. When the room is being heated, if the recirculation position is selected heat will not be wasted.

Ducting:

In order to obtain satisfactory air extraction, long ducts should not be used. Exhaust pipes with a minimum internal diameter of 100mm and with as smooth an inner wall as possible are recommended. The ducting MUST be manufactured from a fire retardant material. Fit the ducting spigot into the aperture on the top of the casing and make an airtight

connection (Fig. 1).

The maximum length of ducting, including one 90° bend should be 3 metres, to be reduced by 1 metre for each 90° bend installed in the duct run.

Where flexible ducting is fitted it should not be turned through very tight bends as this could impair the performance of the hood.

Fig.1

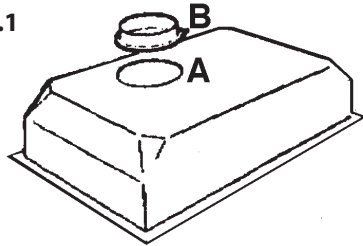

Wall Vent Kit:

For connecting the Hood either directly through a wall or in conjunction with a ducting pipe, we recommend the use of a Wall Vent Kit. A 3m extension pipe is also available. These may be obtained from your nearest retailer or the Genuine Parts and Accessories Mail Order Hotline (see back cover) and must be used where there is a cavity wall. Specific installation instructions are included with the Wall Vent Kit.

NOTE: The Wall Vent Kit has a diameter of 100mm.

Use

The hood may be used in two ways:

- External exhausting version
- Internal recycle version.

External exhausting version.

This method is recommended if at all possible. The air is conveyed out through a pipe which is connected to the outlet hole **A** (fig. 1) by means of a coupling flange **B** (fig. 1).

Diameter of the exhausting pipe must be equal to that of the coupling flange.

Attention! the hood is supplied with a grease filter, which when absorbed with grease and fat can be thrown away.

Internal recycle version.

The air is purified through an active carbon filter and returned to the room.

For instructions on how to fit and replace the carbon filter please see the section on "caring for your cooker hood".

Installing your Cooker Hood

NOTE: The hood is more efficient in the exhaust mode, therefore this position should be selected during the warmer months of the year when no heating is being used. When the room is being heated, if the recirculation position is selected heat will not be wasted.

MOUNTING

Mounting Height:

When installed above an electric cooking appliance the minimum distance between the surface of the hob elements and the lower grille of the cooker hood must be 650mm.

When installed above a gas cooking appliance the minimum distance between the surface of the hob pan supports and the lower grille of the cooker hood must be 750mm.

The minimum distance for installation above a high level grill is 400mm.

The distance between the underside of adjoining wall cabinet and the worktop must not be less than 400mm.

If the cooker hood is installed for use above a gas appliance then the provision for ventilation must be in accordance with the gas safety (Installation and use) regulations. Detailed recommendations are contained in the following British Standard Codes of Practice BS6172, BS5440 and BS6891 Current Edition.

NOTE: This hood has been designed and approved for installation over an electric hob with a maximum input of 7kW or a gas hob with a maximum input of 10kW when fitted in accordance with the heights recommended above.

THERMAL CUT-OUT:

WARNING-The fan motor of this appliance incorporates a thermal cut-out device which will operate if the hood is installed below the minimum recommended heights listed above, or if the motor becomes overheated.

If the cut-out device is activated, switch off the fan motor and allow the hood to cool. The cut-out device will reset itself when the fan motor has cooled significantly.

Note: the hood is more effective when installed in extraction (ducting) mode.

Mounting beneath cabinets on the Wall:

Before fitting the hood beneath any type of wall cabinet/canopy housing, ensure it is firmly fixed to the wall in accordance with the manufacturer's instructions. Before drilling, care should be taken to check for electric cables, water pipes or gas pipes on the wall to which the cabinet/canopy is to be fitted.

The hood may be fixed to any rigid vertical surface. If the hood can only be fixed to a hollow construction plaster or partition board structure, then the wall must be sufficiently reinforced to be quite rigid in the area of the housing mounting system.

IMPORTANT: The exhaust air must not be expelled through a smoke or waste-gas chimney which is in use or through a shaft used for ventilating rooms or into the cavity of a cavity wall or into a cupboard above the cooker hood.

If the room contains a flued fuel burning appliance, such as a gas or oil fired central heating boiler which is not of the 'Balanced Flue' type, you should make sure that there is an adequate air inlet into the room at all times so that fumes from the boiler are not drawn back into the room by the cooker hood.

For secure operation and to prevent discharge gas from coming back in, the vacuum must not exceed 0.04mbr.

This may be done by making sure the air inlet into the room passes through non-closing openings such as air recycling wall boxes, doors, windows or with other technical measures.

Installing your Cooker Hood

Fixing the Cooker Hood

After having adjusted the hood for the version required, it may be installed.

- This appliance is designed for fitting in a cabinet or some other support.
 - The opening to be made on the bottom of the wall hung cabinet must correspond with the measurements shown in fig. 2.
- To fix the hood proceed as follows:

1. Remove the grille using the release clips (fig. 3).
2. Fit the hood into the opening.
3. Secure the unit to the cabinet by screwing up the screws through the hole D (fig. 2).
4. Refit the grille.

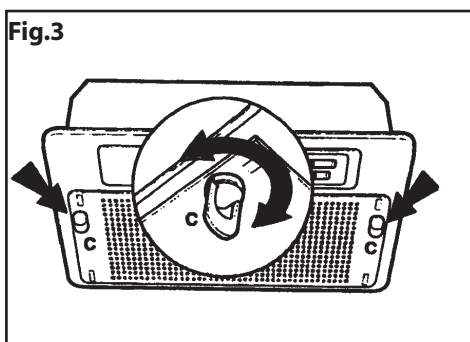
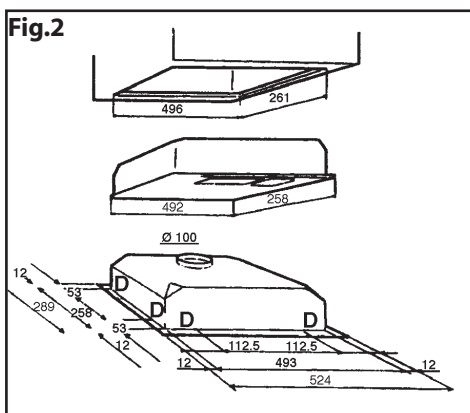

Operating your Cooker Hood

The Controls

Make sure that the Cooker Hood is wired in and the power supply is switched on.

Fan Speed

Your Cooker Hood has three speeds to give you the correct extraction level to suit your cooking conditions.

Position 1 should be selected when simmering or when using only one pan.

Position 2 should be selected for normal cooking up to four pans.

Position 3 should be selected when frying or cooking food with strong odours.

Simply slide the selector to the required setting.

Work Top Illumination

There is a separate selector for the light. This selector controls the worktop illumination.

Position 1 indicates the illumination is operating.

To obtain the best performance it is advisable to switch on the hood a few minutes before you start cooking and leave it running for approximately 15 minutes after finishing.

Do's and Don'ts

DO

- Do** take extra care when frying.
- Do** keep the heating areas on your hob covered over with pots and pans etc. when using the hob and Cooker Hood simultaneously.
- Do** make sure that there is an adequate air inlet into the room if you are using the hood to vent externally and have a boiler or fire in the room, so that fumes are not drawn back from the flue.
- Do** install the hood at the correct height, allowing at least the minimum distance above a cooking appliance (see page 6).
- Do** replace the grease filter when the coloured indicators cover the filter.

DON'T

- Don't** use the hood without the grease filter.
- Don't** leave a naked flame under the hood.
- Don't** leave cooker/hob hotplates 'On' when not covered, as the fan motor of this cooker hood incorporates a thermal cut-out device which will operate if the hood overheats. The fan motor will take approximately 20 minutes to automatically reset at which point the hood will resume normal functions (see page 6).
- NEVER** do flambé cooking beneath this cooker hood.
- NEVER** leave frying pans or deep fat fryers unattended during use, overheated fat/oil may catch fire.

Caring for your Cooker Hood

Before doing any cleaning or replacing the filters or light bulb, always ensure that the electricity supply to the Cooker Hood is switched 'OFF'.

Filters and their replacement:

THE GREASE FILTER -

The grease filter is fitted to absorb grease and dust during cooking to help keep the appliance clean inside.

The grease filter cannot be cleaned.

It must not be washed.

The grease filter should be replaced every 2 months.

To remove the grease filter open the metal inlet grille, carefully ease out the metal retaining wire clips. To remove the grease filter open the grille by turning knob C (fig. 3).

Pull the plastic stops E as shown by the arrow (fig. 4) and remove the grease filter.

Please ensure that the plastic clips are handled with care.

Fig. 3

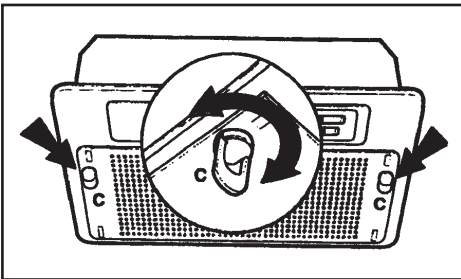
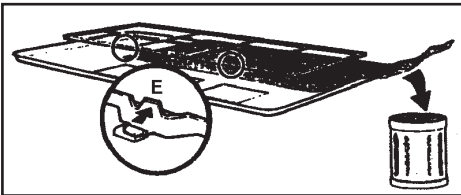

Fig. 4



IMPORTANT: There could be a possible fire hazard if the grease filter is not cleared when necessary and according to these instructions.

THE CARBON FILTER -

(Recirculation only)

The carbon filter is an optional extra and is to be fitted to the cooker hood when installed in the recycling mode.

The activated carbon filter absorbs odours arising from the cooking. In use, the filter will slowly become saturated and gradually less effective. The filter will normally require changing every six months, depending on the amount and type of cooking.

TO FIT THE CARBON FILTERS -

The deflector must be fitted over the hole fixing it with a special screw provided. The deflector should be fixed to ensure the air flow is away from the wall to avoid dirtying or marking the rear wall. Place the new carbon filter over the motor housing, to lock the filter turn in the direction indicated on the housing (fig. 5). The hood must not be connected to ducting when in recirculating mode.

Regular replacement of the charcoal filter will ensure optimum performance from the hood when recirculating.

Fig. 5

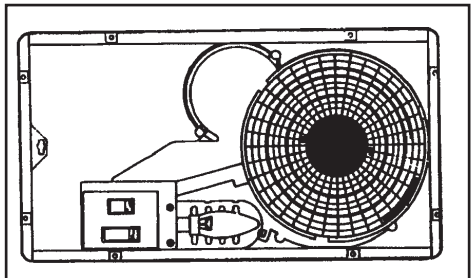

Caring for your Cooker Hood

Cleaning:

Before doing any cleaning or replacing the filters or light bulb always check that the electricity supply to the hood is switched off.

For your own safety and in the interest of hygiene your Cooker Hood needs to be kept clean. A build up of grease or fat from cooking could cause a fire hazard.

Never use excessive amounts of water when cleaning, particularly around the control panel area.

The metal casing and grille assembly should be cleaned at least once a month to keep it looking like new. Wipe over with a soft cloth, wrung out in warm water and dry with a clean soft cloth. Wear protective gloves.

You can use mild non-abrasive cleaners but always read the manufacturer's instructions first. Always test their suitability on a small area of the Cooker Hood not noticeable in normal use.

NOTE: DO NOT use scouring pads or abrasive cleaners as they may scratch the surface.

How to replace the light:

Should the light fail to work, switch 'Off' the mains supply to the Hood.

Remove the grille.

First check the bulb is screwed securely into the bulb holder.

Replacement bulbs are specified 230/240 volts 40watt clear round shape with small Edison (E14) screw thread cap.

Replace the grille and switch on at the mains supply.

NOTE: When changing the bulb, an identical replacement must be fitted to ensure the safe operation of the hood.

Troubleshooting.

First, don't panic!

There may be nothing wrong at all. Look for your problem below, then check the things we suggest. More often than not, this will give you the answer to your problem, and you'll be able to carry on without having to telephone your Service Office.

It is not working!

Are you using a plug and socket?

- Check that the plug is firmly pushed in.
- Check the power supply, by plugging in another appliance.
- Has the fuse blown?

It is not working!

Is the mains lead wired directly into a double pole isolating switch?

- Check that the wires in the mains lead are correctly connected. (See page 2)

The Cooker Hood is not working satisfactorily...

- Check you have selected the correct fan speed.
- Check if the grease filter needs replacing (See page 9).
- Check that there is no obstruction in the outlet pipe.

The light is not working...

- Check the bulb is screwed in securely.
- Replace the light bulb.

The Cooker Hood switches off intermittently...

- Check the mounting height above the hob is correct. The heat from the hob may cause the fan motor to overheat/cut-out.

If, after following these instructions, you are still having problems, contact your nearest Service Centre (See back cover).

Parts

Please remember your new appliance is a complex piece of equipment.

'DIY' repairs or unqualified and untrained service people may put you in danger, could damage the appliance and might mean that you lose cover under the Guarantee.

If you do experience a problem with the appliance, don't take any risks, call in a Service Engineer (See back cover).

Our Parts are designed exclusively to fit only GDA Ltd appliances. Do not use them for any other purpose as you may create a safety hazard.

Key Contacts

Service

Hotpoint has the largest appliance manufacturer's service team in Europe, trained specialists directly employed by us to ensure your complete confidence.

Repair Service

UK: 08709 066 066

Republic of Ireland: 1850 302 200

You will be asked for the following information:-

Name, address and postcode.

Telephone number

Model / Serial number of the appliance

Clear and concise details of the query or fault

Place and Date of purchase

(Please keep the receipt as evidence will be required when the engineer calls).

Extended Warranty

To join: UK 08709 088 088

Republic of Ireland: 1850 502 200

Genuine Parts & Accessories

Mail Order Hotline

UK: 08709 077 077

Republic of Ireland: (01) 842 6836

For further product information 08701 50 60 70

All Hotpoint Services are offered as an extra benefit and do not affect your statutory rights.



General Domestic Appliances Limited, Morley Way, Peterborough, PE2 9JB

Part No. FP075-01

Free Manuals Download Website

<http://myh66.com>

<http://usermanuals.us>

<http://www.somanuals.com>

<http://www.4manuals.cc>

<http://www.manual-lib.com>

<http://www.404manual.com>

<http://www.luxmanual.com>

<http://aubethermostatmanual.com>

Golf course search by state

<http://golfingnear.com>

Email search by domain

<http://emailbydomain.com>

Auto manuals search

<http://auto.somanuals.com>

TV manuals search

<http://tv.somanuals.com>