



HP Photosmart series - B109



Apply sticker to printer.



Important!

Do NOT connect the USB cable until prompted by the software (Windows users only).

1 Verify box contents

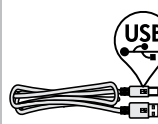
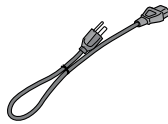

2 Insert the CD for guided printer setup

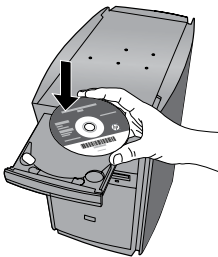

When you insert the CD, animations will guide you through the printer setup, including how to install ink cartridges and load paper.

Notes:

- Software installation will proceed after you complete the guided printer setup.
- For computers without a CD/DVD drive, please go to www.hp.com/support to download and install the software.

Printed in English

© 2009 Hewlett-Packard Development Company, L.P.



Q8433-90109

Download from Www.Somanuals.com

Cyan Cartridge

178 or 364

Magenta Cartridge

178 or 364

Yellow Cartridge

178 or 364

Black Cartridge

178 or 364

Get to know the HP Photosmart

English



- 1 Back:**
Returns to the previous screen.
- 2 Cancel:**
Stops the current operation, restores default settings, and clears the current photo selection.
- 3 OK:**
Selects a menu setting, value, or photo.
- 4 Scan:**
Opens the **Scan Menu**. When viewing screens other than the Home screen, selects options related to the current display.
- 5 Photo:**
Opens the **Photo Menu**. When viewing screens other than the Home screen, selects options related to the current display.
- 6 Copy:**
Opens the **Copy Menu**. When viewing screens other than the Home screen, selects options related to the current display.

Get the most out of your HP Photosmart



Print your photos without connecting to a computer— just insert your memory card into a slot on the HP Photosmart and start printing.



Print on a variety of specialty media such as transparencies and envelopes.



Make color or black-and-white copies.



Scan originals to a memory card or a connected computer.

Find more information

All other product information can be found in the electronic Help and Readme. Electronic Help includes instructions on product features and troubleshooting. It also provides product specifications, legal notices, environmental, regulatory, and support information. The Readme file contains HP support contact information, operating system requirements, and the most recent updates to your product information.

To access the Electronic Help

- Windows: Click **Start > All Programs > HP > Photosmart B109 series > Help**.
- Mac OS x v10.4: Click **Help > Mac Help, Library > HP Product Help**.
- Mac OS x v10.5: Click **Help > Mac Help**. In the **Help Viewer**, select **HP Product Help**.

Windows 7

Windows 7 support information is available online: www.hp.com/go/windows7.

Power specifications:

Power adapter: 0957-2269

Input voltage: 100 to 240 Vac

Input frequency: 50-60 Hz

Power Delivery Capability: 20W Average

Note: Use only with the power adapter supplied by HP.

Ink usage

Note: Ink from the cartridges is used in the printing process in a number of different ways, including in the initialization process, which prepares the device and cartridges for printing, and in printhead servicing, which keeps print nozzles clear and ink flowing smoothly. In addition, some residual ink is left in the cartridge after it is used. For more information see www.hp.com/go/inkusage.

Troubleshooting

Setup Troubleshooting

If the HP Photosmart does not turn on:

1. Check the power cord.
 - Make sure the power cord is firmly connected to both the product and the power adapter.
 - If you are using a power strip, make sure the power strip is turned on. Or, try plugging the product directly into a power outlet.
 - Test the power outlet to make sure it is working. Plug in an appliance that you know works, and see if the appliance has power. If not, then there might be a problem with the power outlet.
 - If you plugged the product into a switched outlet, make sure the outlet is switched on. If it is switched on but still does not work, then there might be a problem with the power outlet.
2. Unplug the power cord from the back of the product. Plug the power cord back in, and then press the On button to turn on the product.
3. The product might not respond if you press the On button too quickly. Press the On button once. It might take a few minutes for the product to turn on. If you press the On button again during this time, you might turn the product off.
4. If you have completed all of the steps provided in the previous solutions and are still having a problem, contact HP support for service. Go to: www.hp.com/support.

Windows

If you are unable to print make sure the product is set as your default printing device:

- **Windows Vista:** On the Windows taskbar, click **Start**, click **Control Panel**, and then click **Printers**.
- **Windows XP:** On the Windows taskbar, click **Start**, click **Control Panel**, and then click **Printers and Faxes**.

Make sure that your product has a check mark in the circle next to it. If your product is not selected as the default printer, right-click the printer icon and choose "Set as default printer" from the menu.

If you are still unable to print, or the Windows software installation fails:

1. Remove the CD from the computer's CD-ROM drive, and then disconnect the USB cable from the computer.
2. Restart the computer.
3. Temporarily disable any software firewall and close any anti-virus software. Restart these programs after the product software is installed.
4. Insert the product software CD in the computer's CD-ROM drive, then follow the onscreen instructions to install the product software. Do not connect the USB cable until you are told to do so.
5. After the installation finishes, restart the computer.

Mac

If you are unable to print, uninstall and reinstall the software:

Note: The uninstaller removes all of the HP software components that are specific to the device. The uninstaller does not remove components that are shared by other products or programs.

To uninstall the software:

1. Disconnect the HP Photosmart from your computer.
2. Open the Applications: Hewlett-Packard folder.
3. Double-click **HP Uninstaller**. Follow the onscreen instructions.

To install the software:

1. To install the software, insert the HP software CD into your computer's CD drive.
2. On the desktop, open the CD and then double-click **HP Installer**.
3. Follow the onscreen instructions.

HP printer limited warranty statement

HP product	Duration of limited warranty
Software Media	90 days
Printer	1 year
Print or Ink cartridges	Until the HP ink is depleted or the "end of warranty" date printed on the cartridge has been reached, whichever occurs first. This warranty does not cover HP ink products that have been refilled, remanufactured, refurbished, misused, or tampered with.
Printheads (only applies to products with customer replaceable printheads)	1 year
Accessories	1 year unless otherwise stated

A. Extent of limited warranty

1. Hewlett-Packard (HP) warrants to the end-user customer that the HP products specified above will be free from defects in materials and workmanship for the duration specified above, which duration begins on the date of purchase by the customer.
2. For software products, HP's limited warranty applies only to a failure to execute programming instructions. HP does not warrant that the operation of any product will be interrupted or error free.
3. HP's limited warranty covers only those defects that arise as a result of normal use of the product, and does not cover any other problems, including those that arise as a result of:
 - a. Improper maintenance or modification;
 - b. Software, media, parts, or supplies not provided or supported by HP;
 - c. Operation outside the product's specifications;
 - d. Unauthorized modification or misuse.
4. For HP printer products, the use of a non-HP cartridge or a refilled cartridge does not affect either the warranty to the customer or any HP support contract with the customer. However, if printer failure or damage is attributable to the use of a non-HP or refilled cartridge or an expired ink cartridge, HP will charge its standard time and materials charges to service the printer for the particular failure or damage.
5. If HP receives, during the applicable warranty period, notice of a defect in any product which is covered by HP's warranty, HP shall either repair or replace the product, at HP's option.
6. If HP is unable to repair or replace, as applicable, a defective product which is covered by HP's warranty, HP shall, within a reasonable time after being notified of the defect, refund the purchase price for the product.
7. HP shall have no obligation to repair, replace, or refund until the customer returns the defective product to HP.
8. Any replacement product may be either new or like-new, provided that it has functionality at least equal to that of the product being replaced.
9. HP products may contain remanufactured parts, components, or materials equivalent to new in performance.
10. HP's Limited Warranty Statement is valid in any country where the covered HP product is distributed by HP. Contracts for additional warranty services, such as on-site service, may be available from any authorized HP service facility in countries where the product is distributed by HP or by an authorized importer.

B. Limitations of warranty

TO THE EXTENT ALLOWED BY LOCAL LAW, NEITHER HP NOR ITS THIRD PARTY SUPPLIERS MAKES ANY OTHER WARRANTY OR CONDITION OF ANY KIND, WHETHER EXPRESS OR IMPLIED WARRANTIES OR CONDITIONS OF MERCHANTABILITY, SATISFACTORY QUALITY, AND FITNESS FOR A PARTICULAR PURPOSE.

C. Limitations of liability

1. To the extent allowed by local law, the remedies provided in this Warranty Statement are the customer's sole and exclusive remedies.
2. TO THE EXTENT ALLOWED BY LOCAL LAW, EXCEPT FOR THE OBLIGATIONS SPECIFICALLY SET FORTH IN THIS WARRANTY STATEMENT, IN NO EVENT SHALL HP OR ITS THIRD PARTY SUPPLIERS BE LIABLE FOR DIRECT, INDIRECT, SPECIAL, INCIDENTAL, OR CONSEQUENTIAL DAMAGES, WHETHER BASED ON CONTRACT, TORT, OR ANY OTHER LEGAL THEORY AND WHETHER ADVISED OF THE POSSIBILITY OF SUCH DAMAGES.

D. Local law

1. This Warranty Statement gives the customer specific legal rights. The customer may also have other rights which vary from state to state in the United States, from province to province in Canada, and from country to country elsewhere in the world.
2. To the extent that this Warranty Statement is inconsistent with local law, this Warranty Statement shall be deemed modified to be consistent with such local law. Under such local law, certain disclaimers and limitations of this Warranty Statement may not apply to the customer. For example, some states in the United States, as well as some governments outside the United States (including provinces in Canada), may:
 - a. Preclude the disclaimers and limitations in this Warranty Statement from limiting the statutory rights of a consumer (e.g., the United Kingdom);
 - b. Otherwise restrict the ability of a manufacturer to enforce such disclaimers or limitations; or
 - c. Grant the customer additional warranty rights, specify the duration of implied warranties which the manufacturer cannot disclaim, or allow limitations on the duration of implied warranties.
3. THE TERMS IN THIS WARRANTY STATEMENT, EXCEPT TO THE EXTENT LAWFULLY PERMITTED, DO NOT EXCLUDE, RESTRICT, OR MODIFY, AND ARE IN ADDITION TO, THE MANDATORY STATUTORY RIGHTS APPLICABLE TO THE SALE OF THE HP PRODUCTS TO SUCH CUSTOMERS.

HP Limited Warranty

Dear Customer,

You will find below the name and address of the HP entity responsible for the performance of the HP Limited Warranty in your country.

You may have additional statutory rights against the seller based on your purchase agreement. Those rights are not in any way affected by this HP Limited Warranty.

Ireland: Hewlett-Packard Ireland Limited, 63-74 Sir John Rogerson's Quay, Dublin 2

United Kingdom: Hewlett-Packard Ltd, Cain Road, Bracknell, GB-Berks RG12 1HN

Malta: Hewlett Packard International Trade BV, Branch 48, Sqaq Nru 2, Triq ix-Xatt, Pieta MSD08, Malta

South Africa: Hewlett-Packard South Africa Ltd, 12 Autumn Street, Rivonia, Sandton, 2128, Republic of South Africa

Free Manuals Download Website

<http://myh66.com>

<http://usermanuals.us>

<http://www.somanuals.com>

<http://www.4manuals.cc>

<http://www.manual-lib.com>

<http://www.404manual.com>

<http://www.luxmanual.com>

<http://aubethermostatmanual.com>

Golf course search by state

<http://golfingnear.com>

Email search by domain

<http://emailbydomain.com>

Auto manuals search

<http://auto.somanuals.com>

TV manuals search

<http://tv.somanuals.com>