

Universal Elevator Mount Owners Manual

SAFETY INSTRUCTIONS

FAILURE TO FOLLOW THESE SAFETY INSTRUCTIONS MAY RESULT IN SERIOUS INJURY, PROPERTY DAMAGE AND WILL VOID WARRANTY.

Owner must ensure that all players know and follow these rules for safe operation of the unit.

To ensure safety, do not attempt to assemble this system without following the instructions carefully. Check entire box and inside all packing material for parts. Before beginning assembly, read the instructions and identify parts using the hardware identifier and parts list in this document. Proper and complete assembly, use and supervision are essential for proper operation and to reduce the risk of accident or injury. A high probability of serious injury exists if this system is not installed, maintained, and operated properly.

- This equipment is intended for home recreational use only and NOT excessive competitive play.
- Read and understand the warning label enclosed with hardware. It is the responsibility of the customer to mount this label. It should be affixed to the pole, wall, or door near playing area, at a height between 4-6 feet (1.2 -1.8 m) above ground level and in a location visible to all players.
- During assembly, if using a ladder use extreme caution. Two people are recommended for this operation.
- If technical assistance is required, contact Huffy Sports.
- Adult supervision is recommended when adjusting height.

Required Tools and Materials:

NOTE: Due to various mounting methods, additional tools and materials may be required.

- Two People
- Tape Measure
- Pencil
- Wrenches: (Two) 7/16", 1/2", 9/16", 3/4" or Large and Small Adjustable Wrenches
- Step Ladder 8 ft. (2.4 m)
- Drill & Bit (3/8")
- Carpenter Level

Most injuries are caused by misuse and/or not following instructions. Use caution when using this unit.

IMPORTANT! Have questions...don't go back to the store!

We appreciate your purchasing one of our many fine products. We are sure that you will be very satisfied with your selection. Although great care and effort have been taken, occasionally problems may occur. To ensure prompt and correct handling of any problems, or to answer any questions, please contact our Toll-Free Customer Service Number listed below. **Service will be quicker if you have your Model Number (found on carton) and assembly instructions ready when calling.** PLEASE WRITE YOUR MODEL NUMBER IN THE SPACE PROVIDED ABOVE.

Toll-Free Customer Service Number for U.S: **1-800-558-5234** and Canada Only: **1-800-284-8339**
Internet Address: <http://www.huffysports.com>



WARNING

FAILURE TO FOLLOW THESE WARNINGS MAY RESULT IN SERIOUS INJURY AND/OR PROPERTY DAMAGE.

Owner must ensure that all players know and follow these rules for safe operation of the unit.

- See instruction manual for proper installation and maintenance.
- Use caution when performing dunk type activities on this unit.
- Do not hang from any part of unit, including backboard, support braces, rim or net.
- Keep pole top covered with cap at all times.
- Do not slide, climb, shake or play on pole.
- Keep organic material away from pole base. Grass, litter, etc. could cause corrosion and/or deterioration.
- Check pole system for signs of corrosion (rust, pitting, chipping) and repaint with exterior enamel paint. If rust has penetrated through steel anywhere, replace pole immediately.
- Check unit before each use for loose hardware, excessive wear and signs of corrosion and repair before using.
- Check unit before each use for stability.
- During play, use extreme caution to keep player's face away from the backboard, rim or net. Serious injury could occur if teeth/face come in contact with backboard, rim or net.
- When adjusting height, keep hands and fingers away from moving parts. Do not allow children to adjust unit.
- During play, do not wear jewelry (rings, watches, necklaces, etc.) Objects may entangle in net.

HEIGHT ADJUSTMENT

Insert end of broom handle or wooden dowel 3/4"-7/8" (19-22mm) diameter into release lever.

Push up, pivot outward to raise and lower

IMPORTANT!
Push up, pivot inward and lower to lock

HUFFY[®]SPORTS

In the U.S.: 1-800-558-5234 and Canada Only: 1-800-284-8339

206117 5/97



ROOF MOUNTING

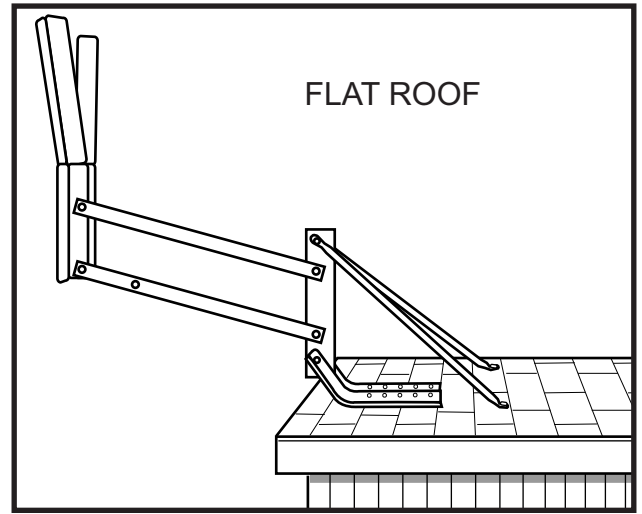
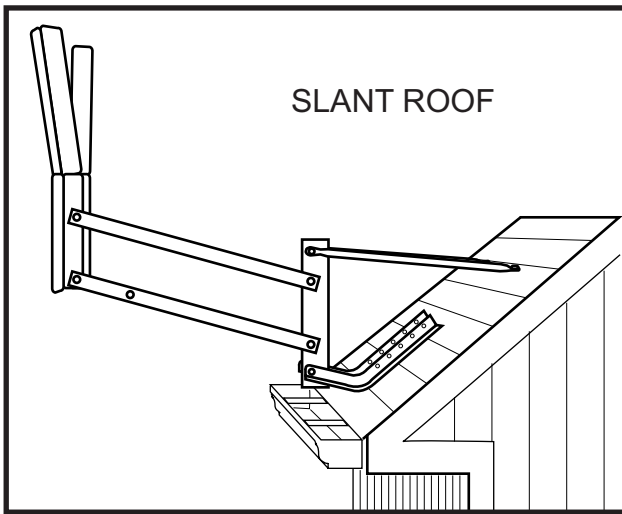

1. Secure struts (3) to upper holes on u-channel (2).
NOTE: Position flat side of strut on u-channel.
Tighten until snug.

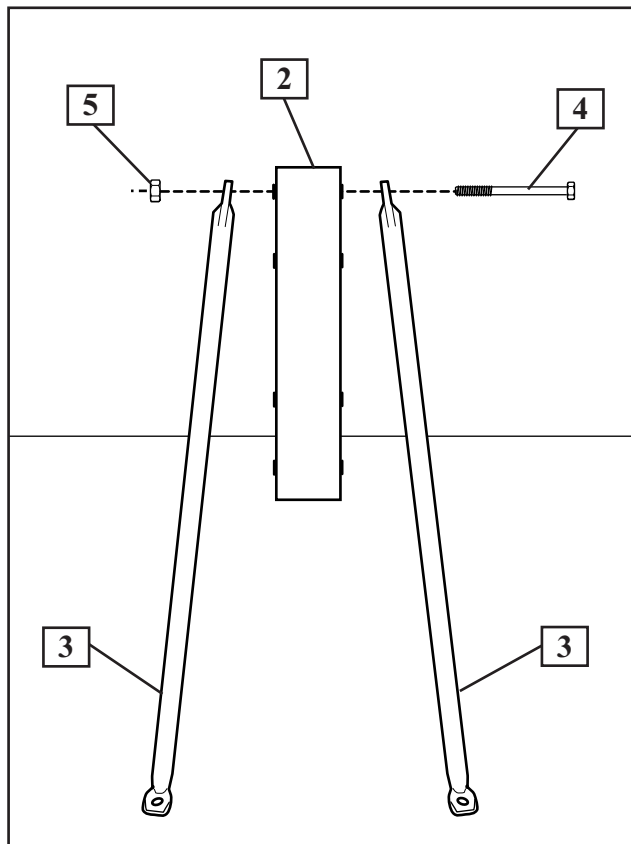

2. Install angle brackets (6 and 7) to lower holes on u-channel (2) and position angle brackets horizontally on roof. Tighten until snug.

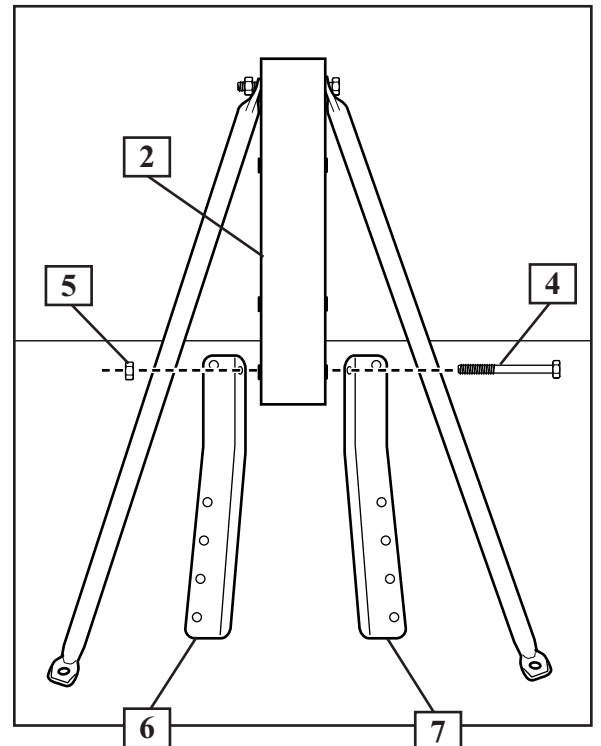

- 3.** **NOTE: Two people recommended for this procedure.** Hold angled brackets (6 and 7) on roof and keep u-channel (2) upright. Measure from top of playing surface to upper elevator hole in u-channel. Distance should be 106" (2.7m). **NOTE: To achieve 106" (2.7 m) you may have to make some adjustments. Such as turning the tube over on the opposite end, and/or moving angled brackets backward or adding height to the entire assembly with wood between angled brackets and roof.**

Mark angled bracket locations on roof. Angled brackets (6 and 7) should be parallel to each other and 3-1/2" (8.9 cm) apart.

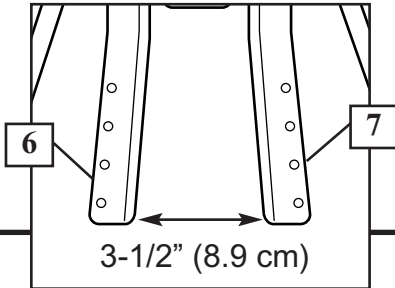

! WARNING

Minimum distance should be 106" (2.7 m) from top elevator hole to playing surface. Homeowner must assume all responsibility for any personal or property damage if backboard height is lower than recommended.

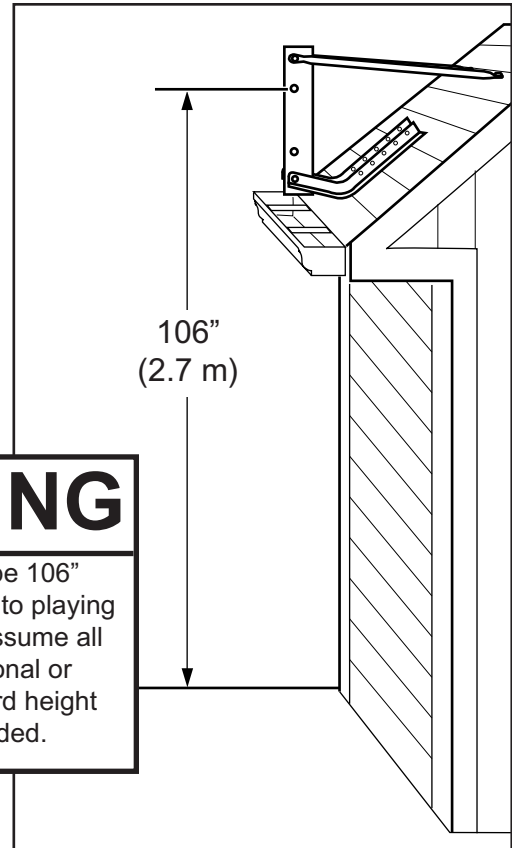

- 4.** Drill holes in roof. Position angled brackets and secure to roof. **NOTE: Hardware for this procedure not included due to various roof construction materials and design structure.**

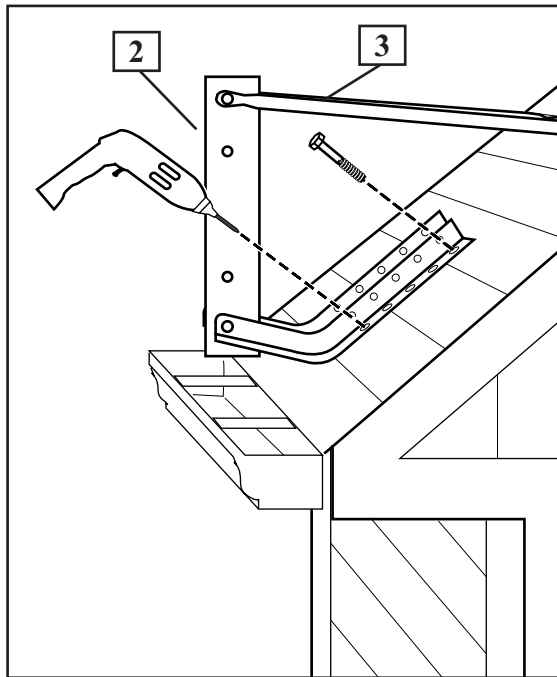

- 5.** Keep u-channel (2) upright and position struts (3) on desired location on roof approx. 26"-30" (66-76 cm) apart. Level tube in all directions. Mark and drill holes. Secure struts in place.

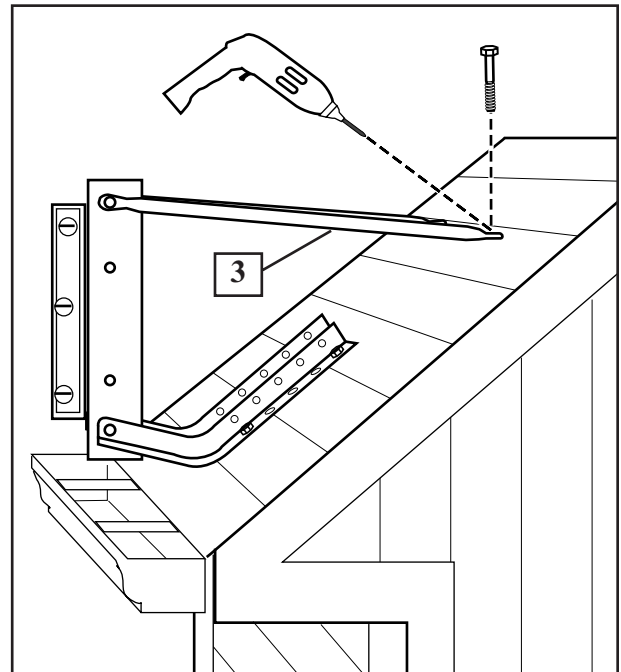

6. IMPORTANT! Test fit bolts into holes of brackets (8) and carefully rock them in a circular motion to ream out paint from holes if necessary.

7. IMPORTANT! Finger tighten nuts and bolts until instructed to fully tighten later.

8. Fit spacer (11) into pawl (13) and fit pin of pawl through end slot of release lever (12).

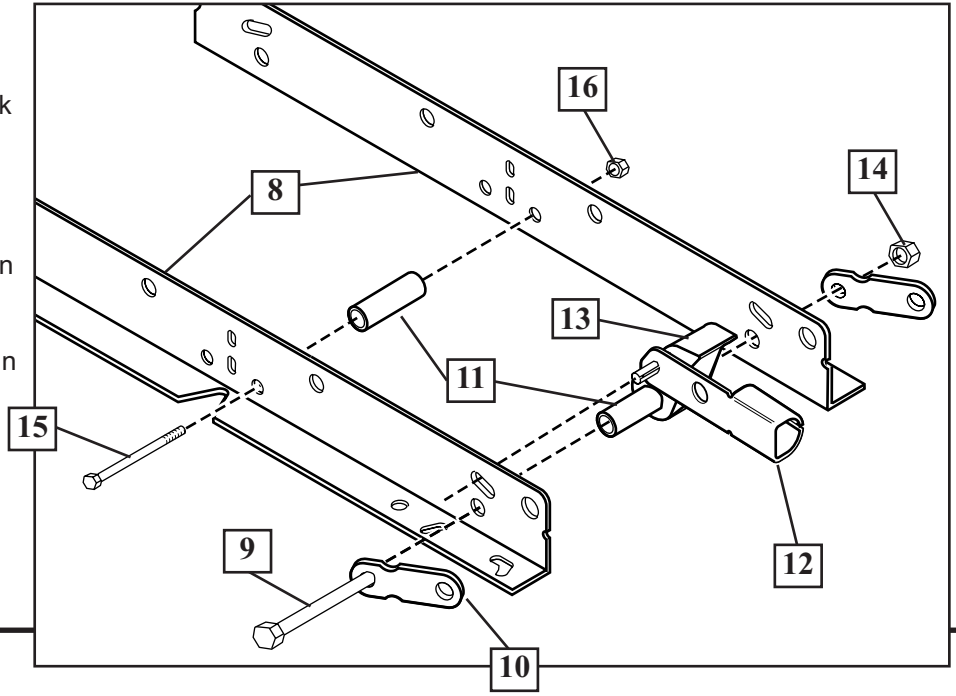

9. IMPORTANT! Bolt (18) must be inserted through tube (17), spacer (19), support bracket (10), board bracket (8), release lever (12), wave washer (20), and then ratchet (21). Fully tighten all nuts and bolts after assembly.

10. Use pliers to stretch spring (23) into position.

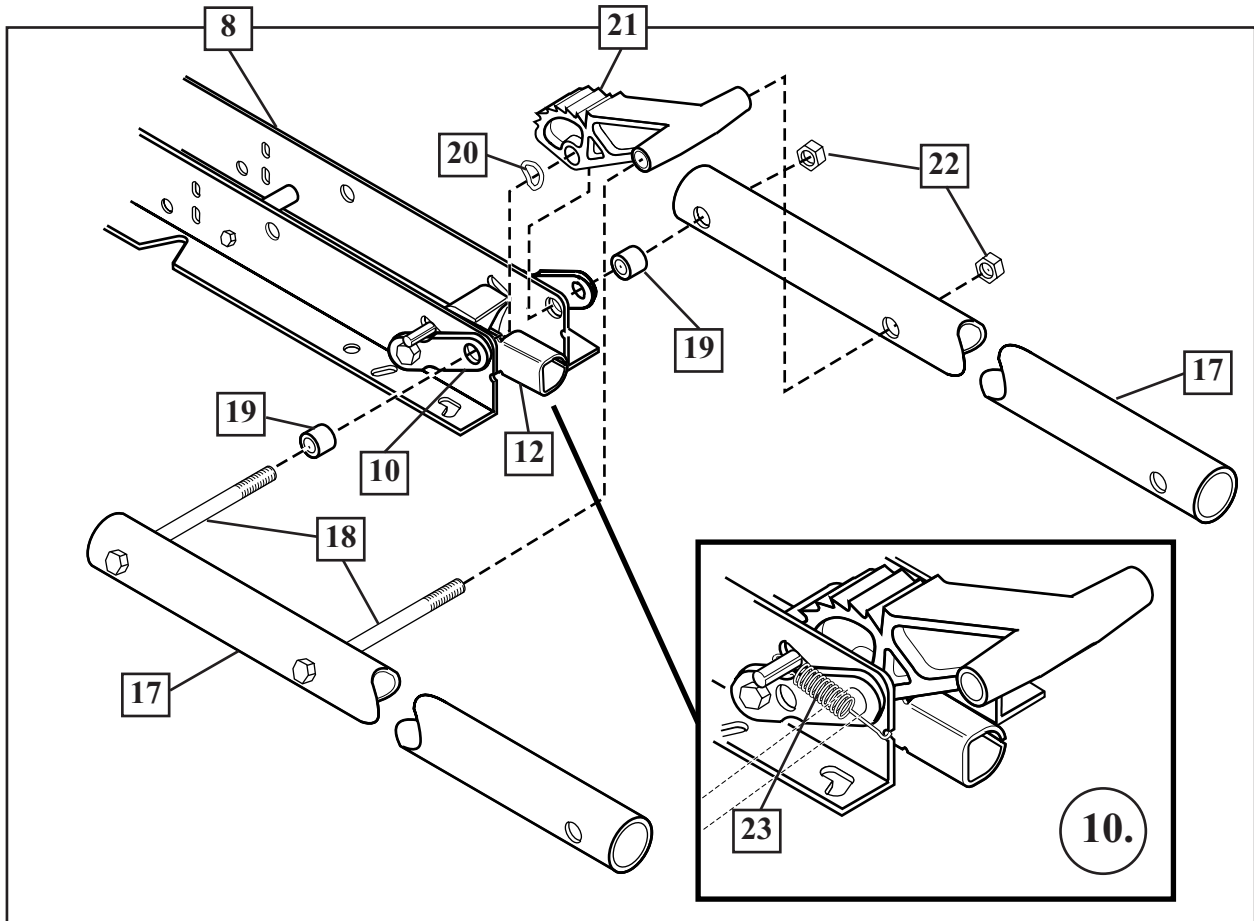

- 11.** Starting with nuts flush against bracket (8), secure rim and bracket to backboard.
NOTE: Mounting nuts and bolts not included.

- 12.** Bend bracket (8) to line up with holes in backboard and secure.

**Backboard
and Rim
NOT
Included**

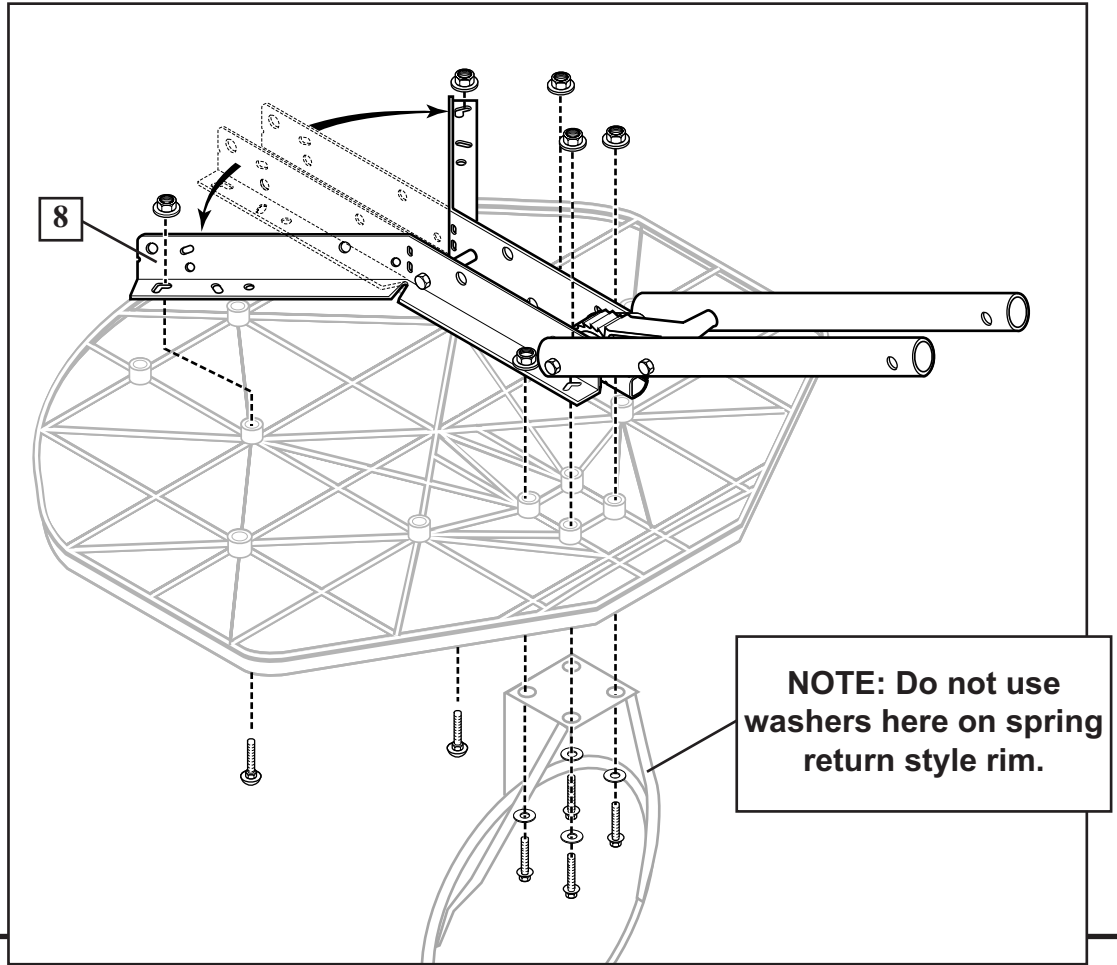

- 13.** Assemble elevator tubes (17) to backboard bracket (8).

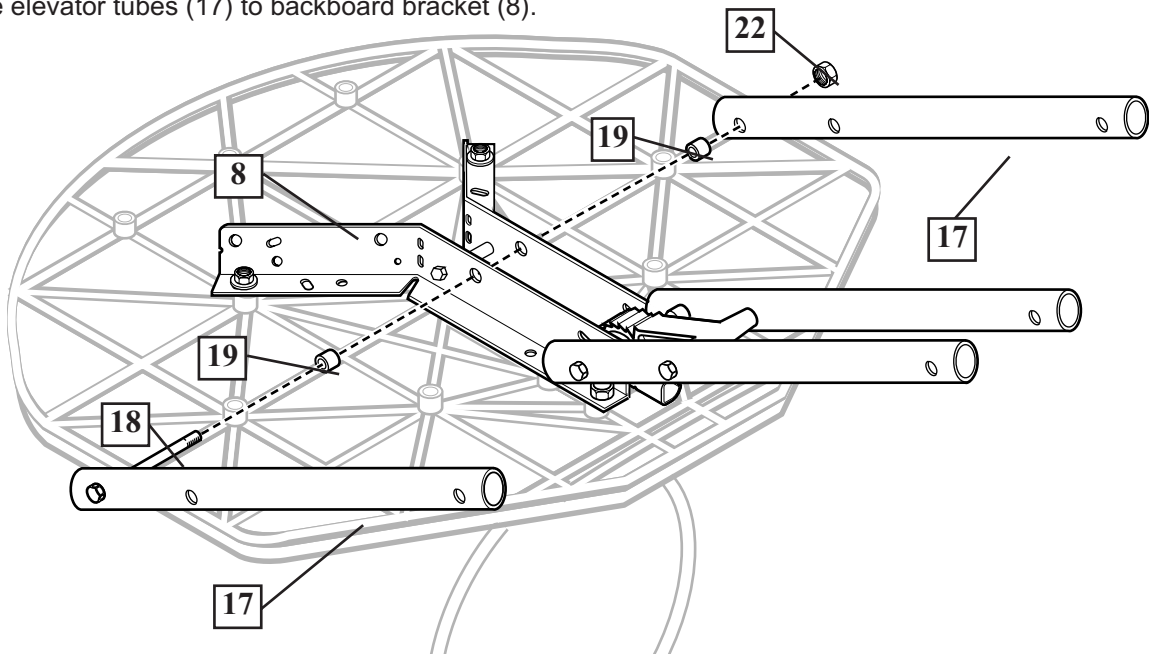

- 14.** **NOTE:** Two people are required for this procedure, use caution, elevator assembly is heavy.
Attach backboard and elevator assembly to u-channel (2).

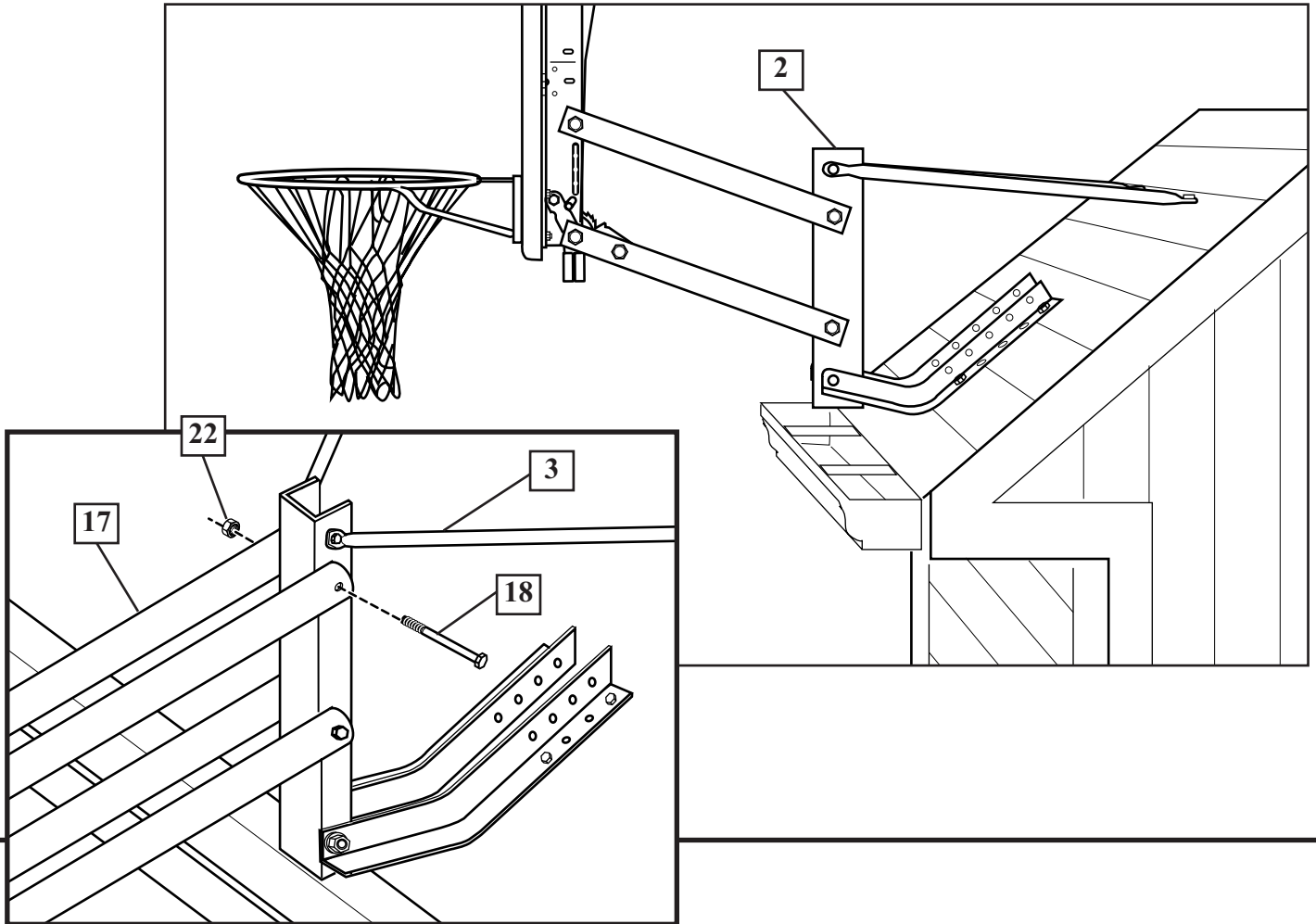

HEIGHT ADJUSTMENT

- 15.** Insert the end of a broom handle or wooden dowel $3/4''-7/8''$ diameter (19-22 mm) into the release lever.

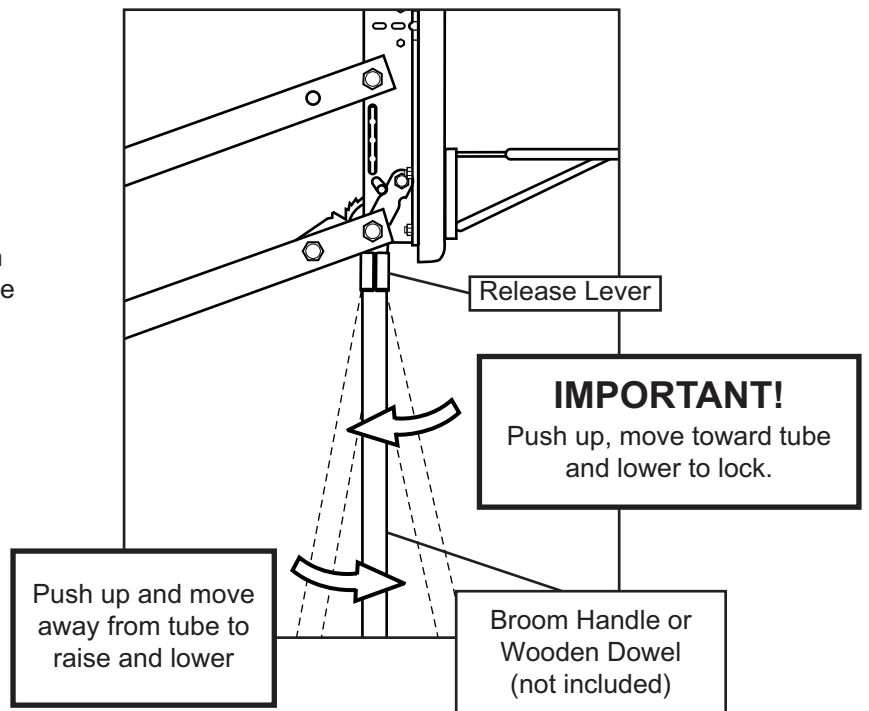

FOR POLE MOUNTING ONLY

1. Assemble mounting brackets (24) to 3-1/2" (8.9 cm) pole as shown. Position bracket assembly to approx. 106" (2.7 m) above level playing surface. Tighten nuts (28) completely. **NOTE: Equal rotations of nuts on each side of u-bolt (25) are necessary.**

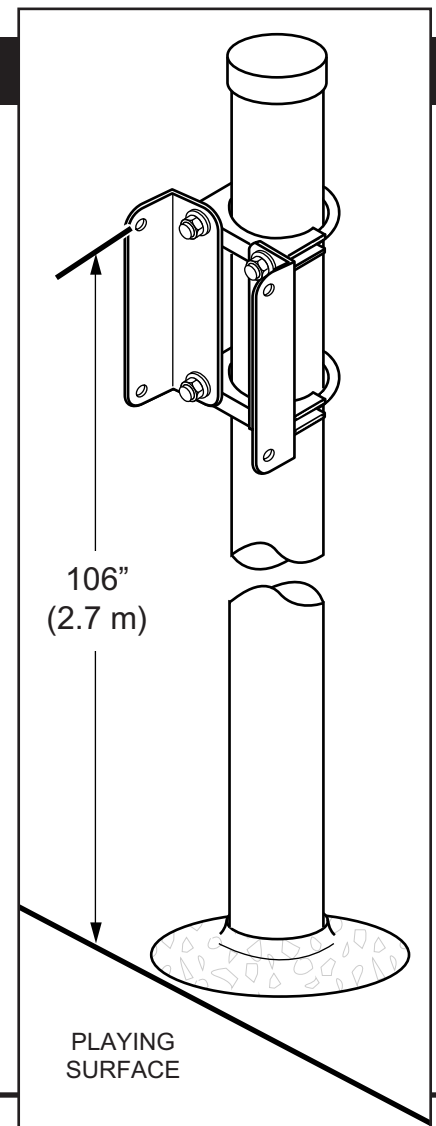
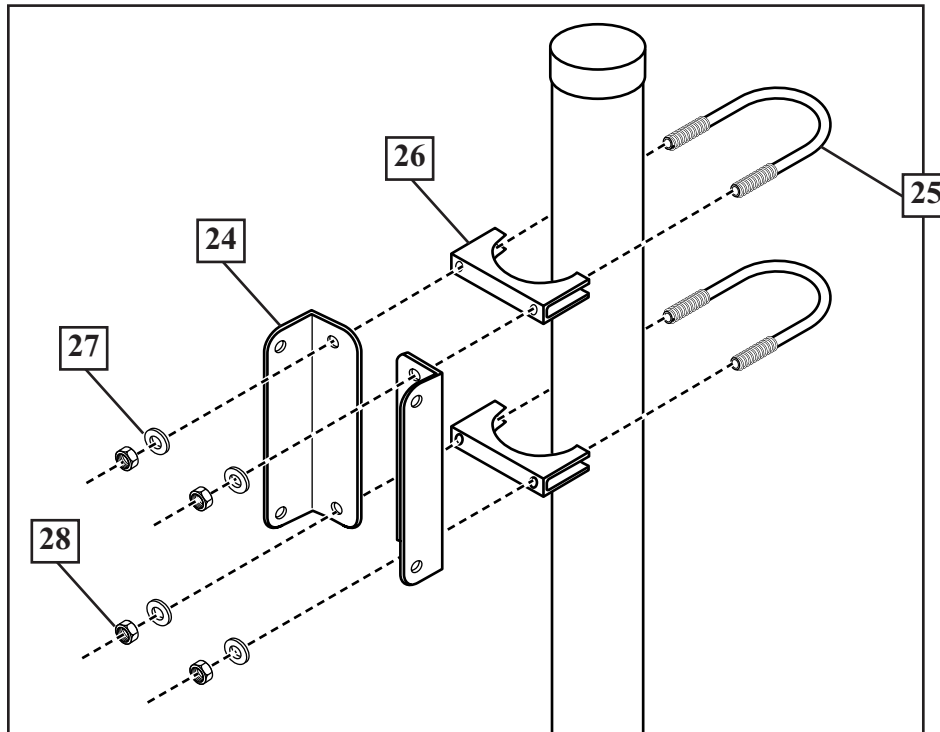

2. **NOTE: Two people required for this procedure, elevator assembly is heavy.** Mount assembled elevator components to mounting bracket (24) as shown. (Refer to Steps 6 through 13 for elevator assembly.)

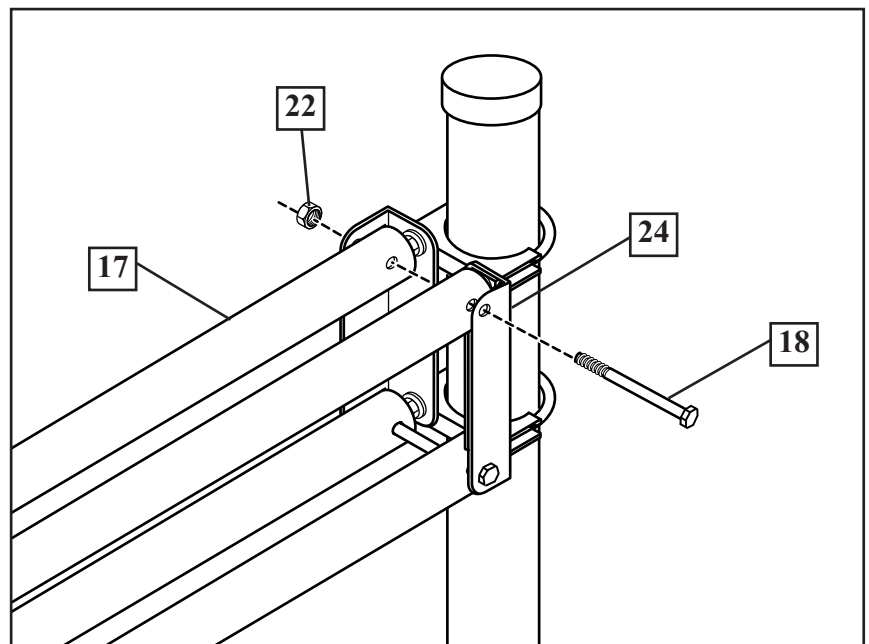

FLAT SURFACE MOUNTING

1. Mark bracket positions on flat solid surface. Upper bracket mounting holes should be located approx. 106" (2.7 m) above playing surface. Drill four, 3/8" (9.5 mm) holes into solid structure for mounting brackets (24).

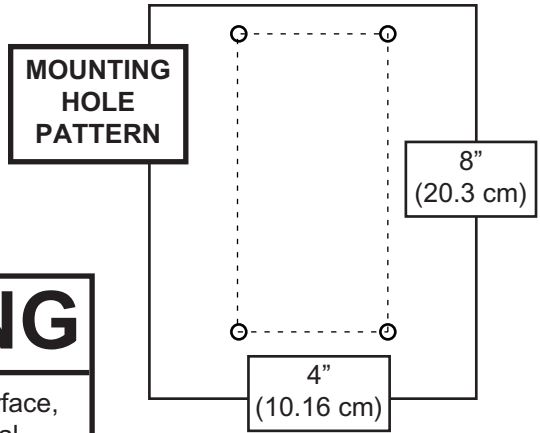

⚠ WARNING

A solid mounting base and/or surface, capable of withstanding normal recreational use forces, must be provided by the customer. A reliable carpenter or building contractor should be consulted if there are questions regarding this procedure.

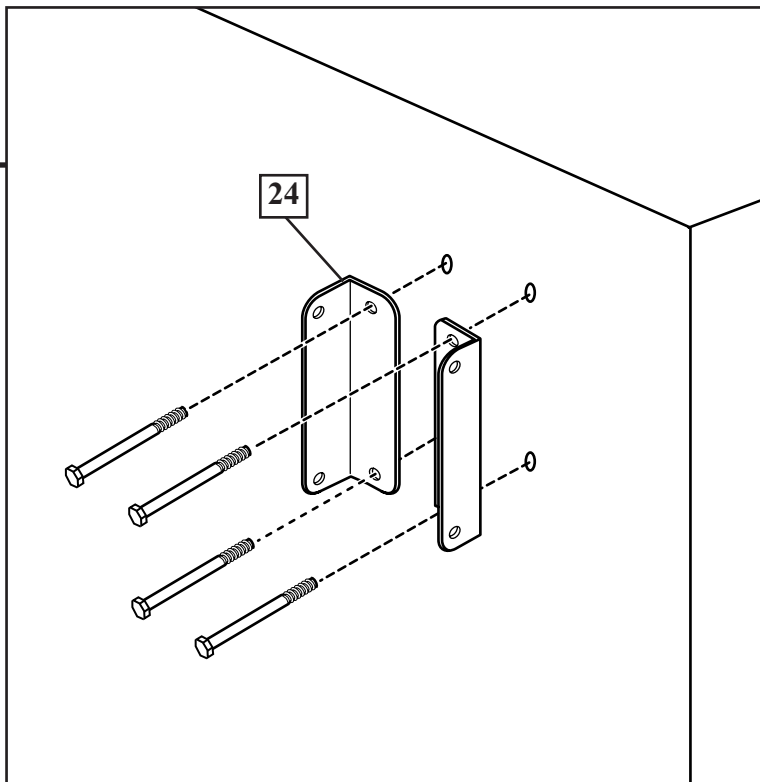
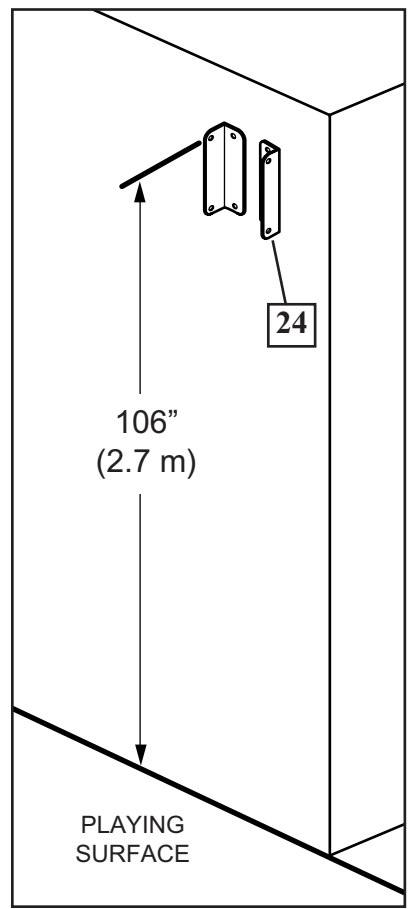

2. Secure mounting brackets (24) to flat solid surface. Install bolt heads outside for safety reasons.

NOTE: Hardware for this procedure not included due to various roof construction materials and design structure.



- 3.** **NOTE:** Two people required for this procedure, elevator assembly is heavy. Mount assembled elevator components to mounting brackets (24) as shown. (Refer to Steps 6 through 13 for elevator assembly.)

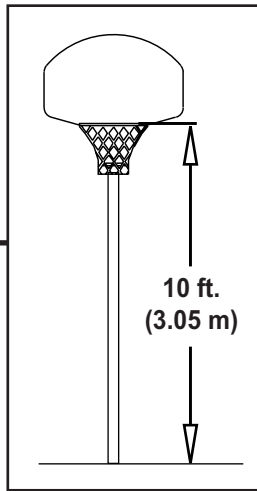
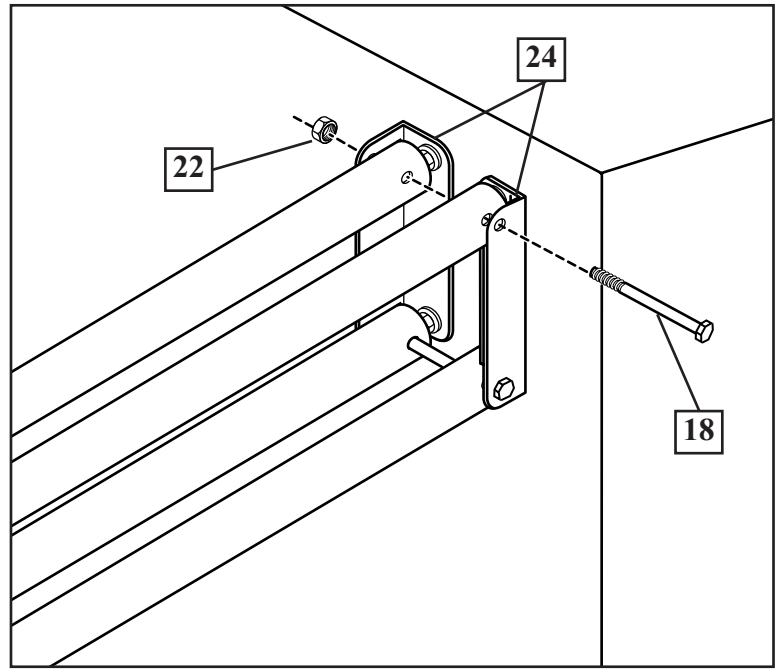

**REGULATION RIM HEIGHT
IS 10 FEET (3.05 m).**



PARTS LIST

<u>Item</u>	<u>Qty.</u>	<u>Part No.</u>	<u>Description</u>	<u>Item</u>	<u>Qty.</u>	<u>Part No.</u>	<u>Description</u>
1	1	206117	Label, Warning	15	1	240017	Bolt, Hex Head, 1/4-20 x 2-1/4 Long
2	1	906377	U-Channel	16	1	203493	Locknut, Hex Head 1/4-20
3	2	906206	Struts	17	4	904807	Elevator Tube, (Black)
4	2	202662	Bolt, Hex Head 5/16-18 x 4-1/2	18	5	201640	Bolt, Hex Head, 1/2-13 x 7-1/4 Long
5	2	203099	Nut, Lock 5/16-18	19	4	201642	Spacer, Plastic
6	1	906350	Bracket, Angled, Left	20	1	201140	Wave Washer
7	1	906349	Bracket, Angled, Right	21	1	201156	Ratchet
8	2	900846	Board Bracket, (Black)	22	6	206340	Locknut, Hex Head, 1/2-13
9	1	201122	Bolt, Hex Head, 3/8-16 x 3-1/4 Long	23	1	201125	Spring
10	2	201133	Support Bracket	24	2	900866	Bracket, Pole
11	2	201129	Spacer, 1-3/4 Long	25	2	203437	U-Bolt, 3/8-16 x 4-1/2
12	1	201126	Release Lever	26	2	202675	Clamp, Saddle
13	1	800878	Pawl & Pin Assembly	27	4*	203309	Washer 13/32 x 1
14	1	201124	Locknut, Hex Head, 3/8-16	28	4*	203017	Hex Nut, 3/8-16

HARDWARE IDENTIFIER

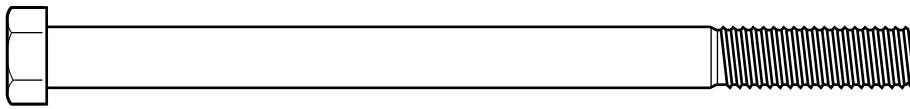

Item #4 (2)

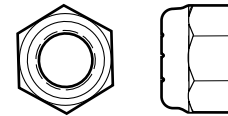

Item #5 (2)

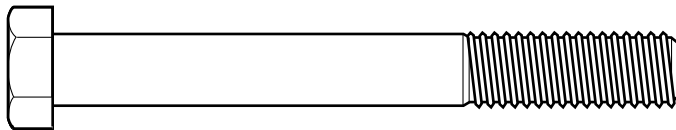

Item #9 (1)

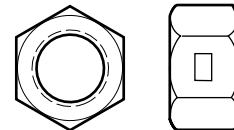

Item #14 (1)

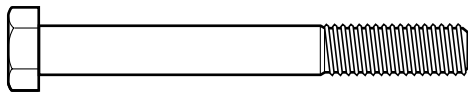

Item #15 (1)

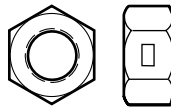

Item #16 (1)

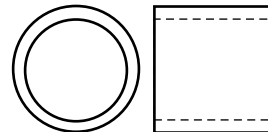

Item #19 (4)

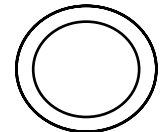

Item #20 (1)

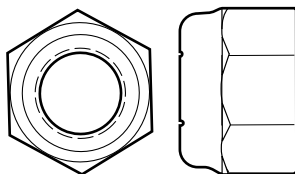

Item #22 (6)

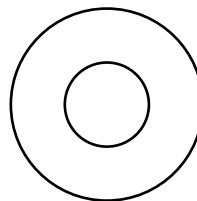

Item #27 (4)*

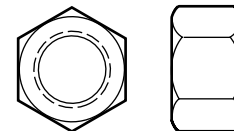

Item #28 (4)*

* YOU MAY HAVE EXTRA PARTS WITH THIS MODEL.



Free Manuals Download Website

<http://myh66.com>

<http://usermanuals.us>

<http://www.somanuals.com>

<http://www.4manuals.cc>

<http://www.manual-lib.com>

<http://www.404manual.com>

<http://www.luxmanual.com>

<http://aubethermostatmanual.com>

Golf course search by state

<http://golfingnear.com>

Email search by domain

<http://emailbydomain.com>

Auto manuals search

<http://auto.somanuals.com>

TV manuals search

<http://tv.somanuals.com>