

Portable Basketball System Owners Manual

! SAFETY INSTRUCTIONS !

FAILURE TO FOLLOW THESE SAFETY INSTRUCTIONS MAY RESULT IN SERIOUS INJURY, PROPERTY DAMAGE AND WILL VOID WARRANTY.

Owner must ensure that all players know and follow these rules for safe operation of the system.

To ensure safety, do not attempt to assemble this system without following the instructions carefully. Proper and complete assembly, use and supervision is essential for proper operation and to reduce the risk of accident or injury. A high probability of serious injury exists if this system is not installed, maintained, and operated properly. Check entire box and inside all packing material for parts and/or additional instructional material. Before beginning assembly, read the instructions and identify parts using the hardware identifier and parts list in this document.

- If using a ladder during assembly, use extreme caution.
- Two (2) people are recommended for this operation.
- Check base regularly for leakage. Slow leaks could cause system to tip over unexpectedly.
- Seat the pole sections properly (if applicable). Failure to do so could allow the pole sections to separate during play and/or transport of the system.
- Climate, corrosion or misuse could result in system failure.
- Minimum operational height is 6' 6" (1.98 m) to the bottom of backboard.
- This equipment is intended for home recreational use only and NOT excessive competitive play.
- Read and understand the warning label affixed to pole. Label is shown on page 2.
- The life of your basketball pole depends on many conditions. The climate, placement of the pole, the location of the pole, exposure to corrosives such as pesticides, herbicides or salts are all important.
- If technical assistance is required, contact Huff Sports.
- Adult supervision is recommended when adjusting height.

*Most injuries are caused by misuse and/or not following instructions.
Use caution when using this system.*

For more information on assembly, placement, proper use and maintenance, visit The American Basketball Council website at <http://www.smarthoops.com>.

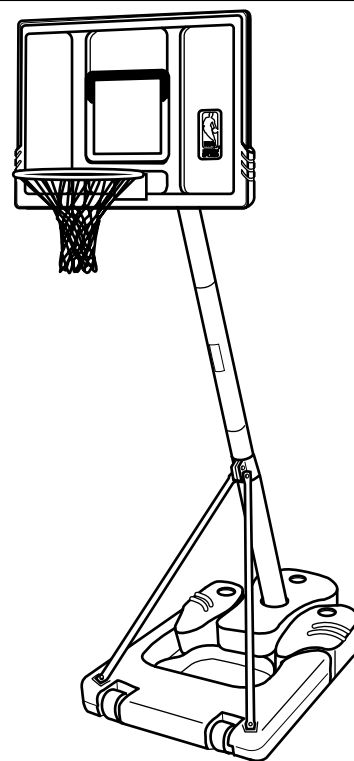

REQUIRED TOOLS AND MATERIALS:

- (Two) People
- Tape Measure
- Tape
- Wood Board (Scrap)
- Wrenches: (Two) 1/2", 9/16", 3/4" or (Two) Large and Small Adjustable Wrenches (9/16" Deep Socket w/Ext. Recommended)
- Garden Hose or Sand (420 lb.) (191 kg)
- 2 Gallons (7.6 Liters) of Non-Toxic Antifreeze
- Sawhorse or Support Table
- Two Step Ladders 8 ft. (2.4 m)

In U.S. and Canada only: Have questions...don't go back to the store!

We appreciate your purchasing one of our many fine products. We are sure that you will be very satisfied with your selection. Although great care and effort have been taken, occasionally problems may occur. To ensure prompt and correct handling of any problems, or to answer any questions, please contact our Toll-Free Customer Service Number listed below. **Service will be quicker if you have your Model Number (found on carton) and assembly instructions ready when calling. PLEASE WRITE YOUR MODEL NUMBER IN THE SPACE PROVIDED ABOVE.**

Toll-Free Customer Service Number for U.S: **1-800-558-5234** Canada Only: **1-800-284-8339**
Internet Address: <http://www.huffysports.com>

WARNING

FAILURE TO FOLLOW THESE WARNINGS MAY RESULT IN SERIOUS INJURY AND/OR PROPERTY DAMAGE.

Owner must ensure that all players know and follow these rules for safe operation of the system.

- DO NOT HANG on the rim or any part of the system including backboard, support braces or net.
- During play, especially when performing dunk type activities, keep player's face away from the backboard, rim and net. Serious injury could occur if teeth/face come in contact with backboard, rim or net.
- Do not slide, climb, shake or play on base and/or pole.
- After assembly is complete, fill system completely with water or sand and stake to the ground. Never leave system in an upright position without filling base with weight, as system may tip over causing injuries.
- When adjusting height or moving system, keep hands and fingers away from moving parts.
- Do not allow children to move or adjust system.
- During play, do not wear jewelry (rings, watches, necklaces, etc.). Objects may entangle in net.
- Surface beneath the base must be smooth and free of gravel or other sharp objects. Punctures cause leakage and could cause system to tip over.
- Keep organic material away from pole base. Grass, litter, etc. could cause corrosion and/or deterioration.
- Check pole system for signs of corrosion (rust, pitting, chipping) and repaint with exterior enamel paint. If rust has penetrated through the steel anywhere, replace pole immediately.
- Check system before each use for proper ballast, loose hardware, excessive wear and signs corrosion and repair before use.
- Check system before each use for instability.
- Do not use system during windy and/or severe weather conditions; system may tip over. Place system in the storage position and/or in an area protected from the wind and free from personal property and/or overhead wires.
- Never play on damaged equipment.
- See instruction manual for proper installation and maintenance.
- When moving system, use caution to keep mechanism from shifting.
- Keep pole top covered with cap at all times.
- Do not allow water in tank to freeze. During sub-freezing weather add non-toxic antifreeze, sand or empty tank completely and store. (Do not use salt.)
- Use extreme caution if placing system on sloped surface. System may tip over more easily.

HUFFY® SPORTS

In the U.S.: 1-800-558-5234 and Canada: 1-800-284-8339

201241 2/99

30

HEIGHT ADJUSTMENT

TO ADJUST BACKBOARD:

Position looped end of crank onto hook as shown. Rotate crank handle to raise or lower backboard.

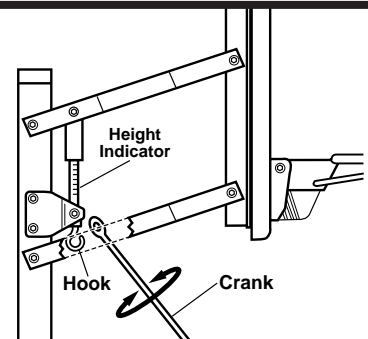

MOVING SYSTEM

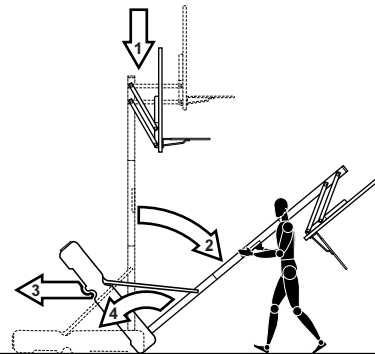

1. Adjust basketball backboard height to lowest position.
2. Rotate basketball system forward, while holding pole, until wheels engage with ground.
3. Move basketball system to desired location.
4. Carefully rotate basketball system upright.
5. Reattach ground restraint and check system for stability.

201254 2/99

1. Remove all parts from packing material and separate tanks from the shipping position.
2. Carefully, position front tank (1) upside down. Secure wheel (2) into place from bottom side (illust. A) making sure the wheel bracket (5) seeds into base as in illust. B. Repeat procedure for opposite wheel. Finger tighten, then upright assembly.

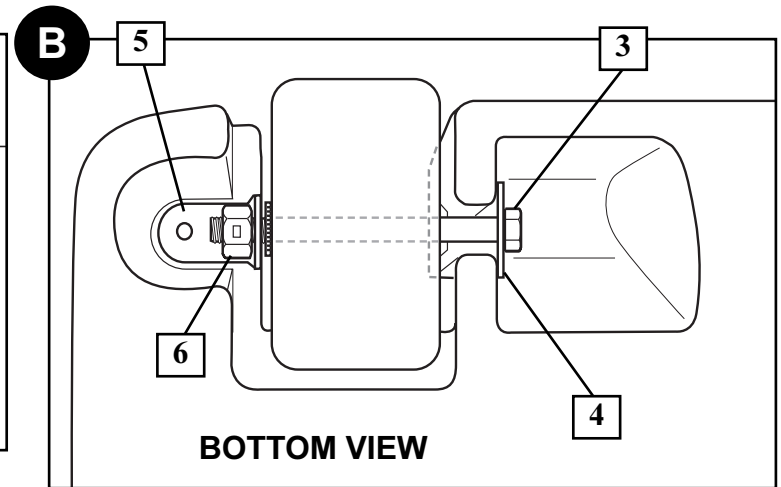
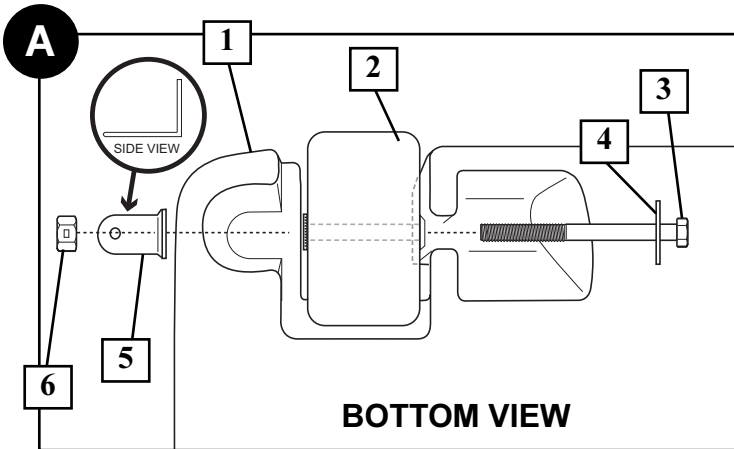

3. Correctly identify each pole section and mark tape as shown.

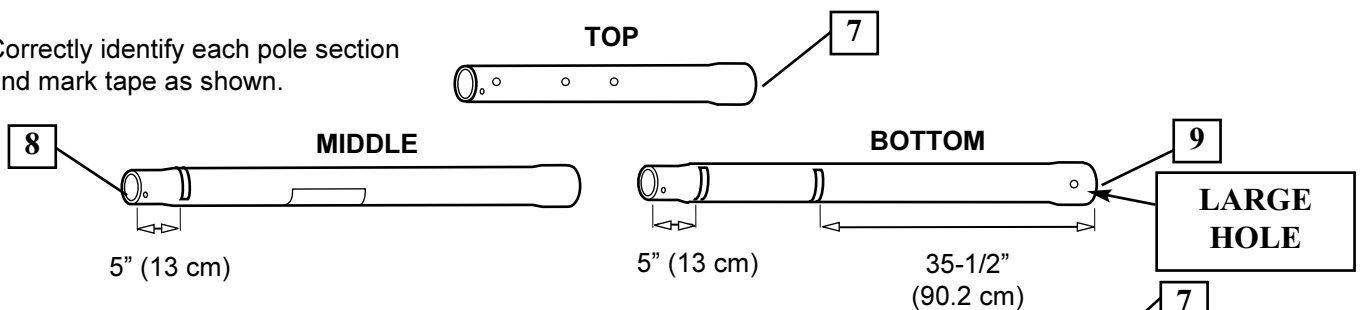

4. **IMPORTANT!** Bounce pole top (7) and middle section (8) together as shown until they no longer move toward taped reference mark. Upright assembly.

NOTE: Pole sections should have a 3-3/4" (9.5 cm) minimum overlap.

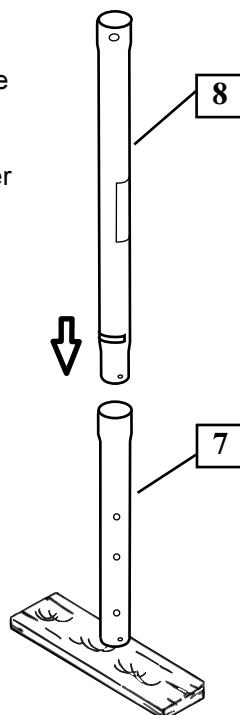

5. **IMPORTANT!** Holes in top (7) and bottom pole (9) sections **MUST ALIGN** to correctly position elevator system toward playing surface. Add bottom pole section (9) to assembly as shown and bounce until completely tight.

NOTE: Pole sections should have a 3-3/4" (9.5 cm) minimum overlap.

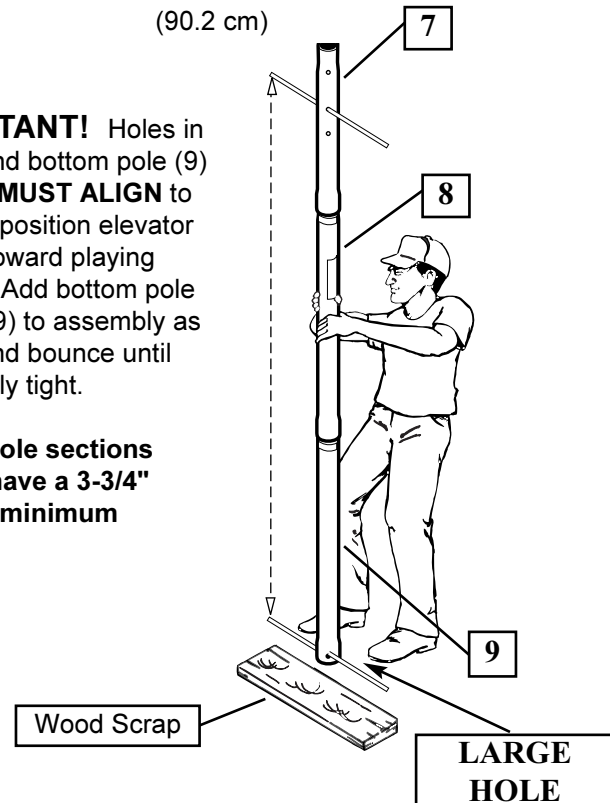

6. Spread collar (10) open and carefully raise collar (10) to 35-1/2" (90.2 cm) taped mark. Finger tighten hardware to prevent collar (10) from moving and scratching pole.

NOTE: Avoid scratching pole.

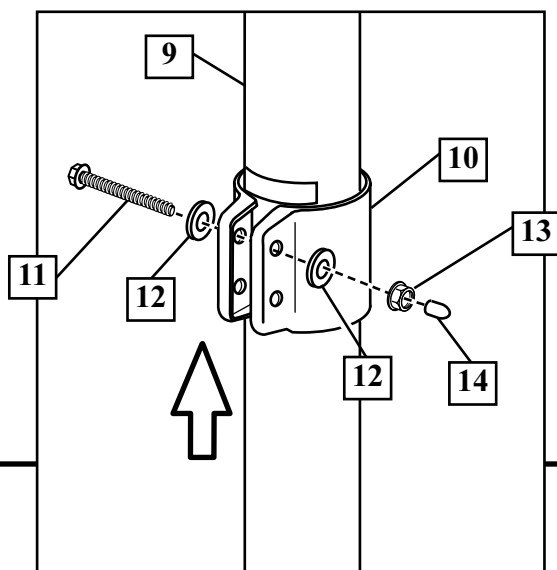

7. Install rod (15) through holes in bottom pole section (9) and eyebolt (16).

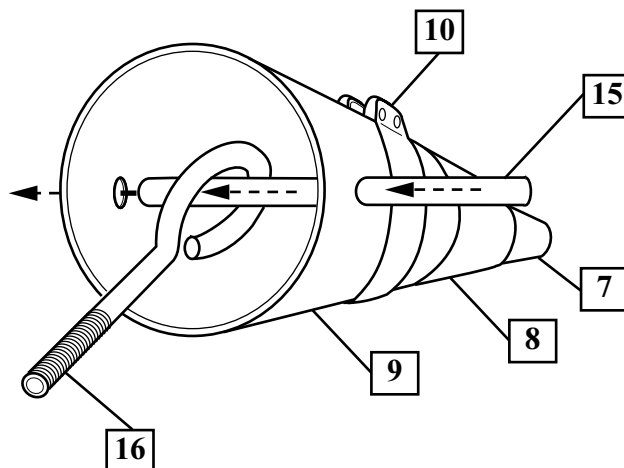

8. Set rear tank (17) onto front tank (1) and insert pole assembly into tank assembly as shown.

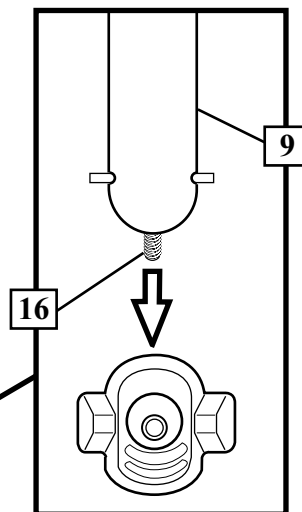
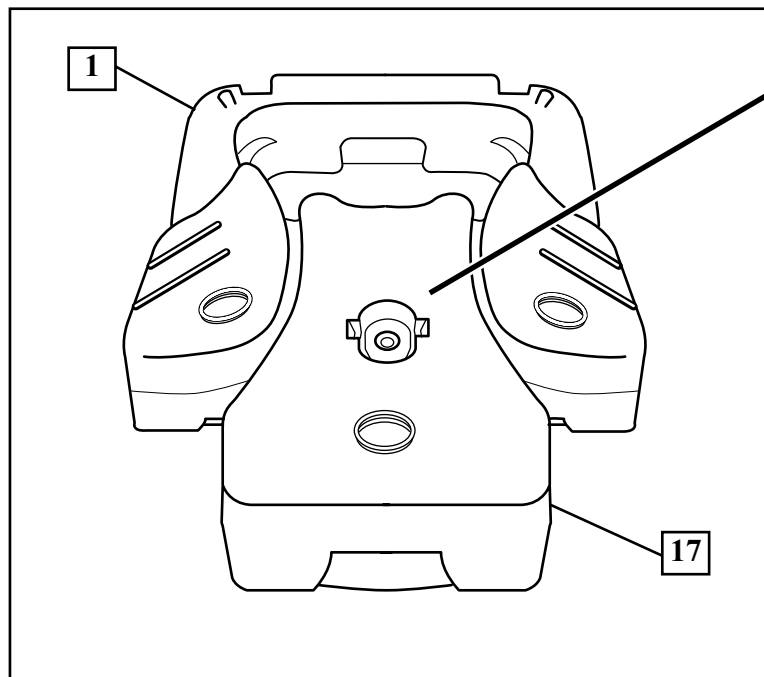

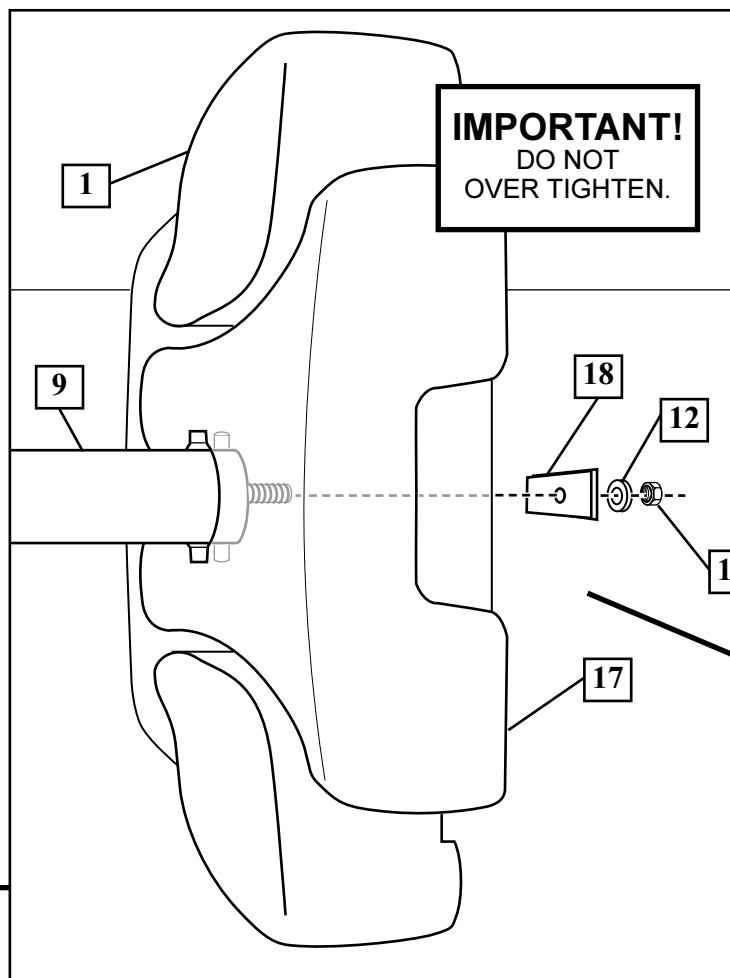

9. Carefully position system on its side, and secure bottom of pole to tank as shown, a deep socket is recommended. Upright system.

NOTE: Keep unnecessary pressure off of the pole assembly when in this position. Two people recommended for this step.

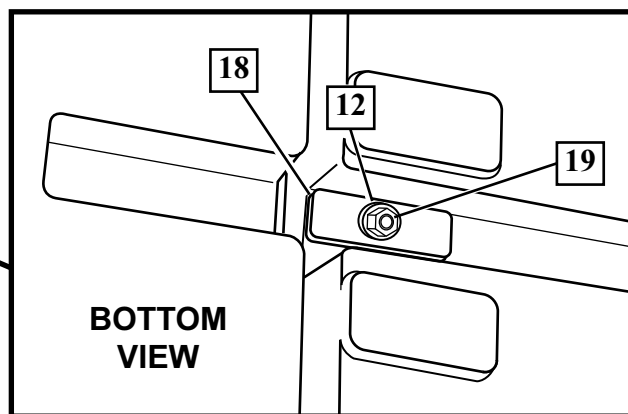

10. Loosen hardware on collar (10) and secure struts (20) to collar (10) as shown and tighten.

NOTE: Final adjustments to collar may need to be made. Refer to Step 32.

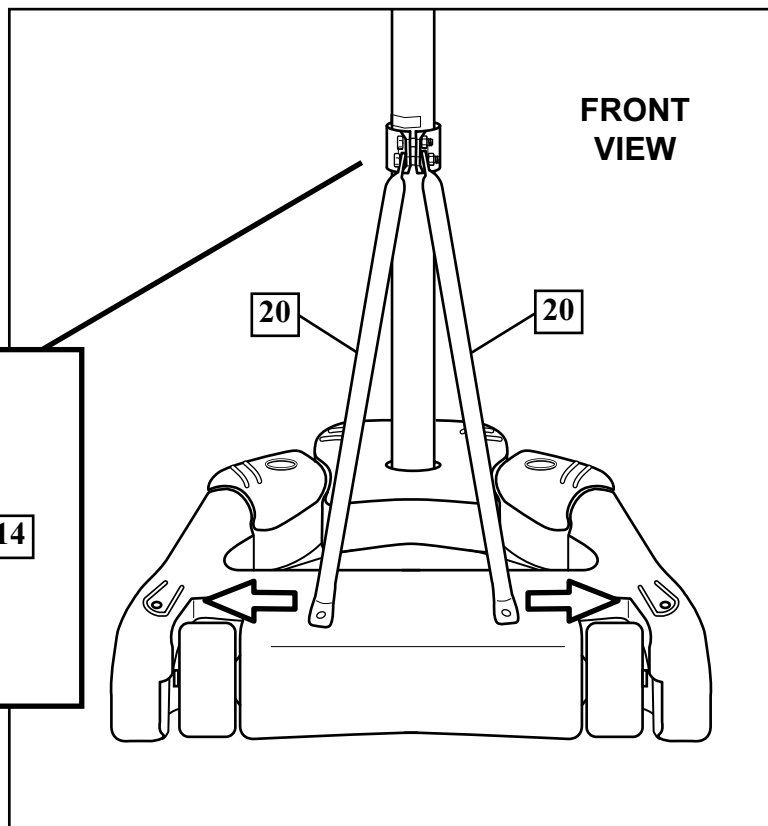
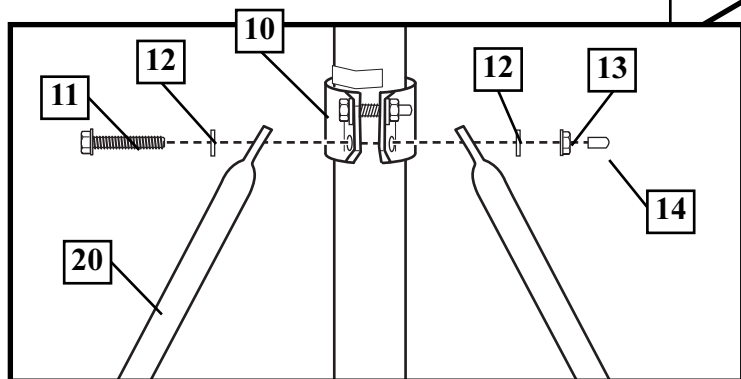

- 11.** Once again, carefully position system in the side position and secure strut (20) to tank (1) as shown. Repeat for opposite side. Completely tighten including bolts from step 2 then carefully upright system.

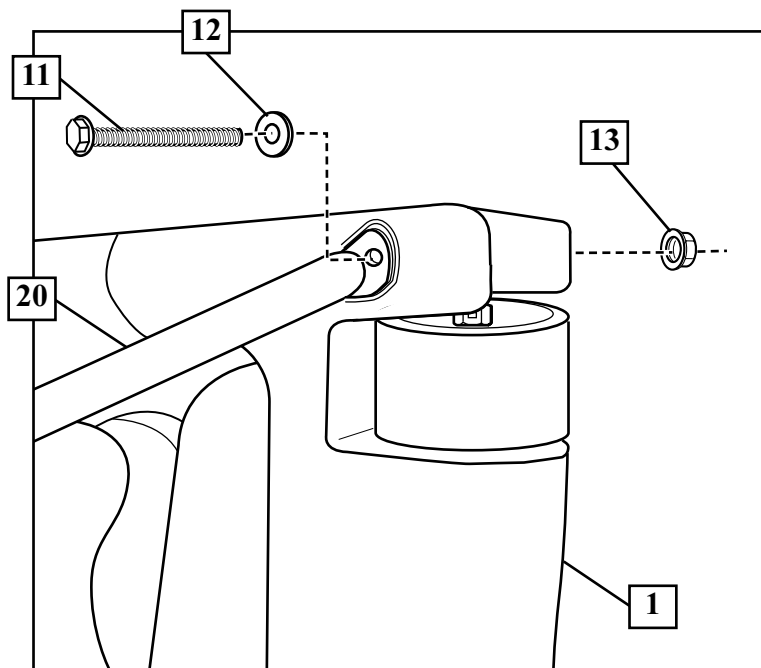

- 13.** Install left screw jack support plate (26) and right screw jack support plate (27) to pole. Finger tighten.

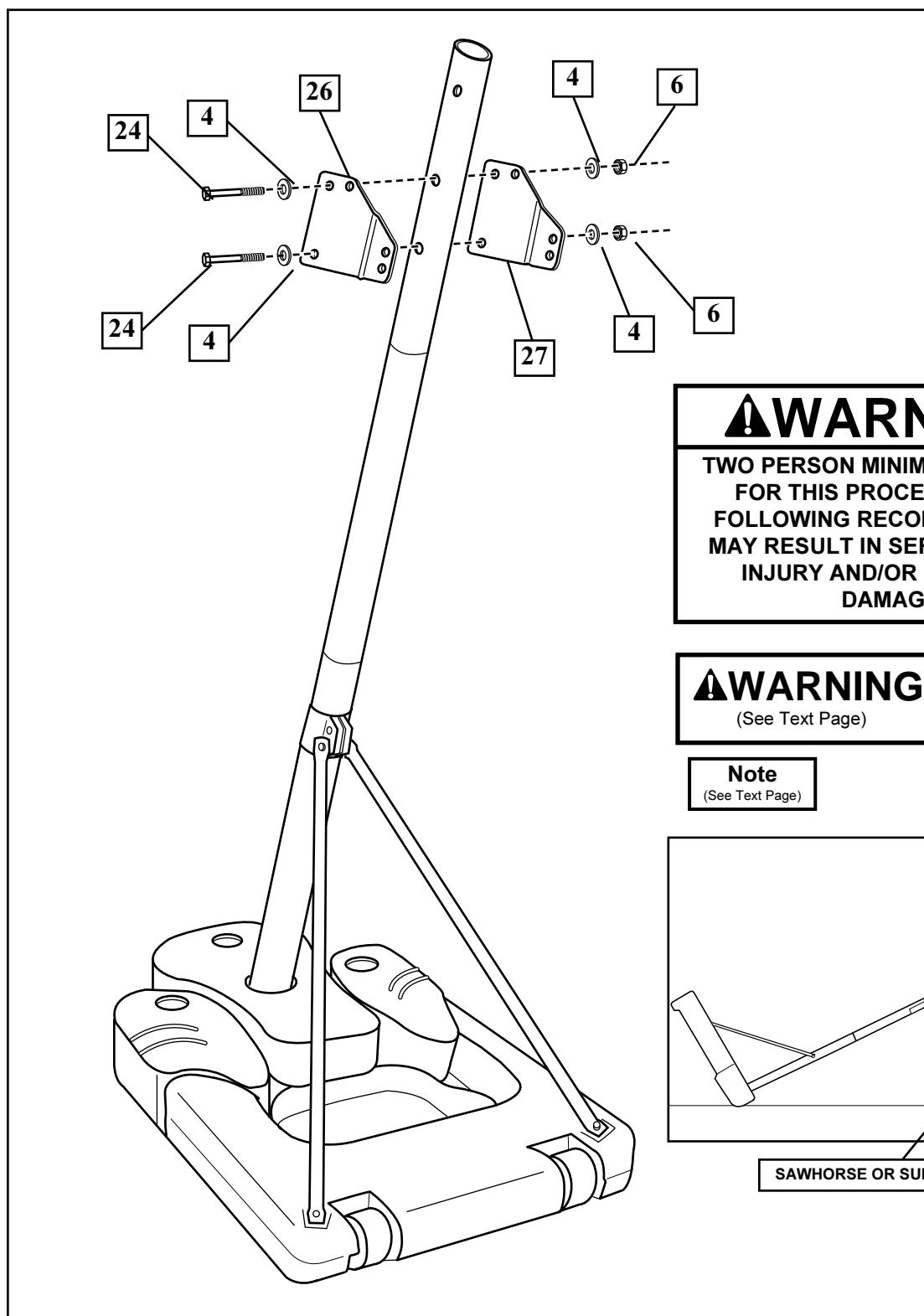

⚠ WARNING

TWO PERSON MINIMUM REQUIRED FOR THIS PROCEDURE. NOT FOLLOWING RECOMMENDATION MAY RESULT IN SERIOUS BODILY INJURY AND/OR PROPERTY DAMAGE.

⚠ WARNING

(See Text Page)

Note

(See Text Page)

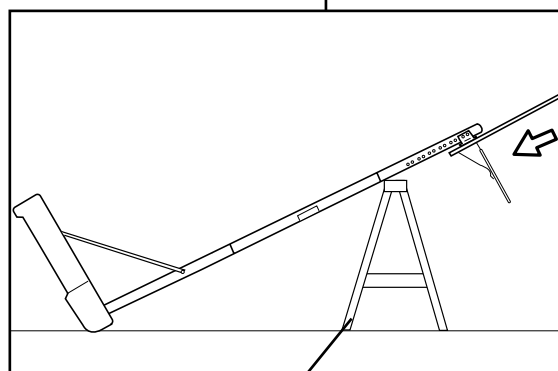

SAWHORSE OR SUPPORT TABLE

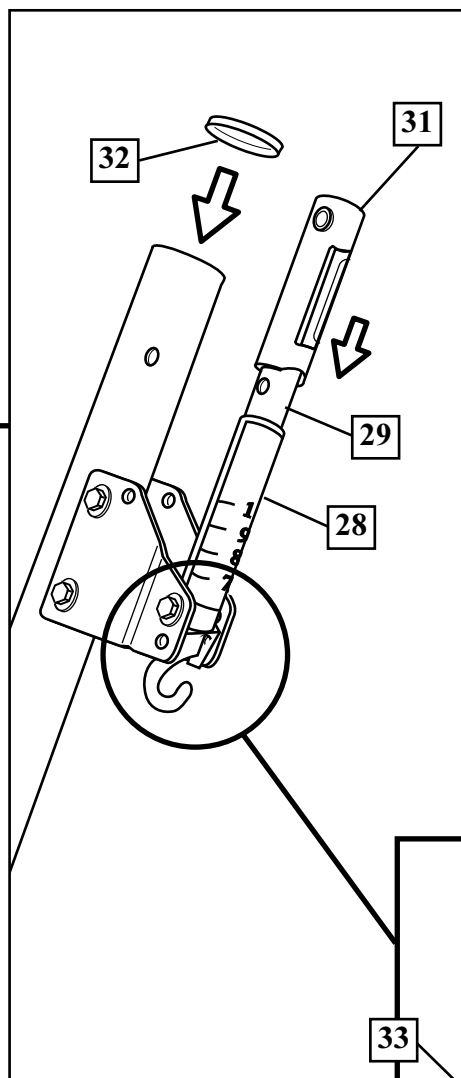

14. Attach height decal (28) on screw jack (29). Align lower edge of decal with bottom of black indicator tube.

⚠ WARNING

TWO PERSON MINIMUM REQUIRED FOR THIS PROCEDURE. NOT FOLLOWING RECOMMENDATION MAY RESULT IN SERIOUS BODILY INJURY AND/OR PROPERTY DAMAGE.

15. Center screw jack (29) between support plates (26 & 27) and secure as shown below. Finger tighten.

16. Place cover over screw jack (29). Install pole cap (32).

FRONT VIEW OF ASSEMBLY

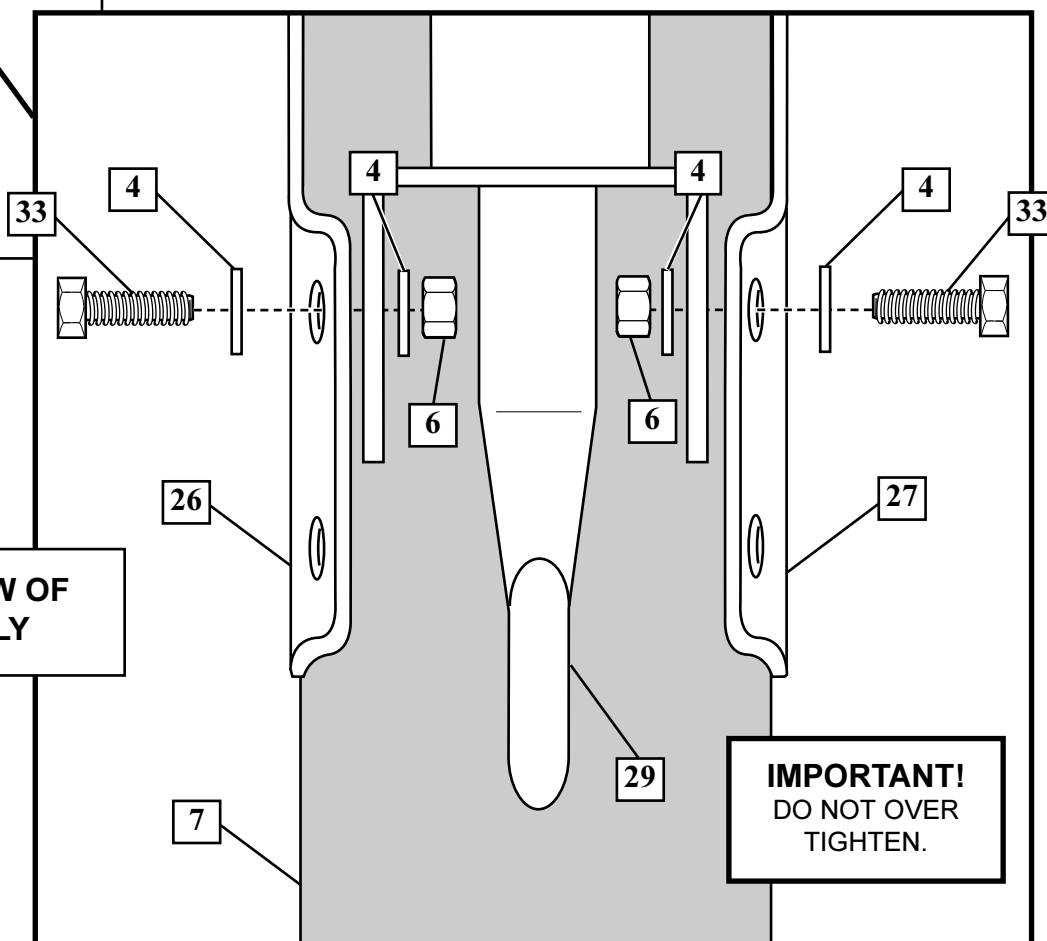

IMPORTANT!
DO NOT OVER
TIGHTEN.

17.

NOTE: Be sure to use proper bracket as shown.

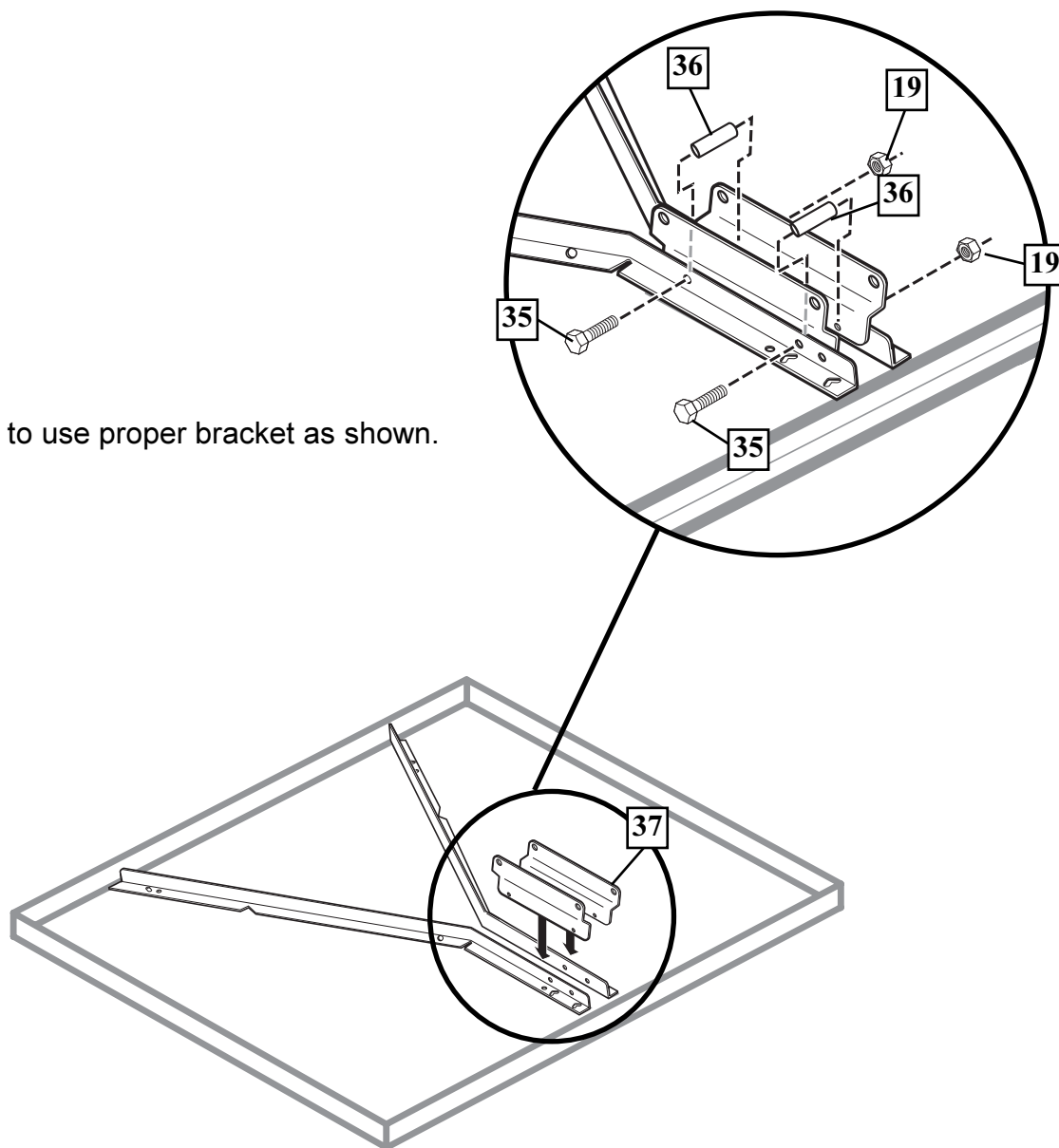

18. Finger tighten.

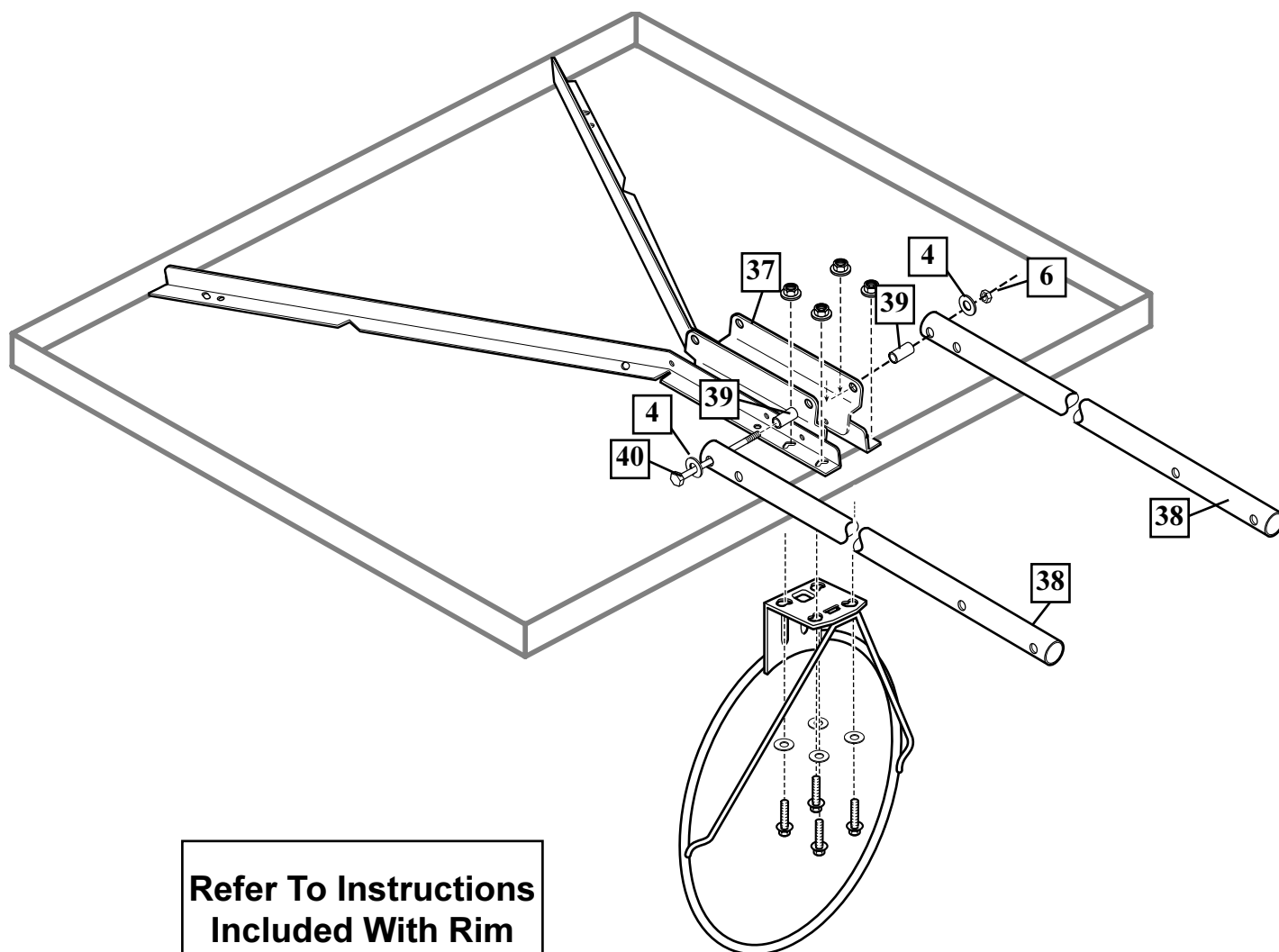

**Refer To Instructions
Included With Rim
Hardware For Rim
Assembly.**

20.

Finger tighten.

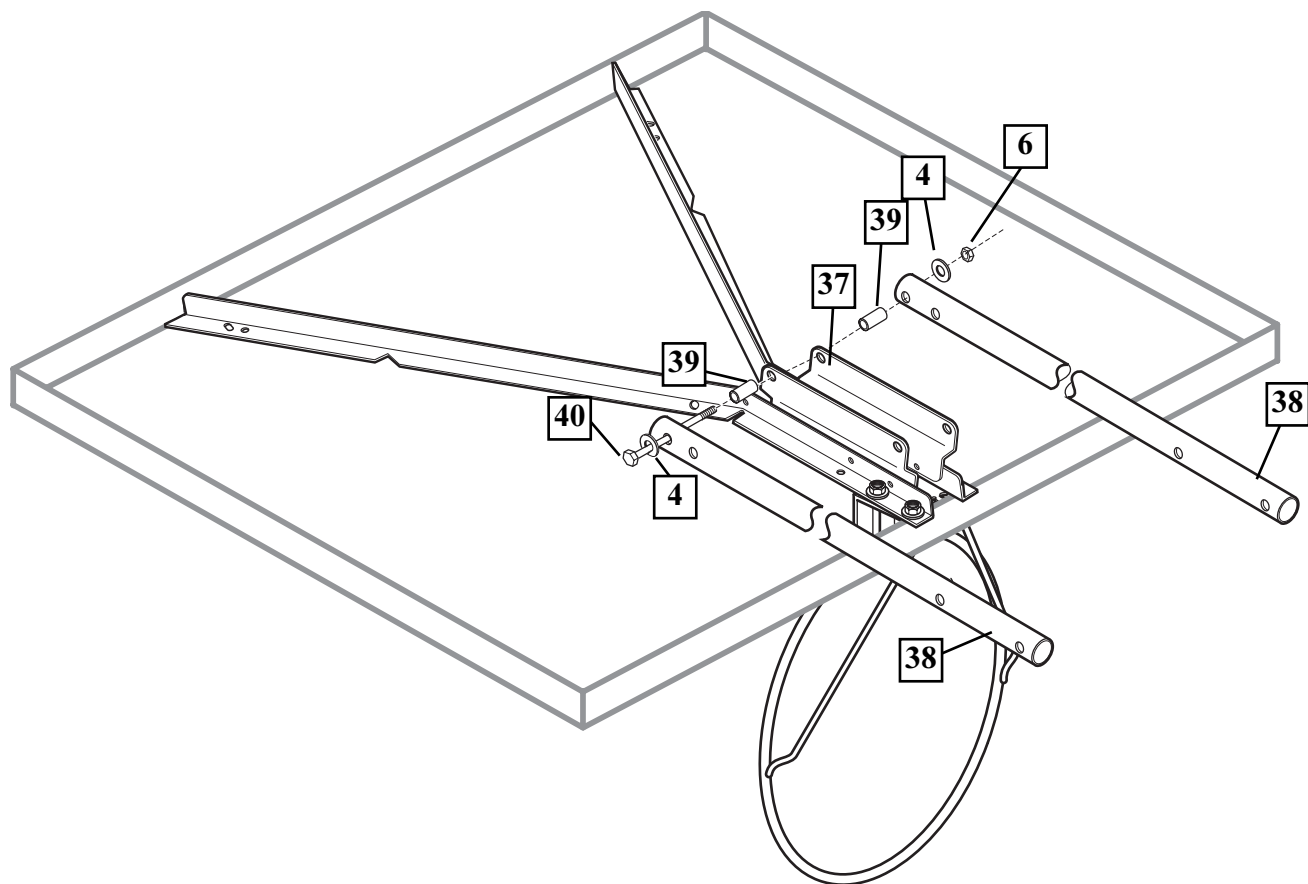

21. Secure board and elevator tube assembly to pole assembly as shown. Finger tighten.

IMPORTANT!
DO NOT OVER
TIGHTEN.

⚠ WARNING

TWO PERSON MINIMUM
REQUIRED FOR THIS
PROCEDURE. NOT
FOLLOWING
RECOMMENDATION
MAY RESULT IN
SERIOUS BODILY
INJURY AND/OR
PROPERTY DAMAGE.

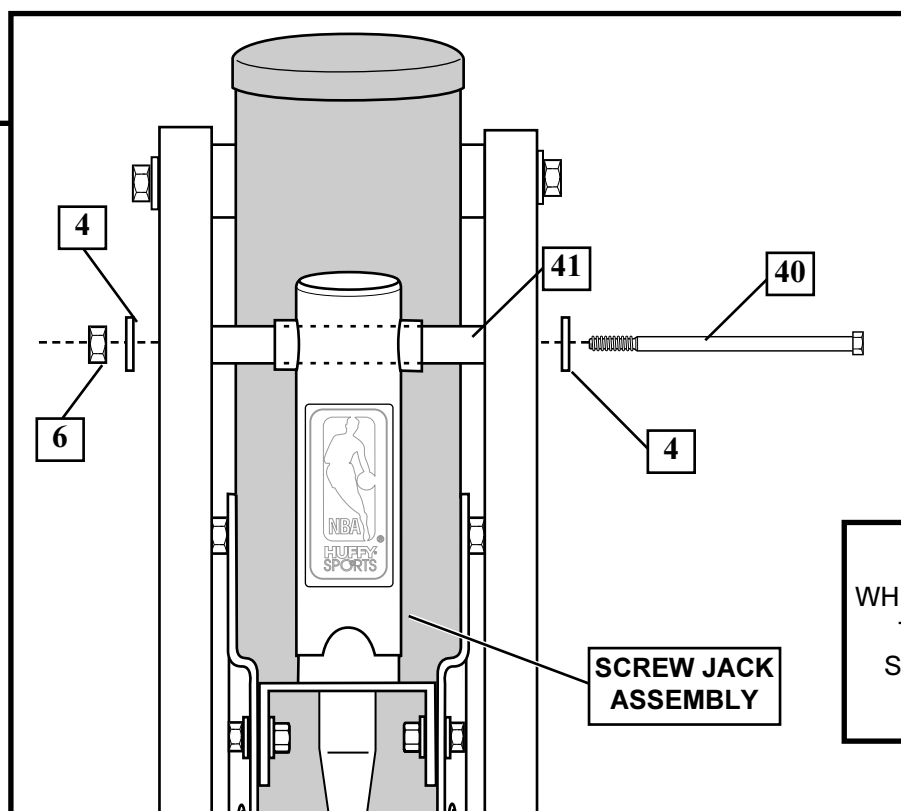
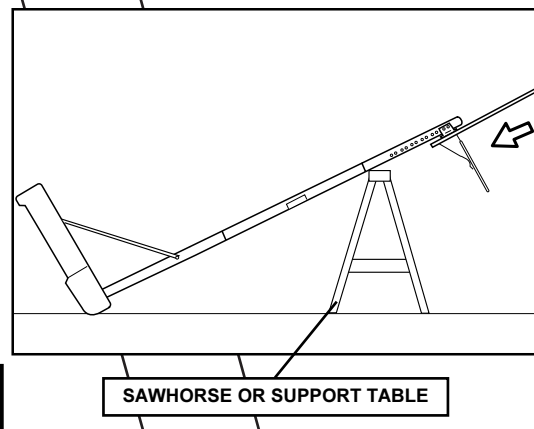
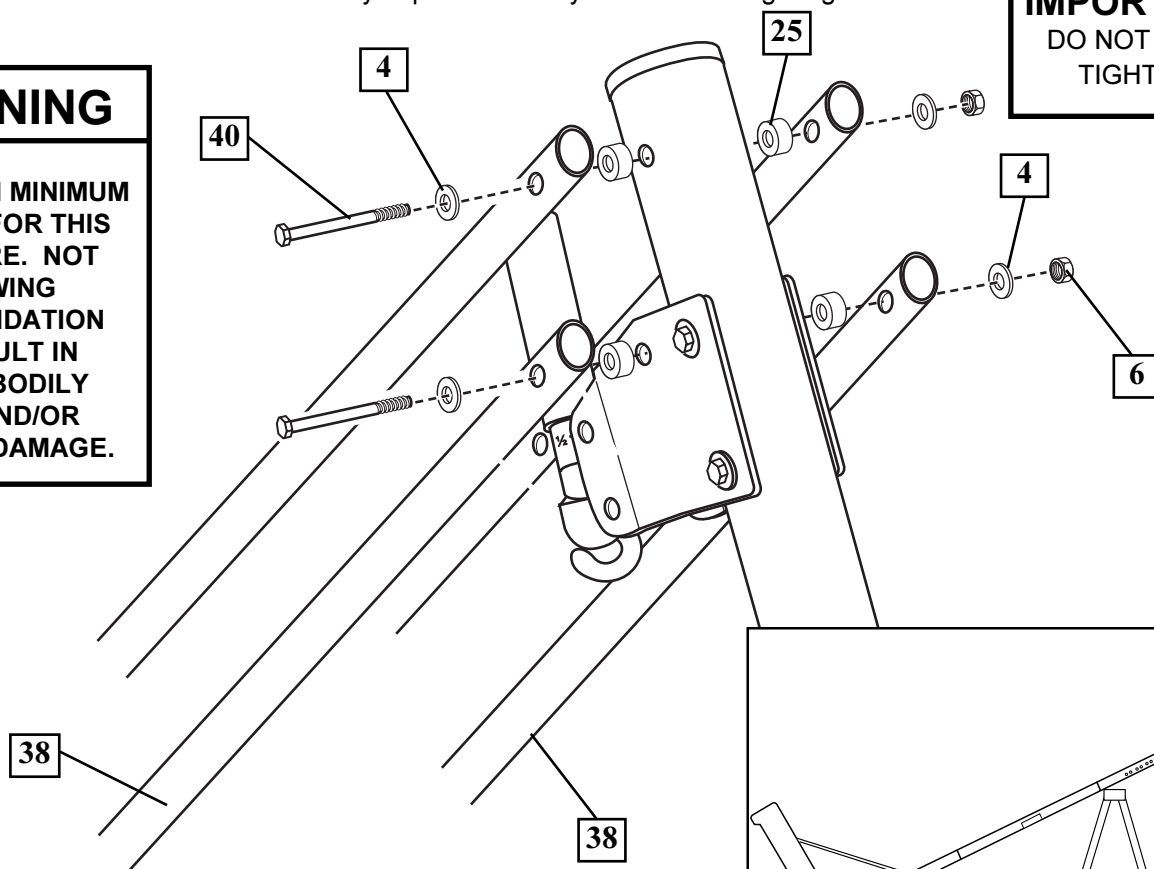

22.

Insert spacer (41) through top holes of height indicator cover (31) and screw jack assembly as shown. Align spacer and screw jack assembly between elevator tubes (34) and secure.

NOTE:

NOW COMPLETELY TIGHTEN ALL
BOLTS FROM STEPS 13-22.

IMPORTANT!

WHEN SECURING SCREW JACK (20) TO
TOP ELEVATOR TUBES (34), USE
SPACER (41) BETWEEN ELEVATOR
TUBES AS SHOWN.

23.

⚠ WARNING

DO NOT LEAVE ASSEMBLY
UNATTENDED WHEN EMPTY,
IT MAY TIP OVER.

Roll assembly to desired playing area.
Secure assembly to ground using rope
(21) and tie down stake (22). Fill larger
tank (1) with water (approx. 24 gallons (91
liters)) or sand (approx. 300 lbs (136 kg))
and smaller tank (17) with (approx. 10
gallons (78.9 liters)) or sand (approx. 120
lbs (54.4 kg)) and snap fill caps (23) in
place.

IMPORTANT!

**Two Gallons (7.6 Liter) of
Non-Toxic Antifreeze
Required.** Add one gallon
(3.8 liters) to each tank to
prevent freezing in sub-
freezing climates.

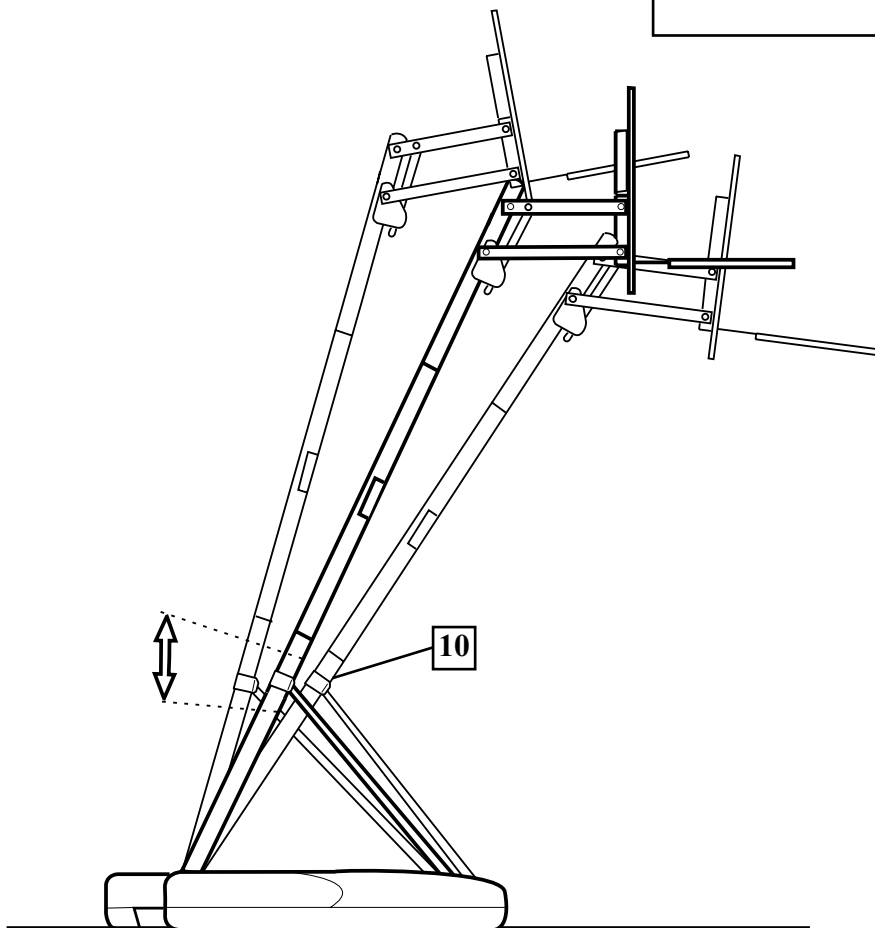
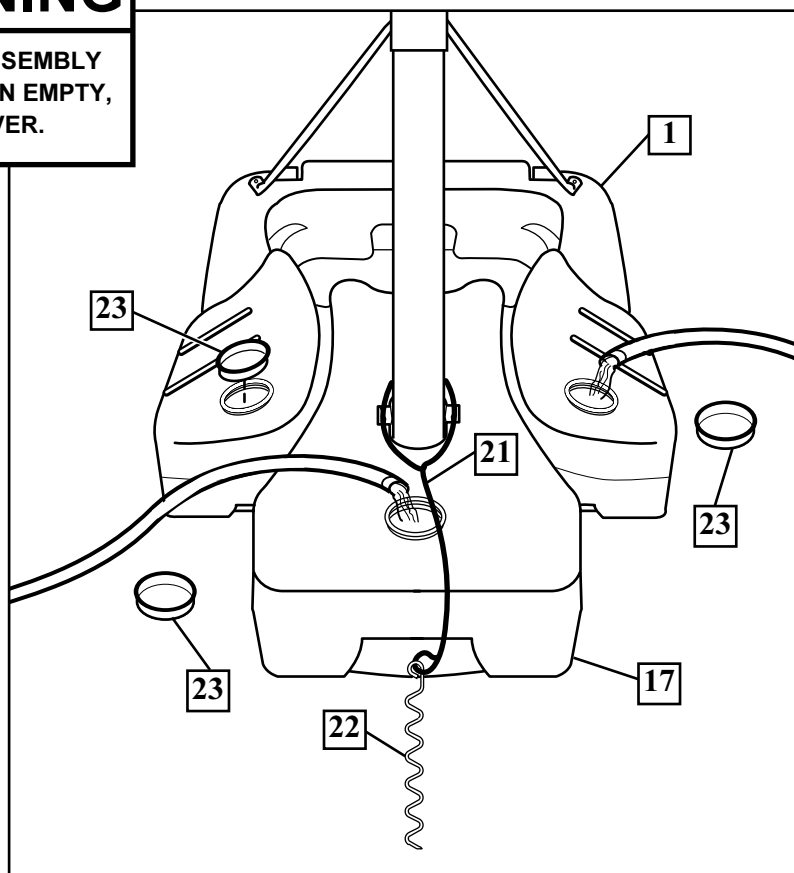

24.

Make final adjustments to level
the rim. If backboard and rim are
tipped back, raise collar (10) until
level and tighten. If backboard
and rim are tipped forward, lower
collar until level and tighten.
Maximum adjustment travel is 33"
to 37" (84-94 cm) from bottom of
pole to top of collar.

25. Apply height adjustment label (30) to front of pole as shown.

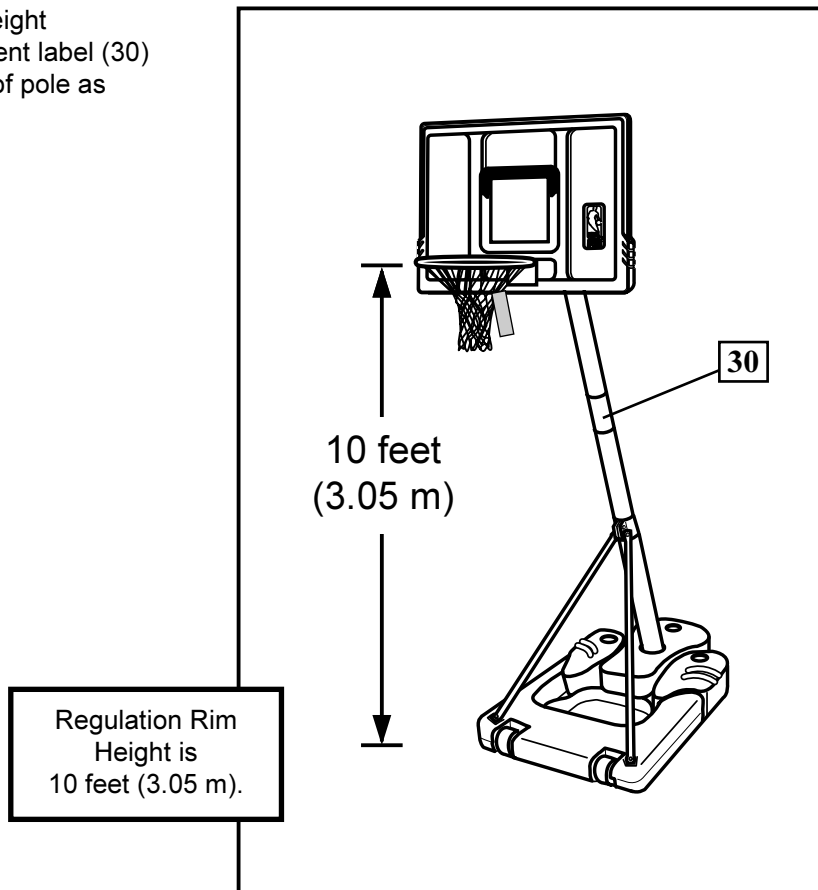

Height Adjustment

26. Position looped end of height adjustment crank (34) onto hook as shown. Rotate crank handle to raise or lower backboard. View label (28) to determine approximate backboard height.

NOTE: If height adjustment is difficult to operate, you may have over tightened the areas indicated.

⚠ WARNING

STORE CRANK OUT OF REACH OF CHILDREN. DO NOT ALLOW CHILDREN TO ADJUST HEIGHT WITHOUT ADULT SUPERVISION COULD RESULT IN SERIOUS BODILY HARM AND/OR PROPERTY DAMAGE.

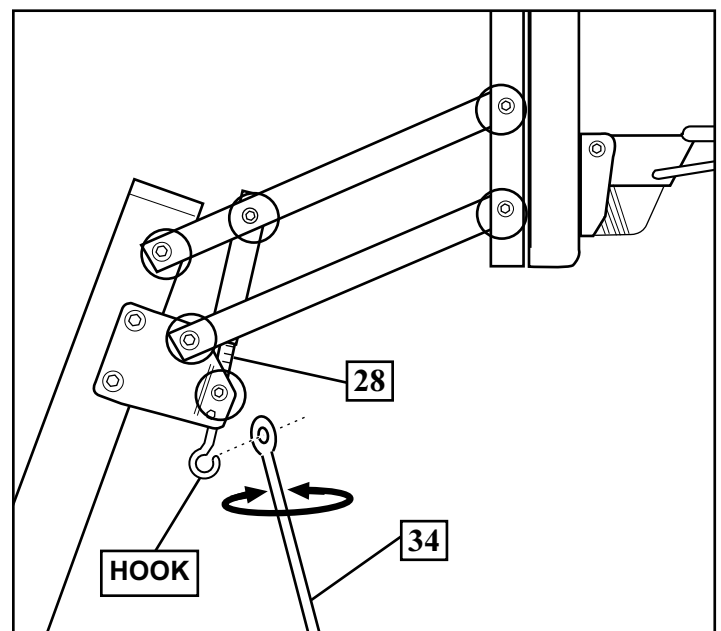

PARTS LIST

<u>Item</u>	<u>Qty.</u>	<u>Part No.</u>	<u>Description</u>	<u>Item</u>	<u>Qty.</u>	<u>Part No.</u>	<u>Description</u>
1	1	226350	Tank, (Front Section)	21	1	202438	Black Nylon Rope
2	2	226403	Wheel	22	1	203124	Stake, Tie Down
3	2	206245	Bolt, Hex Head, 1/2-13 x 5-1/2 Long	23	3	206219	Fill Cap
4	24	203474	Washer, 1/2 I.D., 1-5/64 O.D.	24	2	206273	Bolt, Hex Head, 1/2-13 x 4-1/2 Long
5	2	206341	Bracket, Wheel	25	4	201651	Spacer
6	13	206340	Locknut, Hex, 1/2-13	26	1	906277	Plate, Jack Support, (Left)
7	1	918812	Top Pole Section	27	1	906276	Plate, Jack Support, (Right)
8	1	990062	Middle Pole Section	28	1	205229	Label, Height Indicator
9	1	908407	Bottom Pole Section	29	1	805231	Screw Jack
10	1	906343	Collar, Pole/Strut	30	1	201254	Label, Height Adjustment & Moving
11	4	203113	Bolt, Hex Head Flange, 5/16-18 x 2-1/2 Long	31	1	206234	Cover, Height Indicator
12	12	203232	Washer, Flat, 3/4 O.D.	32	1	206913	Cap, Pole, 3-1/2 Round
13	10	203100	Nut, Hex Flange, 5/16-18	33	2	206249	Bolt, Hex Flange, 1/2-13 x 1-1/4
14	2	200516	Bolt Cover, Vinyl, (Black)	34	1	806259	Crank, Height Adjustment
15	1	206347	Rod, Steel, 1/2 O.D. x 4-3/4 Long	35	2	206360	Bolt, Hex Head 3/8-16 x 2.625 Long
16	1	206352	Eyebolt, 3/8 x 6 Long	36	2	200874	Spacer
17	1	226351	Tank, (Rear Section)	37	1	900964	Board Bracket
18	1	206346	Washer, Rectangle, 1-7/8 x 4	38	4	904807	Tube, 25.5 x 1.5, 4 Holes
19	3	201124	Locknut, Hex 3/8-16	39	4	202862	Spacer, Black Plastic, 1.19" Long
20	2	906410	Strut, 1-1/4 O.D. x 43	40	5	206244	Bolt Hex Head, 1/2-13 x 8, Zinc Plated
				41	1	206269	Spacer, 4 Long x .500 ID x .750 OD

* You may have extra parts with this model.

HARDWARE IDENTIFIER

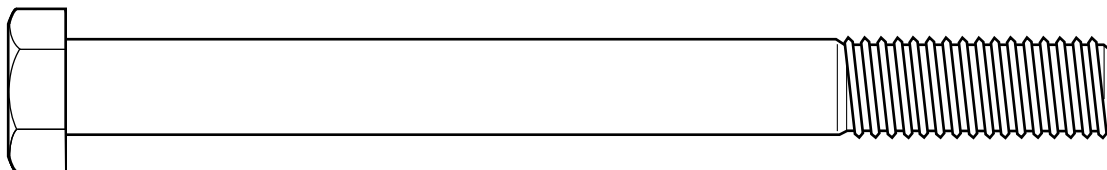

Item #3 (2)

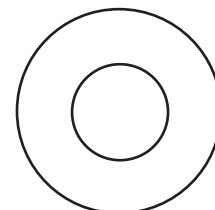

Item #4 (24)

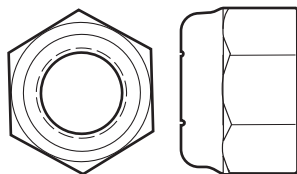

Item #6 (13)

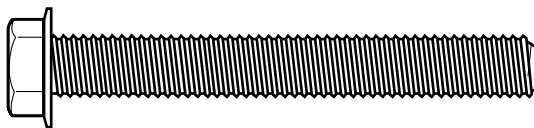

Item #11 (4)

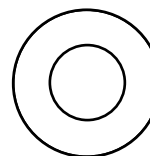

Item #12 (12)

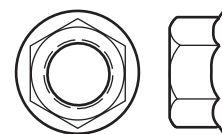

Item #13 (10)



Item #14 (2)

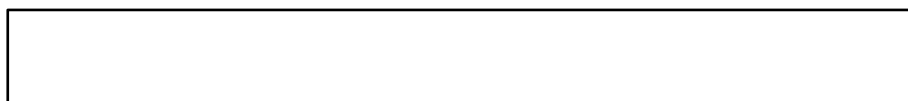

Item #15 (1)

* YOU MAY HAVE EXTRA PARTS WITH THIS MODEL.

HARDWARE IDENTIFIER (CONTINUED)

HARDWARE IDENTIFIER

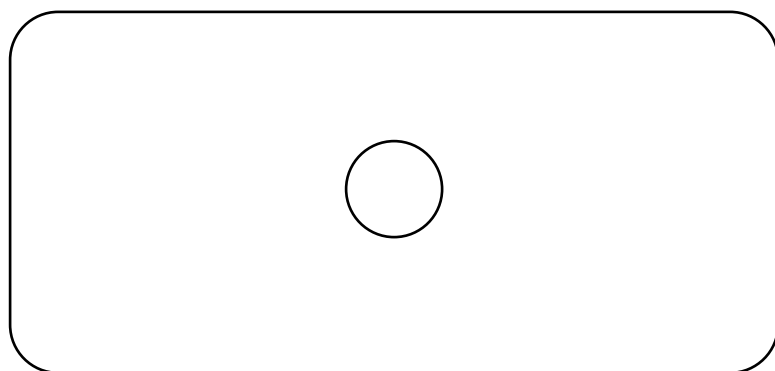

Item #18 (1)

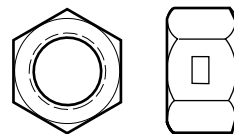

Item #19 (3)

Item #40 (5)

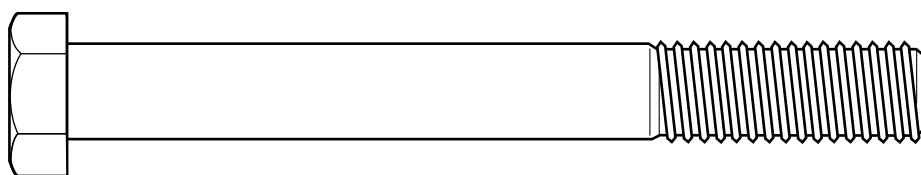
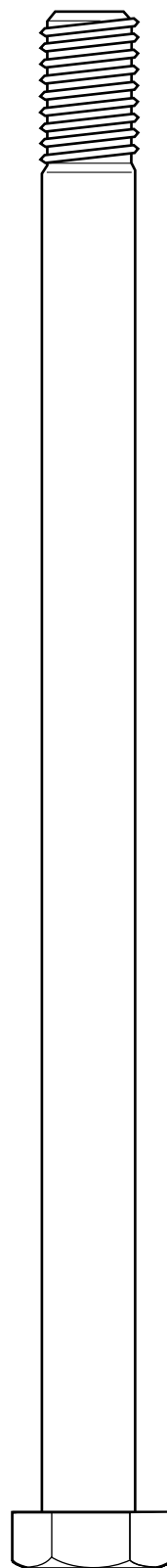

Item #24 (2)

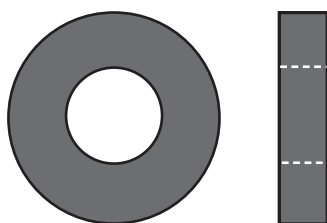

Item #25 (4)

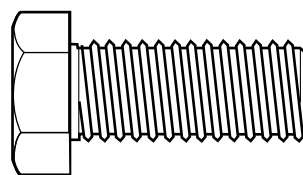

Item #33 (2)

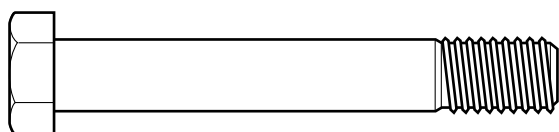

Item #35 (2)



Item #36 (2)

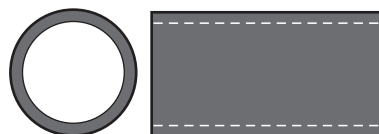

Item #39 (4)

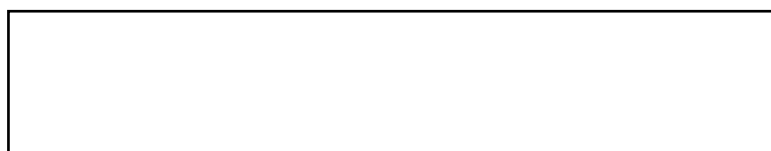

Item #41 (1)

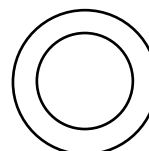

* YOU MAY HAVE EXTRA PARTS WITH THIS MODEL.

HARDWARE IDENTIFIER (CONTINUED)

Free Manuals Download Website

<http://myh66.com>

<http://usermanuals.us>

<http://www.somanuals.com>

<http://www.4manuals.cc>

<http://www.manual-lib.com>

<http://www.404manual.com>

<http://www.luxmanual.com>

<http://aubethermostatmanual.com>

Golf course search by state

<http://golfingnear.com>

Email search by domain

<http://emailbydomain.com>

Auto manuals search

<http://auto.somanuals.com>

TV manuals search

<http://tv.somanuals.com>