



**Model 44758
Remote
Sensor
Owners
Manual**

Your Model 44665 thermostat can read the temperatures from up to three weather-resistant sensors at a distance of up to 75 feet*. It will control the temperature from as many as two indoor sensors, with a third being a sensor only - perfect for outdoor use.

If you use multiple sensors, you might want to number them. Simply use a marker to write a number on the back of each sensor.

Additional sensors can be purchased separately from your HVAC contractor, or you can contact us at www.climatetechnologyproducts.com.

You can mount the Remote Sensors on a wall or other vertical surfaces, or you can set the Remote Sensors on tables or other horizontal surfaces.

Consult the Thermostat Instruction Manual, page 15, Option 8 for instructions in setting the thermostat to accommodate the remote sensors.

* Distance may vary based on building construction or other interfering frequencies.

NOTE

This device complies with Part 15 of the FCC Rules. Operation is subject to the following two conditions: (1) this device may not cause harmful interference, and (2) this device must accept any interference received, including interference that may cause undesired operation.

This equipment has been tested and found to comply with the limits for a Class B digital device, pursuant to Part 15 of the FCC Rules. These limits are designed to provide reasonable protection against harmful interference in a residential installation. This equipment generates, uses and can radiate radio frequency energy and, if not installed and used in accordance with the instructions, may cause harmful interference to radio communications. However, there is no guarantee that interference will not occur in a particular installation. If this equipment does cause harmful interference to radio or television reception, which can be determined by turning the equipment off and on, the user is encouraged to try to correct the interference by one or more of the following measures:

- Increase the separation between the equipment and receiver.
- Connect the equipment into an outlet on a circuit different from that to which the receiver is connected.
- Consult the dealer or an experienced radio/TV technician for help.

1. Remove the four screws on the back of the Remote Sensor. See Figure 1. The Outer Cover will drop off.

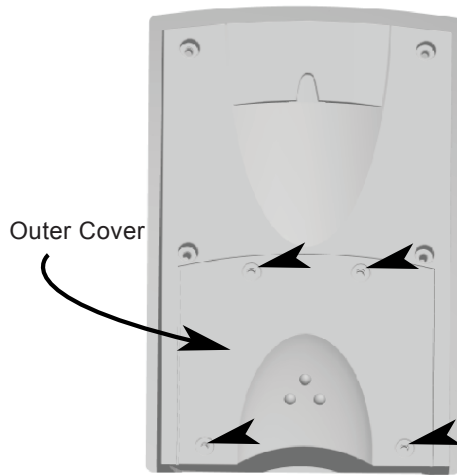

Figure 1

2. Remove the Battery Compartment Cover, which is underneath the Outer Cover. See Figure 2.

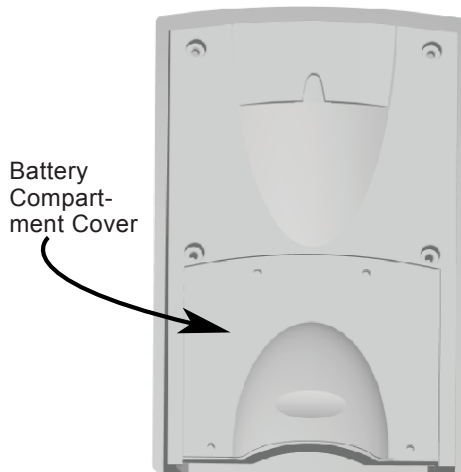

Figure 2

3. Use the tip of a paper clip to set the FIRST FOUR Remote Sensor DIP Switches to any configuration you desire. NOTE: Each sensor you use must have a different setting. See Figure 3.

To set the remote sensor to display the temperature in Fahrenheit, place the FIFTH DIP switch in the DOWN position.

To set the remote sensor to display the temperature in Celsius, place the FIFTH DIP switch in the DOWN position.

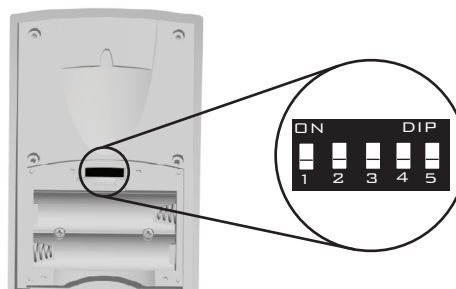

Figure 3

4. Install two fresh AA alkaline batteries into the Battery Compartment, being careful to observe the battery polarities. See Figure 4.

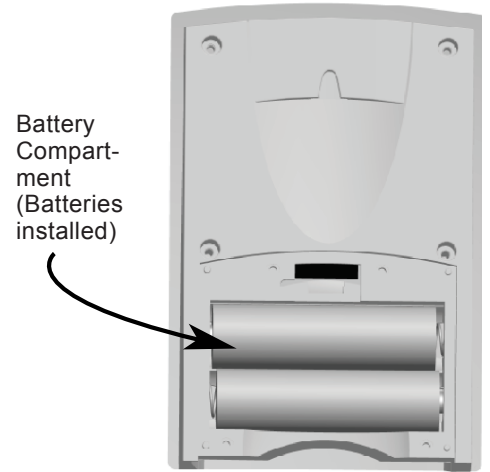

Figure 4

OPERATION

Initial Start-Up

1. When the batteries are installed, the LCD Display will show the first initializing screen for approx. 2 seconds. See Figure 5.

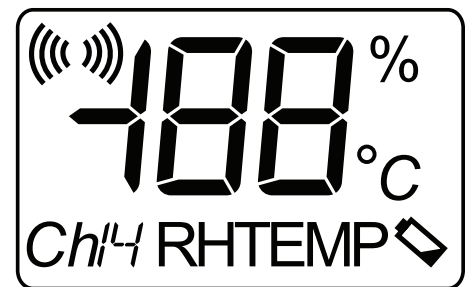

Figure 5

2. The LCD Display will then show the second initializing screen for approx. 10 seconds. See Figure 6.

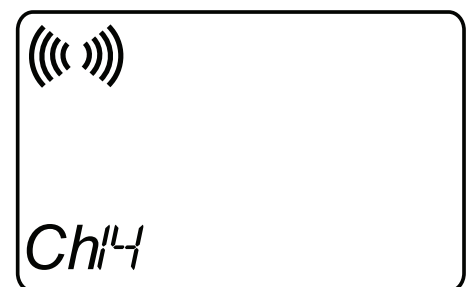

Figure 6

3. The LCD Display will then show the normal operating screen. See Figure 7.
NOTE: It may take up to 30 seconds for the thermostat to "pick-up" the sensor.

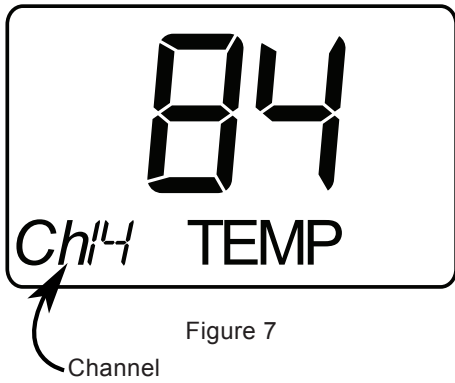

Figure 7

4. The Remote Sensor Screen will display the ambient temperature and, in the bottom-left corner, a channel number between 0 and 15. See Figure 7. This will be the channel to which you will set the thermostat to read the Remote Sensor. See the Thermostat Instruction Manual, page 14, Option 8.

5) Place the Battery Compartment Cover over the Battery Compartment.

6) For Wall Mounting

a. Replace the Outer Cover as shown in Figure 8. Use the four screws to secure the Outer Cover.

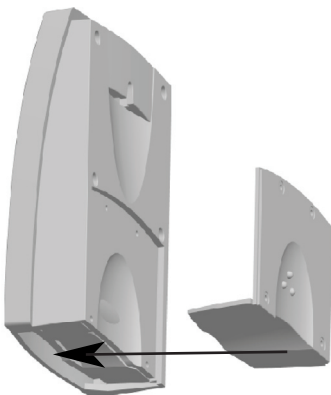

Figure 8

b. Use the provided screw to mount the Remote Sensor on a wall or other vertical surface. The back of the Remote Sensor has a Wall-Mount Indent from which it will hang from the provided screw. See Figure 9

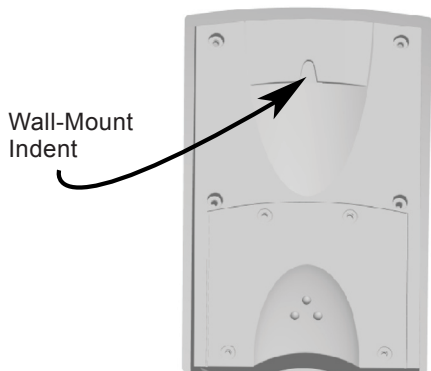

Figure 9

6) To Set the Remote Sensor on a Table

a. Replace the Outer Cover as shown in Figure 10. Use the four screws to secure the Outer Cover.

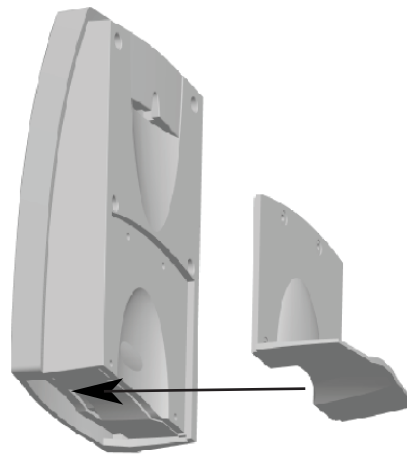

Figure 10

b. Rest the Remote sensor on the horizontal surface of your choice.

Indications

Normal Temperature Indication

If your Remote Sensor is set to show the temperature in Celsius, the display will show the °C indication next to the temperature. See Figure 11.

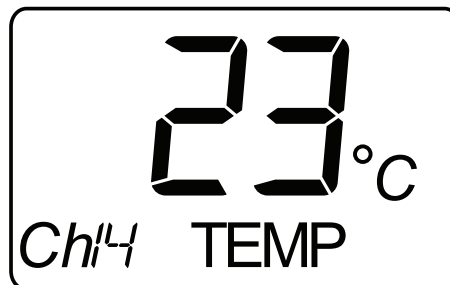

Figure 11

Temperature Measurement Range

Your Remote Sensor will show temperatures from -40°F to 122°F (-40°C to 50°C). If the temperature is greater than 122°F (50°C), the LCD will show "HI". See Figure 12A. If the temperature is lower than -40°F (-40°C), the LCD will show "LO". See Figure 12B.

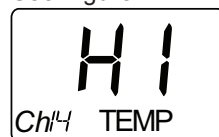

Figure 12A

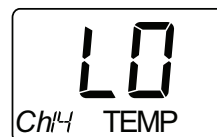

Figure 12B

Low Battery Indication

When your Remote Sensor's battery is running low, the LCD will show the flashing Low Battery Indication to remind you to install two fresh AA Alkaline batteries at your earliest convenience. See Figure 13. At this point your Remote Sensor will continue to function normally.

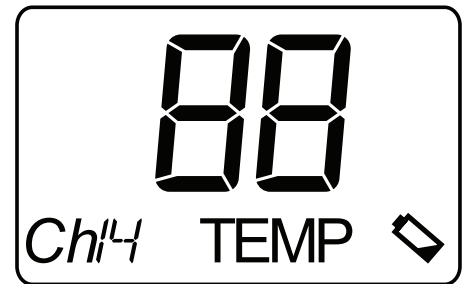

Figure 13

Depleted Battery Indication

If your Remote Sensor's battery is depleted to the point that the LCD is showing only the flashing Low Battery Indication, as in Figure 14, your Remote Sensor has ceased functioning and will continue in this condition until two fresh AA Alkaline batteries are installed. Without further attention, the LCD will eventually go blank.

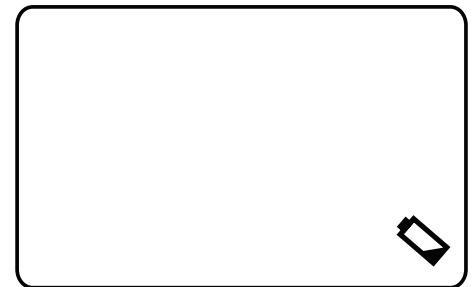

Figure 14

Your Remote Sensor will return to normal operation when fresh batteries are installed.

Troubleshooting

Problem: LCD is Blank.

Solution: Make certain your Remote Sensor's batteries are 1) installed correctly, with polarities correctly positioned, and 2) fresh.

Problem: Thermostat is not showing the same temperature as the Remote Sensor.

Solution: Make certain you have the correct Remote Sensor selected at your thermostat (if you are using more than one Remote Sensor).

If you require further assistance, call Hunter Fan Technical Support at 1-888-830-1326 from 7am to 7pm Central Time Monday thru Friday and 8am to 5pm on Saturday.

Free Manuals Download Website

<http://myh66.com>

<http://usermanuals.us>

<http://www.somanuals.com>

<http://www.4manuals.cc>

<http://www.manual-lib.com>

<http://www.404manual.com>

<http://www.luxmanual.com>

<http://aubethermostatmanual.com>

Golf course search by state

<http://golfingnear.com>

Email search by domain

<http://emailbydomain.com>

Auto manuals search

<http://auto.somanuals.com>

TV manuals search

<http://tv.somanuals.com>