



HUSKY®

The Toughest Name In Tools

HSK141HD

319318

2.25 MILLION CANDLE POWER CORDED, CORDLESS, RECHARGEABLE SPOTLIGHT WITH BUILT-IN STAND AND AREA UTILITY LIGHT



OWNER'S MANUAL & WARRANTY INFORMATION

THIS MANUAL CONTAINS IMPORTANT INFORMATION REGARDING SAFETY, OPERATION, MAINTENANCE AND STORAGE OF THIS PRODUCT. BEFORE USING, READ AND UNDERSTAND ALL CAUTIONS, WARNINGS, INSTRUCTIONS AND PRODUCT LABELS, PLUS YOUR VEHICLE'S BATTERY MANUFACTURER GUIDELINES. FAILURE TO DO SO COULD RESULT IN INJURY AND/OR PROPERTY DAMAGE.

**4140 SW 28TH WAY, FT. LAUDERDALE, FL 33312
TOLL FREE: 800-916-7004**

IMPORTANT SAFETY INFORMATION

1. Although the HUSKY 2.25 candle power spotlight can be recharged using either AC or DC power sources, it is not designed to operate directly from the supplied AC Recharge Adapter. Doing so may result in damage to the unit, and will void the warranty.
2. You **CAN CHARGE** and **OPERATE** the HUSKY spotlight directly from the supplied DC adapter. (Recharge/power adapter)
3. Do not use charging systems other than those supplied by the manufacturer.
4. Do not leave the SPOTLIGHT charging for more than 24 hours (AC method) or 6 hours (DC Method).
5. Do not completely discharge the battery before recharging. Deep discharge will decrease battery life.
6. Recharge the battery in a well ventilated area.
7. Never look directly into the light.
8. Use caution when handling the light as the lens becomes hot during use.
9. Store with Spotlight turned OFF and Trigger Lock ON.
10. Store with Area light in handle turned OFF.
11. Do not operate spotlight with lens against flammable materials.
12. Keep light away from children, it is not a toy.

INTRODUCTION

Congratulations on purchasing the HUSKY 2.25 million candle power spotlight, an advanced design combination spotlight and area light. It instantly converts use from a powerful spotlight to a soft, long-lasting area light. It uses a powerful proven-technology rechargeable, non-spillable sealed lead acid battery that allows for years of dependable use, recharge after recharge. It was designed from the ground up to be the most versatile and practical light for travel, camping, picnicking, tailgate parties and boating. The spotlight gives you the kind of light you need, when and where you need it.

1. FEATURES:

- Cordless/Corded, powerful Quartz Halogen Spotlight for use whenever and wherever you need light
- Longer run-time battery - minimum of 20 minutes continuous use for Spotlight on single charge
- The tough, weather-resistant HUSKY 2.25 candle power spotlight is built for rugged, outdoor use
- Intense 2.25 Candle Power Beam carries up to one mile and easily penetrates rain, fog or smoke
- Powerful, brighter Quartz Halogen Bulb delivers a bright, tight beam up to 10 times the distance of a standard automobile headlight
- Computer designed parabolic reflector
- Area utility light built into handle provides long-term lighting for repair work, or as a flashlight operates 14 hours on full charge
- Battery Status Panel shows battery charge; It remains lit while recharging.
- E-Z-Store, built-in stand provides hands-free use of the spotlight, or the utility light (excellent for roadside repairs, power outages, etc.)

- Built-in hanging lanyard for hands-free convenience
- Cordless operation allows complete freedom of movement, corded for longer run time
- Pistol-grip handle fits comfortably in your hand
- Locking Trigger ON/OFF Switch delivers an instant beam, locks for continuous beam
- Unique switch-locking mechanism prevents accidental battery rundown
- May be charged from either AC or DC Power Sources (both charging adapters included)

FIGURE 1



2. CHARGING:

FIGURE 2

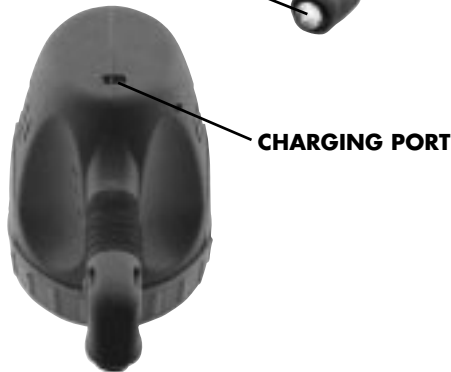

NOTE: During charging, use the handy, built-in stand (See Figure 3) to provide a steady base for the spotlight on floor, shelf, workbench, or vehicle floor.

Charging with AC 110/120 Volt AC charger - Plug the AC charger (included) into the charging port on the back of the HUSKY spotlight 2.25 body, and then plug into a standard AC wall outlet. Make sure the electric rating of your AC Power Supply matches the requirements listed on top of the AC CHARGER (110V AC). Make sure the Trigger Switch is in the OFF position. For initial charge, allow 20 hours for completion of a full charging cycle. For subsequent charges, allow approximately 8-10 hours. Charge until the green Battery Status Panel LED is lit.

NOTE: Charging from a 110/120 Volt AC power source is the most efficient method and is especially recommended for first-time charging.

Charging/Powering with 12 VOLT DC Charger - Plug the DC fused Recharge/Power Adapter (included) into the barrel receptacle on the back of the spotlight body, and then insert the cigarette lighter plug into the cigarette lighter socket of your vehicle or other 12 VDC power source. Make sure the Locking Trigger Switch is in the OFF position. Allow approximately 3-5 hours charging time if the engine is running. You may use the spotlight while its internal battery is recharging. When the spotlight is OFF charge until the green battery status panel LED is lit.

NOTE: Be sure to use only the adapter cords supplied by the manufacturer for recharging - The use of unauthorized adapter cords may damage the unit and will void the warranty.

3. OPERATION:

The Spotlight can be operated with or without the battery installed. Operation from external 12 volt DC source with at least 10 amps capacity will allow lamp operation and internal battery charge.

SPOTLIGHT – Using the locking trigger switch:

- The trigger switch is located on the front of the pistol-grip handle of the spotlight (See Figure 1)
- To turn the Spotlight 2.25 ON, squeeze the trigger switch
- To turn the Spotlight 2.25 OFF, release the trigger switch
- To lock the trigger switch into the **ON** position for continuous operation, squeeze the trigger switch and firmly slide the trigger locking button (see Figure 1); the spotlight will stay on until the lock is released

AREA UTILITY LIGHT

- Will provide 14 hours of continuous utility lighting - THE AREA UTILITY LIGHT is ideal for roadside repairs, as a flashlight, for work areas, for use as a campsite area light, for power outages, etc
- The ON/OFF button for the area light is located near the bottom of the handle, on the left side (see Figure 1 & 3)
- To turn the area light ON, press the button
- To turn the area light OFF, press the button

NOTE The area light switch also turns on the Battery Status Panel LEDs. Recharge when just the red LED is lit.

4. HANDS-FREE OPERATION:

USING THE BUILT-IN HANGING LANYARD:

The lanyard may be used to hang the spotlight from a branch, hook or other convenient object. Adjust the slide on the cords to keep the lanyard secure around the supporting object.

USING THE BUILT-IN STAND:

- Lift and rotate the stand to desired angle
- Turn the spotlight upside-down, and rest it on the stand (see Figure 3)
- The spotlight and/or area utility light may now be used hands-free
- For hand-held operation, simply fold the stand into the storage position

FIGURE 3



5. BULB REPLACEMENT:

For bulb replacement you will need a small Phillips screwdriver. To replace the H3 12 Volt 100 watt Halogen Spotlight Bulb (See Figure 4A and Figure 4B):

1. Disconnect the Spotlight 2.25 from any charging/power source and lock the spotlight trigger switch OFF
2. Remove the rubber bezel by pulling it away from the spotlight lens.
3. Remove the two Phillips-head screws that hold the retaining ring to the spotlight body.
4. Pull off the retaining ring and set it aside.
5. Carefully remove the glass lens, rubber "O" ring and reflector assembly.
6. Loosen (no need to fully remove) the phillips-head screw in the neck of the reflector assembly - this will release the bulb unit.
7. Disconnect the bulb's center conductor wire from it's connecting wire (See figure 4B for bulb removal details).
8. Unsnap the hairpin retaining wires from the reflector's flange.
9. Using the screwdriver, loosen the retaining screw to remove the bulb from the reflector (no need to completely remove this screw).
10. Gently pull out the bulb unit and replace with a new H3 12V 100 watt Halogen Bulb from HUSKY (or minimum H3 12V 55W), available from an electrical supply house or from HUSKY's Technical Support Department, call (800) 916-7004.
11. Insert the replacement bulb into the reflector's flange.
12. Put back and secure the hairpin retaining wires.
13. Connect the bulb power wire to the red power wire.
14. Reverse the above procedure to re-assemble the spotlight.

FIGURE 4A

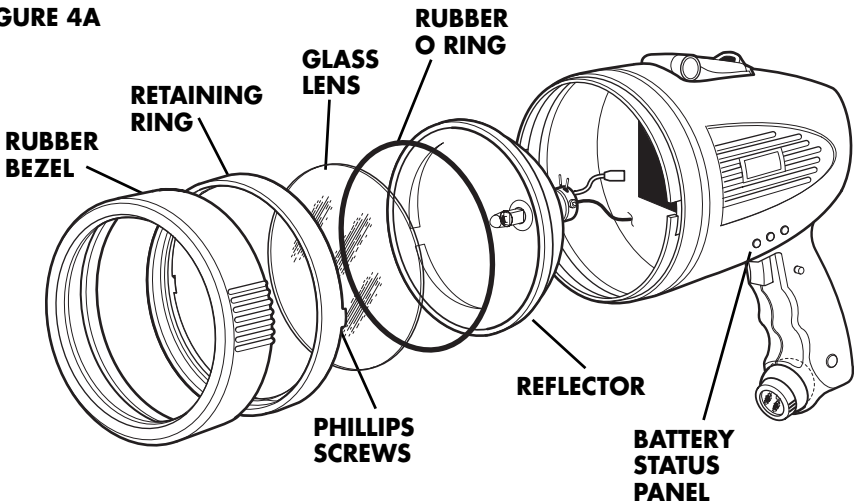

NOTE: It is recommended that the unit be returned to Vector for replacement of the spotlight bulb. Contact HUSKY's Technical Support Department at (800) 916-7004.

NOTE: When handling a new halogen bulb, do not touch the glass portion of the bulb. Natural oils from your hands can cause the bulb to fail. If necessary, clean the bulb with alcohol or a liquid window cleaner.

FIGURE 4B

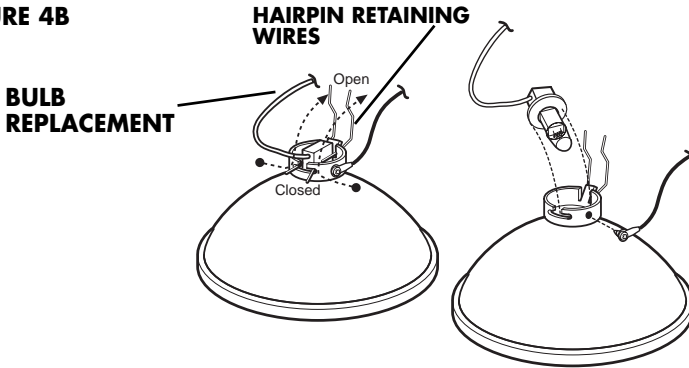

REPLACING THE AREA LIGHT BULB:

1. This 12V bulb is designed to last for the lifetime of the product.
2. In the event of failure, you may return the spotlight to HUSKY for bulb replacement. Contact HUSKY's Technical Support Department at (800) 916-7004.

6. BATTERY:

- The life expectancy of the 12 Volt 3.0 Amp-hour, sealed lead-acid battery is approximately 500 charging cycles. A replacement battery may be purchased through the HUSKY Technical Support Department by calling (800) 916-7004
- A fully-charged battery will provide approximately 20 minutes of continuous light from the spotlight, or up to 14 hours of continuous light from the area utility light
- Do not allow battery to completely discharge, a dim light indicates that the battery charge is low, and should be recharged. Charge battery as soon as possible after each use; monitor charge status by color

REPLACING THE BATTERY PACK:

All lead acid batteries fail over time and with extreme temperature changes. Keeping the battery charged periodically will extend battery life to the maximum. Recharge after each use as soon as possible using AC/DC recharge adapter as DC recharge methods may not fully recharge the battery to its full capacity. If the battery does not operate the spotlight for more than 10 minutes and recharge is sufficient to fully charge the battery, then it is time to replace the battery.

1. Disconnect the SPOTLIGHT 2.25 from the Charging/Powering Source.
2. Make sure the Trigger Switch is turned OFF and locked.
3. Follow the lamp replacement procedures to step 10.
4. Carefully disconnect the positive and negative wires from the battery terminals, noting the position of the wires.
5. Using a small Phillips head screwdriver remove 4 battery hold down strap screws.
6. Set the battery aside and insert the new battery taking care to MATCH UP THE PROPER POLARITY - POSITIVE (red) to positive; negative (Black) to negative.
7. Attach wires to terminals.
8. Replace the battery hold down straps and screws (Do not over-tighten - clockwise)
9. Reassemble spotlight reflector by reversing the bulb replacement procedure.
10. Test the spotlight by operating the trigger switch. Charge the new battery for 20 hours using the AC/DC Recharge Adapter.

FIGURE 5

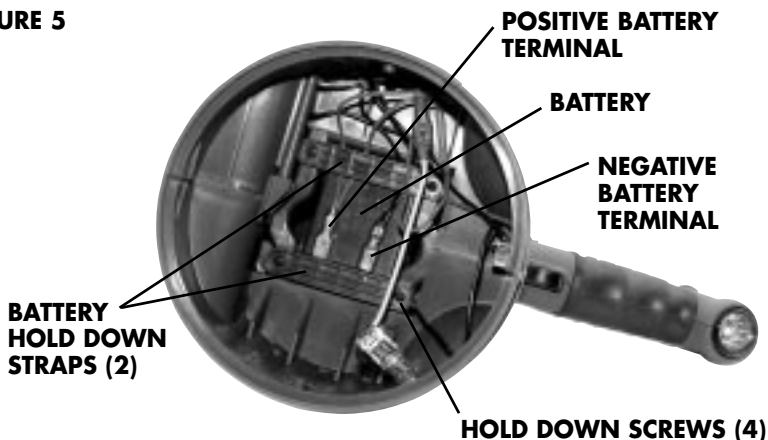

BATTERY DISPOSAL:

1. Non-spillable sealed lead-acid Battery - This battery is fully recyclable and should be accepted at any location that accepts common automotive starter batteries. Examples of places that accept these batteries are: County or municipal recycling drop-off centers, scrap metal dealers, and retailers who sell automotive replacement lead acid starter batteries. For more information on recycling this battery, call toll-free (877) 288-7722.
2. Before disposing of the battery, protect exposed terminals with heavy-duty tape to prevent shorting (Shorting can result in injury or fire).
3. Do not expose battery to fire or intense heat as it may explode.



FUSE REPLACEMENT:

The plug of the DC Power/Charging adapter is equipped with a 10 amp cartridge fuse. If this fuse blows, there may be a short circuit in the power cord or lamp assembly. The fuse will blow if the battery is connected with reverse polarity. The fuse is accessed by unscrewing (counter-clockwise) the tip of the large DC plug. Check the fuse with an ohmmeter or other continuity checker. If the fuse is open, investigate why it blew and correct the problem before replacing the fuse. Reassemble the DC plug and power the lamp from a 8 Amp or greater 12 volt power supply.

SPECIFICATIONS

Spotlight Bulb	12 volt, H3 series
Battery	Maintenance free, sealed lead acid, 12 volt, 3 Amp Hour
Weight	6 lbs 2 oz (1.5 kg)
Depth	9.0 in (22.9 cm)
Width	6.5 in (16.51 cm)
Height	11.5 in. (29.21 cm)

WARRANTY:

HUSKY 2 YEAR LIMITED WARRANTY PROGRAM

The Home Depot warrants this Husky Power Product to the original user to be free from defects in material and workmanship for a period of two years from the date of purchase. If you believe that this unit is defective during its original two-year warranty period, return the unit, with proper proof of purchase to The Home Depot store or send the product to Husky Power Products at the address below.

This Husky Power Products is warranted, to the original purchaser only, to be free of defects in materials and workmanship for two years from the date of purchase without additional charge. The warranty does not extend to subsequent purchasers or users. Husky Power Products will not be responsible for any amount of damage in excess of the retail purchase price of the product under any circumstances. Incidental and consequential damages are specifically excluded from coverage under this warranty.

This product is not intended for commercial or rental application, only a 90 day warranty will apply in this instance. This warranty does not apply to accessories or damage to units from misuse or incorrect installation. Misuse includes wiring or connecting to improper polarity power sources.

RETURN/REPAIR POLICY: If you believe that the product is defective during the it's two year Limited Warranty period, return the unit, with proof of purchase to the Home Depot Store. Defective products, may also be returned postage prepaid to Husky Power Products. Any defective product, other than accessories, that is returned to Husky Power Products within 30 days of the date of purchase will be replaced free of charge. If such a product is returned more than 30 days but less than two years from the purchase date, Husky Power Products will repair the unit or, at its option, replace it free of charge.

If the unit is repaired, new or reconditioned replacement parts may be used, at Husky Power Products' option. A unit may be replaced with a new or reconditioned unit of the same or comparable design. The repaired or replaced unit will then be warranted under the terms of the remainder of the warranty period.

The customer is responsible for the shipping charges on all returned items. During the warranty period, Husky Power Products will be responsible for the return shipping charges to the customer.

LIMITATIONS: This warranty does not cover accessories, bulbs, fuses and batteries, defects resulting from normal wear and tear (including chips, scratches, abrasions, discoloration or fading due to usage or exposure to sunlight), accidents, damage during shipping to our service facility, alterations, unauthorized use or repair, neglect, misuse, abuse, failure to follow instructions for care and maintenance, fire, flood, and Acts of God.

If your problem is not covered by this warranty, call Husky Power Products Technical Support Department at toll-free (800) 916-7004 for general repair information and charges if applicable.

STATE LAW RIGHTS: This warranty gives you specific legal rights. Some states do not allow limitations on how long an implied warranty lasts or the exclusion or limitation of incidental or consequential damages, so the exclusions or limitations stated herein may not apply. This warranty gives the purchaser specific legal rights; other rights, which vary from state to state, may apply.

TO REQUEST WARRANTY SERVICE FOR THIS PRODUCT: Contact Husky Power Products Technical Support by telephone, fax or mail. We suggest that you keep the original packaging in case you need to ship the unit. When returning a product, include your name, address, phone number, dated sales receipt (or copy), and a description of the reason for return and product serial number. After replacing the unit, we will return it to you within four weeks.

**All HUSKY products must be registered within (30) days of purchase to activate this warranty.
Mail the completed registration form, along with a copy of the original sales receipt to:**



HUSKY®
The Toughest Name In Tools

ATTN.: CUSTOMER SERVICE / HUSKY
4140 SW 28th Way, Ft. Lauderdale, FL 33312
TOLL FREE: (800) 916-7004

WARRANTY MUST BE WITHIN 30 DAYS OF PRODUCT PURCHASE DATE.

WARRANTY IS NON-TRANSFERABLE AND NON-REFUNDABLE.
Download from www.Somanuals.com. All Manuals Search And Download.

Free Manuals Download Website

<http://myh66.com>

<http://usermanuals.us>

<http://www.somanuals.com>

<http://www.4manuals.cc>

<http://www.manual-lib.com>

<http://www.404manual.com>

<http://www.luxmanual.com>

<http://aubethermostatmanual.com>

Golf course search by state

<http://golfingnear.com>

Email search by domain

<http://emailbydomain.com>

Auto manuals search

<http://auto.somanuals.com>

TV manuals search

<http://tv.somanuals.com>